

West Mansfield

S. Simpson			J. McFadon	
			I. P.	
			J. McFadon	
			S. Simpson	
			26	
			26	
			S. Peck	
			S. Peck	
			44 45 42 41	
I. B. Church			M. B. Church	
			Heirs of F. Keller	
			20	
			19	
			Heirs of	
			17	
			16	
			15	

Business Directory

J. R. Skidmore }
 Wm^{rs} Reams } Physicians

Wilgus & Robinson, Deal- in Gen Merchise

Geo. Harshfield, Boot & Shoe Manufacturer

Job Smith, " " " "

Snyder Grocer

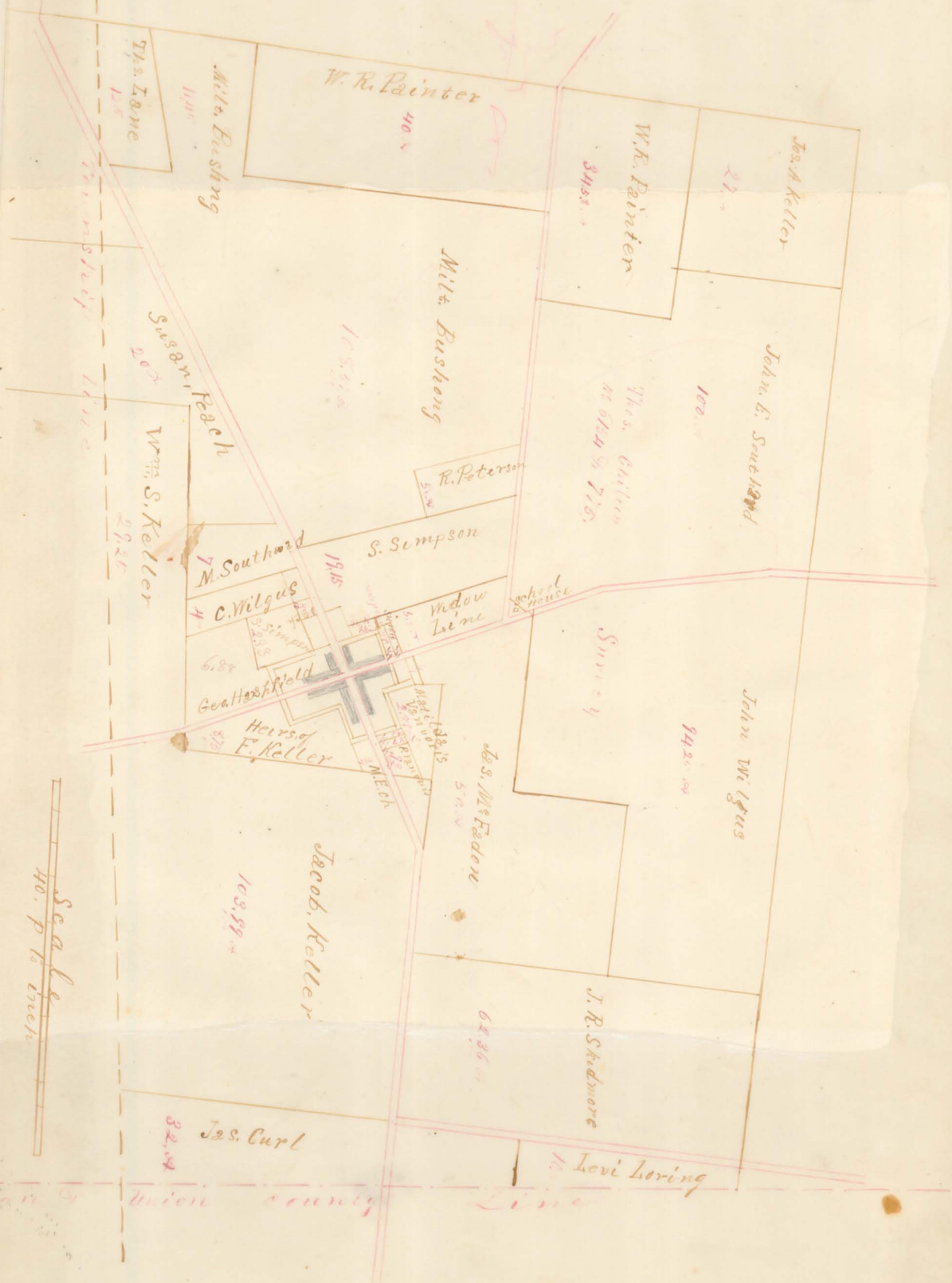

Scale
40. P to inch

South

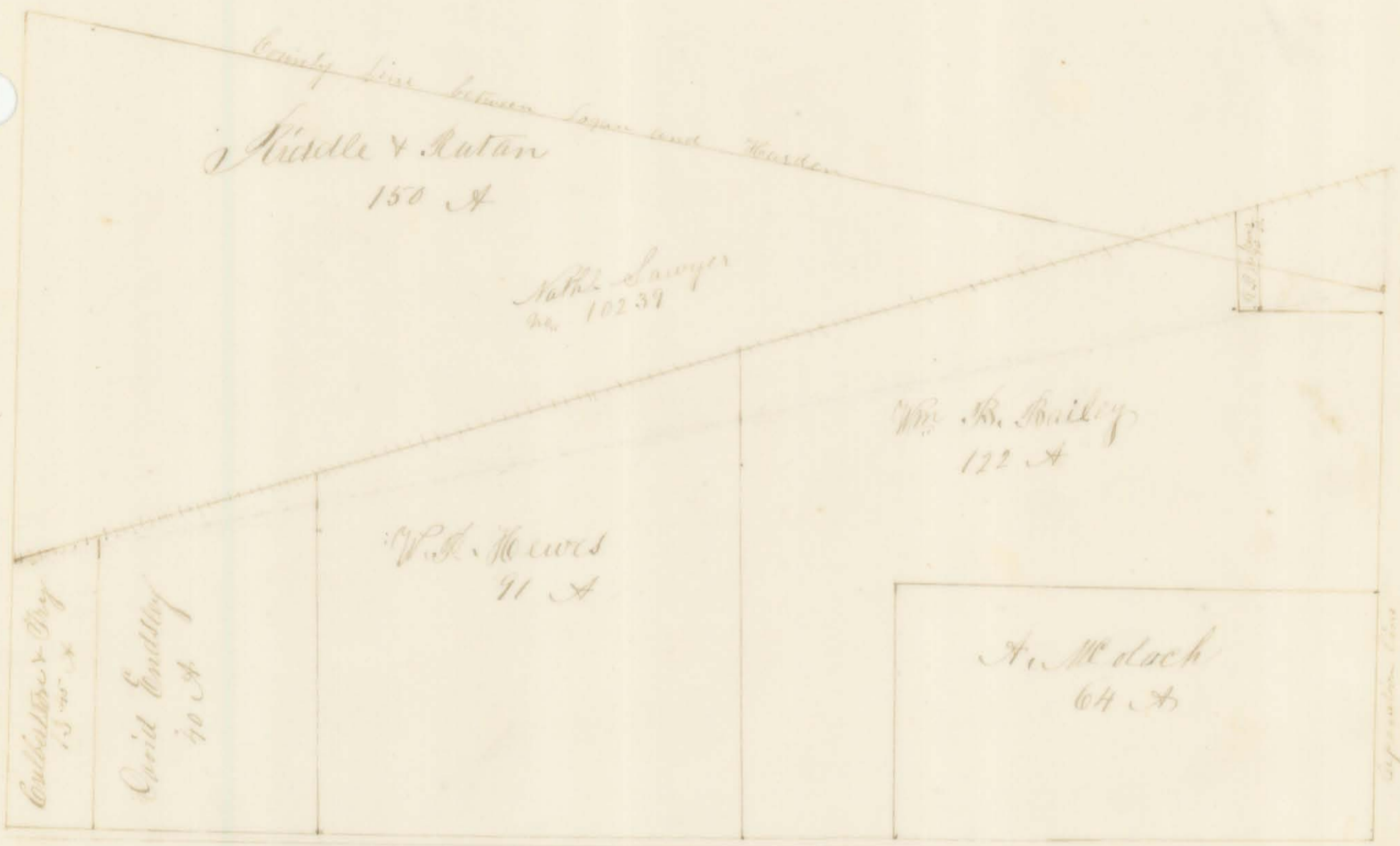

40 p 10 inch

87
R. B. Jenkins
1.50 @

West Ridgeway

74	79	84	89	131	136	141	146	17	18	19	20
75	80	85	90	132	137	142	147	F. Watson	M. Collier		
111	116	121	126	151	156	161	166	3.25 @	3.75 @		
112	117	122	127	152	157	162	167				
113	118	123	128	153	158	163	168				
114	119	124	129	154	159	164	169				
115	120	125	130	155	160	165	170				
21	22	23	24	32	33	34	35	45	49	53	51
W. J. W.	B. J. W.	C. J. W.	D. J. W.	A. C.	B. C.	C. C.	D. C.	J. Spruill	J. Buggs	W. J. W.	J. Spruill
1.50 @	1.50 @	1.50 @	1.50 @	1.90 @	1.90 @	1.90 @	1.90 @	12.25 @	12.25 @	6 @	6 @
25	26	27	28	36	37	38	39				
E. J. W.	F. J. W.	G. J. W.	H. J. W.	W. J. W.	X. J. W.	Y. J. W.	Z. J. W.				
1.50 @	1.50 @	1.50 @	1.50 @	2.22 @	2.22 @	2.22 @	2.22 @				
31	32	33	34	42	43	44	45	51	53	54	55
I. J. W.	J. J. W.	K. J. W.	L. J. W.	M. J. W.	N. J. W.	O. J. W.	P. J. W.	A. Spruill	P. Bushong	W. J. W.	W. J. W.
1.50 @	1.50 @	1.50 @	1.50 @	4.15 @	4.15 @	4.15 @	4.15 @	13.60 @	12.60 @	5.88 @	5.88 @
35	36	37	38	46	47	48	49				
Q. J. W.	R. J. W.	S. J. W.	T. J. W.	U. J. W.	V. J. W.	W. J. W.	X. J. W.				
1.50 @	1.50 @	1.50 @	1.50 @	6.35 @	6.35 @	6.35 @	6.35 @				

County Line

Merchant & Griffith
114 23 @

Nathan Sawyer

No 10259

W. F. Dickinson
Co

No 12258

Logan & Hardin County Line

Nathan

County line north

A. Wallace
78 @

William, Mansdolph

No. 10024 & 9960

Rock creek

John Harrison
76 50 @

John Harrison
37 @

W. Elliott
15 @

County line between Logan and Union

9959

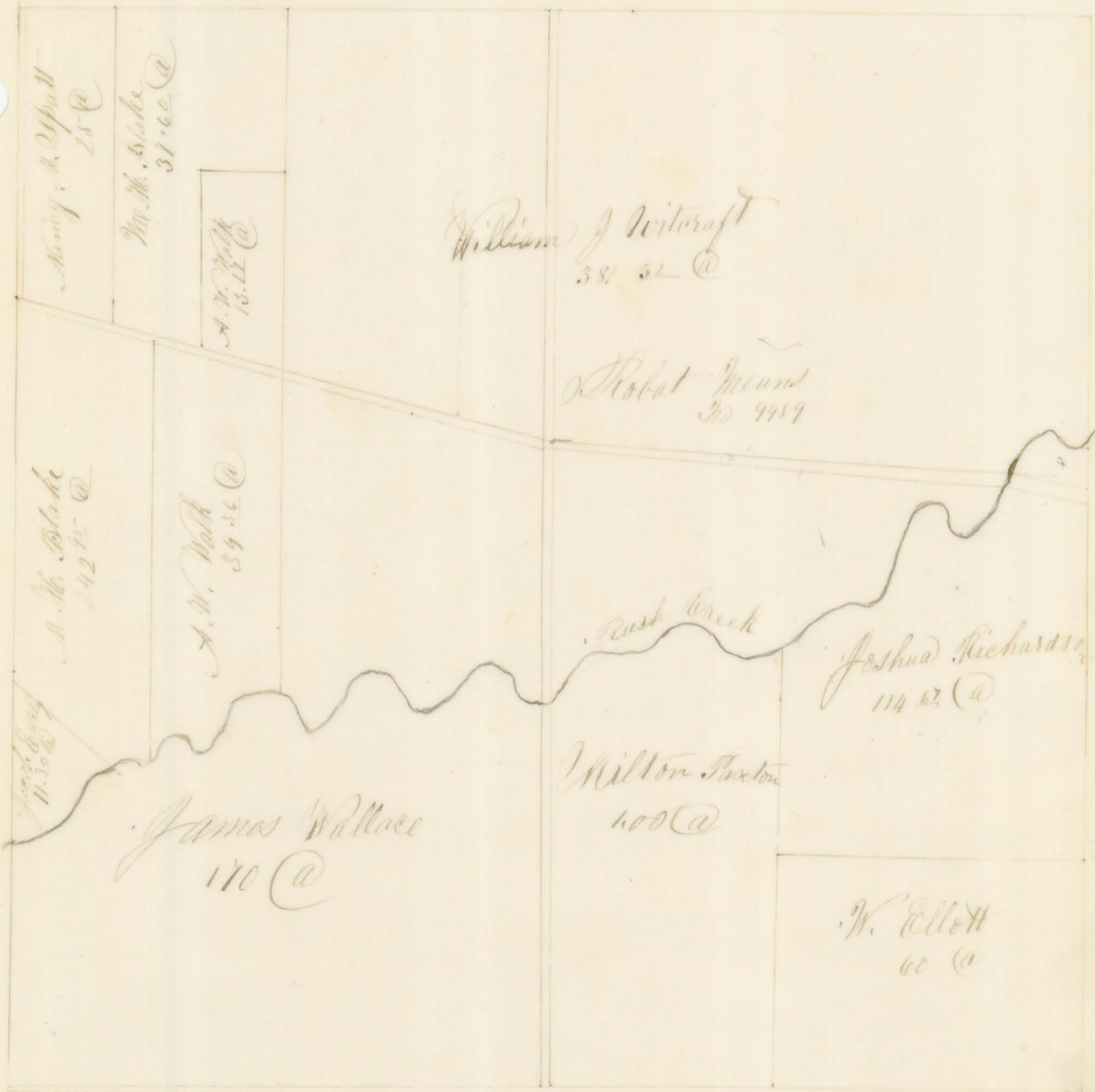

Nancy, M. Spald
25 @

Mrs M. Blake
37.66 @

A. W. Walk
13.12 @

William J. Wittercraft
38.52 @

Robert Means
30 9959

A. M. Blake
42.15 @

A. W. Walk
39.36 @

Rush Creek

Joshua Richards
114 @ @

John D. Long
11.30 @

James Wallace
170 @

Milton Saxton
100 @

W. Elliott
60 @

55. 11. 0

John Bell
11 10 @

Wm. W. West
19 20 @

E. Sanders
30 @

Susanna Howard
25 @

Moses Bell
98 @

Geoffrey Snidder
105 10 @

John Roberts
15 @

V. Elliott
100 @

Alex Parker no 9958
9958

Wm. Shogood
180 @

Jacob Earley
29.5 @

J. M. L. Jones
19 15 @

51

Trust and

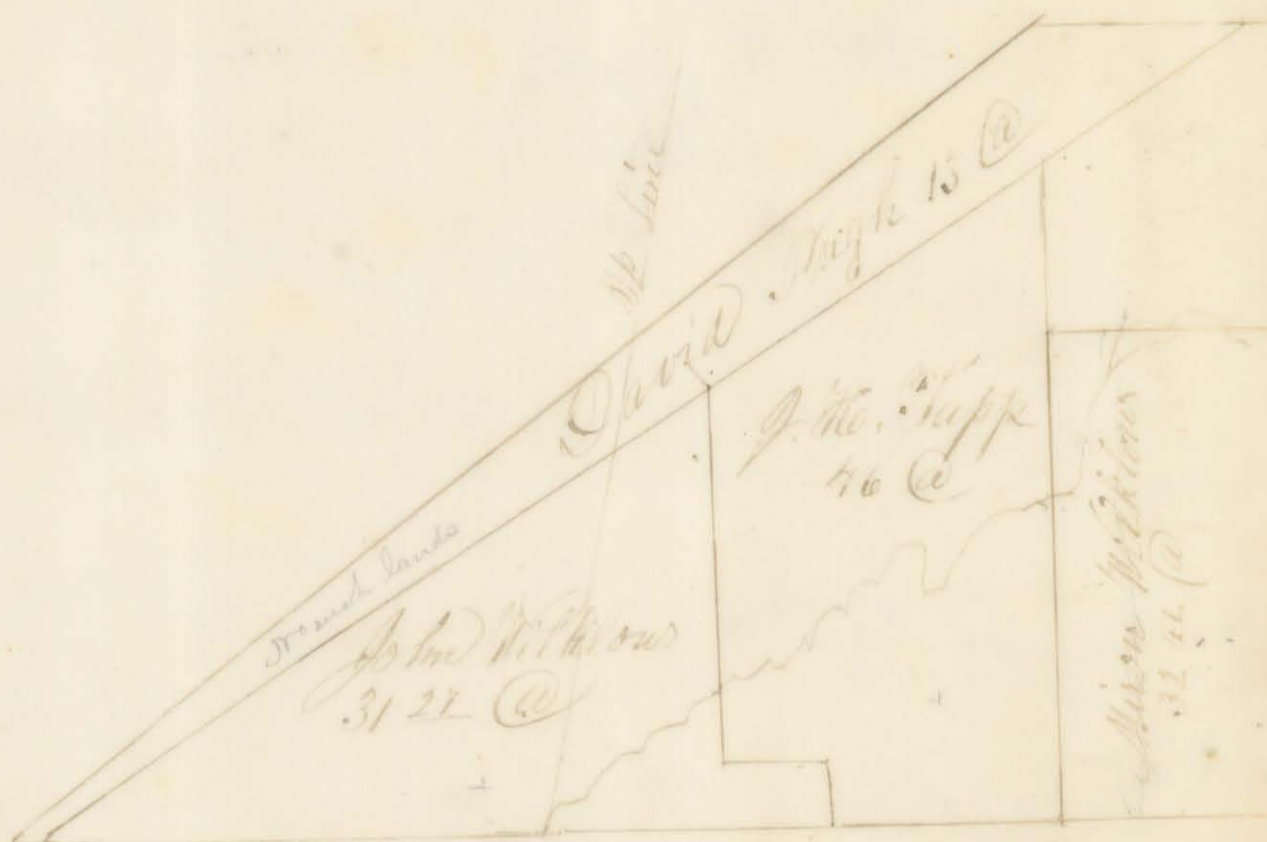

J. Culbertson
35 @

Joel King
44 1/2 @

W. P. Hewes
57 @

C. S. Hewes
60 @

Daniel Gregg
82 1/2 @

W. P. Hewes
79 60 @

Esther Denison
147 1/2 @

Thomas Wright
84 1/2 @

W. P. Hewes

E. Denison
C. Wallace no 14530713593

G. Smithson
42 1/2 @

J. King
44 1/2 @

W. P. Hewes
30 @

April Denison
April 11 1/2 @

Esther Denison
25 @

147 1/2 @

172 1/2 @

A. Murdock
42 1/2 @

C. M. Papp
50 1/2 @

Wm. Hambley
31 1/2 @

John H. Carey
no 103877
(10387)

Andrew Murdock
165 32 @

85
32 1/2
13 1/2
76 1/2

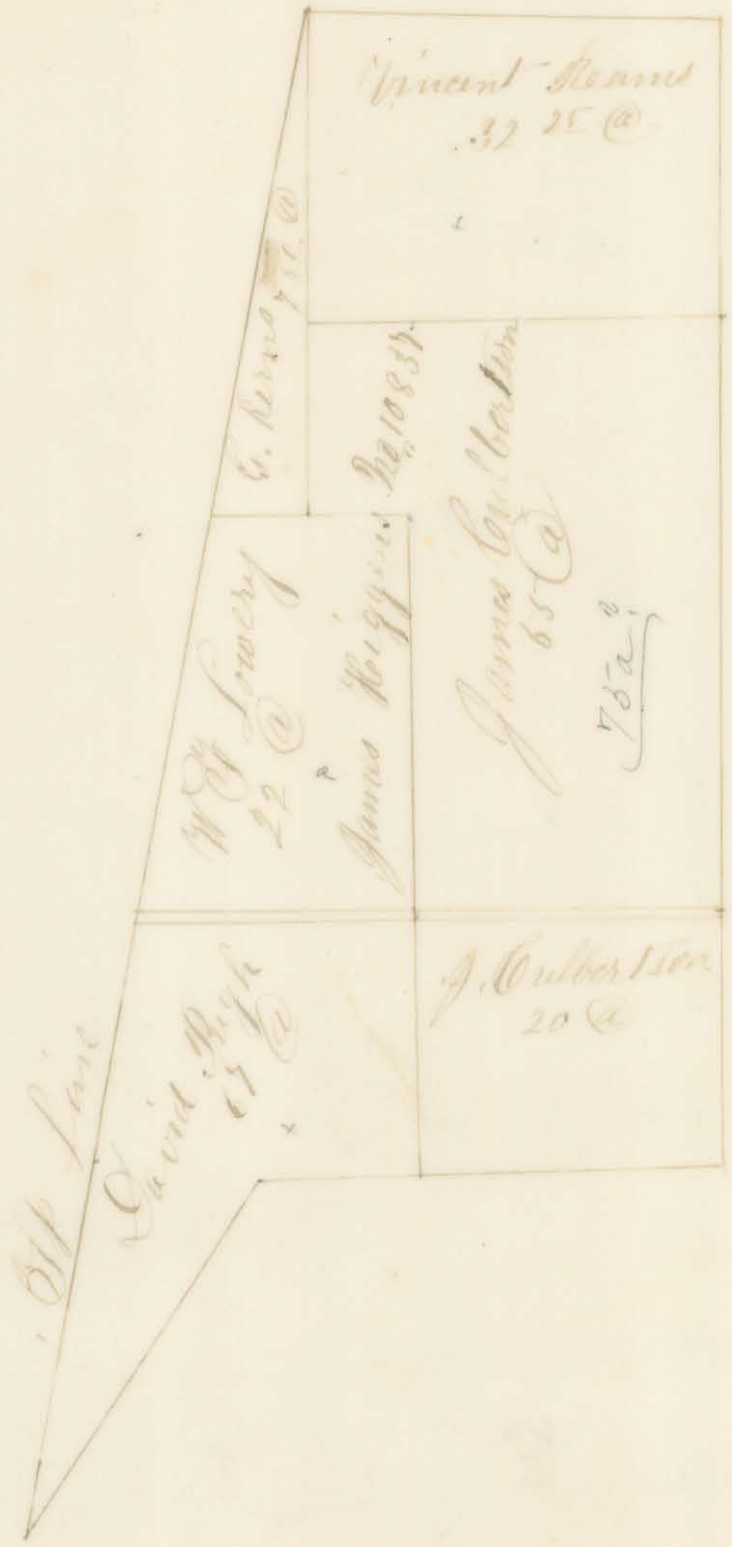

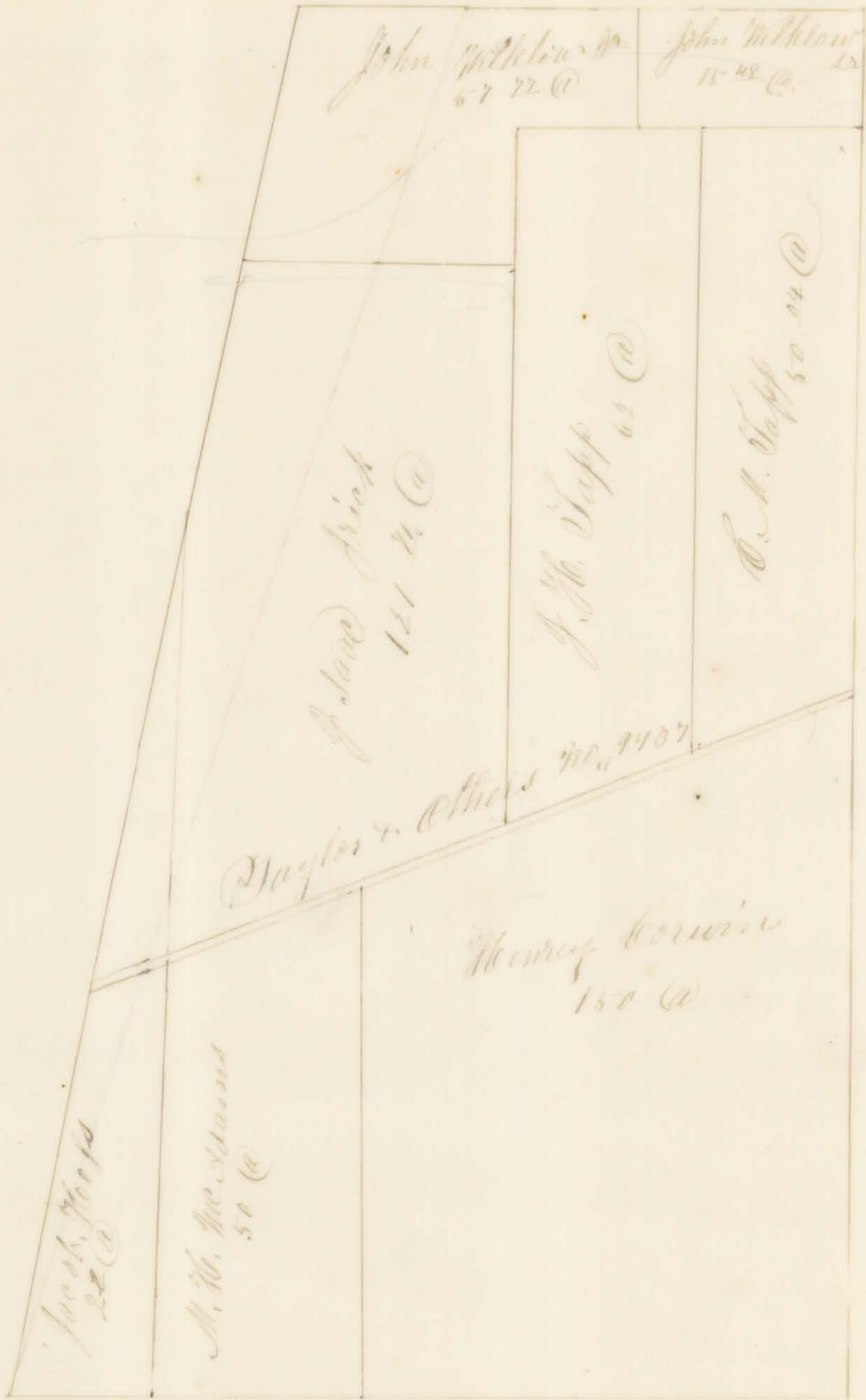

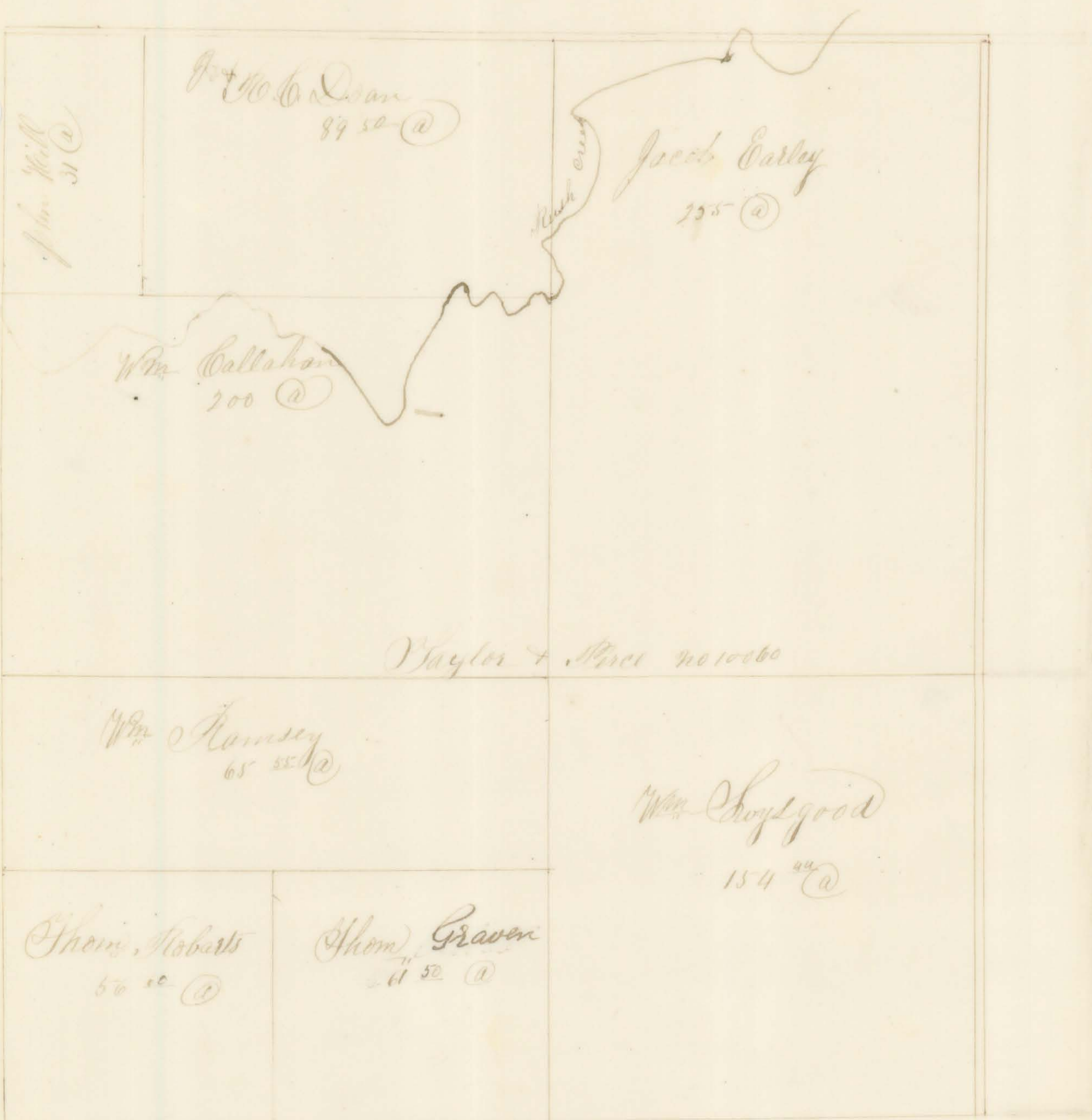

John Will
31 @

Geo. H. Dean
89 50 @

Jacob Carley
135 @

Wm Callahan
200 @

Rush Creek

Taylor & Price no 10060

Wm Ramsey
65 55 @

Wm Hoytgood
154 @

Thom Roberts
56 @

Thom Graven
41 52 @



John Withlow
50 @

John Withlow
29 1/2 @

C.A. Marman
192 1/2 @

Wm. Callahan
10 @

J. Sevalley
145 7/8 @

C.B. Higgins
31 1/2 @

C.A. Marman

Wm. Ramsey
113 @

Mrs. Madison no 1938

Solomon Smith
63 @

Wm. Madison
10 1/2 @

Solomon Smith
15 @

Wm. Blair
3 @

Wm. Blair
2 1/2 @

W.B. Carnish
19 25 @

Wm. Blair
55 @

Wm. Roberts
36 @

John Craven 11 10 (a)	Will 17 12 (a)	
Richard	Cant no 111	John Ewins 401 50 (a)
Sarah	Craven 49 12 (a)	James P. Smith 30 16 (a)
Jirob	Will 50 (a)	John Ewins Chicoy no 11112
Bernard	Ewins 64 50 (a)	

J. W. Williams 40 @	J. W. Williams 44 @
A. H. Elliott 90 @	
C. R. W. Williams No. 12112	
E. O. Stephenson 75 @	
Unknown Owners 51 @	

Logan & American Lines

12112

Jacob Keller
200 @

Wm. Weatherly
167 @

Wm. Gibbs & Others ²⁰⁰
9915

James M. Humphrey
200 @

Wm. Peterson
124 32 @

Oliver Ray
57 @

Wm. Peterson
50 @

W. James
97 @

Thomas Green
104 ss @

James Taylor
Harvey
no. 9914

Patent Stone
30 @

John Miller
40 @

James Taylor
285 ss @

Thomas Hill
300 ss @

A. G. Johnson
147 ss @

Besse Creek

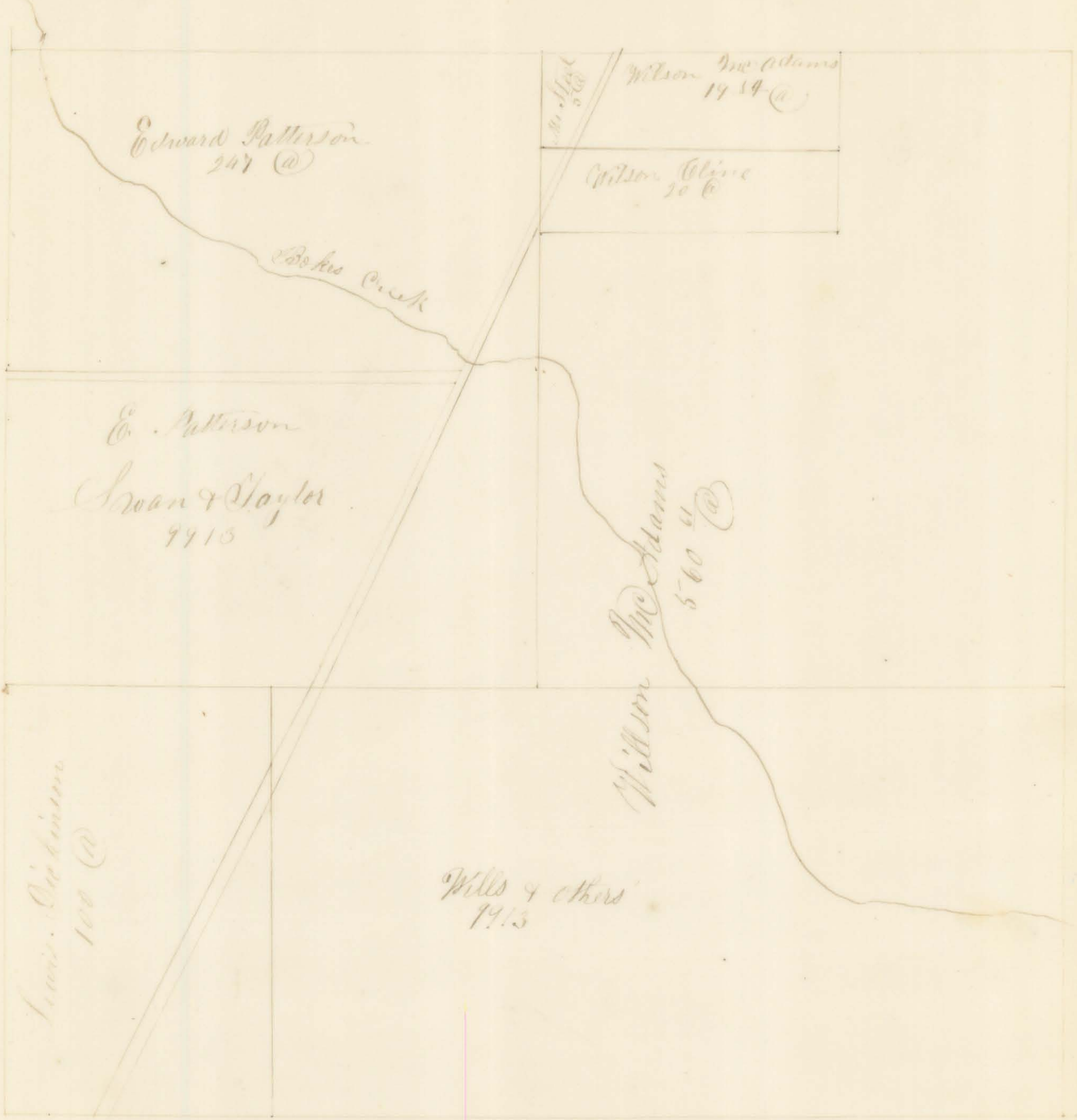

Edward Patterson
247 @

Wilson Mc Adams
19 1/4 @

Wilson Olive
10 @

Berkus Creek

E. Patterson
Swan & Taylor
99 1/3

Wilson Mc Adams
560 1/2 @

Lewis Dickinson
100 @

Wills & others
19 1/3

Oliver Corwin
190 @

N. Fuller No. 9912

James Gordon
33 @

Oliver Corwin
236 @

Oliver Corwin
No. 1000
No. 1000 Williams
63 @

Wm. Henton No. 1000

Cyrus Bell
146 55 @

John Crabill
175 @

Wilson McAdams
201 @

Lewis Dickinson
13 @

Abraham Woodland
36 @

Taylor & Others 9890

John Day
40 @

Peter Outland
125 @

Amos
11 @

Cyrus Bell
199 @

James Murdoch
50 @

W.M. Sutton
72 @

Sp. Line



Lewis Dickinson 118 46 @		Garrison Stuart 129 38 @		Mary Archer 31 67 @	
Christopher Williams 76 @		C. W. B. Allison 129 32 @		Olivia Hawcett 32 66 @	
Mrs Roberts No. 9891					
C Williams 4 @	Station Museum 5 @	Walter Martin 17 96 @	Charles Woodcock 36 02 b	James Taylor 21 22 @	Willy Perry 30 25 @
Charles Kinchlow 12 @	Kinchlow & Sutherland 44 52 @	Christopher Williams 50 b (ward)	Alfred McQuinn 51 22 @	John Hughes 102 @	O. J. & A. W. Roberts 101 34 @
Valley Museum 30 @	Kinchlow & Sutherland 44 52 @	Christopher Williams 50 b (ward)	Alfred McQuinn 51 22 @	John Hughes 102 @	O. J. & A. W. Roberts 101 34 @

Ac. L. Dickerson
249 54 @

Thom. Skidmore
103 42 @

Bones Creek

James Taylor Survey no. 9892

Wm. Herow
57 32 @

Henry Miller
(Charles) 30 70 @

Thom. Stuart
56 28 @

James O. Wilgus
110

James Crane
47 12 @

James O. Wilgus
160 30 @

Warner Westbrook
25

Moses Swinney
25 @

Benjamin Fictus
130 20 @

Wm. Hoopes
25 @

Alfred McGinnis
25 @



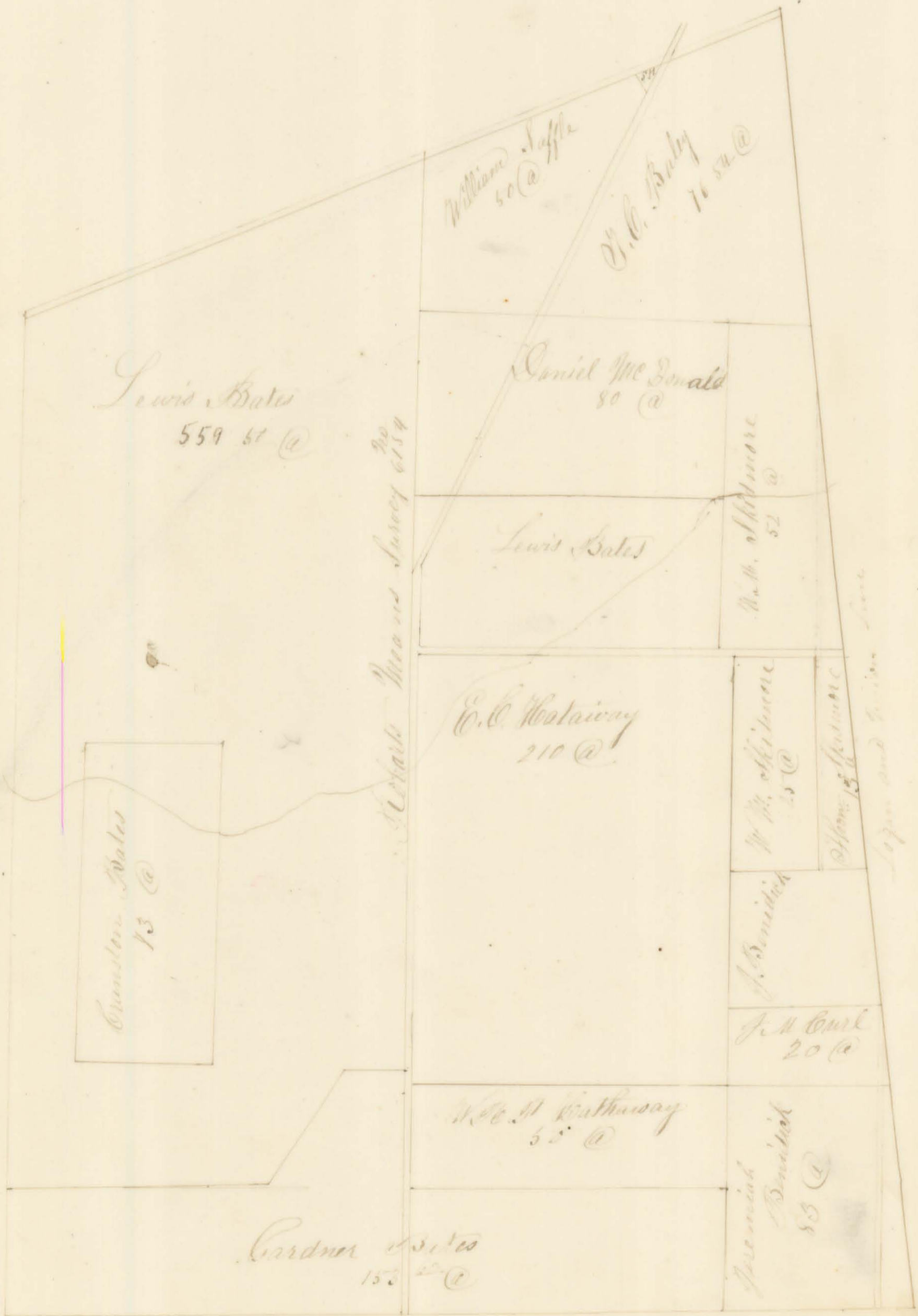

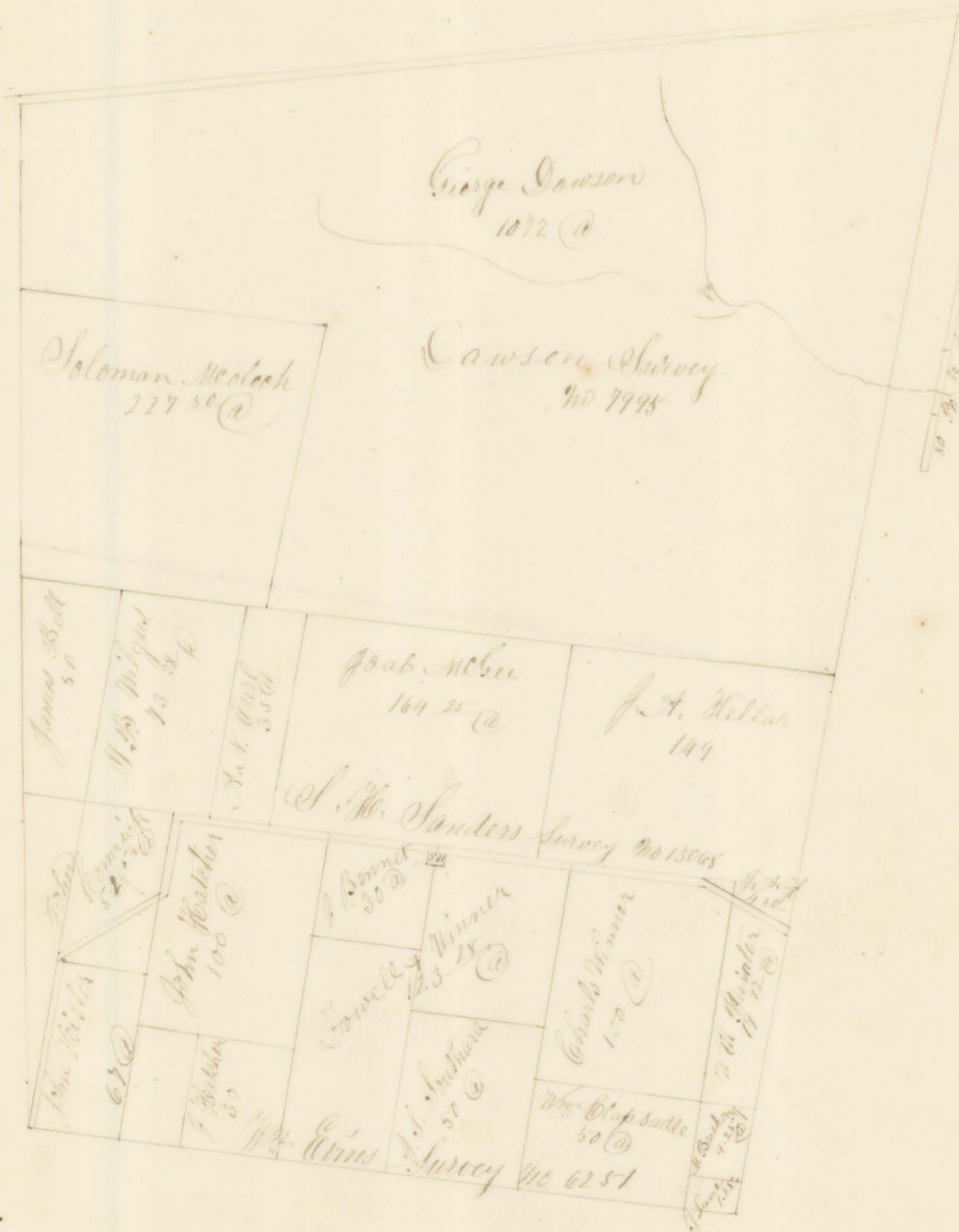

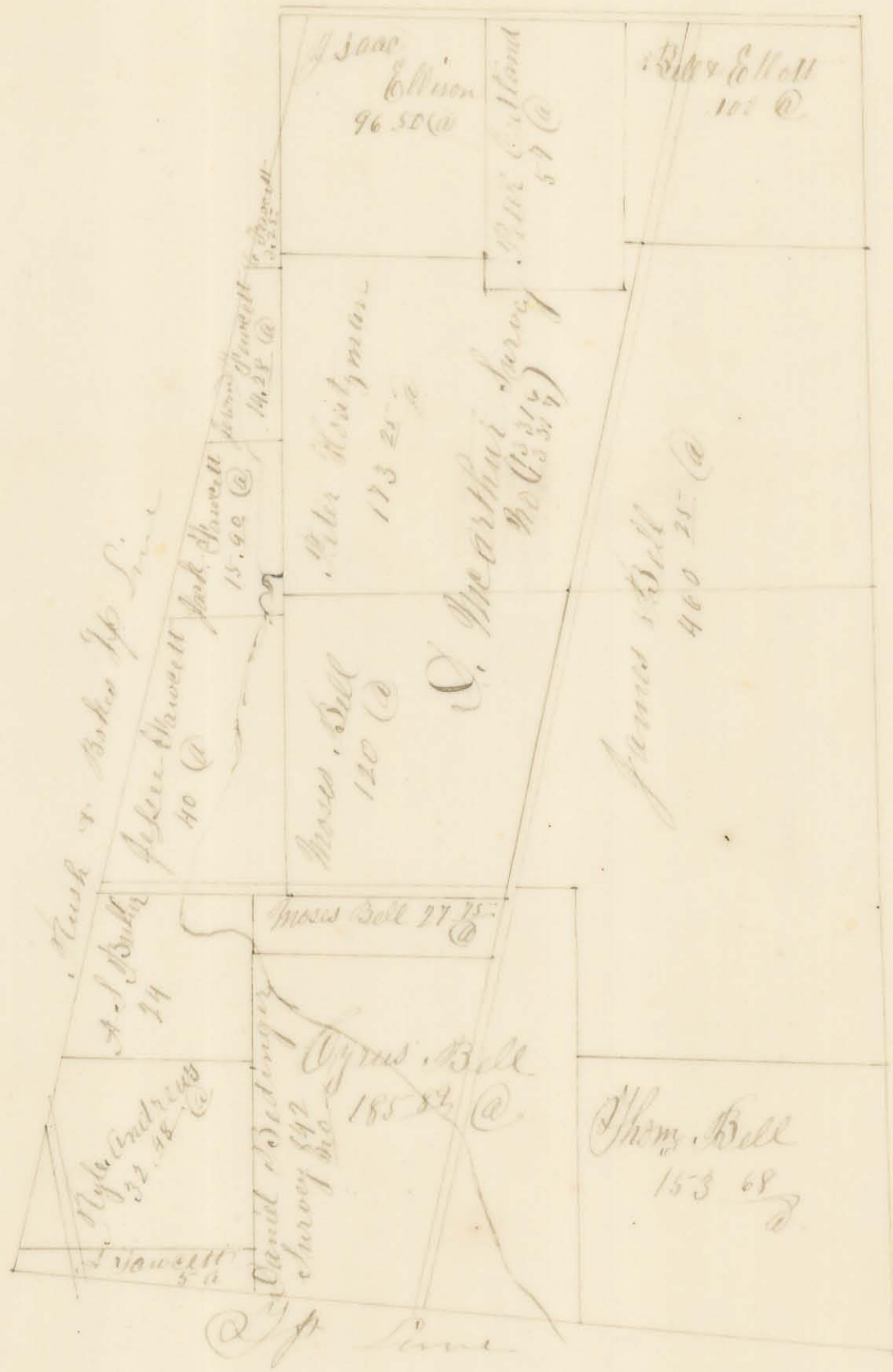

100 00 10 10 10 10