

Fairgrounds Survey for
Filling NE Corner

Party: G. Wilgus E. Lucas N. Kayser
C. Kaysor R. Harms 18 April 1946 B

(3)

F E D C 100'

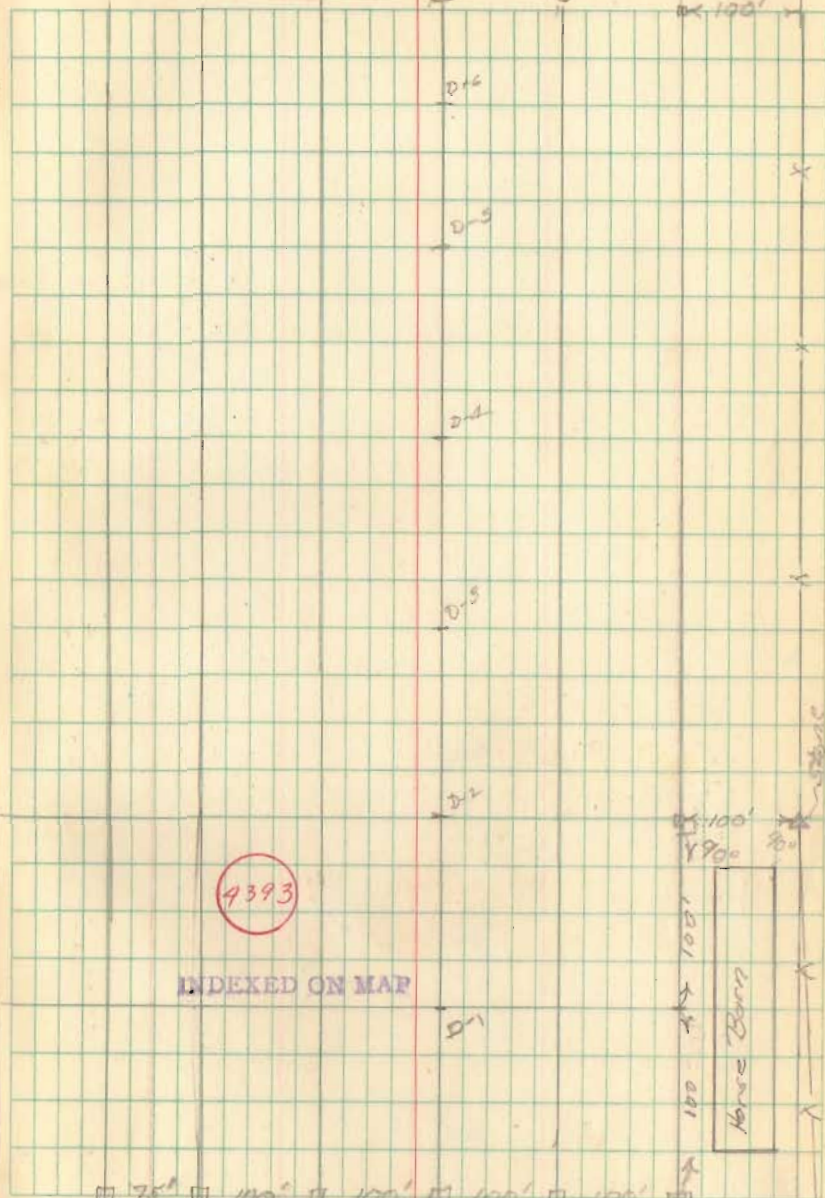

stone Angle

INDEXED ON MAP

75' 100' 100' 100' 100'
F F E C B
re spike
in middle
Hub
- stake

100'
100'
100'
100'
100'
Horse Barn
A

