

PLAT OF
THE
LESTER-POWERS
ADDITION
TO
BELLE CENTER, O.

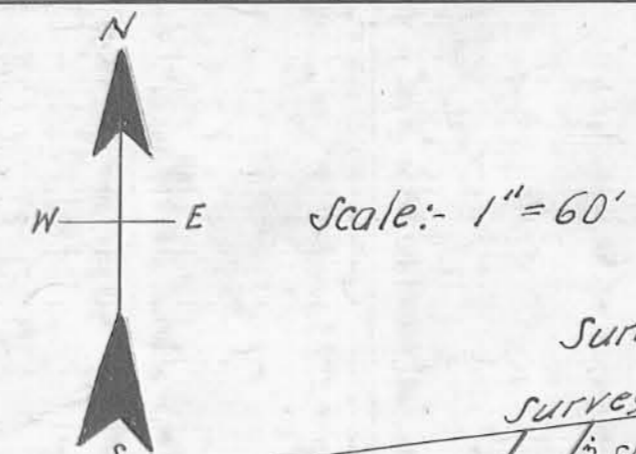

Surveyors Certificate:-
 The annexed plat is a correct representation of the "Lester-Powers Addition" to Belle Center, Ohio, as surveyed and platted by me October 8-9-10-11, 1912. Containing 13.08 Acres
F. W. McKimmon Surveyor.

Dedication:-
 This is to certify that Earl W. Ramsey, owner in trust of the above described property caused the making of the accompanying plat and does hereby dedicate to the public use and convenience for ever the streets and alleys as the same are shown upon said plat.
Earl W. Ramsey Owner in Trust.

Acknowledgement:-
 State of Ohio, Logan County, S.S. - Be it remembered that on the 16th day of October A.D. 1912, before me a Notary Public in and for said County of Logan, personally came Earl W. Ramsey, owner in trust of the "Lester-Powers Addition" as described above and acknowledged the signing and sealing of the same to be his voluntary act and deed for the use and purposes as herein set forth. In testimony whereof I here unto subscribe my name and affix my official seal on the day and date above mentioned.
Earl W. Ramsey
 Notary Public for Logan Co.

Approved & signed by
Earl W. Ramsey
 Daniel J. Hamilton



Acceptance:- The annexed plat was adopted by Resolution as an addition to the village of Belle Center, State of Ohio. Said Resolution was passed by the Council at a regular meeting on the 16th day of October A.D. 1912.
Joseph H. Dennis Mayor
H. A. Sieder President of Council
H. A. Sieder Clerk

Auditors Office Bellefontaine Ohio:-
 The within Lots transferred this 16th day of October A.D. 1912.
J. S. Van Keiser Auditor Logan Co, Ohio

Recorders Office, Bellefontaine Ohio.
 Received for record at 10⁴⁵ o'clock P.M., October 16th A.D. 1912
 Recorded November 16th A.D. 1912.
Henry J. Kemper Recorder Logan Co., Ohio

