

DENVER L. SHAFFER
208 AC.
O.R. VOL. 70 PAGE 949

WILLIAM M. REED
3.30 AC.
O.R. VOL 106 PAGE 271

THE ACCOMPANYING PLAT REPRESENTS A SUBDIVISION OF LAND IN SECTION 36, TOWN 6 SOUTH, RANGE 8 EAST, IN THE VILLAGE OF RUSSELLS POINT, WASHINGTON TOWNSHIP, LOGAN COUNTY, OHIO.

THIS TRACT HAS AN AREA OF 1.177 ACRES OF WHICH 0.262 ACRE IS IN WILGUS COURT AND 0.915 ACRE IS IN LOTS.

ALL MEASUREMENTS ARE IN FEET AND DECIMALS OF A FOOT.

I HEREBY CERTIFY THAT THE ACCOMPANYING PLAT IS A CORRECT REPRESENTATION OF WILGUS ADDITION AS SURVEYED JUNE 15, 1990 AND THAT ALL IRON BARS AS SHOWN HEREON HAVE BEEN OR WILL BE SET.

Stacie H. Mueller
REGISTERED SURVEYOR NO. 5248
DATED 7/5/90



PLAT OF WILGUS ADDITION
RUSSELLS POINT, OHIO
SECTION 36, TOWN 6 SOUTH, RANGE 8 EAST
WASHINGTON TOWNSHIP
LOGAN COUNTY, OHIO

SCALE: 1" = 30'

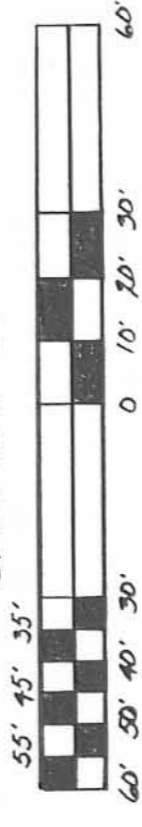

LEGEND:
■ - CAP AND NAIL SET
● - 3/8 INCH IRON BAR SET
○ - 3/8 INCH IRON BAR FOUND

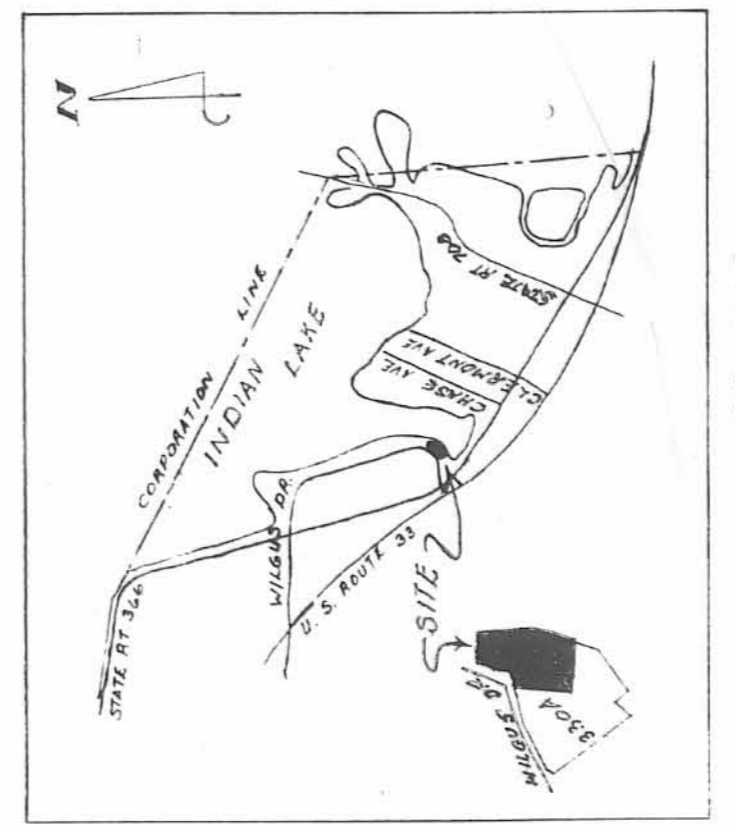

KNOW ALL MEN BY THESE PRESENTS THAT WILLIAM M. REED, PROPRIETOR OF THE LAND INDICATED ON THE ACCOMPANYING PLAT, HAS AUTHORIZED THE PLATTING THEREOF AND DOES HEREBY CERTIFY SAME AND DEDICATE WILGUS COURT TO THE PUBLIC USE FOREVER.

William M. Reed
PROPRIETOR

STATE OF OHIO
COUNTY OF LOGAN

BEFORE ME, A NOTARY PUBLIC IN AND FOR SAID COUNTY PERSONALLY CAME WILLIAM M. REED WHO ACKNOWLEDGED THE SIGNING OF THE FOREGOING INSTRUMENT TO BE HIS VOLUNTARY ACT AND DEED FOR THE USES AND PURPOSES THEREIN EXPRESSED.

IN WITNESS WHEREOF, I HAVE HEREUNTO SET BY HAND AND AFFIXED MY OFFICIAL SEAL THIS 17th DAY OF August, 1990.

My Comm. Expires 5/6/93 BY *Anna L. Ethelbrink*
NOTARY PUBLIC

APPROVED THIS 17th DAY OF August, 1990.

APPROVED THIS 17th DAY OF August, 1990.

APPROVED THIS 17th DAY OF August, 1990.

APPROVED THIS 17th DAY OF August, 1990.

PLAT PRE-APPROVAL JCH 7-17-90

APPROVED THIS 21st DAY OF August, 1990.

APPROVED THIS 10th DAY OF August, 1990.

TRANSFERRED THIS 27th DAY OF August, 1990.

RECORDED THIS 27th DAY OF August, 1990 IN CABINET A

SLIDE 721-B @ 10:44 A.M.

FILE NO. 721-B

DESCRIPTION

BEGINNING AT A P. K. NAIL SET AT THE SOUTHWEST CORNER OF LOT 46-82 OF INDIAN LAKE RESERVOIR LANDS IN THE EAST LINE OF WILGUS DRIVE.

THENCE WITH THE SOUTH LINE OF SAID LOT 46-82 S. 83° 17' 12" E.

105.98 FEET TO A POINT, PASSING A 5/8 INCH IRON BAR SET AT 95.98 FEET.

THENCE S. 2° 17' 11" W. 45.37 FEET TO A POINT.

THENCE S. 3° 26' 00" W. 46.75 FEET TO A POINT.

THENCE S. 4° 35' 07" W. 92.90 FEET TO A POINT.

THENCE S. 20° 42' 42" W. 133.53 FEET TO A POINT.

THENCE N. 83° 17' 12" W. 114.98 FEET TO A 5/8 INCH IRON BAR SET AT THE SOUTHEAST CORNER OF A 50.00 FOOT WILGUS COURT, PASSING A 5/8 INCH IRON BAR SET AT 10.00 FEET.

THENCE WITH THE SOUTH LINE OF SAID WILGUS COURT N. 79° 30' 00" W.

50.00 FEET TO A 5/8 INCH IRON BAR SET.

THENCE WITH THE WEST LINE OF SAID WILGUS COURT N. 10° 30' 00" E.

219.32 FEET TO A 5/8 INCH IRON BAR SET IN THE SOUTH LINE OF WILGUS DRIVE.

THENCE WITH SAID SOUTH LINE N. 81° 00' 55" E. 53.03 FEET TO A 5/8 INCH IRON BAR FOUND AT THE SOUTHWEST CORNER OF OLD LOT 46-81A.

THENCE WITH THE EAST LINE OF SAID WILGUS DRIVE N. 14° 20' 56" E.

45.15 FEET TO A 5/8 INCH IRON BAR FOUND.

THENCE N. 23° 33' 16" E. 34.56 FEET TO THE PLACE OF BEGINNING.

CONTAINING 1.177 ACRES MORE OR LESS OF WHICH 0.232 ACRE IS IN OLD LOTS 46-81 AND 46-81A, 0.683 ACRE IS IN LOTS AND 0.262 ACRE IS IN THE RIGHT-OF-WAY OF WILGUS COURT.

326984
RECORDED THIS 27th DAY OF August, 1990 IN CABINET A
SLIDE 721-B @ 10:44 A.M.
FILE NO. 721-B

TRANSFERRED THIS 27th DAY OF August, 1990.

APPROVED THIS 10th DAY OF August, 1990.

APPROVED THIS 21st DAY OF August, 1990.

PLAT PRE-APPROVAL JCH 7-17-90

APPROVED THIS 17th DAY OF August, 1990.

APPROVED THIS 17th DAY OF August, 1990.

APPROVED THIS 17th DAY OF August, 1990.

IN WITNESS WHEREOF, I HAVE HEREUNTO SET BY HAND AND AFFIXED MY OFFICIAL SEAL THIS 17th DAY OF August, 1990.

BEFORE ME, A NOTARY PUBLIC IN AND FOR SAID COUNTY PERSONALLY CAME WILLIAM M. REED WHO ACKNOWLEDGED THE SIGNING OF THE FOREGOING INSTRUMENT TO BE HIS VOLUNTARY ACT AND DEED FOR THE USES AND PURPOSES THEREIN EXPRESSED.

STATE OF OHIO
COUNTY OF LOGAN

KNOW ALL MEN BY THESE PRESENTS THAT WILLIAM M. REED, PROPRIETOR OF THE LAND INDICATED ON THE ACCOMPANYING PLAT, HAS AUTHORIZED THE PLATTING THEREOF AND DOES HEREBY CERTIFY SAME AND DEDICATE WILGUS COURT TO THE PUBLIC USE FOREVER.

William M. Reed
PROPRIETOR