

DEPARTMENT OF HIGHWAYS ~ STATE OF OHIO

235 -
 CURVE REALIGNMENT FOR LOG 69-2.24
 REDESIGNED BY S. L. SMITH

Date ~ 5 August 1957
 Scale ~ 1" = 50'

Old Curve Data

PI :: 6+58.15
 Δ :: 57° 50' Rt.
 D :: 20°
 T :: 158.15
 E :: 40.75
 L :: 289.00'
 R :: 286.48'

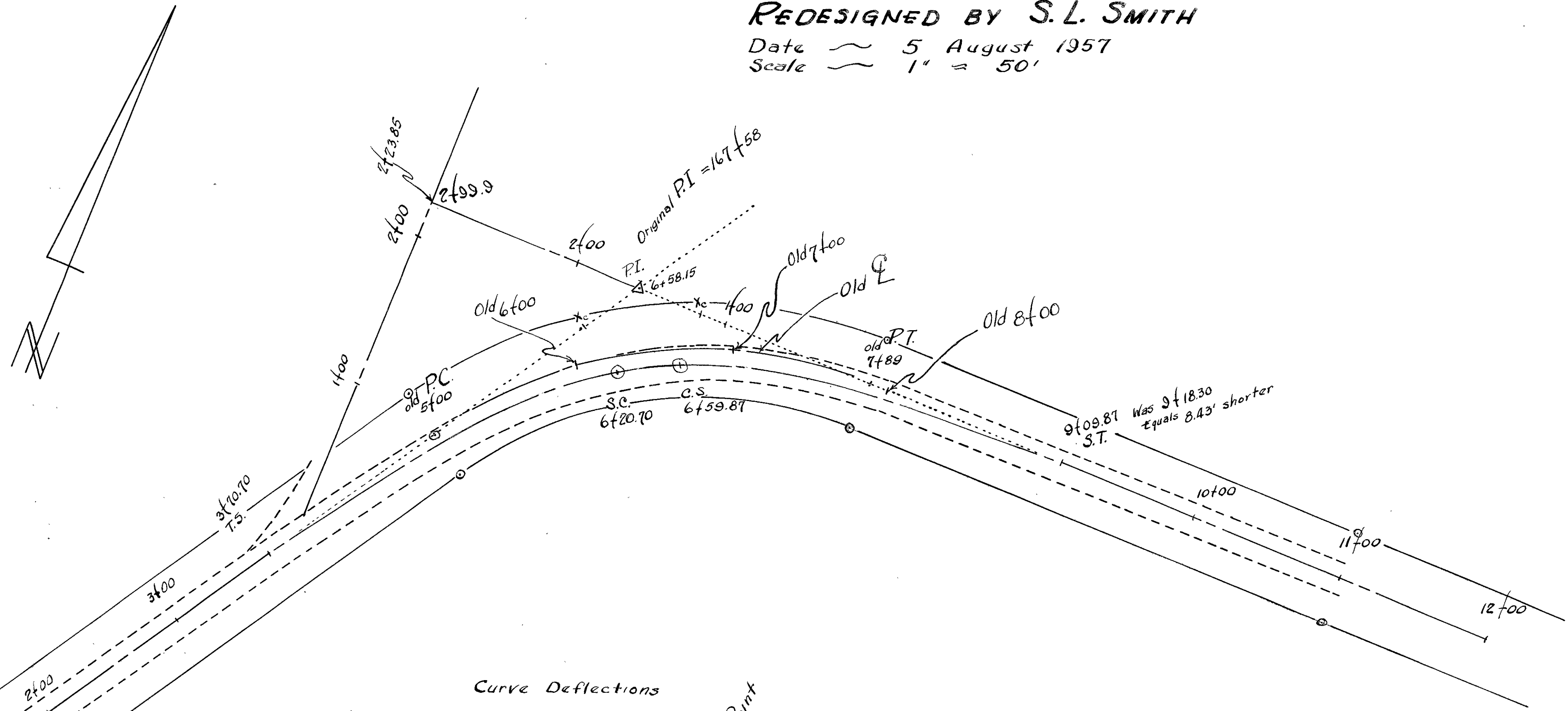

New Curve Data

PI :: 6+58.15
 Δ :: 57° 50' Rt.
 D :: 20°
 L_s :: 250.00'
 T_s :: 287.45'
 E_s :: 51.30'
 θ_s :: 25°
 p :: 9.03'
 k :: 124.21'
 X_c :: 245.28'
 y_c :: 35.87'
 L.T. :: 168.36'
 S.T. :: 84.87'
 L.C. :: 247.89'
 D_c :: 7.8333°
 L_c :: 39.17'

Transit on T.S.

3+70.70 :: 0° 00'
 3+95.70 :: 0° 05.0'
 4+20.70 :: 0° 20.0'
 4+45.70 :: 0° 45.0'
 4+70.70 :: 1° 20.0'
 4+95.70 :: 2° 05.0'
 5+20.70 :: 3° 00.0'
 5+45.70 :: 4° 05.0'
 5+70.70 :: 5° 19.8'
 5+95.70 :: 6° 44.6'
 S.P. 6+20.70 :: 8° 19.2'

Curve Deflections

Transit on S.C.
 S.C. 6+20.70 :: 0° 00'
 6+25.00 :: 0° 25.8'
 6+50.00 :: 2° 55.8'
 C.S. 6+59.87 :: 3° 55.0'

Radius Point

Transit on S.T.
 9+09.87 :: 0° 00'
 8+84.87 :: 0° 05.0'
 8+59.87 :: 0° 20.0'
 8+34.87 :: 0° 45.0'
 8+09.87 :: 1° 20.0'
 7+84.87 :: 2° 05.0'
 7+59.87 :: 3° 00.0'
 7+34.87 :: 4° 05.0'
 7+09.87 :: 5° 19.8'
 6+84.87 :: 6° 44.6'
 C.S. 6+59.87 :: 8° 19.2'

New Superelevation Table		
Station	F. Grade	R. Edge Gr.
3+48.80	103.58	103.41
4+00.70	103.50	103.33
4+95.70	103.41	103.24
5+45.70	103.33	103.16
5+95.70	103.24	103.07
6+45.70	103.15	102.98
6+95.70	103.06	102.89
7+45.70	102.89	102.72
7+95.70	102.80	102.63
8+45.70	102.71	102.54
8+95.70	102.63	102.46
9+45.70	102.54	102.36
9+95.70	102.46	102.26
10+45.70	102.37	102.16
10+95.70	102.28	102.07
11+45.70	102.19	101.98
11+95.70	102.10	101.89
12+45.70	102.01	101.81
12+95.70	101.92	101.72
13+45.70	101.83	101.63
13+95.70	101.74	101.54
14+45.70	101.65	101.46
14+95.70	101.56	101.39

Curve Data 1424
 205 Acc 1950