

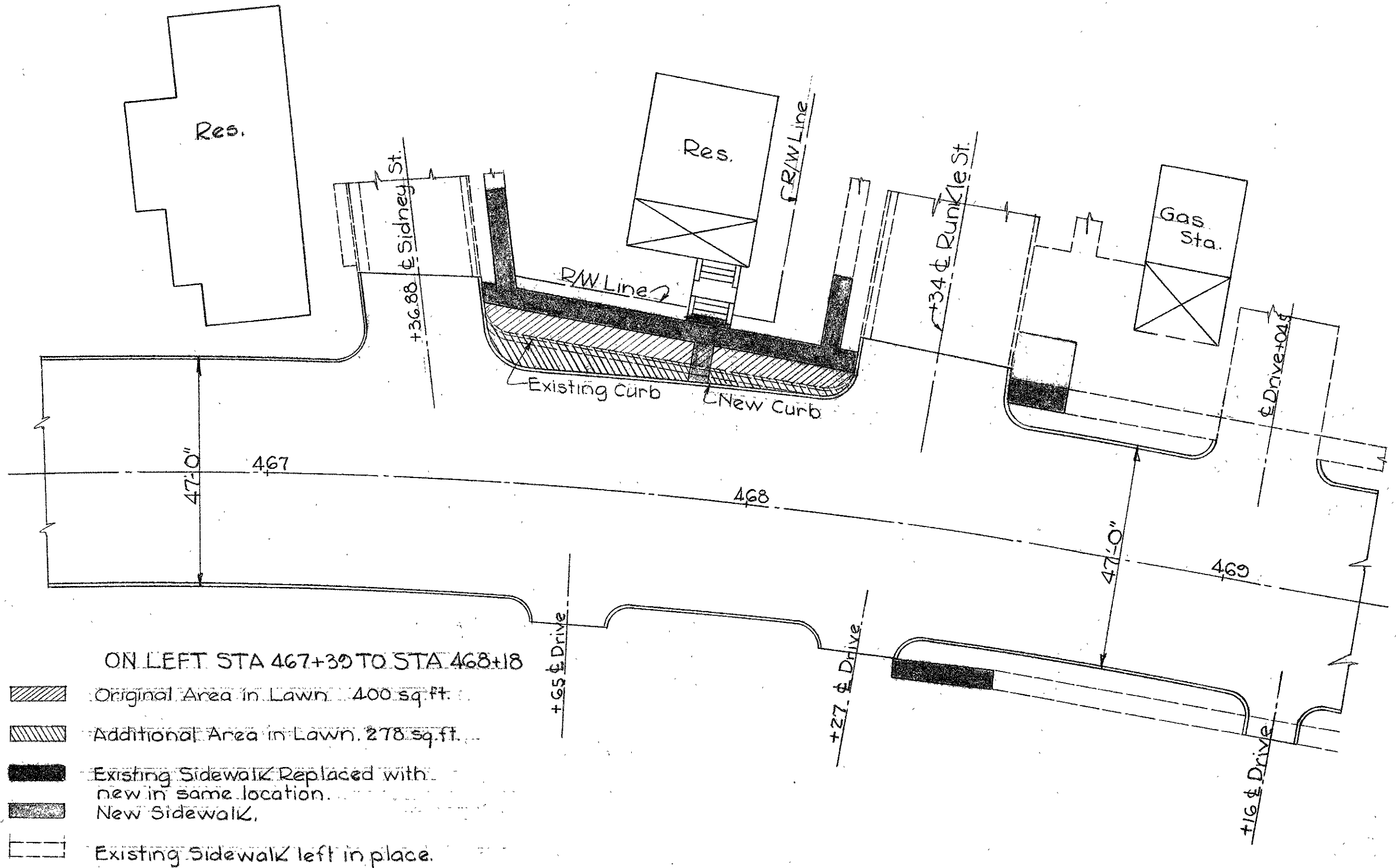

4.5.68

CHAMPAIGN COUNTY
S.H. 180 SEC F
LOGAN COUNTY
S.H. 180 SEC'S G & West Liberty

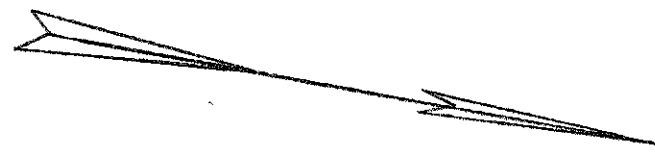
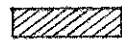
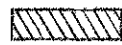

ON LEFT STA 467+39 TO STA 468+18

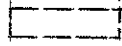
-  Original Area in Lawn 400 sq. ft.
-  Additional Area in Lawn 278 sq. ft.
-  Existing Sidewalk Replaced with new in same location.
-  New Sidewalk.
-  Existing Sidewalk left in place.

CURB & SIDEWALK PLAN FROM STA 467+39
TO STA 468+18 ON LEFT