

Survey of lot 409

Measured east from stake set
at SE \leftarrow lot 410 - 55' for
NE \leftarrow lot 409

Then measured south 31'
from NW \leftarrow lot 410 on west
side lot - Put wig at this
point turn NE \leftarrow $69^{\circ} 19'$
checked angle and distance
55' for stake at NE \leftarrow lot
410 - measured east 55'
from NE \leftarrow lot 410 - set nail
at new this point turn
NE \leftarrow $69^{\circ} 19'$ and measure
south on this line 31' for
NE \leftarrow lot 409

NE \leftarrow lot 409 corner 18'
South of NE \leftarrow corner
NE \leftarrow lot 410 South of

corner
On E West St. 405' from N line
lot 410 produced to intersection
to corner

$15^{\circ} 45'$ Measured angle from
wig at point 55' east of NE \leftarrow lot
410 - line at NE \leftarrow lot 410
to NW \leftarrow lot 410

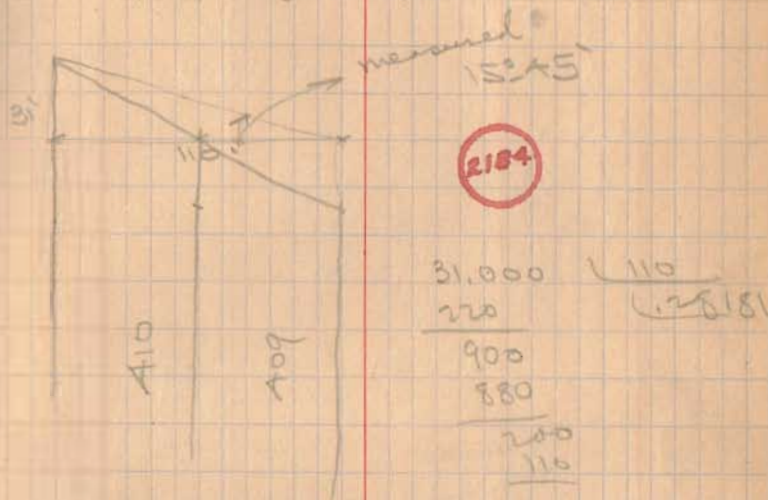

$\tan^{-1} 0.25181 = \text{calculated } 15^{\circ} 44' 3''$

measured west side lot 410
= 229.1' roughly
measured east side lot 409 = 229.90'
roughly

49.50 from ϕ main track T&O C to
my spike on ϕ West measured at
angles to ϕ my
50' from NE \leftarrow to ϕ track