

LEGAL DESCRIPTION
639.170 ACRES TRACT
(NEW TRACT 1 for CROWN CREDIT CO. LTD.)
IN
HARRISON TOWNSHIP, CITY OF BELLEFONTAINE
LOGAN COUNTY, OHIO

Being a 639.170 acres tract, now owned by Crown Credit Co. Ltd., as recorded in Official Record 315, Page 115 of the records of Logan County, and located in the Southeast Quarter of Section 24, the Southwest Quarter of Section 18, the Northeast Quarter of Section 23, and Section 17, all in Town 3, Range 14, Between the Miami Rivers Survey, Harrison Township, partly in the City of Bellefontaine, Logan County, State of Ohio, and being more particularly described as follows:

Beginning at a masonry nail found over a stone on the centerline of Township Road No.46 at Centerline Station 107+03 (Field Book 589, Page 11);

Thence, North 3 degrees 51' 33" East, 2697.50 feet along the centerline of Township Road No.46 and the western line of the City of Bellefontaine Corporation Limits to a 5/8 inch iron pin set on the south line of aforesaid Section 24 and, also, on the north low bank of Bokengehalas Creek, reference the turning point easterly of said corporation line at 1347.53 feet, reference a 5/8 inch iron bolt found at a turning point in the road right-of-way at 2296.23 feet, reference a 5/8 inch iron pin set on the south bank of said creek at 2659.53 feet and, also, reference a 5/8 inch iron pin set on the north high bank of said creek North 3 degrees 51' 33" East, 50.00 feet;

Thence, North 86 degrees 26' 58" West, 1348.09 feet along the south line of said Section 24, and the north line of a 149.62 acres tract now owned by Nevin Russell Smith, Trustee and Peggy A. Smith, Trustee (Official Record 236, Page 230 & Official Record 236, Page 226) to a 15 inch concrete corner post found, reference the centerline of Township Road No.46 at 38.02 feet;

Thence, North 3 degrees 55' 00" East, 2051.78 feet along the east lines of a 79.95 acres tract now owned by James R. Skeen et ux (Deed Volume 401, Page 820) and a 42.43 acres tract now owned by Ronald E. Furrow et al (Deed Volume 390, Page 673), to a 5/8 inch iron pin found at a corner of said 42.43 acres tract, reference a 15 inch concrete corner post found on the northerly line of a former railroad property at 550.00 feet, and a stone found with a cross cut on top at the northeasterly corner of said 79.95 acres tract at 1350.86 feet;

Thence, with a south line of said 42.43 acres tract and the south lines of a 3.76 acres tract now owned by David A. Bechtel et al (Deed Volume 407, Page 992) and a 15.613 acres tract now owned by Ronald E. Hadley et al (Official Record 182, Page 441), South 86 degrees 21' 33" East, 2689.28 feet to a 3/8 inch iron pin in concrete found on the west line of aforesaid Section 18 and, also, at the southwest corner of a 7.09 acres tract now owned by Edward L. Bailey et ux (Deed Volume 391, Page 760), reference a 5/8 inch iron pin set on the west right-of-way line of Township Road No.46 at 1625.16 feet, reference a 1 inch iron pipe found on the centerline of Township Road No.46 at 1645.16 feet and, also, reference a 5/8 inch iron pin set on the east right-of-way line of Township Road No.46 at 1665.16 feet;

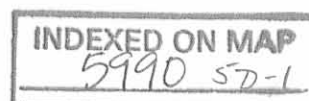

Thence, South 86 degrees 56' 40" East, 592.16 feet along the south line of said 7.09 acres tract to a point in the center of Bokengehalas Creek, reference a 5/8 inch iron pin set on the easterly bank of said creek South 86 degrees 56' 40" East, 50.00 feet;

Thence, North 18 degrees 12' 40" West, 213.07 feet along the center of Bokengehalas Creek and the easterly line of said 7.09 acres tract to a point;

Thence, North 12 degrees 16' 28" West, 456.53 feet along the center of Bokengehalas Creek and the easterly line of said 7.09 acres tract to a masonry nail set on a bridge, on the centerline of County Road No.13 and, also, being on the north line of the Southwest Quarter of aforesaid Section 18;

Thence, South 85 degrees 17' 36" East, 2307.48 feet along the centerline of County Road No.13 and the north line of said Southwest Quarter of Section 18 to a masonry nail found at the northeast corner of said Southwest Quarter of Section 18;

Thence, South 4 degrees 30' 22" West, 2679.91 feet along the east line of said Southwest Quarter of Section 18 and the west line of a 166.0 acres tract now owned by Mac-O-Cheek Inc. (Official Record 159, Page 97, Tract VII) to an 8 inch concrete corner post found at the southeast corner of said Southwest Quarter of Section 18, reference a 15 inch concrete corner post found at 30.05 feet;

Thence, South 85 degrees 46' 59" East, 2714.08 feet along the north line of the Northeast Quarter of aforesaid Section 17 to an 8 inch concrete corner post found, said corner post being common to Sections 11, 12, 17 and 18;

Thence, South 4 degrees 17' 53" West, 935.70 feet along the east line of the Northeast Quarter of said Section 17 and, also, the City of Bellefontaine Corporation Line to a 5/8 inch iron pin found;

Thence, South 69 degrees 00' 03" West, 5927.18 feet along the north line of a 268.030 acres tract now owned by the City of Bellefontaine (Official Record 382, Page 241); municipal airport property; to a 5/8 inch iron pin set, reference an angle point in the City of Bellefontaine Corporation Line at 993.86 feet;

Thence, North 4 degrees 06' 21' East, 757.39 feet along the east line of a 90.000 acres tract now owned by Carol Skeen etal (Deed Volume 401, Page 13) to an 8 inch wood corner post found;

Thence, North 85 degrees 57' 43" West, 1337.50 feet along the north line of said 90.000 acres tract to the point of beginning, reference an 8 inch wood corner post found at 1316.46 feet.

Containing 639.170 acres, more or less, including 2.996 acres, more or less, in the right-of-way of Township Road No.46, and 1.601 acres, more or less, in the right-of-way of County Road No.13 and 149.142 acres, more or less, within the City of Bellefontaine Corporation Limits.

Subject to all easements, rights-of-way and restrictions of record.

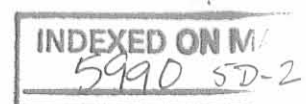

The above tract is part of the Crown Credit Company Ltd. 294.85 acres tract and 323.03 acres tract (Parcel Four, Tracts I & II), all of the remainder of the 18.49 acres tract (Parcel 7), and all of the 79.99 acres tract, the 122.72 acres tract, the 146.12 acres tract and the 12.29 acres tract (Parcel 4, Tracts III, IV, V and Parcel 9), as described in Official Record 315, Page 115.

The starting bearing, North 3 degrees 51' 33" East, is based on the south line of the Southwest Quarter of Section 17, which is North 86 degrees 00' 40" West, an assumed meridian used only to denote angles.

The above description prepared by Michael R. Holt, Registered Surveyor No.7108, of Freytag & Associates, Inc., Architects/Engineers, 226 North Miami Avenue, Sidney, Ohio 45365, on August 17, 2004, from field measurements and existing surveys. A copy of the Retracement Survey is on file in the Logan County Engineer's office (Tax Map office).

Michael R. Holt
8-17-04

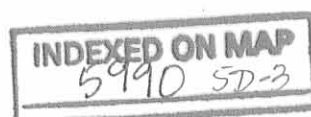

**LEGAL DESCRIPTION
68.353 ACRES TRACT
(NEW TRACT 2 for CROWN CREDIT CO. LTD.)
IN
HARRISON TOWNSHIP, CITY OF BELLEFONTAINE
LOGAN COUNTY, OHIO**

Being a 68.353 acres tract, now owned by Crown Credit Co. Ltd., as recorded in Official Record 315, Page 115 of the records of Logan County, and located in the south part of the Southwest Quarter and the southwest part of the Southeast Quarter of Section 17, Town 3, Range 14, Between the Miami Rivers Survey, Harrison Township, City of Bellefontaine, Logan County, State of Ohio, and being more particularly described as follows:

Beginning at a 1 inch iron bar found at the southwest corner of said Section 17, said iron pin being on the centerline of State Route No.47;

Thence, North 3 degrees 59' 15" East, 492.45 feet along the west line of the Southwest Quarter of said Section 17 and an east line of a 268.030 acres tract now owned by the City of Bellefontaine (municipal airport), as recorded in Official Record 382, Page 241, to a 5/8 inch iron pin set, reference a 5/8 inch iron pin found on the north right-of-way line of State Route No.47 at 30.00 feet;

Thence, South 86 degrees 00' 58" East, 1092.01 feet along a south line of said 268.030 acres tract to a 5/8 inch iron pin found;

Thence, North 69 degrees 00' 03" East, 2594.31 feet along a south line of said 268.030 acres tract to a 5/8 inch iron pin set;

Thence, South 4 degrees 11' 10" West, 1527.08 feet along a west line of said 268.030 acres tract (also, the west line of an access road to the municipal airport) to a 5/8 inch iron pin set;

Thence, southwesterly along a curve to the right, 38.96 feet to a 5/8 inch iron pin set on the north right-of-way line of State Route No.47, said curve having a delta angle of 89 degrees 18' 03", a radius of 25.00 feet and a chord bearing South 48 degrees 50' 12" West, 35.14 feet;

Thence, South 86 degrees 30' 47" East, 24.70 feet along the north right-of-way line of State Route No.47 to a 5/8 inch iron pin set;

Thence, South 4 degrees 11' 10" West, 30.00 feet to a masonry nail found on the south line of the Southeast Quarter of aforesaid Section 17 and, also, the centerline of State Route No.47;

Thence, North 86 degrees 30' 47" West, 763.98 feet along the south line of the Southeast Quarter of said Section 17, the centerline of State Route No.47 and with the City of Bellefontaine Corporation Line to a 1 inch iron bar found at the quarter section corner;

Thence, North 86 degrees 00' 40" West, 2674.08 feet along the south line of the Southwest Quarter of said Section 17, the centerline of State Route No.47 and with said corporation line to the point of beginning.

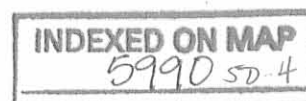

Containing 68.353 acres, more or less, including 2.368 acres, more or less, in the right-of-way of State Route No.47.

Subject to all easements, rights-of-way and restrictions of record.

The above tract is a part of, the Crown Credit Company Ltd. 323.03 acres tract (Parcel Four, Tract II) and 76.66 acres tract (Parcel Five), as described in Official Record 315, Page 115.

The starting bearing, North 3 degrees 59' 15" East, is based on the south line of the Southwest Quarter of Section 17, which is North 86 degrees 00' 40" West, an assumed meridian used only to denote angles.

The above description prepared by Michael R. Holt, Registered Surveyor No.7108, of Freytag & Associates, Inc., Architects/Engineers, 226 North Miami Avenue, Sidney, Ohio 45365, on August 17, 2004, from field measurements and existing surveys. A copy of the Retracement Survey is on file in the Logan County Engineer's office (Tax Map office).

Michael R. Holt
8.17.04

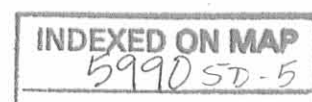

REC'D 8-23-04 S.M.O.K.

**LEGAL DESCRIPTION
82.374 ACRES TRACT
(NEW TRACT 3 for CROWN CREDIT CO. LTD.)
IN
HARRISON TOWNSHIP, CITY OF BELLEFONTAINE
LOGAN COUNTY, OHIO**

Being a 82.374 acres tract, now owned by Crown Credit Co. Ltd., as recorded in Official Record 315, Page 115 of the records of Logan County, and located in the Southeast Quarter of Section 17 and the west part of the Southwest Quarter of Section 11, both in Town 3, Range 14, Between the Miami Rivers Survey, Harrison Township, City of Bellefontaine, Logan County, State of Ohio, and being more particularly described as follows:

Commencing at a 1 inch iron bar found at the southwest corner of the Southeast Quarter of said Section 17, said iron bar being on the centerline of State Route No.47;

Thence, South 86 degrees 30' 47" East, 823.98 feet along the south line of said Southeast Quarter of Section 17 and the centerline of State Route No.47 to a 1 inch iron bar found at the southwest corner of a 2.34 acres tract now owned by Bruce M. Gates, etal (Official Record 519, Page 945);

Thence, North 4 degrees 11' 10" East, 314.00 feet along the west line of said 2.34 acres tract and an east line of a 268.030 acres tract now owned by the City of Bellefontaine (Official Record 382, Page 241) also, the east line of the access drive to the municipal airport, to a 1 inch iron pipe found, said iron pipe being the point of beginning of the herein described tract;

Thence, North 4 degrees 11' 10" East, 1295.26 feet along an east line of said 268.030 acres tract (also, the east line of the access drive to the municipal airport) to a 5/8 inch iron pin found;

Thence, North 69 degrees 00' 03" East, 2052.92 feet along the southerly line of said 268.030 acres tract to a 5/8 inch iron pin found on the east line of the aforesaid Southeast Quarter of Section 17;

Thence, North 4 degrees 27' 44" East, 203.27 feet along the east line of said Southeast Quarter of Section 17 and, also, an east line of said 268.030 acres tract to a 3/8 inch pin in concrete found at the northeast corner of said Southeast Quarter of Section 17;

Thence, South 85 degrees 39' 54" East, 24.50 feet along a south line of said 268.030 acres tract to a 5/8 inch iron pin found at the northwest corner of an 80.002 acres tract now owned by Crown Credit Co. Ltd. (Official Record 315, Page 115, Parcel 3);

Thence, South 4 degrees 27' 44" West, 2663.80 feet along the west line of said 80.002 acres tract and, also, on the City of Bellefontaine Corporation Line, to a R.R. Spike found on the south line of aforesaid Southwest Quarter of Section 11 and on the centerline of State Route No.47, reference a 5/8 inch iron pin found on the north right-of-way line of State Route No.47 at 2633.80 feet;

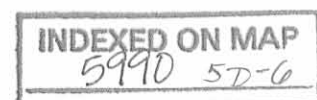

Thence, North 85 degrees 16' 47" West, 24.50 feet along the south line of said Southwest Quarter of Section 11, the centerline of State Route No.47 and with said corporation line to a 1 inch iron pin found at the southeast corner of aforesaid Southeast Quarter of Section 17 and, also, the southeast corner of a 1.14 acres tract now owned by Bonnie Jean Watt, Trustee (Official Record 396, Page 765);

Thence, North 4 degrees 27' 44" East, 530.31 feet along the east lines of said 1.14 acres tract and a 1.00 acre tract now owned by SaraBel Youtsey (Official Record 655, Page 529) and with said corporation line to a 3/8 inch iron pin in concrete found at the northeast corner of said 1.00 acre tract;

Thence; North 86 degrees 20' 22" West, 158.23 feet along the north line of said 1.00 acre tract and with said corporation line to a 3/8 inch iron pin in concrete found at the northwest corner of said 1.00 acre tract;

Thence, South 3 degrees 38' 42" West, 295.41 feet along the west line of said 1.00 acre tract and with said corporation line to a 3/8 inch iron pin in concrete found on the north line of aforesaid 1.14 acres tract;

Thence, North 86 degrees 20' 24" West, 61.15 feet along the north line of said 1.14 acres tract and with said corporation line to a 3/8 inch iron pin in concrete found at the northwest corner of said 1.14 acres tract;

Thence, South 3 degrees 39' 42" West, 236.00 feet along the west line of said 1.14 acres tract and with said corporation line to a masonry nail set on the south line of aforesaid Southeast Quarter of Section 17 and the centerline of State Route No.47, reference a 3/8 inch iron pin in concrete found on the north right-of-way line of State Route No.47 at 206.00 feet;

Thence, North 86 degrees 30' 47" West, 1123.13 feet along the south line of said Southeast Quarter of Section 17, the centerline of State Route No.47 and with said corporation line to a 1 inch axle found at the southeast corner of a 1.00 acre tract now owned by Marion F. Parmer etal (Official Record 389, Page 225);

Thence, North 4 degrees 07' 38" East, 236.70 feet along the east line of said 1.00 acre tract and with said corporation line to a 5/8 inch iron pin set (buried 12 inches in cultivated field, approximately 8 feet north of a wire fence) at the northeast corner of said 1.00 acre tract, reference a 5/8 inch iron pin found (bent over) on the north right-of-way line of State Route No.47 at 30.00 feet;

Thence, North 86 degrees 30' 47' West, 185.98 feet along the north line of said 1.00 acre tract and with said corporation line to a 5/8 inch iron pin found at the northwest corner of said 1.00 acre tract and on the east line of aforesaid 2.34 acres tract;

Thence, North 4 degrees 15' 48" East, 77.30 feet along the east line of said 2.34 acres tract and with said corporation line to a 5/8 inch iron pin found;

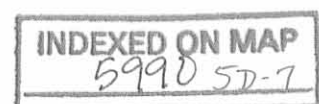

Thence, North 86 degrees 30' 47' West, 324.91 feet along the north line of said 2.34 acres tract and with said corporation line to the point of beginning.

Containing 82.374 acres, more or less, including 0.790 acres, more or less, in the right-of-way of State Route No.47.

Subject to all easements, rights-of-way and restrictions of record.

The above tract is part of the Crown Credit Company Ltd. 294.85 acres tract (Parcel Four, Tract I) and 76.66 acres tract (Parcel Five), as described in Official Record 315, Page 115.

The starting bearing, South 86 degrees 30' 47" East, is based on the south line of the Southeast Quarter of Section 17, an assumed meridian used only to denote angles.

The above description prepared by Michael R. Holt, Registered Surveyor No.7108, of Freytag & Associates, Inc., Architects/Engineers, 226 North Miami Avenue, Sidney, Ohio 45365, on August 17, 2004, from field measurements and existing surveys. A copy of the Retracement Survey is on file in the Logan County Engineer's office (Tax Map office).

Michael R. Holt

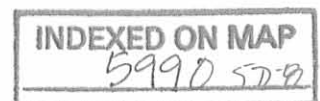

RETRACEMENT SURVEY

FOR
CROWN CREDIT COMPANY LTD.
40 SOUTH WASHINGTON STREET
NEW BREMEN, OHIO 45869

IN
SECTIONS 11, 17, 18, 23 & 24, TOWN 3, RANGE 14,
BETWEEN THE MIAMI RIVERS SURVEY
HARRISON TOWNSHIP CITY OF BELLEFONTAINE
LOGAN COUNTY STATE OF OHIO

BY
MICHAEL R. HOLT REGISTERED SURVEYOR No. 7108
FREYTAG & ASSOCIATES, INC. ARCHITECTS / ENGINEERS
226 NORTH MIAMI AVENUE P.O. BOX 220
SIDNEY, OHIO 45365 937-492-6983

AUGUST 2004

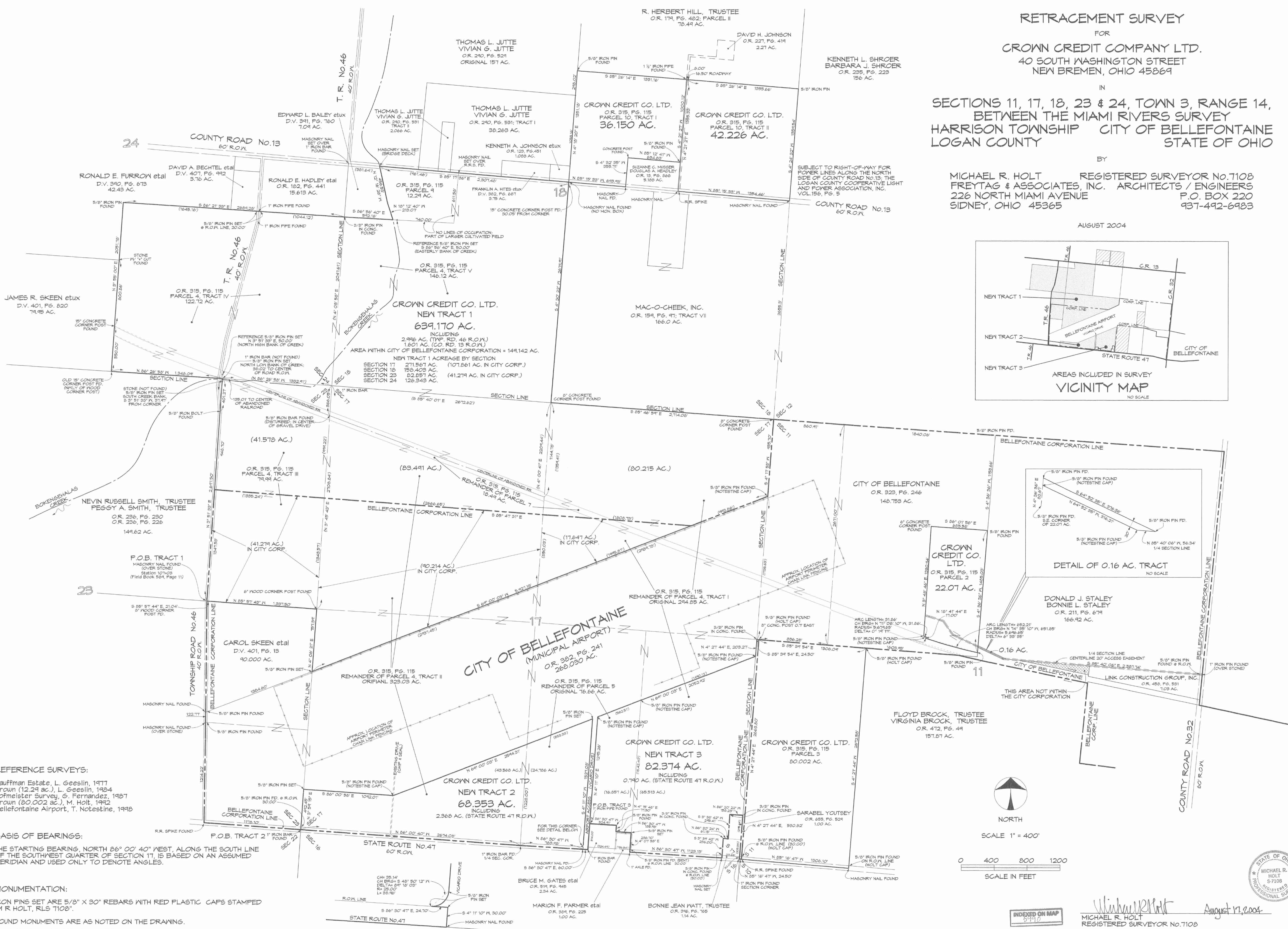
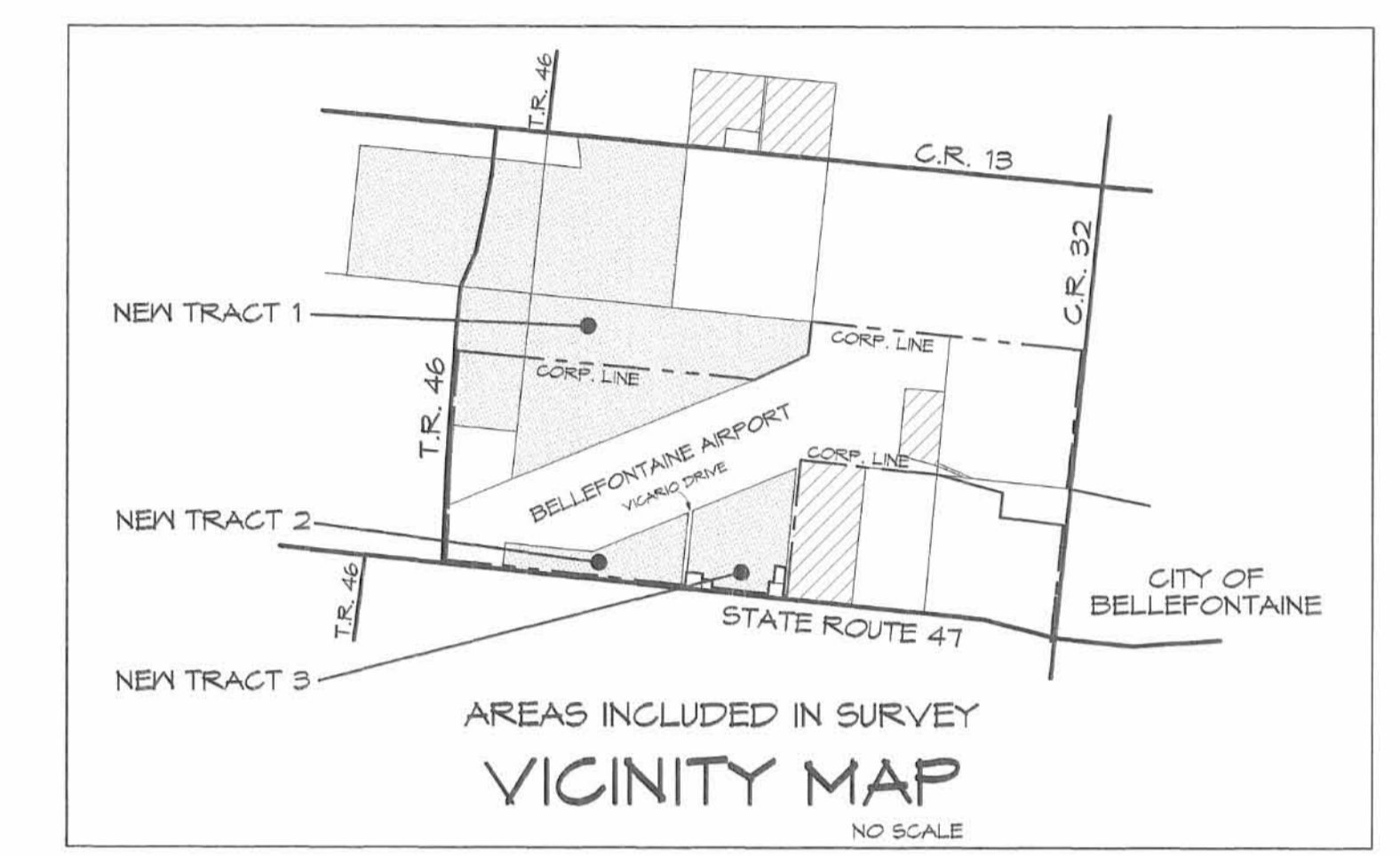

REFERENCE SURVEYS:
Kauffman Estate, L. Geeslin, 1977
Crown (12.24 ac.), L. Geeslin, 1984
Hofmeister Survey, G. Fernandez, 1987
Crown (80.002 ac.), M. Holt, 1992
Bellefontaine Airport, T. Notestine, 1998

BASIS OF BEARINGS:
THE STARTING BEARING, NORTH 86° 00' 40" WEST, ALONG THE SOUTH LINE OF THE SOUTHWEST QUARTER OF SECTION 17, IS BASED ON AN ASSUMED MERIDIAN AND USED ONLY TO DENOTE ANGLES.

MONUMENTATION:
IRON PINS SET ARE 5/8" X 30" REBARS WITH RED PLASTIC CAPS STAMPED "M R HOLT, RLS 7108".
FOUND MONUMENTS ARE AS NOTED ON THE DRAWING.

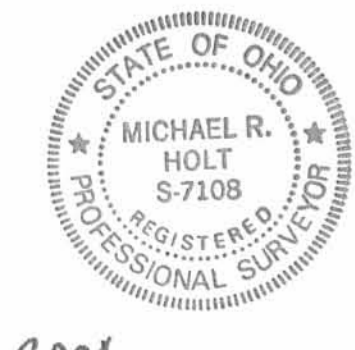
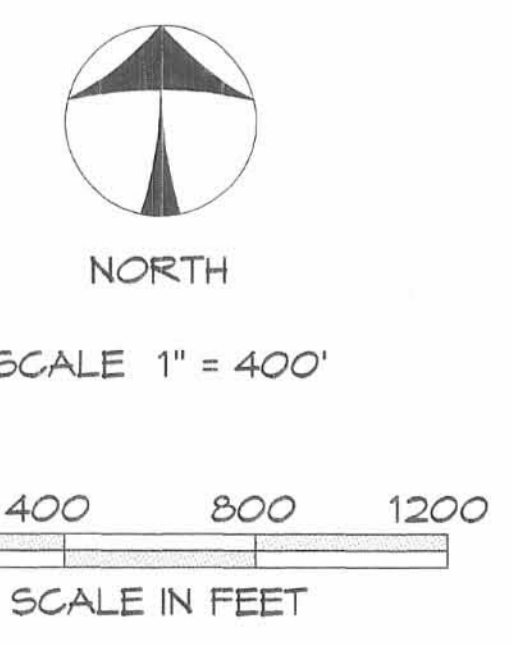

Michael R. Holt
MICHAEL R. HOLT
REGISTERED SURVEYOR No. 7108
August 17, 2004