

Received 7-22-02 OKGMH

WILLIAMS AVENUE (50')

N 78° 41' 32" E
60.43'

LOT 1694
LOT 1693

LEGEND
○ 1/2 INCH IRON ROD FOUND
● 5/8 INCH IRON ROD SET

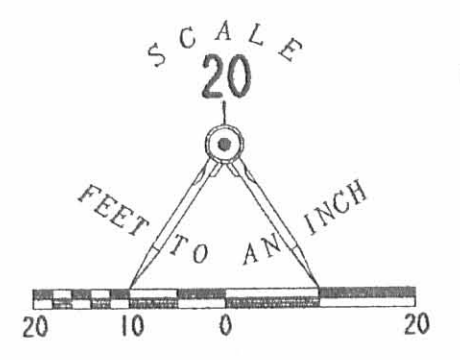

RANDALL L. LONGENECKER
AND MARLA J. LONGENECKER
LOT 2936 AND 2937
VOL. 399. PG. 57

VALERIE SUE KERNS
PART OF LOT 1692 & 1693
O.R. 456. PG. 642

RETRACEMENT SURVEY OF THE
MATTHEW D. YOUNG LOT 1694 & PART OF LOT 1693
OF THE STANTON-CAMPBELL ADDITION
PLAT CABINET A. SLIDE 27
CITY OF BELLEFONTAINE
LAKE TOWNSHIP
LOGAN COUNTY, OHIO

VACATED ALLEY (10')

MATTHEW D. YOUNG
AND ROBERTA LEE YOUNG
LOT 1694 AND PART OF 1693
O.R. 550. PG. 893

156.02'
S 01° 21' 55" W

LOT 2937
BRADEN ADDITION
PLAT CABINET A. SLIDE 61

LOT 1694

LOT 1693

N 05° 08' 01" E
159.66'



ORIGINAL STAMP IN GREEN

SURVEYED BY:
[Signature]
JEFFREY I. LEE
PROFESSIONAL SURVEYOR 6359
JULY 15, 2002

16' ALLEY

71.40'
S 77° 57' 29" W

COPYRIGHT 2002 BY:
LEE SURVEYING & MAPPING CO., INC.
117 North Madriver Street
BELLEFONTAINE, OHIO 43311
(937) 593-7335

D 410 MATDYOUS L-3398-3

2 WORKING DAYS
BEFORE YOU DIG
CALL TOLL FREE 800-362-2764
OHIO UTILITIES PROTECTION SERVICE.

INDEXED ON MAP
9408 1P

REC'D 5-15-02 SMY OK

WILLIAMS AVENUE (50')

(BASIS FOR BEARINGS)
N 79° 15' 00" E
40.00'

LOT 1693
LOT 1692

N 04° 58' 09" W
150.38'

LOT 1692
LOT 1691

150.00'
S 10° 50' 20" E

LOT 1694
LOT 1693

VALERIE SUE KERNS
PART OF LOT 1692 & 1693
O.R. 456. PG. 642

AMBER D. LETH
PART OF LOT 1692 & 1693
O.R. 475. PG. 977

THE CITY OF BELLEFONTAINE
LOGAN COUNTY, OHIO
RUTAN PARK
VOL. 112. PG. 295

VACATED 10' ALLEY

55.38'
S 79° 38' 53" W

16' ALLEY

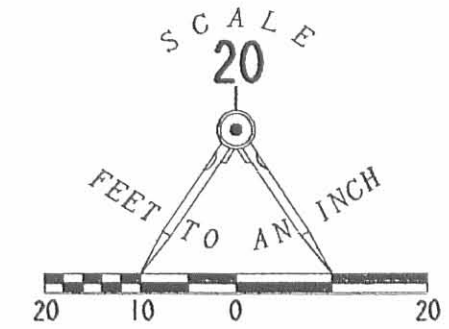

LEGEND

- 5/8 INCH IRON ROD SET
- 5/8 INCH IRON ROD FOUND
- 1 INCH IRON PIPE FOUND
- ∅ 1/2 INCH IRON ROD FOUND

RETRACEMENT SURVEY OF THE
AMBER D. LETH PART OF LOT 1692 & 1693
OF THE STANTON-CAMPBELL ADDITION
OFFICIAL RECORD 475, PAGE 977
PLAT CABINET A, SLIDE 27
CITY OF BELLEFONTAINE
LAKE TOWNSHIP
LOGAN COUNTY, OHIO

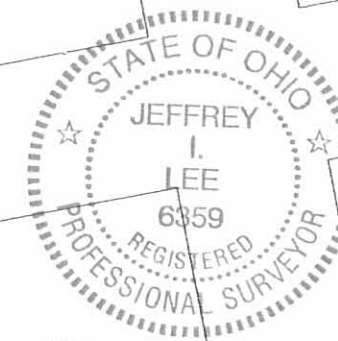

ORIGINAL STAMP IN GREEN

SURVEYED BY:

Jeffrey I. Lee
JEFFREY I. LEE
PROFESSIONAL SURVEYOR 6359
MAY 1, 2002

COPYRIGHT 2002 BY:
LEE SURVEYING & MAPPING CO., INC.
117 North Madriver Street
BELLEFONTAINE, OHIO 43311
(937) 593-7335

D 401 HOWELL

L-3364-3

INDEXED ON MAP
9408 2P