

196

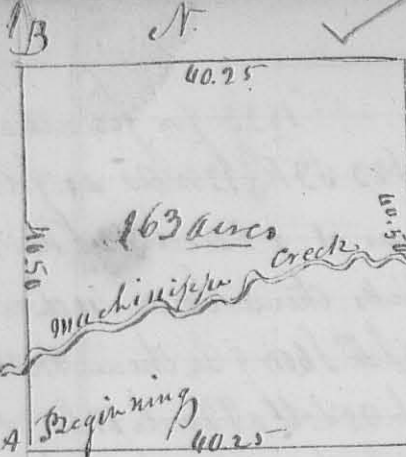

N. 230

8314

Surveyed for Gardner on Munchinippe Oct. 1833 the NW 1/4 of T. 9 S. R. 8 E. as shown by the plat in the following manner: Beginning at the orig. gr. corner on the West boundary in an old Indian pile, the bearing true, dead timber, then pass designated on the plat by letter A. thence B N 3° 50' W 40.50 crossing Munchinippe to the NW corner of the section, thence C N 86° 10' E 40.25 ch. to the orig. gr. s. corner on the north line of the section. thence D S 3° 50' E 40.50 ch. crossing the creek at 21 ch. to an Elm 8' W N 20° 19' E and Gray Ash 12' S N 46° 42' Links, thence E S 86° 10' W 40.25 to the beginning containing 163 acres. D. Hopkins depy. J. H.

N. 231

8315



Surveyed July 15th 1833 the East half of the SW 1/4 of T. 22 S. R. 8 E. for Benjamin Reed and also 40 acres out of the NW corner of the S. E. quarter of the same section, as follows: Beginning at a Water Buck 6' W S 38° E 12 links and White Oak 10' W N 31° W 75 links, in the South line of said section, and comes between the two 80 acres lots in said S. W. quarter, thence A N 3° 50' W 40 ch. crossing the river to a Buck 12' W N 67° W 26 Links and Ash 6' W S 5° E 17 links, thence B N 86° 10' E 20 ch. to a S. Bulbony 6' W S 21° E 18 Links, a W. Oak 4' W N 76° 2 links, thence C S 3° 50' E 20 chains to a Black Walnut 4' W S 78° E 31 links, Duck Eye 6' W S 45° W 19 links, thence D N 86° 10' E 20 ch. to Bur Oak 12' W S 49° W 34 links, Elm 10' W S 16° E 19 links, thence E S 3° 50' E 20 ch. crossing the Munchinippe to Duck Eye 15' W N 42° E 8 1/2 links, Hickory 8' W S 89° W 46 links, in the South line of the section, thence with said line S 86° 10' W 40 ch. passing the orig. corner and comes between Joseph Poie and Geo. Hirston at 20 ch. to the beginning containing one hundred and twenty acres. At Summit and under sum N. ran a line for Joseph Poie, beginning as above thence F S 3° 50' E 22 chains to Hickory 6' W N 76° 13 links, and a Hickory 15' W S 46° 37 links, in Nancy Stewart's North line, and also ran a line between Joseph Poie and Geo. Hirston, beginning at the orig. corner above, thence G S 3° 50' E 20 ch. 75 Links to Hickory 4' W N 30° W 7 Links, Ash 4' W S 16° W 16 links, part of S. 77. S. R. 8 E. lying between Nancy Stewart & Mrs. J. Poie Geo. Hirston d. cur. J. H. Surveyor.