

Lee Surveying and Mapping Co., Inc.

Land Surveys • Topography • Subdivisions • Construction Layout

117 N. Madriver St.
Bellefontaine OH 43311



Phone: (937) 593-7335
Fax: (937) 593-7444

CARPENTER 16.332 ACRES

Lying in Virginia Military Survey 9891, Bokescreek Township, Logan County, Ohio.

Being all of the Richard F. Carpenter original 15.78 acres as deeded and described in Official Record 150, Page 235 of the Logan County Records of Deeds and being more particularly described as follows:

Beginning at a 3/4 inch iron rod found in a monument box at the north corner of Virginia Military Survey 9891 at the intersection of County Highway 20 (50 feet wide) and County Highway 120 (60 feet wide).

THENCE, with the center-line of County Highway 120, S 10°-30'-00" E, a distance of 2590.91 feet to a railroad spike set at the TRUE POINT OF BEGINNING.

THENCE, with the center-line of County Highway 120, S 10°-30'-00" E, a distance of 863.15 feet to a 1 inch square iron rod found in a monument box at the intersection of County Highway 120 and County Highway 119 (60 feet wide).

THENCE, with the center-line of County Highway 119, S 79°-25'-57" W, a distance of 822.50 feet to a railroad spike set.

THENCE, with the east line of the Bernard Bates 7.0 acre tract (Vol. 350, Pg. 864, Tract II), and the Bernard Bates 30.24 acre tract (O.R. 93, Pg. 888, Tract I) and the Bernard Bates 16.25 acre tract (O.R. 93, Pg. 888, Tract IV), N 10°-36'-10" W, a distance of 865.07 feet to a 5/8 inch iron rod set, passing a 5/8 inch iron rod set at 20.00 feet.

THENCE, with the south line of the Bernard Bates 16.33 acre tract (O.R. 93, Pg. 888, Tract III), N 79°-33'-58" E, a distance of 824.05 feet to the point of beginning, passing a 5/8 inch iron rod set at 804.05.

Containing 16.332 acres, of which 1.140 acres are within the highway right-of-way.

The basis for bearings is the center-line of County Highway 120 being S 10°-30'-00" E, and all other bearings are from angles and distances measured in a field survey by Lee Surveying and Mapping Co., Inc. on May 12, 2000.

Description prepared by:

William K. Bruce
Professional Surveyor 7437
June 6, 2000



ORIGINAL STAMP IN GREEN

L-2964

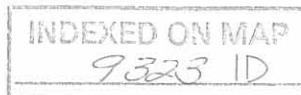

REC'D 6-13-00 SMY & CV

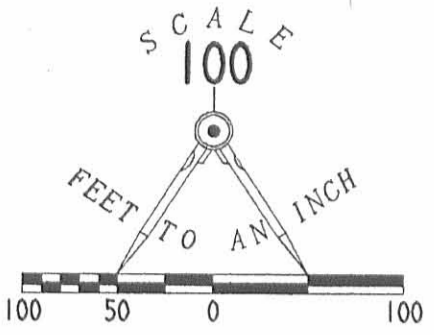

LEGEND

- 5/8 INCH IRON ROD SET
- ⊕ RAILROAD SPIKE SET
- ⊠ 1 INCH SQUARE IRON ROD FOUND IN A MONUMENT BOX
- ⊙ 3/4 INCH IRON ROD FOUND IN A MONUMENT BOX

BERNARD BATES, DONNA BATES, SCOTT BATES, AND LINDA BATES 16.25 ACRES O.R. 93, PG. 888 TRACT IV

BERNARD BATES, DONNA BATES, SCOTT BATES, AND LINDA BATES 16.33 ACRES O.R. 93, PG. 888 TRACT III

16.332 ACRES OF WHICH 1.140 ACRES ARE WITHIN THE HIGHWAY RIGHT-OF-WAY

BERNARD BATES, DONNA BATES, SCOTT BATES AND LINDA BATES 30.24 ACRES TRACT I O.R. 93, PG. 888

BERNARD BATES AND DONNA BATES 7.0 ACRES VOL. 350, PG. 864 TRACT II

RETRACEMENT SURVEY OF THE
 RICHARD F. CARPENTER
 15.78 ACRE TRACT
 OFFICIAL RECORD 150, PAGE 235
 VIRGINIA MILITARY SURVEY 9891
 BOKESCREEK TOWNSHIP
 LOGAN COUNTY, OHIO

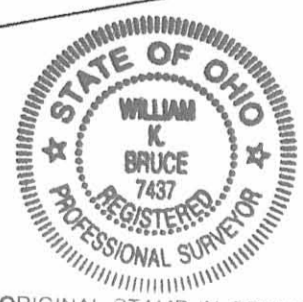

ORIGINAL STAMP IN GREEN

SURVEYED BY:

WILLIAM K. BRUCE
PROFESSIONAL SURVEYOR 7437
MAY 12, 2000

COPYRIGHT 2000 BY:
LEE SURVEYING & MAPPING CO., INC.
117 North Madriver Street
BELLEFONTAINE, OHIO 43311
(937) 593-7335

2 WORKING DAYS
BEFORE YOU DIG
CALL TOLL FREE 800-362-2764
OHIO UTILITIES PROTECTION SERVICE.

INDEXED ON MAP
93231P