

REC'D 3-9-06 SMY OK

Lee Surveying and Mapping Co., Inc.

Land Surveys • Topography • Subdivisions • Construction Layout

117 N. Madriver St.
Bellefontaine OH 43311

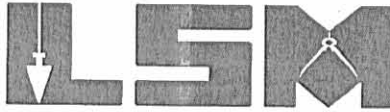

Phone: (937) 593-7335
Fax: (937) 593-7444

1975-2005 - 30 YEARS OF EXCELLENCE

**SHAWVER
TRACT A
1.395 ACRES**

Lying in Section 6, Town 3, Range 14, Harrison Township, Logan County, Ohio.

Being out of the Thomas F. Shawver, John L. Shawver and Charyl Ann Winner original 76.182 acre tract as deeded and described in Official Record 807, Page 890, Tract I of the Logan County Records of Deeds and being more particularly described as follows:

Beginning at a 5/8 inch iron rod found at the southeast corner of Shady Knolls Allotment No. 3 (Plat Cabinet A, Slide 421) on the intersection of the south right-of-way of Charyl Street and the east right-of-way of John Street.

THENCE, with the south right-of-way of Charyl Street (60 feet wide), N 85°-03'-58"W, a distance of 865.05 feet to a 5/8 inch iron rod set at the TRUE POINT OF BEGINNING.

THENCE, S 4°-35'-15"W, a distance of 150.00 feet to a 5/8 inch iron rod set.

THENCE, N 85°-03'-58"W, a distance of 405.00 feet to a 5/8 inch iron rod set.

THENCE, N 4°-35'-15"E, a distance of 150.00 feet to a 5/8 inch iron rod set on the south right-of-way of Charyl Street.

THENCE, with the south right-of-way of Charyl Street, S 85°-03'-58"E, a distance of 405.00 feet to the point of beginning.

Containing 1.395 acres.

The basis for bearings is the center-line of County Highway 130, being N 36°-07'-00"W, and all other bearings are from angles and distances measured in a field survey by Lee Surveying and Mapping Co., Inc. on February 28, 2006.



Description prepared by:

[Handwritten Signature]
Jeffrey I. Lee
Professional Surveyor 6359
February 28, 2006

ORIGINAL STAMP IN GREEN

3377016A

INDEXED ON MAP
3580 9D-1

REC'D 39-068M OK

Lee Surveying and Mapping Co., Inc.

Land Surveys • Topography • Subdivisions • Construction Layout

117 N. Madriver St.
Bellefontaine OH 43311

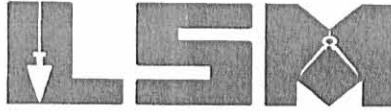

Phone: (937) 593-7335
Fax: (937) 593-7444

1975-2005 - 30 YEARS OF EXCELLENCE

**SHAWVER
TRACT B
0.930 ACRE**

Lying in Section 6, Town 3, Range 14, Harrison Township, Logan County, Ohio.

Being out of the Thomas F. Shawver, John L. Shawver and Charyl Ann Winner original 76.182 acre tract as deeded and described in Official Record 807, Page 890, Tract I of the Logan County Records of Deeds and being more particularly described as follows:

Beginning at a 5/8 inch iron rod found at the southeast corner of Shady Knolls Allotment No. 3 (Plat Cabinet A, Slide 421) on the intersection of the south right-of-way of Charyl Street and the east right-of-way of John Street.

THENCE, with the south right-of-way of Charyl Street (60 feet wide), N 85°-03'-58"W, a distance of 595.05 feet to a 5/8 inch iron rod set at the TRUE POINT OF BEGINNING.

THENCE, S 4°-35'-15"W, a distance of 150.00 feet to a 5/8 inch iron rod set.

THENCE, N 85°-03'-58"W, a distance of 270.00 feet to a 5/8 inch iron rod set.

THENCE, N 4°-35'-15"E, a distance of 150.00 feet to a 5/8 inch iron rod set on the south right-of-way of Charyl Street.

THENCE, with the south right-of-way of Charyl Street, S 85°-03'-58"E, a distance of 270.00 feet to the point of beginning.

Containing 0.930 acre.

The basis for bearings is the center-line of County Highway 130, being N 36°-07'-00"W, and all other bearings are from angles and distances measured in a field survey by Lee Surveying and Mapping Co., Inc. on February 28, 2006.



ORIGINAL STAMP IN GREEN

Description prepared by:

Jeffrey I. Lee
Professional Surveyor 6359
February 28, 2006

3377016A

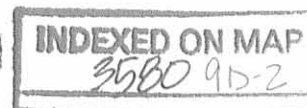

REC'D 3 9-06 SMJ OK
Lee Surveying and Mapping Co., Inc.

Land Surveys • Topography • Subdivisions • Construction Layout

117 N. Madriver St.
Bellefontaine OH 43311

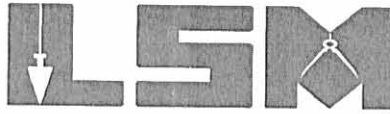

Phone: (937) 593-7335
Fax: (937) 593-7444

1975-2005 - 30 YEARS OF EXCELLENCE

**SHAWVER
TRACT C
1.395 ACRE**

Lying in Section 6, Town 3, Range 14, Harrison Township, Logan County, Ohio.

Being out of the Thomas F. Shawver, John L. Shawver and Charyl Ann Winner original 76.182 acre tract as deeded and described in Official Record 807, Page 890, Tract I of the Logan County Records of Deeds and being more particularly described as follows:

Beginning at a 5/8 inch iron rod found at the southeast corner of Shady Knolls Allotment No. 3 (Plat Cabinet A, Slide 421) on the intersection of the south right-of-way of Charyl Street and the east right-of-way of John Street.

THENCE, with the south right-of-way of Charyl Street (60 feet wide), N 85°-03'-58"W, a distance of 190.05 feet to a 5/8 inch iron rod set at the TRUE POINT OF BEGINNING.

THENCE, S 4°-35'-15"W, a distance of 150.00 feet to a 5/8 inch iron rod set.

THENCE, N 85°-03'-58"W, a distance of 405.00 feet to a 5/8 inch iron rod set.

THENCE, N 4°-35'-15"E, a distance of 150.00 feet to a 5/8 inch iron rod set on the south right-of-way of Charyl Street.

THENCE, with the south right-of-way of Charyl Street, S 85°-03'-58"E, a distance of 405.00 feet to the point of beginning.

Containing 1.395 acres.

The basis for bearings is the center-line of County Highway 130, being N 36°-07'-00"W, and all other bearings are from angles and distances measured in a field survey by Lee Surveying and Mapping Co., Inc. on February 28, 2006.



ORIGINAL STAMP IN GREEN

Description prepared by:

Jeffrey I. Lee
Professional Surveyor 6359
February 28, 2006

3377016A

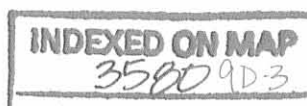

REC'D 3-9-06 SMY OK
Lee Surveying and Mapping Co., Inc.

Land Surveys • Topography • Subdivisions • Construction Layout

117 N. Madriver St.
Bellefontaine OH 43311

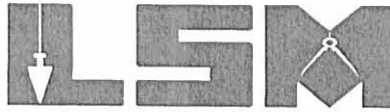

Phone: (937) 593-7335
Fax: (937) 593-7444

1975-2005 - 30 YEARS OF EXCELLENCE

**SHAWVER
TRACT D
0.533 ACRE**

Lying in Section 6, Town 3, Range 14, Harrison Township, Logan County, Ohio.

Being out of the Thomas F. Shawver, John L. Shawver and Charyl Ann Winner original 76.182 acre tract as deeded and described in Official Record 807, Page 890, Tract I of the Logan County Records of Deeds and being more particularly described as follows:

Beginning at a 5/8 inch iron rod found at the southeast corner of Shady Knolls Allotment No. 3 (Plat Cabinet A, Slide 421) on the intersection of the south right-of-way of Charyl Street and the east right-of-way of John Street.

THENCE, with the east line of the northwest quarter of Section 6 and the west line of the Roberta J. Drown original 145.37 acre tract (O.R. 349, Pg. 094, Tract II), S 5°-12'-22"W, a distance of 180.00 feet to a 5/8 inch iron rod set.

THENCE, N 85°-03'-58"W, a distance of 128.10 feet to a 5/8 inch iron rod set.

THENCE, N 4°-35'-15"E, a distance of 180.00 feet to a 5/8 inch iron rod set on the south right-of-way of Charyl Street.

THENCE, with the south right-of-way of Charyl Street, S 85°-03'-58"E, a distance of 130.05 feet to the point of beginning.

Containing 0.533 acre.

The basis for bearings is the center-line of County Highway 130, being N 36°-07'-00"W, and all other bearings are from angles and distances measured in a field survey by Lee Surveying and Mapping Co., Inc. on February 28, 2006.



ORIGINAL STAMP IN GREEN

Description prepared by:

Jeffrey I. Lee
Professional Surveyor 6359
February 28, 2006

3377016A

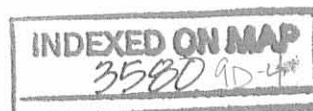

REC'D 3-9-06 SMM/OU

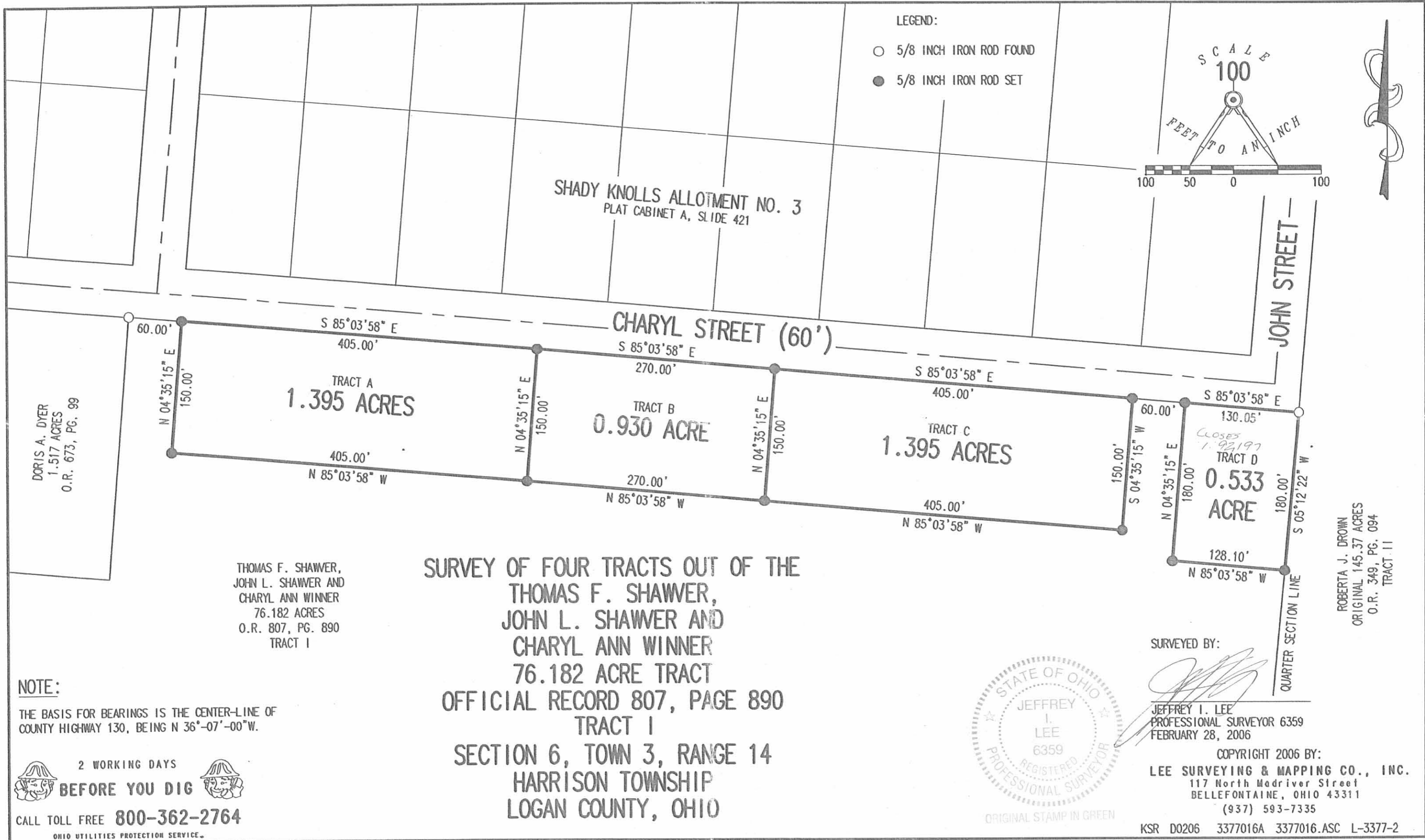

NOTE:
THE BASIS FOR BEARINGS IS THE CENTER-LINE OF COUNTY HIGHWAY 130, BEING N 36°-07'-00"W.

2 WORKING DAYS
BEFORE YOU DIG
CALL TOLL FREE **800-362-2764**
OHIO UTILITIES PROTECTION SERVICE.

**SURVEY OF FOUR TRACTS OUT OF THE
THOMAS F. SHAWER,
JOHN L. SHAWER AND
CHARYL ANN WINNER
76.182 ACRE TRACT
OFFICIAL RECORD 807, PAGE 890
TRACT I
SECTION 6, TOWN 3, RANGE 14
HARRISON TOWNSHIP
LOGAN COUNTY, OHIO**



SURVEYED BY:
[Signature]
JEFFREY I. LEE
PROFESSIONAL SURVEYOR 6359
FEBRUARY 28, 2006

COPYRIGHT 2006 BY:
LEE SURVEYING & MAPPING CO., INC.
117 North Madriver Street
BELLEFONTAINE, OHIO 43311
(937) 593-7335
KSR D0206 3377016A 3377016.ASC L-3377-2

INDEXED ON MAP
3580 9P

LESLIE H. GEESLIN

REGISTERED SURVEYOR 5248

P. O. BOX 274

RUSHSVLVANIA, OHIO 43347

TELEPHONE: (937) 468-2793

FAX: (937) 468-2080

ADAMS SURVEY

October 14, 1998

The following described real estate situated in the State of Ohio, County of Logan, Township of Harrison, being part of Section 6, Town 3, Range 14 and more particularly described as follows:

Beginning at a cap and nail found in the centerline of County Highway 130 at the northwest corner of Michael W. Vanover, et al's 1.71 acre tract as described in O. R. Vol. 43 Page 94.

Thence with the centerline of said C. H. 130 N. 36° 17' 00" W. 542.41 feet to a magnetic nail set.

Thence N. 53° 39' 52" E. 989.28 feet to a 5/8 inch iron bar set in the west line of Roberta J. Drown's original 100 acre tract as described in O. R. Vol. 349 page 94, passing a 5/8 inch iron bar set at 30.00 feet.

Thence with said Drown's west line and the west line of H. Richard Frick, Trustee, et al's original 36.48 acre tract as described in O. R. Vol. 128 Page 489 (Tr. 2) S. 4° 58' 57" W. 868.53 feet to a 1/2 inch iron bar found at said Vanover's northeast corner.

Thence with said Vanover's north line S. 68° 27' 09" W. 430.60 feet to the place of beginning, passing a 5/8 inch iron bar found at 399.58 feet.

Containing 10.000 acres more or less of which 0.374 acre is in the right of way of County Highway 130.

The above described 10.000 acre tract being part of Richard B. Adams, Jr.'s 31.71 acre tract as described in D. B. Vol. 360 Page 891.

Bearings are based on an assumed bearing (N. 36° 17' 00" W.) for the centerline of County Highway 130 in this field survey by Leslie H. Geeslin, Reg. Surveyor 5248 on October 14, 1998.

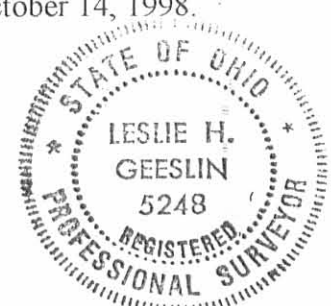

HARRISON\04\ADAMS2.SAM

INDEXED ON MAP
3580 10D

Leslie H. Geeslin

SCALE: 1"=20'

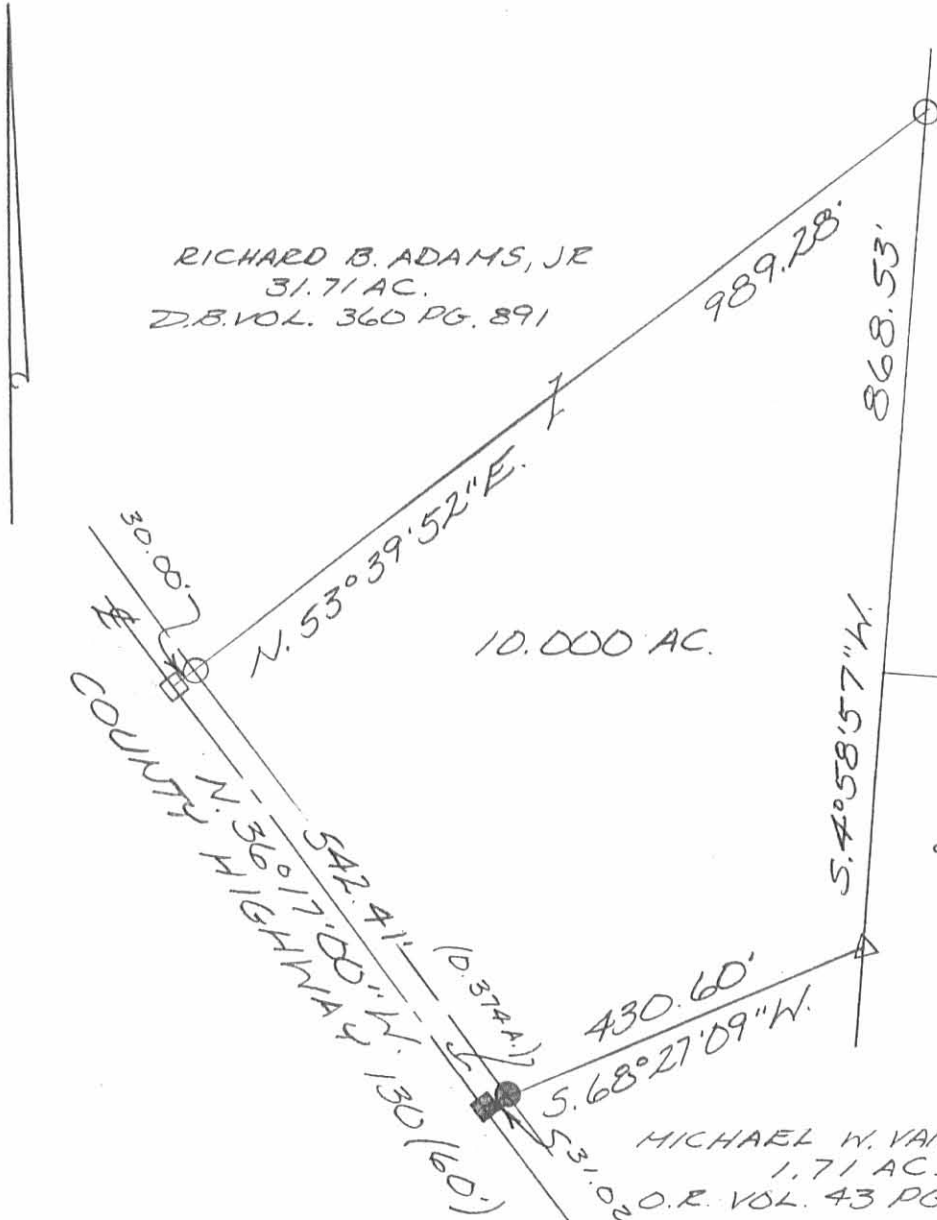

RICHARD B. ADAMS, JR
31.71 AC.
D.B. VOL. 360 PG. 891

LEGEND:

- = CAP AND NAIL FOUND
- = 5/8 INCH IRON BAR FOUND
- △ = 1/2 INCH IRON BAR FOUND
- = MAGNETIC NAIL SET
- = 5/8 INCH IRON BAR SET

ROBERTA J. DROWN
ORG. 100 AC.
D.R. VOL. 349 PG. 94

H. RICHARD FRICK, TRUSTEE
ET AL
ORG. 36.48 AC.
O.R. VOL. 128 PG. 489 (TR. 2)

MICHAEL W. VANOVER, ET AL
1.71 AC.
O.R. VOL. 43 PG. 94

SURVEY OF 10.000 ACRES IN SECTION 6,
TOWN 3, RANGE 14, HARRISON TOWNSHIP,
LOGAN COUNTY, OHIO FOR RICHARD
ADAMS ON OCTOBER 14, 1998



Leslie H. Geeslin
LESLIE H. GEESLIN
RUSHSVLVANIA, OH
PH: (937) 468-2793
FX: (937) 468-2080

INDEXED ON MAP
3580 IID

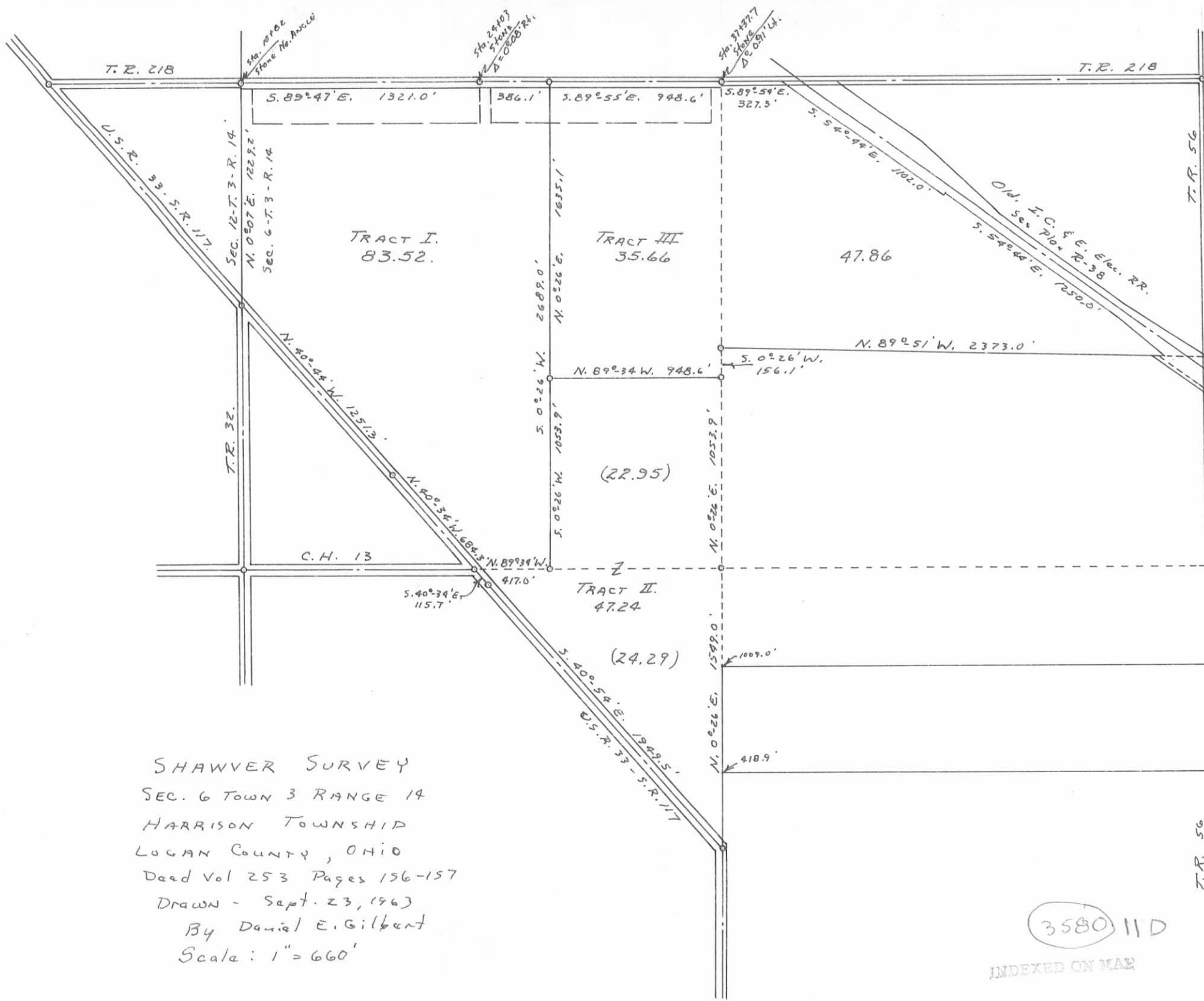

SHAWVER SURVEY
 SEC. 6 TOWN 3 RANGE 14
 HARRISON TOWNSHIP
 LOGAN COUNTY, OHIO
 Deed Vol 253 Pages 156-157
 Drawn - Sept. 23, 1963
 By Daniel E. Gilbert
 Scale: 1" = 660'

3580 11 D
 INDEXED ON MAP

Rec'd 6-17-02 JLB OK

Lee Surveying and Mapping Co., Inc.

Land Surveys • Topography • Subdivisions • Construction Layout

117 N. Madriver St.
Bellefontaine OH 43311

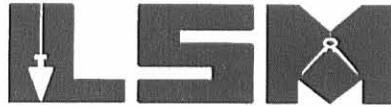

Phone: (937) 593-7335
Fax: (937) 593-7444

STOVER 10 FEET WIDE DRAINAGE EASEMENT

Lying in Section 6, Town 3, Range 14, Harrison Township, Logan County, Ohio.

Being a 10 feet wide drainage easement over the Bert E. Stover and Janice A. Stover 1.515 acre tract as deeded and described in Official Record 529, Page 869, Tract II of the Logan County Records of Deeds and being more particularly described as follows:

Beginning at a 5/8 inch iron rod found on the south right-of-way of Charyl Street (60 feet wide) at the northeast corner of the said 1.515 acre tract.

THENCE, with the east line of the said 1.515 acre tract and the west line of the James E. Garver 1.515 acre tract (O.R. 389, Pg. 613), S 0°-13'-00" W, a distance of 151.00 feet to a point on the center-line of this 10 feet wide easement at the TRUE POINT OF BEGINNING.

THENCE, with the center-line of this 10 feet wide easement, N 76°-00'-00" W, a distance of 90.00 feet to a point at the terminus of this easement.

The basis for bearings is the west line of the said Garver 1.515 acre tract, being S 0°-13'-00" W, and all other bearings are from angles and distances measured in a field survey by Lee Surveying and Mapping Co., Inc. on May 28, 2002.

Description prepared by:

Jeffrey I. Lee
Professional Surveyor 6359
May 29, 2002
Revised June 11 2002

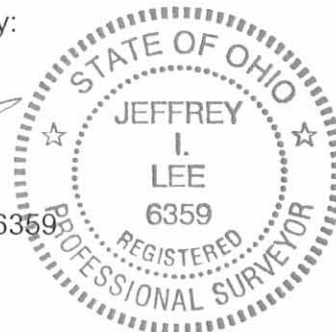

ORIGINAL STAMP IN GREEN

L-3377

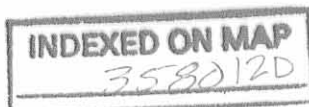

SECTION 12, TOWN 3, RANGE 14
SECTION 6, TOWN 3, RANGE 14

THOMAS STREET (60')

SHAWVER RD.

CHARYL STREET (60')

S 89° 47' 00" E
819.45'

10' DRAINAGE
EASEMENT

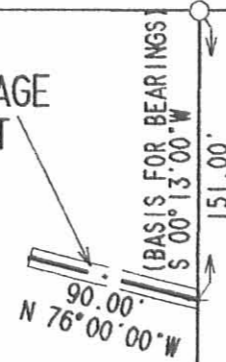

BERT E. STOVER AND
JANICE A. STOVER
1.515 ACRES
O.R. 529, PG. 869
TRACT 11

JAMES E. GARVER
1.515 ACRES
O.R. 389, PG. 613

KRISTOPHER J. MATTFELD AND
DEBRA S. MATTFELD
1.517 ACRES
O.R. 416, PG. 308

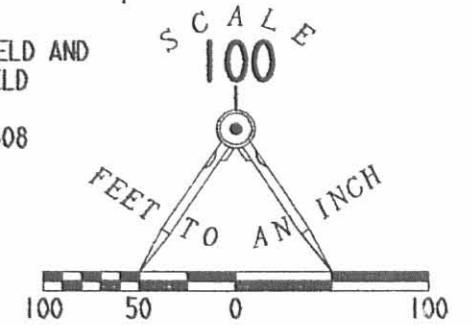

LEGEND

- 5/8 INCH IRON ROD FOUND
- 1 INCH IRON ROD FOUND

SURVEY OF A 10 FEET WIDE
DRAINAGE EASEMENT OVER THE
BERT E. STOVER AND JANICE A. STOVER
1.515 ACRE TRACT
OFFICIAL RECORD 529, PAGE 869, TRACT 11
SECTION 6, TOWN 3, RANGE 14
HARRISON TOWNSHIP
LOGAN COUNTY, OHIO



ORIGINAL STAMP IN GREEN

SURVEYED BY:

Jeffrey I. Lee
JEFFREY I. LEE
PROFESSIONAL SURVEYOR 6359
MAY 28, 2002
REVISED JUNE 11, 2002

COPYRIGHT 2002 BY:

LEE SURVEYING & MAPPING CO., INC.
117 North Madriver Street
BELLEFONTAINE, OHIO 43311
(937) 593-7335

INDEXED ON MAP
3580 12P

D 403

GARV2

L-3377-3

REC'D 5-31-02 SMJ QK

Lee Surveying and Mapping Co., Inc.

Land Surveys • Topography • Subdivisions • Construction Layout

117 N. Madriver St.
Bellefontaine OH 43311

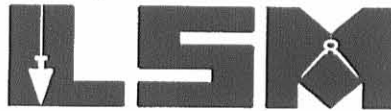

Phone: (937) 593-7335
Fax: (937) 593-7444

GARVER 10 FEET WIDE DRAINAGE EASEMENT

Lying in Section 6, Town 3, Range 14, Harrison Township, Logan County, Ohio.

Being a 10 feet wide drainage easement over the James E. Garver 1.515 acre tract as deeded and described in Official Record 389, Page 613 of the Logan County Records of Deeds and being more particularly described as follows:

Beginning at a 5/8 inch iron rod found on the south right-of-way of Charyl Street (60 feet wide) at the northwest corner of the said 1.515 acre tract.

THENCE, with the west line of the said 1.515 acre tract and the east line of the Bert E. Stover 1.515 acre tract (O.R. 529, Pg. 869, Tract II), S 0°-13'-00" W, a distance of 151.00 feet to a point on the center-line of this 10 feet wide easement at the TRUE POINT OF BEGINNING.

THENCE, with the center-line of this 10 feet wide easement, N 67°-00'-00" E, a distance of 170.00 feet to a point at the terminus of this easement.

The basis for bearings is the west line of the said 1.515 acre tract, being S 0°-13'-00" W, and all other bearings are from angles and distances measured in a field survey by Lee Surveying and Mapping Co., Inc. on May 28, 2002.

Description prepared by:



ORIGINAL STAMP IN GREEN

Jeffrey I. Lee
Professional Surveyor 6359
May 29, 2002

L-3377



REC'D 5-31-02 SMJ OK

SECTION 12, TOWN 3, RANGE 14
SECTION 6, TOWN 3, RANGE 14

THOMAS STREET (60')

SHAWVER RD.

CHARYL STREET (60')

S 89° 47' 00" E
819.45'

(BASIS FOR BEARINGS)
S 00° 13' 00" W
151.00'

10' DRAINAGE
EASEMENT

N 67° 00' 00" E
170.00'

BERT E. STOVER AND
JANICE A. STOVER
1.515 ACRES
O.R. 529, PG. 869
TRACT 11

JAMES E. GARVER
1.515 ACRES
O.R. 389, PG. 613

KRISTOPHER J. MATTFELD AND
DEBRA S. MATTFELD
1.517 ACRES
O.R. 416, PG. 308

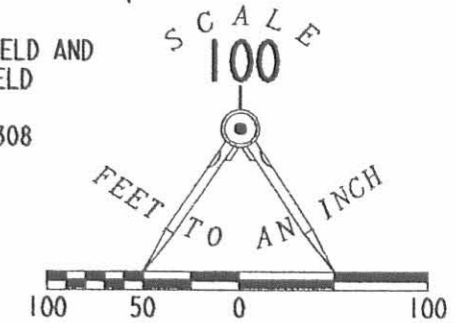

LEGEND

- 5/8 INCH IRON ROD FOUND
- ◉ 1 INCH IRON ROD FOUND

SURVEY OF A 10 FEET WIDE
DRAINAGE EASEMENT OVER THE
JAMES E. GARVER
1.515 ACRE TRACT
OFFICIAL RECORD 389, PAGE 613
SECTION 6, TOWN 3, RANGE 14
HARRISON TOWNSHIP
LOGAN COUNTY, OHIO

INDEXED ON MAP
3580 13P



SURVEYED BY:

Jeffrey I. Lee
JEFFREY I. LEE
PROFESSIONAL SURVEYOR 6359
MAY 28, 2002

COPYRIGHT 2002 BY:
LEE SURVEYING & MAPPING CO., INC.
117 North Madriver Street
BELLEFONTAINE, OHIO 43311
(937) 593-7335

D 403

GARV2

L-3377-3 ✓

REC'D 3-9-06 smyak

Lee Surveying and Mapping Co., Inc.

Land Surveys • Topography • Subdivisions • Construction Layout

117 N. Madriver St.
Bellefontaine OH 43311

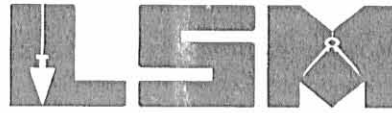

Phone: (937) 593-7335
Fax: (937) 593-7444

1975-2005 - 30 YEARS OF EXCELLENCE

**SHAWVER
TRACT E
0.465 ACRE**

Lying in Section 6, Town 3, Range 14, Harrison Township, Logan County, Ohio.

Being out of the Thomas F. Shawver, John L. Shawver and Charyl Ann Winner original 76.182 acre tract as deeded and described in Official Record 807, Page 890, Tract I of the Logan County Records of Deeds and being more particularly described as follows:

Beginning at a 5/8 inch iron rod found at the southeast corner of Shady Knolls Allotment No. 3 (Plat Cabinet A, Slide 421) on the intersection of the south right-of-way of Charyl Street and the east right-of-way of John Street.

THENCE, with the south right-of-way of Charyl Street (60 feet wide), N 85°-03'-58"W, a distance of 1135.05 feet to a 5/8 inch iron rod set at the TRUE POINT OF BEGINNING.

THENCE, S 4°-35'-15"W, a distance of 150.00 feet to a 5/8 inch iron rod set.

THENCE, N 85°-03'-58"W, a distance of 135.00 feet to a 5/8 inch iron rod set.

THENCE, N 4°-35'-15"E, a distance of 150.00 feet to a 5/8 inch iron rod set on the south right-of-way of Charyl Street.

THENCE, with the south right-of-way of Charyl Street, S 85°-03'-58"E, a distance of 135.00 feet to the point of beginning.

Containing 0.465 acre.

The basis for bearings is the center-line of County Highway 130, being N 36°-07'-00"W, and all other bearings are from angles and distances measured in a field survey by Lee Surveying and Mapping Co., Inc. on February 28, 2006.

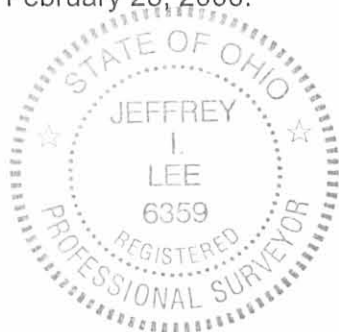

ORIGINAL STAMP IN GREEN

Description prepared by:

[Signature]
Jeffrey I. Lee
Professional Surveyor 6359
February 28, 2006

3377016A



REV'D 3-9-06 SMY/OK

Lee Surveying and Mapping Co., Inc.

Land Surveys • Topography • Subdivisions • Construction Layout

117 N. Madriver St.
Bellefontaine OH 43311

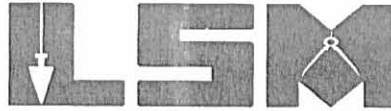

Phone: (937) 593-7335
Fax: (937) 593-7444

1975-2005 - 30 YEARS OF EXCELLENCE

**SHAWVER
TRACT F
0.465 ACRE**

Lying in Section 6, Town 3, Range 14, Harrison Township, Logan County, Ohio.

Being out of the Thomas F. Shawver, John L. Shawver and Charyl Ann Winner original 76.182 acre tract as deeded and described in Official Record 807, Page 890, Tract I of the Logan County Records of Deeds and being more particularly described as follows:

Beginning at a 5/8 inch iron rod found at the southeast corner of Shady Knolls Allotment No. 3 (Plat Cabinet A, Slide 421) on the intersection of the south right-of-way of Charyl Street and the east right-of-way of John Street.

THENCE, with the south right-of-way of Charyl Street (60 feet wide), N 85°-03'-58"W, a distance of 1000.05 feet to a 5/8 inch iron rod set at the TRUE POINT OF BEGINNING.

THENCE, S 4°-35'-15"W, a distance of 150.00 feet to a 5/8 inch iron rod set.

THENCE, N 85°-03'-58"W, a distance of 135.00 feet to a 5/8 inch iron rod set.

THENCE, N 4°-35'-15"E, a distance of 150.00 feet to a 5/8 inch iron rod set on the south right-of-way of Charyl Street.

THENCE, with the south right-of-way of Charyl Street, S 85°-03'-58"E, a distance of 135.00 feet to the point of beginning.

Containing 0.465 acre.

The basis for bearings is the center-line of County Highway 130, being N 36°-07'-00"W, and all other bearings are from angles and distances measured in a field survey by Lee Surveying and Mapping Co., Inc. on February 28, 2006.



ORIGINAL STAMP IN GREEN

Description prepared by:

Jeffrey I. Lee
Professional Surveyor 6359
February 28, 2006

3377016A



PLD 3 9-06 SMJ DLK
Lee Surveying and Mapping Co., Inc.

Land Surveys • Topography • Subdivisions • Construction Layout

117 N. Madriver St.
Bellefontaine OH 43311

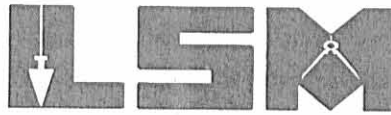

Phone: (937) 593-7335
Fax: (937) 593-7444

1975-2005 - 30 YEARS OF EXCELLENCE

**SHAWVER
TRACT G
0.465 ACRE**

Lying in Section 6, Town 3, Range 14, Harrison Township, Logan County, Ohio.

Being out of the Thomas F. Shawver, John L. Shawver and Charyl Ann Winner original 76.182 acre tract as deeded and described in Official Record 807, Page 890, Tract I of the Logan County Records of Deeds and being more particularly described as follows:

Beginning at a 5/8 inch iron rod found at the southeast corner of Shady Knolls Allotment No. 3 (Plat Cabinet A, Slide 421) on the intersection of the south right-of-way of Charyl Street and the east right-of-way of John Street.

THENCE, with the south right-of-way of Charyl Street (60 feet wide), N 85°-03'-58"W, a distance of 865.05 feet to a 5/8 inch iron rod set at the TRUE POINT OF BEGINNING.

THENCE, S 4°-35'-15"W, a distance of 150.00 feet to a 5/8 inch iron rod set.

THENCE, N 85°-03'-58"W, a distance of 135.00 feet to a 5/8 inch iron rod set.

THENCE, N 4°-35'-15"E, a distance of 150.00 feet to a 5/8 inch iron rod set on the south right-of-way of Charyl Street.

THENCE, with the south right-of-way of Charyl Street, S 85°-03'-58"E, a distance of 135.00 feet to the point of beginning.

Containing 0.465 acre.

The basis for bearings is the center-line of County Highway 130, being N 36°-07'-00"W, and all other bearings are from angles and distances measured in a field survey by Lee Surveying and Mapping Co., Inc. on February 28, 2006.



ORIGINAL STAMP IN GREEN

Description prepared by:

Jeffrey I. Lee
Professional Surveyor 6359
February 28, 2006

3377016A

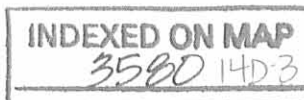

REV'D 3-9-06 SWM OK
Lee Surveying and Mapping Co., Inc.

Land Surveys • Topography • Subdivisions • Construction Layout

117 N. Madriver St.
Bellefontaine OH 43311

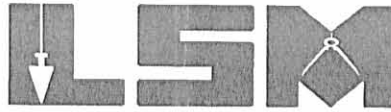

Phone: (937) 593-7335
Fax: (937) 593-7444

1975-2005 - 30 YEARS OF EXCELLENCE

**SHAWVER
TRACT H
0.465 ACRE**

Lying in Section 6, Town 3, Range 14, Harrison Township, Logan County, Ohio.

Being out of the Thomas F. Shawver, John L. Shawver and Charyl Ann Winner original 76.182 acre tract as deeded and described in Official Record 807, Page 890, Tract I of the Logan County Records of Deeds and being more particularly described as follows:

Beginning at a 5/8 inch iron rod found at the southeast corner of Shady Knolls Allotment No. 3 (Plat Cabinet A, Slide 421) on the intersection of the south right-of-way of Charyl Street and the east right-of-way of John Street.

THENCE, with the south right-of-way of Charyl Street (60 feet wide), N 85°-03'-58"W, a distance of 730.05 feet to a 5/8 inch iron rod set at the TRUE POINT OF BEGINNING.

THENCE, S 4°-35'-15"W, a distance of 150.00 feet to a 5/8 inch iron rod set.

THENCE, N 85°-03'-58"W, a distance of 135.00 feet to a 5/8 inch iron rod set.

THENCE, N 4°-35'-15"E, a distance of 150.00 feet to a 5/8 inch iron rod set on the south right-of-way of Charyl Street.

THENCE, with the south right-of-way of Charyl Street, S 85°-03'-58"E, a distance of 135.00 feet to the point of beginning.

Containing 0.465 acre.

The basis for bearings is the center-line of County Highway 130, being N 36°-07'-00"W, and all other bearings are from angles and distances measured in a field survey by Lee Surveying and Mapping Co., Inc. on February 28, 2006.



ORIGINAL STAMP IN GREEN

Description prepared by:

Jeffrey I. Lee
Professional Surveyor 6359
February 28, 2006

3377016A

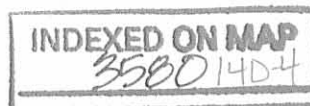

2221D 39-06 SMM OK

Lee Surveying and Mapping Co., Inc.

Land Surveys • Topography • Subdivisions • Construction Layout

117 N. Madriver St.
Bellefontaine OH 43311

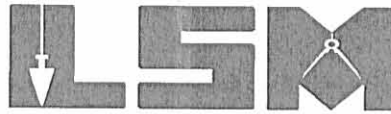

Phone: (937) 593-7335
Fax: (937) 593-7444

1975-2005 - 30 YEARS OF EXCELLENCE

**SHAWVER
TRACT J
0.465 ACRE**

Lying in Section 6, Town 3, Range 14, Harrison Township, Logan County, Ohio.

Being out of the Thomas F. Shawver, John L. Shawver and Charyl Ann Winner original 76.182 acre tract as deeded and described in Official Record 807, Page 890, Tract I of the Logan County Records of Deeds and being more particularly described as follows:

Beginning at a 5/8 inch iron rod found at the southeast corner of Shady Knolls Allotment No. 3 (Plat Cabinet A, Slide 421) on the intersection of the south right-of-way of Charyl Street and the east right-of-way of John Street.

THENCE, with the south right-of-way of Charyl Street (60 feet wide), N 85°-03'-58"W, a distance of 595.05 feet to a 5/8 inch iron rod set at the TRUE POINT OF BEGINNING.

THENCE, S 4°-35'-15"W, a distance of 150.00 feet to a 5/8 inch iron rod set.

THENCE, N 85°-03'-58"W, a distance of 135.00 feet to a 5/8 inch iron rod set.

THENCE, N 4°-35'-15"E, a distance of 150.00 feet to a 5/8 inch iron rod set on the south right-of-way of Charyl Street.

THENCE, with the south right-of-way of Charyl Street, S 85°-03'-58"E, a distance of 135.00 feet to the point of beginning.

Containing 0.465 acre.

The basis for bearings is the center-line of County Highway 130, being N 36°-07'-00"W, and all other bearings are from angles and distances measured in a field survey by Lee Surveying and Mapping Co., Inc. on February 28, 2006.



ORIGINAL STAMP IN GREEN

Description prepared by:-

Jeffrey I. Lee
Professional Surveyor 6359
February 28, 2006

3377016A

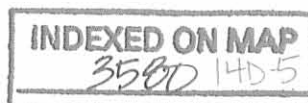

REC'D 3-9-06 SM OK
Lee Surveying and Mapping Co., Inc.

Land Surveys • Topography • Subdivisions • Construction Layout

117 N. Madriver St.
Bellefontaine OH 43311

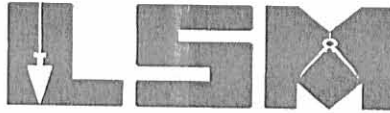

Phone: (937) 593-7335
Fax: (937) 593-7444

1975-2005 - 30 YEARS OF EXCELLENCE

**SHAWVER
TRACT K
0.465 ACRE**

Lying in Section 6, Town 3, Range 14, Harrison Township, Logan County, Ohio.

Being out of the Thomas F. Shawver, John L. Shawver and Charyl Ann Winner original 76.182 acre tract as deeded and described in Official Record 807, Page 890, Tract I of the Logan County Records of Deeds and being more particularly described as follows:

Beginning at a 5/8 inch iron rod found at the southeast corner of Shady Knolls Allotment No. 3 (Plat Cabinet A, Slide 421) on the intersection of the south right-of-way of Charyl Street and the east right-of-way of John Street.

THENCE, with the south right-of-way of Charyl Street (60 feet wide), N 85°-03'-58"W, a distance of 460.05 feet to a 5/8 inch iron rod set at the TRUE POINT OF BEGINNING.

THENCE, S 4°-35'-15"W, a distance of 150.00 feet to a 5/8 inch iron rod set.

THENCE, N 85°-03'-58"W, a distance of 135.00 feet to a 5/8 inch iron rod set.

THENCE, N 4°-35'-15"E, a distance of 150.00 feet to a 5/8 inch iron rod set on the south right-of-way of Charyl Street.

THENCE, with the south right-of-way of Charyl Street, S 85°-03'-58"E, a distance of 135.00 feet to the point of beginning.

Containing 0.465 acre.

The basis for bearings is the center-line of County Highway 130, being N 36°-07'-00"W, and all other bearings are from angles and distances measured in a field survey by Lee Surveying and Mapping Co., Inc. on February 28, 2006.



ORIGINAL STAMP IN GREEN

Description prepared by:

A handwritten signature in black ink, appearing to read 'Jeffrey I. Lee', written over a faint background.

Jeffrey I. Lee
Professional Surveyor 6359
February 28, 2006

3377016A



REC'D 3-9-06 SUM OK
Lee Surveying and Mapping Co., Inc.

Land Surveys • Topography • Subdivisions • Construction Layout

117 N. Madriver St.
Bellefontaine OH 43311

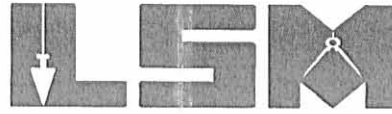

Phone: (937) 593-7335
Fax: (937) 593-7444

1975-2005 - 30 YEARS OF EXCELLENCE

**SHAWVER
TRACT L
0.465 ACRE**

Lying in Section 6, Town 3, Range 14, Harrison Township, Logan County, Ohio.

Being out of the Thomas F. Shawver, John L. Shawver and Charyl Ann Winner original 76.182 acre tract as deeded and described in Official Record 807, Page 890, Tract I of the Logan County Records of Deeds and being more particularly described as follows:

Beginning at a 5/8 inch iron rod found at the southeast corner of Shady Knolls Allotment No. 3 (Plat Cabinet A, Slide 421) on the intersection of the south right-of-way of Charyl Street and the east right-of-way of John Street.

THENCE, with the south right-of-way of Charyl Street (60 feet wide), N 85°-03'-58"W, a distance of 325.05 feet to a 5/8 inch iron rod set at the TRUE POINT OF BEGINNING.

THENCE, S 4°-35'-15"W, a distance of 150.00 feet to a 5/8 inch iron rod set.

THENCE, N 85°-03'-58"W, a distance of 135.00 feet to a 5/8 inch iron rod set.

THENCE, N 4°-35'-15"E, a distance of 150.00 feet to a 5/8 inch iron rod set on the south right-of-way of Charyl Street.

THENCE, with the south right-of-way of Charyl Street, S 85°-03'-58"E, a distance of 135.00 feet to the point of beginning.

Containing 0.465 acre.

The basis for bearings is the center-line of County Highway 130, being N 36°-07'-00"W, and all other bearings are from angles and distances measured in a field survey by Lee Surveying and Mapping Co., Inc. on February 28, 2006.



ORIGINAL STAMP IN GREEN

Description prepared by:

Jeffrey I. Lee
Professional Surveyor 6359
February 28, 2006

3377016A



REV'D 3-9-06 SMY/ek
Lee Surveying and Mapping Co., Inc.

Land Surveys • Topography • Subdivisions • Construction Layout

117 N. Madriver St.
Bellefontaine OH 43311

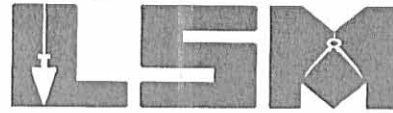

Phone: (937) 593-7335
Fax: (937) 593-7444

1975-2005 - 30 YEARS OF EXCELLENCE

**SHAWVER
TRACT M
0.465 ACRE**

Lying in Section 6, Town 3, Range 14, Harrison Township, Logan County, Ohio.

Being out of the Thomas F. Shawver, John L. Shawver and Charyl Ann Winner original 76.182 acre tract as deeded and described in Official Record 807, Page 890, Tract I of the Logan County Records of Deeds and being more particularly described as follows:

Beginning at a 5/8 inch iron rod found at the southeast corner of Shady Knolls Allotment No. 3 (Plat Cabinet A, Slide 421) on the intersection of the south right-of-way of Charyl Street and the east right-of-way of John Street.

THENCE, with the south right-of-way of Charyl Street (60 feet wide), N 85°-03'-58"W, a distance of 190.05 feet to a 5/8 inch iron rod set at the TRUE POINT OF BEGINNING.

THENCE, S 4°-35'-15"W, a distance of 150.00 feet to a 5/8 inch iron rod set.

THENCE, N 85°-03'-58"W, a distance of 135.00 feet to a 5/8 inch iron rod set.

THENCE, N 4°-35'-15"E, a distance of 150.00 feet to a 5/8 inch iron rod set on the south right-of-way of Charyl Street.

THENCE, with the south right-of-way of Charyl Street, S 85°-03'-58"E, a distance of 135.00 feet to the point of beginning.

Containing 0.465 acre.

The basis for bearings is the center-line of County Highway 130, being N 36°-07'-00"W, and all other bearings are from angles and distances measured in a field survey by Lee Surveying and Mapping Co., Inc. on February 28, 2006.



ORIGINAL STAMP IN GREEN

Description prepared by:

Jeffrey I. Lee
Professional Surveyor 6359
February 28, 2006

3377016A

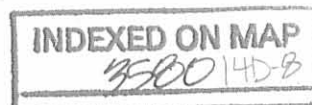

REC'D 3-9-06 S.M.J. OK

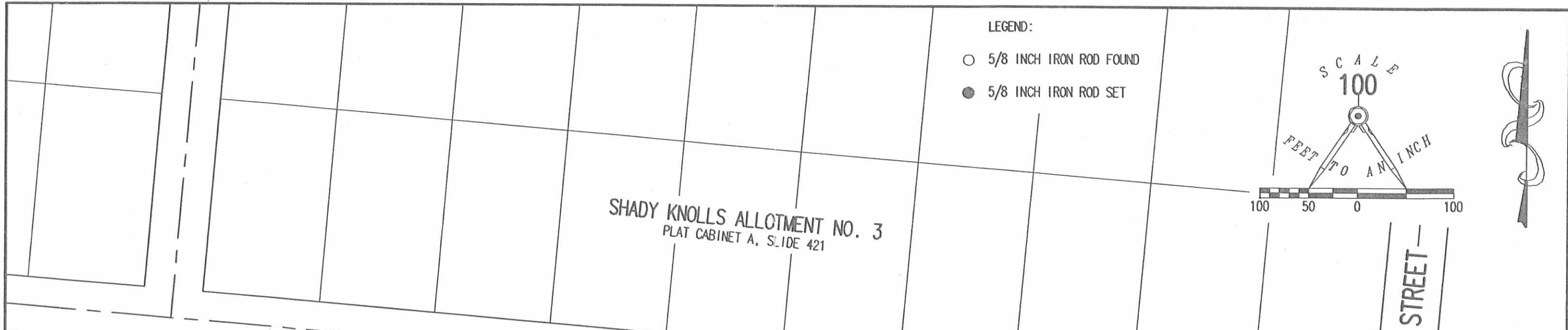

SHADY KNOLLS ALLOTMENT NO. 3
PLAT CABINET A, SLIDE 421

LEGEND:
 ○ 5/8 INCH IRON ROD FOUND
 ● 5/8 INCH IRON ROD SET

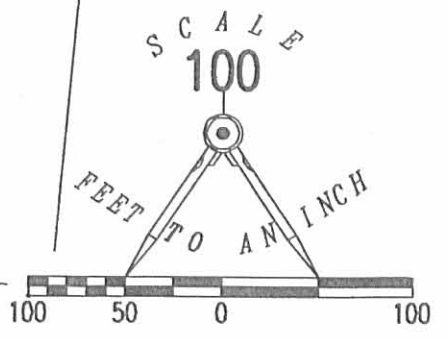

DORIS A. DYER
1.517 ACRES
O.R. 673, PG. 99

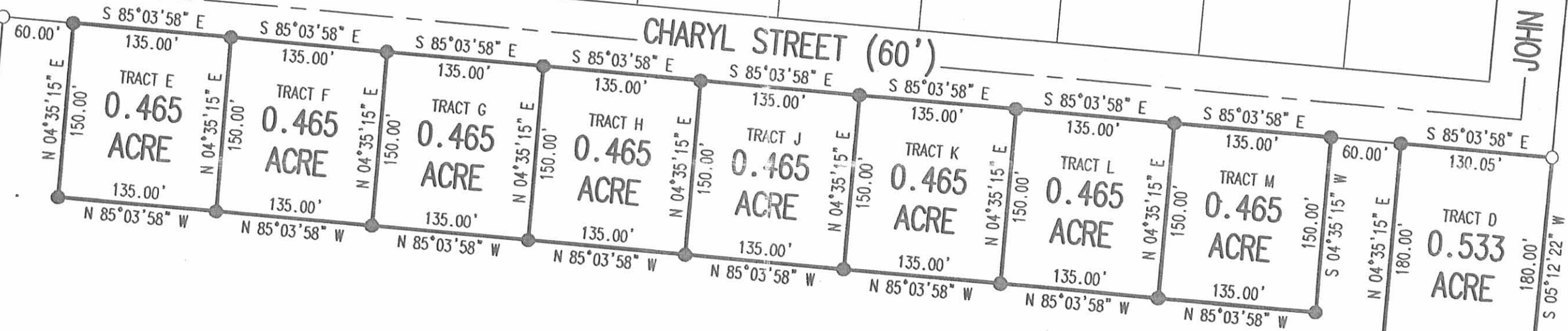

THOMAS F. SHAWER,
JOHN L. SHAWER AND
CHARYL ANN WINNER
76.182 ACRES
O.R. 807, PG. 890
TRACT I

SURVEY OF NINE TRACTS OUT OF THE
 THOMAS F. SHAWER,
 JOHN L. SHAWER AND
 CHARYL ANN WINNER
 76.182 ACRE TRACT
 OFFICIAL RECORD 807, PAGE 890
 TRACT I
 SECTION 6, TOWN 3, RANGE 14
 HARRISON TOWNSHIP
 LOGAN COUNTY, OHIO

ROBERTA J. DROWN
ORIGINAL 145.37 ACRES
O.R. 349, PG. 094
TRACT II

NOTE:
 THE BASIS FOR BEARINGS IS THE CENTER-LINE OF
 COUNTY HIGHWAY 130, BEING N 36°-07'-00"W.

2 WORKING DAYS
BEFORE YOU DIG
 CALL TOLL FREE 800-362-2764
 OHIO UTILITIES PROTECTION SERVICE



SURVEYED BY:
 JEFFREY I. LEE
 PROFESSIONAL SURVEYOR 6359
 FEBRUARY 28, 2006

COPYRIGHT 2006 BY:
 LEE SURVEYING & MAPPING CO., INC.
 117 North Medriver Street
 BELLEFONTAINE, OHIO 43311
 (937) 593-7335

KSR D0206 3377016A 3377016.ASC L-3377-2

INDEXED ON MAP
3580 14P

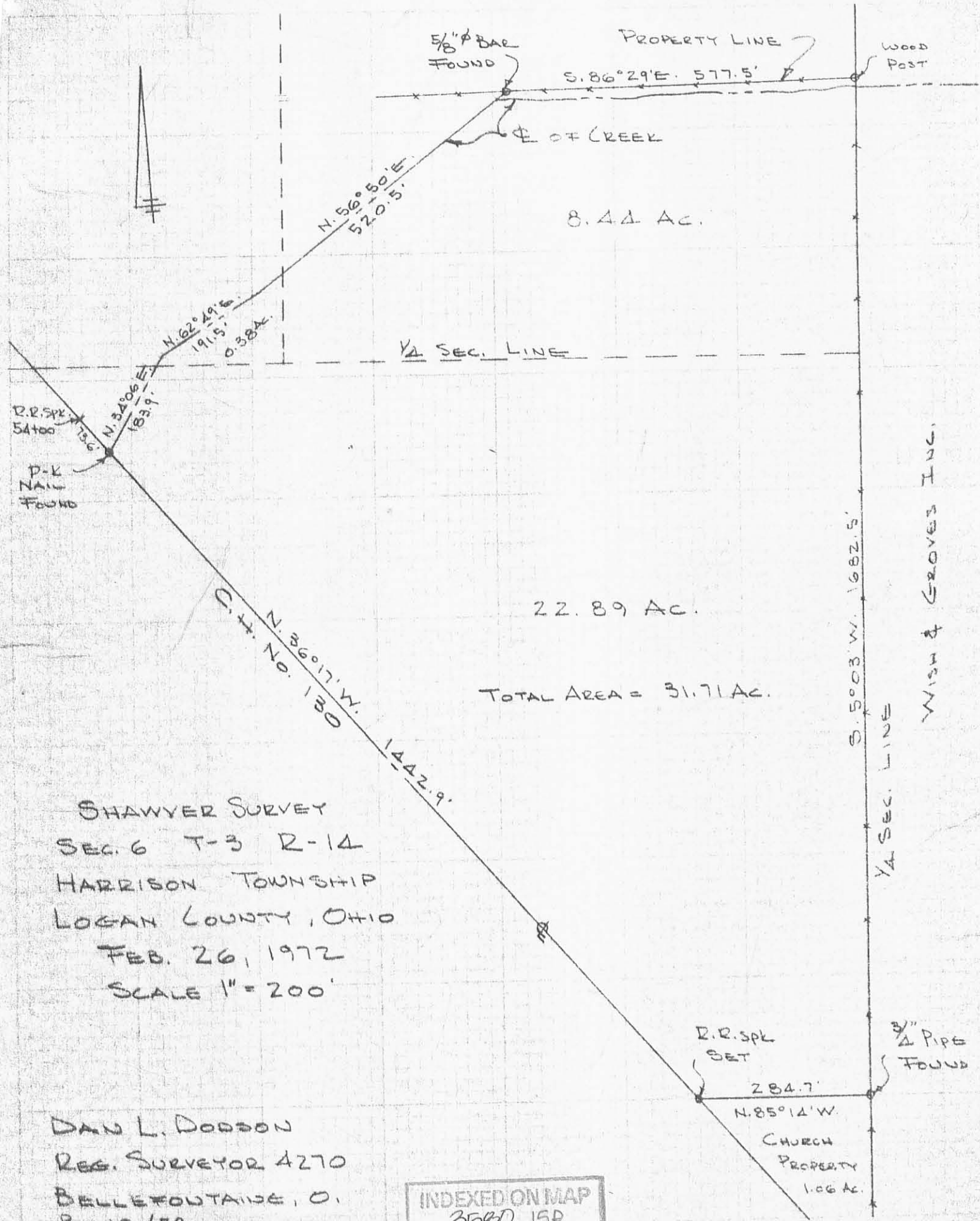

22.89 AC.
 TOTAL AREA = 31.71 AC.

SHAWYER SURVEY
 SEC. 6 T-3 R-14
 HARRISON TOWNSHIP
 LOGAN COUNTY, OHIO
 FEB. 26, 1972
 SCALE 1" = 200'

DAV L. DODSON
 REG. SURVEYOR 4270
 BELLEFONTAINE, O.
 BK 18/59

INDEXED ON MAP
 3580 15P

WISH & GROVES INC.

CHURCH
 PROPERTY
 1.06 AC.