

38

Surrey
556

8518

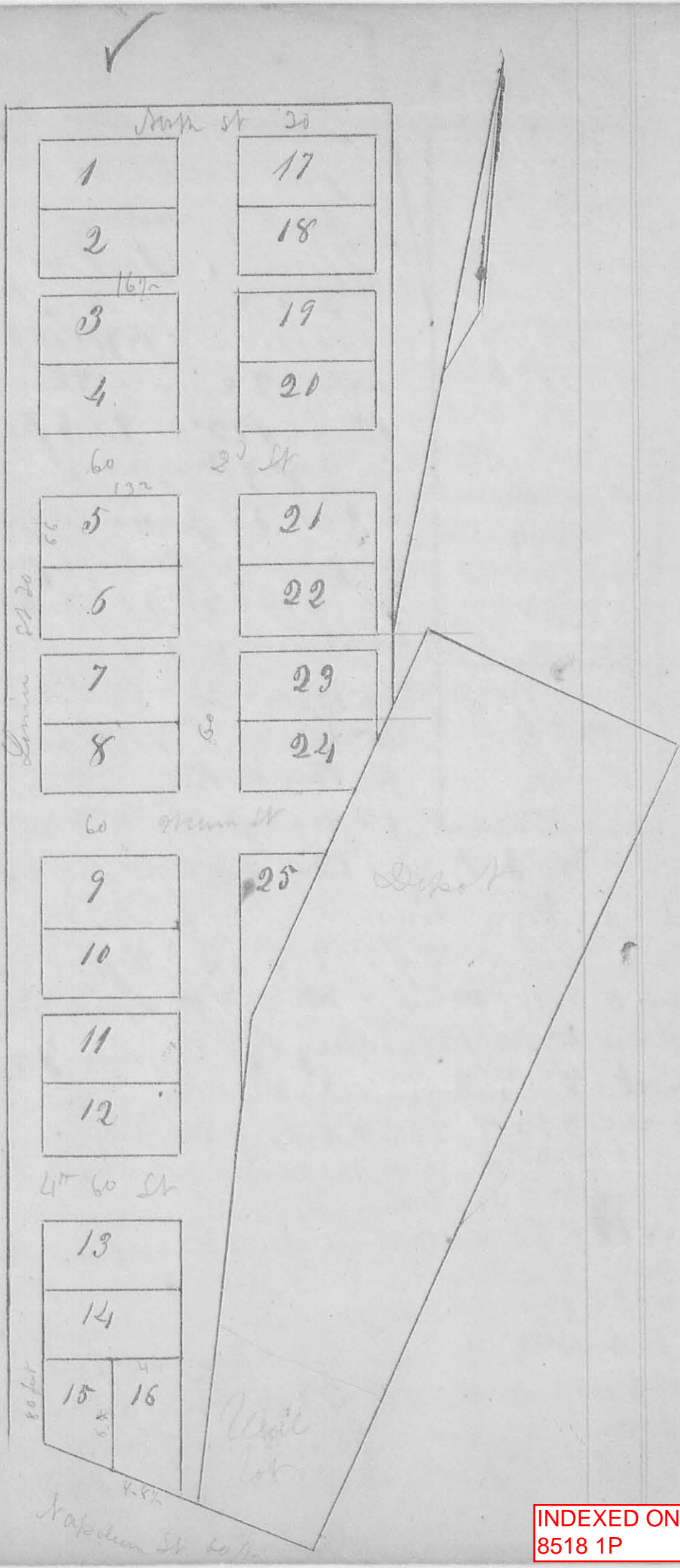

Lots from 9 to 16
including are on
Theo. Wickert's land
The other lots are
on G. Hervey's land

INDEXED ON MAP
8518 1P

Survey
557

The Annexed Diagram represents the town plat of Huntsville Surveyed September the 29th 1846 for George Hoyer on Survey no 9904.

Time & North Streets are each 30ft wide All the other streets are each 60ft wide. All the alleys are each 16 1/2 ft wide. Lots one to 23 ~~are~~ Except 15 & 16 are each 1/2 poles by 8 poles. Lot 15 is 1/2 poles & 14 ft on an Time Street, 1/2 poles 3 1/2 ft on Napoleon Street, 6 poles 8 inches on East line and on North line. Lot 16 is 6 poles 8 inches on West line, 1/2 poles 8 1/2 ft on Napoleon Street 7 poles 12 ft on East line & 1/2 poles on North line.

A Stone is planted at N.W. corner of Lot 1st. Time Street bears N 10° 36' W. All other Streets & alleys parallel & at right angles with it except Napoleon Street which bears S E. Lot 24 is 1 p 4 ft 3 inches on East side, 3 poles on South East side & 6 poles 12 ft on South side, other sides equal to full lots

A. Harrison
C. S. L. C. C.
Abraham Scott & Chas
George M. Hoyer
Edus Viant

INDEXED ON MAP
8518 1D

INDEXED ON MAP
8518 2P

8518

Survey
574

CENTRAL RAIL ROAD

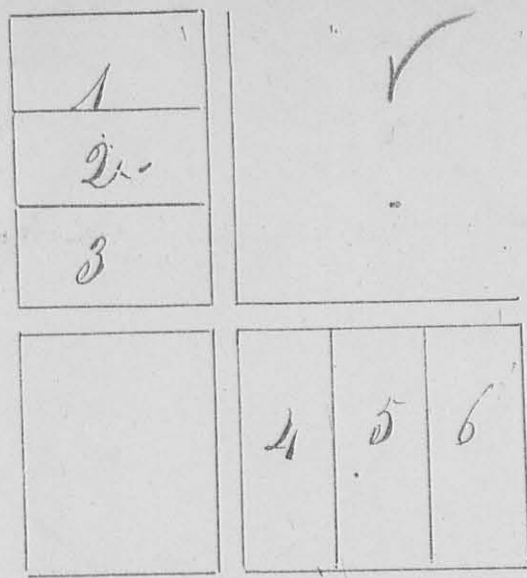

Napoleon Street

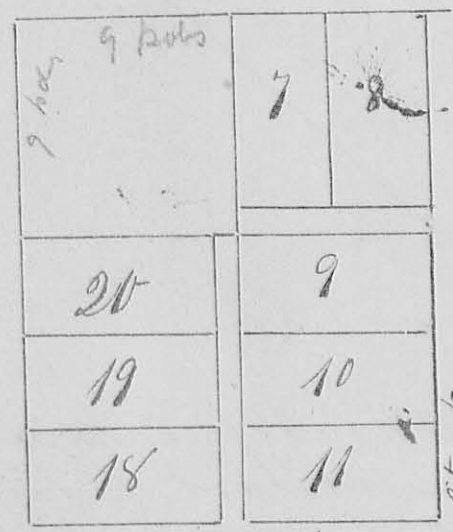

South Street

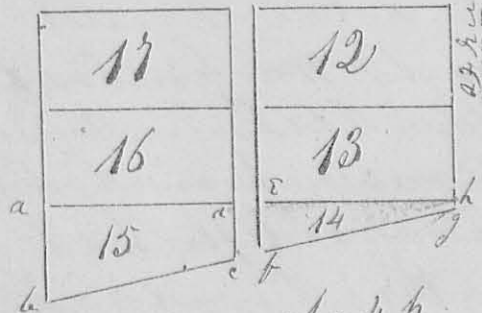

of Rail Street

Surveyed April 20th
1828 for George Horro
An addition to the town
of Monticello, as repre-
sented by the annexed plat
Napoleon Street is 60 feet
wide, South Street is fifty
feet wide & Fruit Street is
twenty five feet wide, Alleys
are each 16 feet wide. The
Lots are each 4 by 8 poles
except 14 & 15, Lots 1, 2,
3, 4 15 to 20 inclusive
front on the Rail Road
The Rail Road bears N 14° E
& Napoleon Street S 75 1/2° E
The two Squares, one on the
North side of 8 on the South of
Napoleon Street, not num-
bered are not part of the
town plat, Lots 4, 5 & 6 are
but 4 by 8 poles although represented
larger which is an error

- ab = 4 p
- bc = 8 " 3 links
- ca = 2 " 9 "
- fd = 2 " 3 "
- fg = 8 " 3 "
- gh = 1/2 p

A. Marbison
C. S. Co

Saml Horro
James Cassil
Cher

8518

159



The above diagram represents the second Eastern addition to the town of Huntsville surveyed April 18th 1849 for Samuel Hoover as follows Beginning at a planted Stone at the N.W. corner of Lot, No 21.

Lot No. 21, 22, 23, 24, 25, 26 are each 4 by 8 poles containing 32 square perches -

Lot No. 27 is 4 poles on the West and 2 on the East end 8 poles on the North and $8\frac{2}{5}$ poles on the south side containing 24 square perches -

Lot No. 28 is $8\frac{2}{3}$ poles on the West and $8\frac{2}{5}$ poles on the East and 4 on the North and 6 on the South side containing 44 sq. perches -

Napoleon and South Streets bear S 75° E Spruce Street N 13° E.

J. P. Wallace
Thos. Wishart & Co.

O. Hayes Surd. Co.

160

No 651

Surveyed March 26th 1849
for James Sarghead in
Military Survey No 9904 on Cherokee way

8562

Run a lot of land as follows Beginning
at a stake in the Napoleon road thence
N 11° W 102 poles to a stake, thence N 78 3/4° E
6 3/4 poles to a stake, thence S 19° E 97 1/2 poles
to a stake, thence N 78 1/2° W 7 poles to a stake
in a field thence S 11° E 13 3/4 poles to a stake
in the aforesaid Road thence N 78 1/2° W
13 1/2 poles to the Beginning containing
8 Acres.

Ebenezer Bane

Thos Morton S ch. ex.

O. Hayes Sur. L.C.O.

No 652

Surveyed March 26/49 for the heirs
of George Hoover deceased a lot of ground
adjoining the town of Huntsville as
follows Beginning at the S.E. corner of
lot No 6 in the Eastern addition to said
town thence S 14° E 42 1/6 poles to a stake in
the South end of Fruit street in said town
thence S 87° E 10 poles to a stake, thence
N 14° W 3 1/2 poles to the Centre of the Napo-
leon Road, thence 4 poles to a stake in the
aforesaid road, thence N 13° E 8 2/3 poles to a
stake, thence N 65 1/2° W 4 poles to the Beginning
containing 2 Acres and 75 perches, also laid
off a lot on the N. side of the aforesaid E.
addition to the town of Huntsville, ^{Beginning} at a
stake at the N.W. corner of lot No 1 thence
N 14° E 10 1/3 poles to a stake, thence S 45 1/2° E 10 1/2 p.
to a stake, thence S 10° W 5 1/3 poles to a stake
thence N 76° W 9 3/5 poles to the Beginning contain-
ing 70 perches

8518

John S. Wallace
Thos. M. Hart } ch. ex.

O. Hayes Sur. L.C.O.

INDEXED ON MAP
8518 4D

No 653

8518

Surveyed March 26/49 for
Mishart to T. P. Wallace a part of Military Survey No 9904 on Cherokees and Run as follows Beginning at a stake in the centre of the Lima Road and at the west end of Napoleon Street in the town of Huntsville, thence S 11° E 12 poles to a stake in said road, thence N 89 1/4° E 4 poles to a stake, thence N 11 W 6 3/4 poles to a stake, thence North 3 3/4 poles to a stake, thence N 75 W 5 poles to the Beginning containing 30 perches

Samuel Hoover } Ch. Crs.
Thos Mishart }
O. Hayes Sur. G. C.

No 654

8564

Surveyed March 29th 1849 for Samuel Gish, Russell B. Mulford David Hill Philip Shaver and Samuel Miles a part of Section No 3 T. R 8 E. M. M. as follows for Gish Beginning at a Stake at the S. W. corner of the Section Burr Oak 20 S. S. S 58° E 29 links thence N 4 W 179 1/2 poles to a stake and Bitter Elm 10 S. S. N 21° E 22 links, thence N 85 3/4° E 80 1/2 poles to a stake and Swamp Ash 16 S. S. N 78 1/2 W 7 links & Swamp Ash 3 S. S. S 30 3/4° E 23 links, thence S 4 E 179 1/2 poles to a stake in the South line of the section, thence S 85 3/4° W 80 1/2 poles to the beginning containing 89.97 Acres

Gish

Also for Mulford the North part of the N. half of the N. W. q. of said section Beginning at the N. W. corner the section at a Stake Blk. Ash 30 S. S. N 77° E 31 links thence S 4° E 137 1/2 poles to a