

line or 52^o 32 poles to a stake in said line at the S.E. corner of the original survey; thence
 or 38^o N. crossing a spring branch
 several times and the road)
 250 poles to the beginning, con-
 -taining fifty acres off the east
 end of Jones' said Survey -

Lewis Sullivan }
 Levi Garwood jr. } W. Ja. M. Warron
 C. S. & Co.

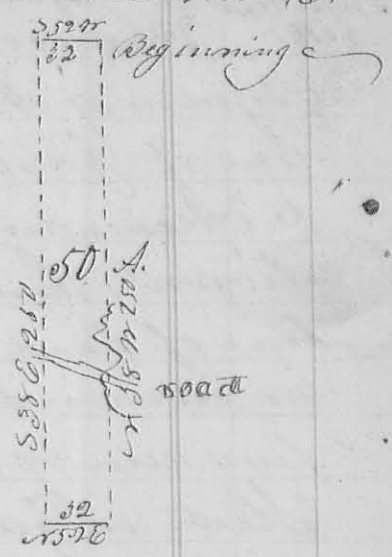

9th mo (Sept) 5th 1831

Survey No. 146

Surveyed 196³/₄ acres for Alexander Long

(8299)

Beginning at a stake & small ash bushes and sugar tree
 in the west line of James Calderwoods survey No 3137
 153³/₄ poles northerly from the south west corner of said
 survey, and at the north corner of land deced by Lucas
 Sullivan to William Jane; thence with said line N 75^o E
 crossing the road from Bellefontaine to Jamesfield at 10 poles
 a branch at 20 poles, 76.7 poles to a stake and beech in
 said line, south west corner of land conveyed by said
 Sullivan to Ebenezer Jane and N.W. corner of land con-
 veyed by said Sullivan to Alex. Long; thence S 75^o E
 crossing Sandusky street in Jamesfield at 205 poles, cross
 Mad river at 286 poles, 410 poles to a stone beech and dog wood
 in the east line of the original survey, N.E. corner to
 Alex. Long, and S.E. corner to E Jane; thence with said line
 S 75^o W 76.7 poles to a stake small Hickory and beech
 in said line, corner between Alex. Long and Wm Jane -
 - thence

Lewman A Long
 & L. Curtis



or 38^o N. crossing
 the road from Jamesfield to Melford at 65 poles, Mad river at
 134, Spring branch at 198, the road to Urbana at 248 poles,
 410 poles to the beginning containing 196³/₄ acres of the original Sur-
 vey No 3137

Robert R. Warron }
 David Jane } W. Ja. Warron
 C. S. & Co.