

Road # 183 Lake Tapp.  
V.M.S. 4399 and 3683

Stakes Placed 20' for  $\phi$

0+00 near corporation line  
of Bellefontaine.

(See Book 608 Page 53)

1352

INDEXED ON MAP

Sept. 13, 1929  
cloudy P. 74.52  
W. 10.00  
N. 10.00  
A. 10.00  
W. 10.00



$\Delta$  20° 10'

P.I. = 4+52

D = 15'

E = 6.00

T = 74.8

L = 13 V. 80'

P.O. = 3+77.4

P.T. = 5+11.62

P.S. = 4+52



P.O. = 0+00

P.I. = 3+11.62

P.T. = 1+75

$\Delta$  10° 30'

D = 6'

T = 59.77

E = 4.03

L = 17.3

1730  
x x x



Road # 185

217-00  
217-20  
142-40

300  
217-20  
142-40

1352  
INDEXED ON MAP

Land to Right of P.I.

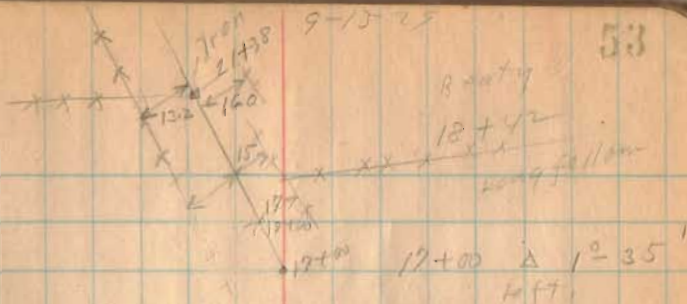

53



PI = 8+30.2  
PC = 7+90  
PT = 8+76

$R = 191.11'$

$D = 30^{\circ}$

$\Delta = 37^{\circ} 50'$

$E = 11.05'$

$T = 66.25'$

$L = 12^{\circ}$

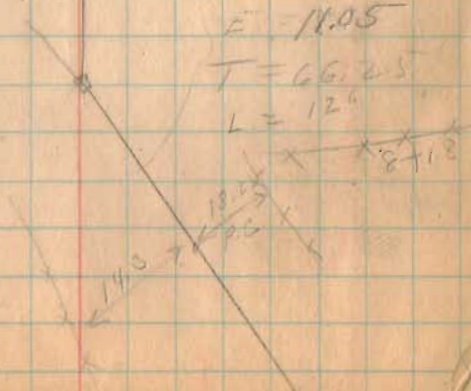

8+12