

Section corner of Heater-King line  
on Road 199

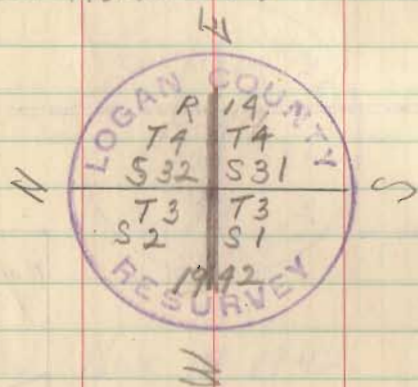

Stamped Nov 19 1942 R.M.P.

G.C. McKeep  
F. Hurst  
R.M. Garvey  
9-14-42

6

Rd 199 - Cor 31-32 T4R14  
1-2 T3R14

Found one stone on top of  
larger pointed stone (covered by piece  
of strap iron) with broken brick  
around.

Set concrete marker 6" below surface

