

274

N389

9447

#12052

Surveyed September 28, 1837 for David Scott Hittell
 Survey No 6476 as follows - Beginning 2 Ash & 2
 Hickories NW Corner to Michael Rudolph Survey
 No 9902 thence N5°W 102 poles to a Run oak hick
 ory of Small Ash the Southeast corner to Walter Penn
 Survey No 10951 thence with his Line S78°W 214 poles to
 2 Red oaks Small Run Oak & Hickory in Roberts Line
 thence with said Line S24°30'E 102 poles to 2 Whitewoaks
 & an Ash thence N78°E 180 poles to the beginning
 Containing 124³/₄ acres.

Dan Hopkins Co. Sw. 46

N390

8290

Surveyed Oct 1837 for James Wall the N half of Sect
 4 T4. R13 M. R. 5 as follows Beginning at a Run
 Oak 12 Inches diameter N52°E 17 Links, a Stone in a
 State road thence N89³/₄°W 80 ch 50 L. to a Stone a Wh.
 Oak 20 I.D. S44°W 10 Links, thence S0°20'W 40 ch 62 Links
 to a White Oak 10 I.D. S77°W 12 Links and Hickory 8 I.D.
 N37°E 16 Links, thence the original q. corner, thence S89°30'E
 80 ch 75 Links to a Jack Oak 12 I.D. N84°E 31 Links, and
 Jack Oak 8 I.D. S7°E 35 Links in the East Line of the
 Section thence with said Line N40° chain to the beginning
 Containing 9325 acres -

Dan Hopkins Co. Sw. 46

N°391

8416

Surveyed for Pollock the NW. q. and part of the SW
 quarter of S34 T5. R13 M. R. 5 as follows. Beginning
 as in the foregoing Survey, thence with the Section Line
 South 60 chain to a Jack oak 12 I.D. N84°E 31 Links
 and Jack Oak 8 I.D. S7°E 35 Links thence S89°E 5 chain
 to a Jack Oak 8 I.D. N76°W 13 Links and Jack oak
 South 8 Links, thence South 40 chain crossing a hand
 to a Jack oak 8 I.D. N7°W 5 Links, and southerly point of
 a Rock bean S69°W 30 Links in the South line of the
 Section, thence with said Line S89°E 37 ch. 65 Links -
 crossing a Small branch to a Stone in a prairie

Center of said Section Six - thence North each 75^o E 275.
 to a White Oak 22^o S 72 W 30 Links, and a Stone in the
 N. Line of the Section, thence with said Line ^{West} 42 ch.
 65 Links, to the beginning. Containing 322⁷³/₁₀₀ acs.
 Oct 1837 Dan Hopkins Sec. Sur. G. O.

N. 392

Survey for Meetinghouse Lot near Peter Kelly Oct 1837
 Beginning west 3 chains South 30 feet from the N. E. Corner
 of S23.25 R13 M. r. s at a White Oak 18 inches diameter S 53 E
 12 Links thence South 2^o chain to a black oak 3 inches diam
 52 ft 6 Links thence S 20 E 97 Links thence West 2 chain
 50 Links to a Hickory 2 in. dia N 52 E 5 Links thence North 2 chain
 to a Hickory 6 in. dia South 6 Links thence East 2 chain 50 L.
 to the beginning Containing one half acre.
 Oct 1837 D. Hopkins Sec. Sur. G. O.

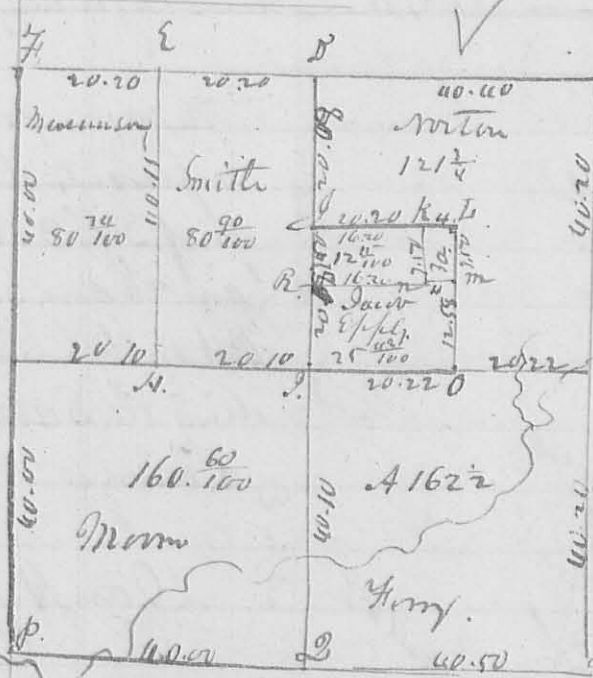

b. The annexed plat represents the
 Survey and Subdivision of S2679 R
 14 M. R. s for Hony Mormon & others
 made Nov. 15 1837. The variation
 of the original line is 30^o E from
 their original Magnetic bearing
 the division line B. O. A. L. bears
 N 89. 60 W. The line D. J. P. bears
 N. 20 E. The other the same course
 The Description of corners is as
 follows:

N. 393
 3 acres
 for
 S. Clayton

A. A. Stone. D. Elm 10 S. D. N 62 25 E. R. O. 40 D. N 75 W 10 Links
 B. Stone. E. N. O. 18 S. D. S 34 E 29 L. M. O. 18 S. D. N 58 W 38 Links
 C. N. E. L. of Sub. F. 130 O. Corner to G. Stake in a Prairie -
 G. Stone & White O. 22 S. D. S 46 W 110 L. J. White O. 15 S. D. N 75 W 20 L
 at m. r. k. Stone - Is 130. O 12 S. D. N 67 W 16. W. O. 5 S. D. N 11 E 18 Links
 J. N. O. 22 S. D. S 72 W 56 Links. K. Plum Bush 3 S. D. S 87 E 182 Links
 M. O. 22 N 2 W 54 Links. N. Hickory 1 S. D. S 15 W 16 Links. O. 1 L. W
 N 14 W 29 Links - at D. Corner between S25.26 Stone. White O.
 now 8 L. D. West 12 Links. the other bearings true down -
 J. Cuesp. S. Mormon ch. chain.
 D. Hopkins Sec. Sur. G. O.