

282

thence West 58 1/2 pole, crossing a branch at 25 pole
to a Stake in Knopf's said Lin. thence with said
Lin North 55 2/10 pole, crossing branch at 25 1/2 an
ons at 36 1/2 to the beginning. Containing 20 acs.
Peter Knopf, J. F. Knopf ch. men.

Dan Hopkins Co. S. T. C. O.

N^o 406

8426

Surveyed March 14. 1838 a Lin between William
McN^o 2^o and David Shields, Heir, as follows.

Beginning on the line dividing S. 34. T. 5. R. 13 N. W. 1/2
from north to south, and N. 69 ch 37 Links from a
Stem in the center of the South line of said Section at
a White Oak 24 1/2 ch 12 Links thence S 8 1/2 E 62, ch
65 Link to a Stem in the East Lin of said Section, and
N. 69 ch. 37 Links from J. P. Miller N. W. corner -
Dan Hopkins Co. S. T. C. O.

N^o 407

8426

Survey and Subdivision of S. 74. R. 13 N. W. 1/2 for Saml McFrank
on Dan. Joseph, Alfred Hays and Horner made March
N 23^o 1838 by J. W. Carter ch men.

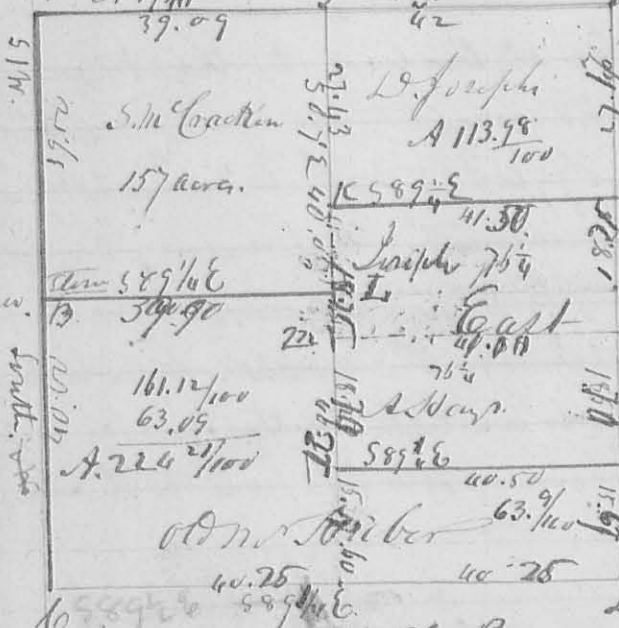

Description of Corners.

G. A. NW Corner of the Section the orig
bearing true down planted stem
and marked W. Oak 15 1/2 D 55 7/8
61 Links - B. Oak 12 D N 32 1/2
18 links planted stem. C. SW
sect corner, planted stem in
a Stake and D Bur 0 12
N 52 E 17 Links. E - Jack oak
8 1/2 D 58 9/10 65 Links. F. Bur oak 6 1/2 D N 37 1/2 8 Links ditto G. S. 6 1/2 D
64 Links. G. Stem. H. Jack oak 10 1/2 D N 10 E 11 Links. ditto
6 1/2 D 523 E 9 Links. I. Stem, orig. tree standing a white oak
20 1/2 D 542 E 29 Links. K. Stem. L. Hickory 6 1/2 D N 57 1/2 15 Links
Jack oak 3 1/2 D 564 E 18 Links. M - Bl. Oak 15 1/2
N 50 E 29 Link an an oak 500 W 15 Links -
Dan Hopkins Co. S. T. C. O.