

Mayer
No. 330

8500

Mag. Var. 1° E

Scale of Protraction
100 poles to the inch

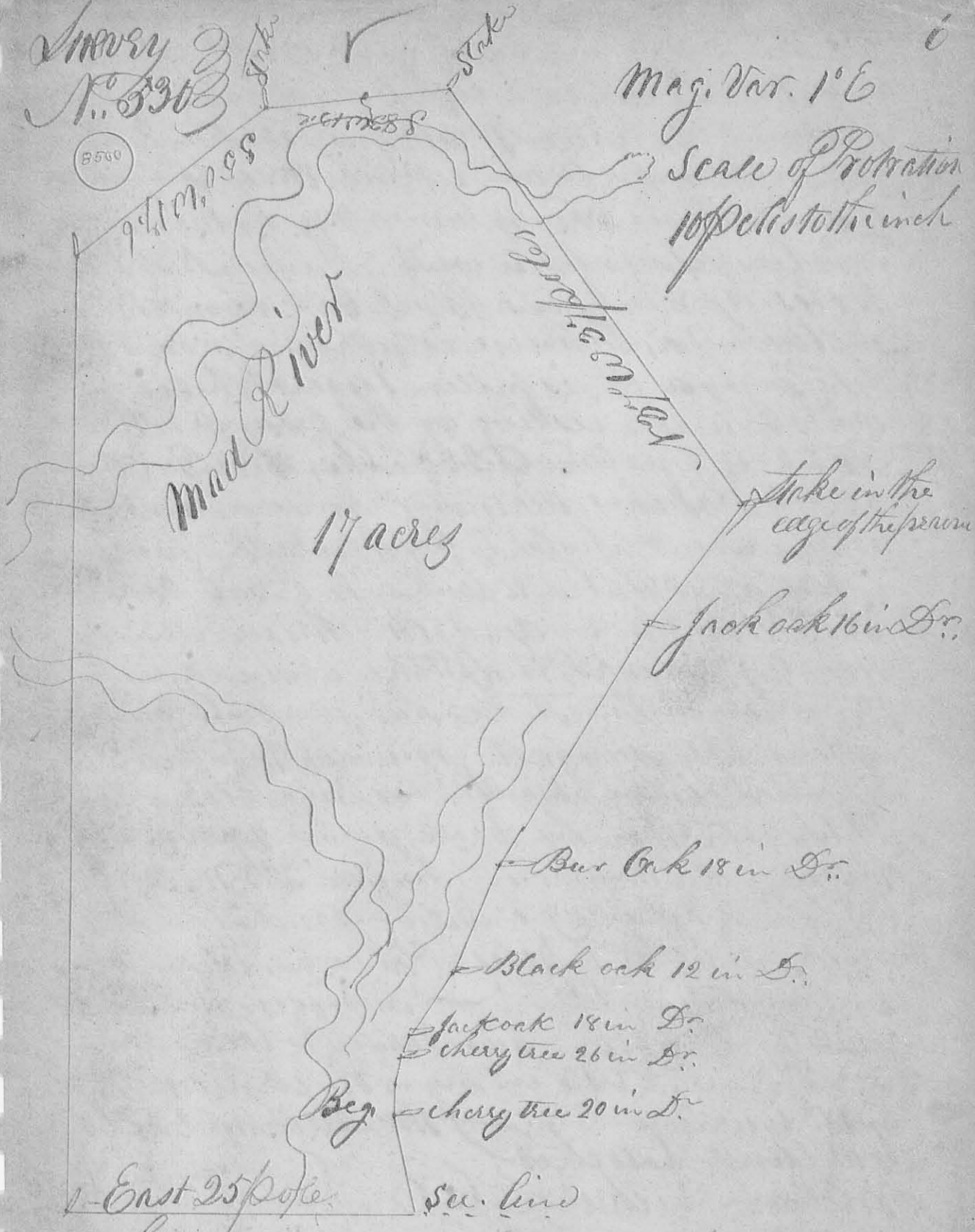

Surveyed Augt. 30th 1844 for Israel Finney as follows; Beginning at a cherry tree about 20 in diameter this tree is down, and the root of the tree bears N 9° W 7 1/10 poles from a stake in the north line of Section 26. T5. R 13 this stake is 25 poles east of the NW corner of the section; thence N 5 1/2 E 4 poles and 2 links to a cherry tree about 26 in diameter

7.
This tree is partly dead; thence $N 19^{\circ} E$ 1 pole
and 18 links, to a Jack Oak about 18 inches
in diameter, here we found the water in mad
river 20 links to our left hand at the mouth
of a Branch this tree is turned up by the roots
and lies towards the west; thence $N 35^{\circ} E$
6 poles 6 links to a Black Oak about 12 inches
in diameter, this tree is broken off about 15
feet high and is fallen towards the east
with the top resting on the ground; thence
 $N 20^{\circ} E$ 8 poles and 20 links, to a Bur Oak
about 18 inches diameter here we found
water about 1 pole to left hand; thence
 $N 30^{\circ} E$ 20 poles 11 links, to a Bur Oak
about 16 inches in diameter; thence $N 33^{\circ} E$
11 poles 5 links, to a stake in the edge of
the prairie, this stake stands about one
pole & a half from fast ground; thence $N 37^{\circ} W$
37 poles crossing Mad River, to a stake, this
stake stands on the bank about 2 poles from
the edge of the prairie; thence $S 83^{\circ} W$ 13 poles
& 5 links, crossing a Spring branch to a stake
thence $S 50^{\circ} W$ 17 poles & 15 links, to a stake
in the Section line; — Surveyed for Isaac
Powers as above; this Survey is located on
Sec 27, T. 5. R. 13 in the S. W. corner of the
S. W. Quarter
Garland Crocker
William Vickers C. C.