

Summary of Great Survey

17.91
15.04
2.87

S 21 an the T 5 R 13
Hogrow
H. H. H. T.P. (-?)

See also pages 62 to 71 this book



$$\tan \frac{1}{2}(B+C) = \frac{c-b}{a+c}$$

$$\tan \frac{1}{2}(B+C) = \frac{13-11}{15.04+15}$$

$$B+C = 24' \quad \tan \frac{12}{15.04} = .0020$$

$$L+c = 32.96$$

$$L-c = 2.87$$

$$\tan \frac{1}{2}(B+C) = \frac{2.87}{32.96} = .00087$$

$$\frac{1}{2}(B+C) = 12'$$

$$\frac{1}{2}(B+C) = 12'$$

$$C = 13'$$

$$B = 11'$$

2.87 / 15.04 = .000191
15.04 / 17.91 = .000838
15.04 / 15 = .000669

1019.04 / 15700 = .0000649
15.04 / 15 = .000669

32.96

CAL. C.P.M. C.P. 3/20/00

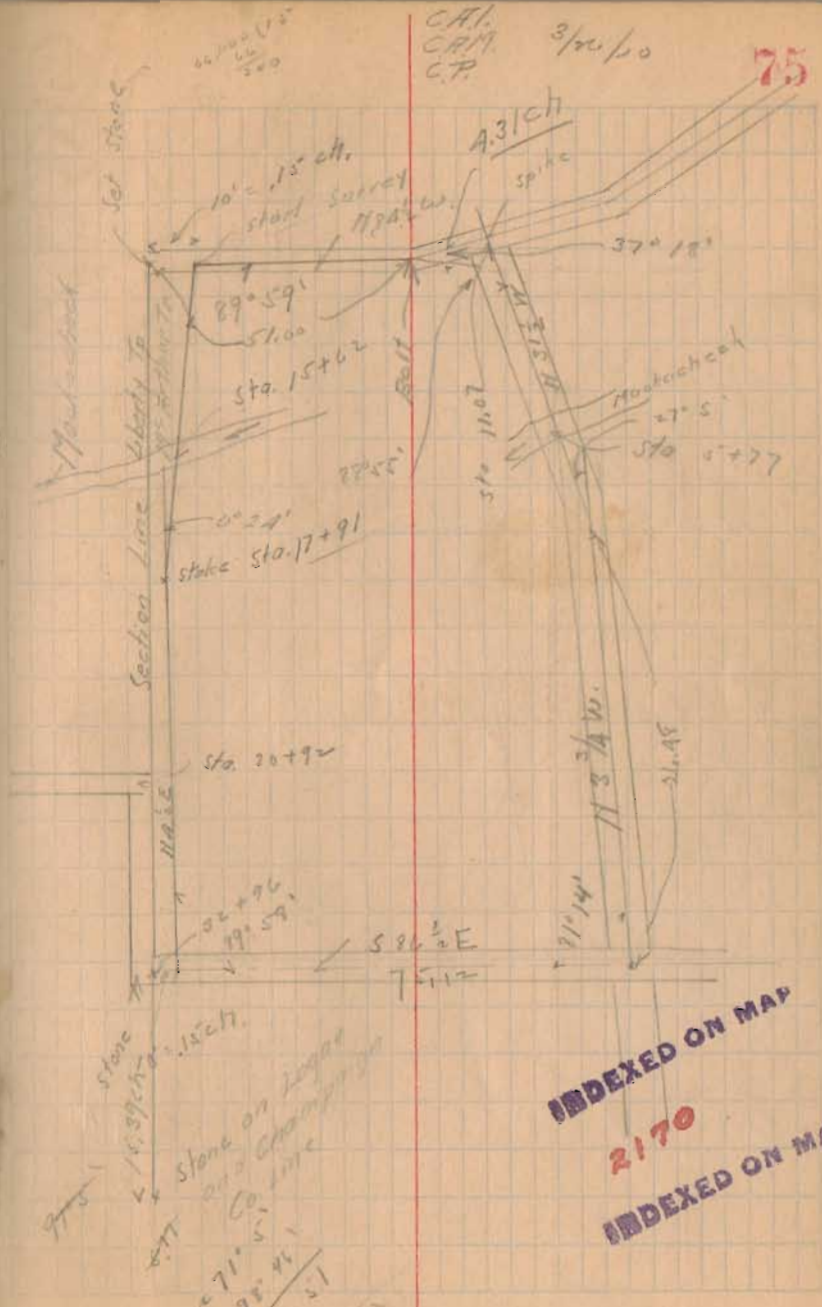

INDEXED ON MAP

2170

INDEXED ON MAP

975
1019.04 / 15700 = .0000649
15.04 / 15 = .000669
32.96 / 15 = 2.1973