

Lee Surveying and Mapping Co., Inc.

Land Surveys • Topography • Subdivisions • Construction Layout

117 N. Madriver St.
Bellefontaine OH 43311



Phone: (937) 593-7335
Fax: (937) 593-7444

BAILEY 5.142 ACRES TRACT 1-A

Lying in Section 22, Town 5, Range 13, Miami Rivers Survey, Monroe Township, Logan County, Ohio

Being out of the Vincent R. Bailey, Trustee of the Vincent R. Bailey Trust, dated April 11, 1995 original 68.711 acre tract (Tract II, Parcel 2) and 72.410 acre tract (Tract IV) as deeded and described in Official Record 254, Page 306 of the Logan County Records of Deeds and being more particularly described as follows:

Beginning at a 5/8 inch iron rod set at the northwest corner of the southwest quarter of Section 22 and in the center-line of Township Road 173 (40 feet wide).

THENCE, with the north line of the southwest quarter of Section 22 and the center-line of Township Road 173, S 84°-31'-06"E, a distance of 2387.84 feet to a MAG nail set, at the TRUE POINT OF BEGINNING.

THENCE, continuing with the north line of the southwest quarter of Section 22 and the center-line of Township Road 173, S 84°-31'-06"E, a distance of 273.30 feet to a MAG nail set.

THENCE, S 5°-50'-00"W, a distance of 819.65 feet to a 5/8 inch iron rod set, passing a 5/8 inch iron rod set at 20.00 feet.

THENCE, N 84°-31'-06"W, a distance of 273.30 feet to a 5/8 inch iron rod set.

THENCE, N 5°-50'-00" E, a distance of 819.65 feet to the point of beginning, passing a 5/8 inch iron rod set at 799.65 feet.

Containing 5.142 acre, of which 0.125 acre is within the highway right-of-way.

The basis for bearings is the south line of Section 22, being N 85°-00'-00"W, and all other bearings are from angles and distances measured in a field survey by Lee Surveying and Mapping Co., Inc. on January 6, 2004.

Description prepared by:



ORIGINAL STAMP IN GREEN

Jeffrey I. Lee
Jeffrey I. Lee
Professional Surveyor 6359
January 13, 2004

L-3713

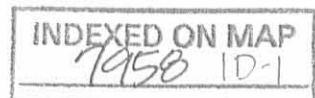

Lee Surveying and Mapping Co., Inc.

Land Surveys • Topography • Subdivisions • Construction Layout

117 N. Madriver St.
Bellefontaine OH 43311



Phone: (937) 593-7335
Fax: (937) 593-7444

BAILEY 5.142 ACRES TRACT 2-B

Lying in Section 22, Town 5, Range 13, Miami Rivers Survey, Monroe Township, Logan County, Ohio

Being out of the Vincent R. Bailey, Trustee of the Vincent R. Bailey Trust, dated April 11, 1995 original 72.410 acre tract as deeded and described in Official Record 254, Page 306 (Tract IV) of the Logan County Records of Deeds and being more particularly described as follows:

Beginning at a 5/8 inch iron rod set at the northwest corner of the southwest quarter of Section 22 and in the center-line of Township Road 173 (40 feet wide).

THENCE, with the north line of the southwest quarter of Section 22 and the center-line of Township Road 173, S 84°-31'-06"E, a distance of 2661.14 feet to a MAG nail set, at the TRUE POINT OF BEGINNING.

THENCE, continuing with the north line of the southwest quarter of Section 22 and the center-line of Township Road 173, S 84°-31'-06"E, a distance of 273.30 feet to a MAG nail set.

THENCE, S 5°-50'-00"W, a distance of 819.65 feet to a 5/8 inch iron rod set, passing a 5/8 inch iron rod set at 20.00 feet.

THENCE, N 84°-31'-06"W, a distance of 273.30 feet to a 5/8 inch iron rod set.

THENCE, N 5°-50'-00" E, a distance of 819.65 feet to the point of beginning, passing a 5/8 inch iron rod set at 799.65 feet.

Containing 5.142 acre, of which 0.125 acre is within the highway right-of-way.

The basis for bearings is the south line of Section 22, being N 85°-00'-00"W, and all other bearings are from angles and distances measured in a field survey by Lee Surveying and Mapping Co., Inc. on January 6, 2004.



ORIGINAL STAMP IN GREEN

Description prepared by:

Jeffrey I. Lee
Professional Surveyor 6359
January 13, 2004

L-3713

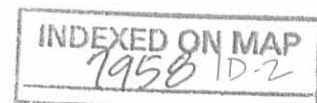

Received 1.23.04 OK gja

Lee Surveying and Mapping Co., Inc.

Land Surveys • Topography • Subdivisions • Construction Layout

117 N. Madriver St.
Bellefontaine OH 43311



Phone: (937) 593-7335
Fax: (937) 593-7444

BAILEY 5.142 ACRES TRACT 3-C

Lying in Section 22, Town 5, Range 13, Miami Rivers Survey, Monroe Township, Logan County, Ohio

Being out of the Vincent R. Bailey, Trustee of the Vincent R. Bailey Trust, dated April 11, 1995 original 72.410 acre tract as deeded and described in Official Record 254, Page 306 (Tract IV) of the Logan County Records of Deeds and being more particularly described as follows:

Beginning at a 5/8 inch iron rod set at the northwest corner of the southwest quarter of Section 22 and in the center-line of Township Road 173 (40 feet wide).

THENCE, with the north line of the southwest quarter of Section 22 and the center-line of Township Road 173, S 84°-31'-06"E, a distance of 2934.44 feet to a MAG nail set, at the TRUE POINT OF BEGINNING.

THENCE, continuing with the north line of the southwest quarter of Section 22 and the center-line of Township Road 173, S 84°-31'-06"E, a distance of 273.30 feet to a MAG nail set.

THENCE, S 5°-50'-00"W, a distance of 819.65 feet to a 5/8 inch iron rod set, passing a 5/8 inch iron rod set at 20.00 feet.

THENCE, N 84°-31'-06"W, a distance of 273.30 feet to a 5/8 inch iron rod set.

THENCE, N 5°-50'-00" E, a distance of 819.65 feet to the point of beginning, passing a 5/8 inch iron rod set at 799.65 feet.

Containing 5.142 acre, of which 0.125 acre is within the highway right-of-way.

The basis for bearings is the south line of Section 22, being N 85°-00'-00"W, and all other bearings are from angles and distances measured in a field survey by Lee Surveying and Mapping Co., Inc. on January 6, 2004.



ORIGINAL STAMP IN GREEN

Description prepared by:

Jeffrey I. Lee
Professional Surveyor 6359
January 13, 2004

L-3713

MEMBER: AMERICA CONGRESS ON SURVEYING & MAPPING (ACSM) • NATIONAL SOCIETY OF PROFESSIONAL SURVEYORS (NSPS)
PROFESSIONAL LAND SURVEYORS OF OHIO (PLSO) • SURVEYORS HISTORICAL SOCIETY

INDEXED ON MAP
7958 1D-3

Received 1-23-04 OK gcm

Lee Surveying and Mapping Co., Inc.

Land Surveys • Topography • Subdivisions • Construction Layout

117 N. Madriver St.
Bellefontaine OH 43311



Phone: (937) 593-7335
Fax: (937) 593-7444

BAILEY 5.142 ACRES TRACT 4-D

Lying in Section 22, Town 5, Range 13, Miami Rivers Survey, Monroe Township, Logan County, Ohio

Being out of the Vincent R. Bailey, Trustee of the Vincent R. Bailey Trust, dated April 11, 1995 original 72.410 acre tract as deeded and described in Official Record 254, Page 306 (Tract IV) of the Logan County Records of Deeds and being more particularly described as follows:

Beginning at a 5/8 inch iron rod set at the northwest corner of the southwest quarter of Section 22 and in the center-line of Township Road 173 (40 feet wide).

THENCE, with the north line of the southwest quarter of Section 22 and the center-line of Township Road 173, S 84°-31'-06"E, a distance of 3207.74 feet to a MAG nail set, at the TRUE POINT OF BEGINNING.

THENCE, continuing with the north line of the southwest quarter of Section 22 and the center-line of Township Road 173, S 84°-31'-06"E, a distance of 273.30 feet to a MAG nail set.

THENCE, S 5°-50'-00"W, a distance of 819.65 feet to a 5/8 inch iron rod set, passing a 5/8 inch iron rod set at 20.00 feet.

THENCE, N 84°-31'-06"W, a distance of 273.30 feet to a 5/8 inch iron rod set.

THENCE, N 5°-50'-00" E, a distance of 819.65 feet to the point of beginning, passing a 5/8 inch iron rod set at 799.65 feet.

Containing 5.142 acre, of which 0.125 acre is within the highway right-of-way.

The basis for bearings is the south line of Section 22, being N 85°-00'-00"W, and all other bearings are from angles and distances measured in a field survey by Lee Surveying and Mapping Co., Inc. on January 6, 2004.



ORIGINAL STAMP IN GREEN

Description prepared by:

Jeffrey I. Lee
Jeffrey I. Lee
Professional Surveyor 6359
January 13, 2004

L-3713

MEMBER: AMERICA CONGRESS ON SURVEYING & MAPPING (ACSM) • NATIONAL SOCIETY OF PROFESSIONAL SURVEYORS (NSPS)
PROFESSIONAL LAND SURVEYORS OF OHIO (PLSO) • SURVEYORS HISTORICAL SOCIETY

INDEXED ON MAP
7958 ID4

Received 1-23-04 orig/4
Lee Surveying and Mapping Co., Inc.

Land Surveys • Topography • Subdivisions • Construction Layout

117 N, Madriver St.
Bellefontaine OH 43311



Phone: (937) 593-7335
Fax: (937) 593-7444

**BAILEY
5.142 ACRES
TRACT 5-E**

Lying in Section 22, Town 5, Range 13, Miami Rivers Survey, Monroe Township, Logan County, Ohio

Being out of the Vincent R. Bailey, Trustee of the Vincent R. Bailey Trust, dated April 11, 1995 original 72.410 acre tract as deeded and described in Official Record 254, Page 306 (Tract IV) of the Logan County Records of Deeds and being more particularly described as follows:

Beginning at a 5/8 inch iron rod set at the northwest corner of the southwest quarter of Section 22 and in the center-line of Township Road 173 (40 feet wide).

THENCE, with the north line of the southwest quarter of Section 22 and the center-line of Township Road 173, S 84°-31'-06"E, a distance of 3481.04 feet to a MAG nail set, at the TRUE POINT OF BEGINNING.

THENCE, continuing with the north line of the southwest quarter of Section 22 and the center-line of Township Road 173, S 84°-31'-06"E, a distance of 273.30 feet to a MAG nail set.

THENCE, S 5°-50'-00"W, a distance of 819.65 feet to a 5/8 inch iron rod set, passing a 5/8 inch iron rod set at 20.00 feet.

THENCE, N 84°-31'-06"W, a distance of 273.30 feet to a 5/8 inch iron rod set.

THENCE, N 5°-50'-00" E, a distance of 819.65 feet to the point of beginning, passing a 5/8 inch iron rod set at 799.65 feet.

Containing 5.142 acre, of which 0.125 acre is within the highway right-of-way.

The basis for bearings is the south line of Section 22, being N 85°-00'-00"W, and all other bearings are from angles and distances measured in a field survey by Lee Surveying and Mapping Co., Inc. on January 6, 2004.



ORIGINAL STAMP IN GREEN

Description prepared by:

Jeffrey I. Lee
Jeffrey I. Lee
Professional Surveyor 6359
January 13, 2004

L-3713

MEMBER: AMERICA CONGRESS ON SURVEYING & MAPPING (ACSM) • NATIONAL SOCIETY OF PROFESSIONAL SURVEYORS (NSPS)
PROFESSIONAL LAND SURVEYORS OF OHIO (PLSO) • SURVEYORS HISTORICAL SOCIETY

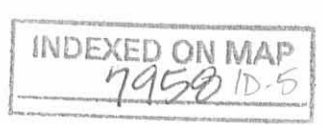

Received 1-23-04 ok gcl

Lee Surveying and Mapping Co., Inc.

Land Surveys • Topography • Subdivisions • Construction Layout

117 N. Madriver St.
Bellefontaine OH 43311

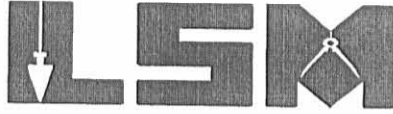

Phone: (937) 593-7335
Fax: (937) 593-7444

BAILEY 5.210 ACRES TRACT 6-F

Lying in Section 22, Town 5, Range 13, Miami Rivers Survey, Monroe Township, Logan County, Ohio

Being out of the Vincent R. Bailey, Trustee of the Vincent R. Bailey Trust, dated April 11, 1995 original 72.410 acre tract as deeded and described in Official Record 254, Page 306 (Tract IV) of the Logan County Records of Deeds and being more particularly described as follows:

Beginning at a 5/8 inch iron rod set at the northwest corner of the southwest quarter of Section 22 and in the center-line of Township Road 173 (40 feet wide).

THENCE, with the north line of the southwest quarter of Section 22 and the center-line of Township Road 173, S 84°-31'-06"E, a distance of 3754.34 feet to a MAG nail set, at the TRUE POINT OF BEGINNING.

THENCE, continuing with the north line of the southwest quarter of Section 22 and the center-line of Township Road 173, S 84°-31'-06"E, a distance of 376.66 feet to a MAG nail set.

THENCE, S17°-48'-39"W, a distance of 20.47 feet to a 5/8 inch iron rod set.

THENCE, S 19°-35'-07"W, a distance of 254.15 feet to a 5/8 inch iron rod set.

THENCE, S 19°-35'-03"W, a distance of 570.34 feet to a 5/8 inch iron rod set.

THENCE, N 84°-31'-06"W, a distance of 176.43 feet to a 5/8 inch iron rod set.

THENCE, N 5°-50'-00" E, a distance of 819.65 feet to the point of beginning, passing a 5/8 inch iron rod set at 799.65 feet.

Containing 5.210 acre, of which 0.172 acre is within the highway right-of-way.

The basis for bearings is the south line of Section 22, being N 85°-00'-00"W, and all other bearings are from angles and distances measured in a field survey by Lee Surveying and Mapping Co., Inc. on January 6, 2004.



ORIGINAL STAMP IN GREEN

Description prepared by:

Jeffrey I. Lee
Jeffrey I. Lee
Professional Surveyor 6359
January 13, 2004

L-3713

INDEXED ON MAP
7958 1D-6

Received 1-23-04 ok jll

Lee Surveying and Mapping Co., Inc.

Land Surveys • Topography • Subdivisions • Construction Layout

117 N. Madriver St.
Bellefontaine OH 43311



Phone: (937) 593-7335
Fax: (937) 593-7444

BAILEY 5.005 ACRES TRACT 7-G

Lying in Section 22, Town 5, Range 13, Miami Rivers Survey, Monroe Township, Logan County, Ohio

Being out of the Vincent R. Bailey, Trustee of the Vincent R. Bailey Trust, dated April 11, 1995 original 72.410 acre tract as deeded and described in Official Record 254, Page 306 (Tract IV) of the Logan County Records of Deeds and being more particularly described as follows:

Beginning at a 5/8 inch iron rod set at the northwest corner of the southwest quarter of Section 22 and in the center-line of Township Road 173 (40 feet wide).

THENCE, with the north line of the southwest quarter of Section 22 and the center-line of Township Road 173, S 84°-31'-06"E, a distance of 4131.00 feet to a MAG nail set, at the TRUE POINT OF BEGINNING.

THENCE, continuing with the north line of the southwest quarter of Section 22 and the center-line of Township Road 173, S 84°-31'-06"E, a distance of 819.62 feet to a railroad spike found at the intersection of the center-lines of Township Road 173 and County Highway 47 (60 feet wide).

THENCE, with the center-line of County Highway 47, S 19°-27'-10"W, a distance of 273.80 feet to a MAG nail set.

THENCE, N 84°-34'-24"W, a distance of 819.81 feet to a 5/8 inch iron rod set, passing a 5/8 inch iron rod set at 30.94 feet.

THENCE, N 19°-35'-07"E, a distance of 254.15 feet to a 5/8 inch iron rod set.

THENCE, N 17°-48'-39" E, a distance of 20.47 feet to the point of beginning.

Containing 5.005 acre, of which 0.549 acre is within the highway rights-of-way.

The basis for bearings is the south line of Section 22, being N 85°-00'-00"W, and all other bearings are from angles and distances measured in a field survey by Lee Surveying and Mapping Co., Inc. on January 6, 2004.

Description prepared by:



ORIGINAL STAMP IN GREEN

Jeffrey I. Lee
Professional Surveyor 6359
January 13, 2004

L-3713

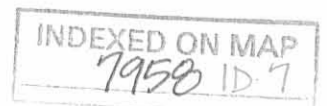

Received 1-23-04 v2 gm

Lee Surveying and Mapping Co., Inc.

Land Surveys • Topography • Subdivisions • Construction Layout

117 N. Madriver St.
Bellefontaine OH 43311



Phone: (937) 593-7335
Fax: (937) 593-7444

BAILEY 5.004 ACRES TRACT 8-J

Lying in Section 22, Town 5, Range 13, Miami Rivers Survey, Monroe Township, Logan County, Ohio

Being out of the Vincent R. Bailey, Trustee of the Vincent R. Bailey Trust, dated April 11, 1995 original 72.410 acre tract as deeded and described in Official Record 254, Page 306 (Tract IV) of the Logan County Records of Deeds and being more particularly described as follows:

Beginning at a railroad spike found in the north line of the southwest quarter of Section 22 at the intersection of center-lines of County Highway 47 (60 feet wide) and Township Road 173 (40 feet wide).

THENCE, with the center-line of County Highway 47, S 19°-27'-10"W, a distance of 273.80 feet to a MAG nail set, at the TRUE POINT OF BEGINNING.

THENCE, with the center-line of County Highway 47, S 19°-35'-03"W, a distance of 273.81 feet to a MAG nail set

THENCE, N 84°-37'-42"W, a distance of 820.01 feet to a 5/8 inch iron rod set, passing a 5/8 inch iron rod set at 30.82 feet.

THENCE, N 19°-35'-03"E, a distance of 274.62 feet to a 5/8 inch iron rod set.

THENCE, S 84°-34'-24" E, a distance of 819.81 feet to the point of beginning, passing a 5/8 inch iron rod set at 788.87 feet.

Containing 5.004 acres, of which 0.189 acre is within the highway right-of-way.

The basis for bearings is the south line of Section 22, being N 85°-00'-00"W, and all other bearings are from angles and distances measured in a field survey by Lee Surveying and Mapping Co., Inc. on January 6, 2004.



ORIGINAL STAMP IN GREEN

Description prepared by:

Jeffrey I. Lee
Professional Surveyor 6359
January 13, 2004

L-3713

INDEXED ON MAP
7958 1D-8

Lee Surveying and Mapping Co., Inc.

Land Surveys • Topography • Subdivisions • Construction Layout

117 N. Madriver St.
Bellefontaine OH 43311



Phone: (937) 593-7335
Fax: (937) 593-7444

BAILEY 5.004 ACRES TRACT 9-K

Lying in Section 22, Town 5, Range 13, Miami Rivers Survey, Monroe Township, Logan County, Ohio

Being out of the Vincent R. Bailey, Trustee of the Vincent R. Bailey Trust, dated April 11, 1995 original 72.410 acre tract as deeded and described in Official Record 254, Page 306 (Tract IV) of the Logan County Records of Deeds and being more particularly described as follows:

Beginning at a railroad spike found in the north line of the southwest quarter of Section 22 at the intersection of center-lines of County Highway 47 (60 feet wide) and Township Road 173 (40 feet wide).

THENCE, with the center-line of County Highway 47 the following two courses:

S 19°-27'-10"W, a distance of 273.80 feet to a MAG nail set.

S 19°-35'-03"W, a distance of 273.81 feet to a MAG nail set at the TRUE POINT OF BEGINNING.

THENCE, continuing with the center-line of County Highway 47, S 19°-35'-03"W, 273.81 feet to a MAG nail set.

THENCE, N 84°-40'-59"W, a distance of 820.21 feet to a 5/8 inch iron rod set, passing a 5/8 inch iron rod set at 30.95 feet.

THENCE, N 19°-35'-03"E, a distance of 274.62 feet to a 5/8 inch iron rod set.

THENCE, S 84°-37'-42" E, a distance of 820.01 feet to the point of beginning, passing a 5/8 inch iron rod set at 789.19 feet.

Containing 5.004 acres, of which 0.189 acre is within the highway right-of-way.

The basis for bearings is the south line of Section 22, being N 85°-00'-00"W, and all other bearings are from angles and distances measured in a field survey by Lee Surveying and Mapping Co., Inc. on January 6, 2004.



ORIGINAL STAMP IN GREEN

Description prepared by:

Jeffrey I. Lee
Professional Surveyor 6359
January 13, 2004

L-3713

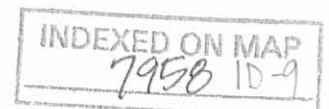

Lee Surveying and Mapping Co., Inc.

Land Surveys • Topography • Subdivisions • Construction Layout

117 N. Madriver St.
Bellefontaine OH 43311



Phone: (937) 593-7335
Fax: (937) 593-7444

BAILEY 5.004 ACRES TRACT 10-M

Lying in Section 22, Town 5, Range 13, Miami Rivers Survey, Monroe Township, Logan County, Ohio

Being out of the Vincent R. Bailey, Trustee of the Vincent R. Bailey Trust, dated April 11, 1995 original 72.410 acre tract as deeded and described in Official Record 254, Page 306 (Tract IV) of the Logan County Records of Deeds and being more particularly described as follows:

Beginning at a railroad spike found in the north line of the southwest quarter of Section 22 at the intersection of center-lines of County Highway 47 (60 feet wide) and Township Road 173 (40 feet wide).

THENCE, with the center-line of County Highway 47, the following two courses:

S 19°-27'-10"W, a distance of 273.80 feet to a MAG nail set

S 19°-35'-03"W, a distance of 547.62 feet to a MAG nail set at the TRUE POINT OF BEGINNING.

THENCE, continuing with the center-line of County Highway 47, S 19°-35'-03"W, a distance of 273.81 feet to a MAG nail set.

THENCE, N 84°-44'-17"W, a distance of 820.41 feet to a 5/8 inch iron rod set, passing a 5/8 inch iron rod set at 30.96 feet.

THENCE, N 19°-35'-03"E, a distance of 274.62 feet to a 5/8 inch iron rod set.

THENCE, S 84°-40'-59" E, a distance of 820.21 feet to the point of beginning, passing a 5/8 inch iron rod set at 789.26 feet.

Containing 5.004 acres, of which 0.189 acre is within the highway right-of-way.

The basis for bearings is the south line of Section 22, being N 85°-00'-00"W, and all other bearings are from angles and distances measured in a field survey by Lee Surveying and Mapping Co., Inc. on January 6, 2004.

Description prepared by:



ORIGINAL STAMP IN GREEN

Jeffrey I. Lee
Professional Surveyor 6359
January 13, 2004

L-3713

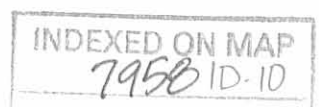

Lee Surveying and Mapping Co., Inc.

Land Surveys • Topography • Subdivisions • Construction Layout

117 N. Madriver St.
Bellefontaine OH 43311



Phone: (937) 593-7335
Fax: (937) 593-7444

BAILEY 5.003 ACRES TRACT 11-N

Lying in Section 22, Town 5, Range 13, Miami Rivers Survey, Monroe Township, Logan County, Ohio

Being out of the Vincent R. Bailey, Trustee of the Vincent R. Bailey Trust, dated April 11, 1995 original 97.44 acre tract (Tract II, Parcel 1) and 72.410 acre tract (Tract IV) as deeded and described in Official Record 254, Page 306 of the Logan County Records of Deeds and being more particularly described as follows:

Beginning at a railroad spike found in the north line of the southwest quarter of Section 22 at the intersection of center-lines of County Highway 47 (60 feet wide) and Township Road 173 (40 feet wide).

THENCE, with the center-line of County Highway 47 the following two courses:

S 19°-27'-10"W, a distance of 273.80 feet to a MAG nail set

S 19°-35'-03"W, a distance of 821.43 feet to a MAG nail set at the TRUE POINT OF BEGINNING.

THENCE, continuing with the center-line of County Highway 47 the following two courses:

S 19°-35'-03"W, a distance of 270.81 feet to a MAG nail set.

S 21°-49'-15"W, a distance of 3.00 feet to a MAG nail set.

THENCE, N 84°-47'-32"W, a distance of 820.65 feet to a 5/8 inch iron rod set, passing a 5/8 inch iron rod set at 31.04 feet.

THENCE, N 21°-49'-15"E, a distance of 4.00 feet to a 5/8 inch iron rod set.

THENCE, N 19°-35'-03"E, a distance of 270.62 feet to a 5/8 inch iron rod set.

THENCE, S 84°-44'-17" E, a distance of 820.41 feet to the point of beginning, passing a 5/8 inch iron rod set at 789.45 feet.

Containing 5.003 acres, of which 0.189 acre is within the highway right-of-way.

The basis for bearings is the south line of Section 22, being N 85°-00'-00"W, and all other bearings are from angles and distances measured in a field survey by Lee Surveying and Mapping Co., Inc. on January 6, 2004.

Description prepared by:



ORIGINAL STAMP IN GREEN

Jeffrey I. Lee
Jeffrey I. Lee
Professional Surveyor 6359
January 13, 2004

L-3713

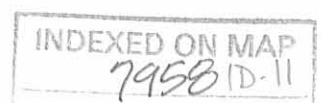

Lee Surveying and Mapping Co., Inc.

Land Surveys • Topography • Subdivisions • Construction Layout

117 N. Madriver St.
Bellefontaine OH 43311

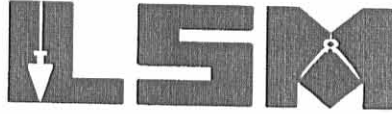

Phone: (937) 593-7335
Fax: (937) 593-7444

BAILEY 5.051 ACRES TRACT 12-P

Lying in Section 22, Town 5, Range 13, Miami Rivers Survey, Monroe Township, Logan County, Ohio

Being out of the Vincent R. Bailey, Trustee of the Vincent R. Bailey Trust, dated April 11, 1995 original 97.44 acre tract as deeded and described in Official Record 254, Page 306 (Tract II, Parcel 1) of the Logan County Records of Deeds and being more particularly described as follows:

Beginning at a railroad spike found in the north line of the southwest quarter of Section 22 at the intersection of center-lines of County Highway 47 (60 feet wide) and Township Road 173 (40 feet wide).

THENCE, with the center-line of County Highway 47 the following three courses:

S 19°-27'-10"W, a distance of 273.80 feet to a MAG nail set

S 19°-35'-03"W, a distance of 1092.24 feet to a MAG nail set

S 21°-49'-15"W, a distance of 3.00 feet to a MAG nail set at the TRUE POINT OF BEGINNING.

THENCE, continuing with the center-line of County Highway 47, S 21°-49'-15"W, a distance of 279.88 feet to a MAG nail set.

THENCE, N 84°-46'-51"W, a distance of 820.60 feet to a 5/8 inch iron rod set, passing a 5/8 inch iron rod set at 31.18 feet.

THENCE, N 21°-49'-15"E, a distance of 279.71 feet to a 5/8 inch iron rod set.

THENCE, S 84°-47'-32" E, a distance of 820.65 feet to the point of beginning, passing a 5/8 inch iron rod set at 789.61 feet.

Containing 5.051 acres, of which 0.192 acre is within the highway right-of-way.

The basis for bearings is the south line of Section 22, being N 85°-00'-00"W, and all other bearings are from angles and distances measured in a field survey by Lee Surveying and Mapping Co., Inc. on January 6, 2004.

Description prepared by:



ORIGINAL STAMP IN GREEN

Jeffrey I. Lee
Professional Surveyor 6359
January 13, 2004

L-3713

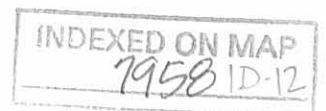

Lee Surveying and Mapping Co., Inc.

Land Surveys • Topography • Subdivisions • Construction Layout

117 N. Madriver St.
Bellefontaine OH 43311



Phone: (937) 593-7335
Fax: (937) 593-7444

BAILEY 5.093 ACRES TRACT 13-Q

Lying in Section 22, Town 5, Range 13, Miami Rivers Survey, Monroe Township, Logan County, Ohio

Being out of the Vincent R. Bailey, Trustee of the Vincent R. Bailey Trust, dated April 11, 1995 original 97.44 acre tract as deeded and described in Official Record 254, Page 306 (Tract II, Parcel 1) of the Logan County Records of Deeds and being more particularly described as follows:

Beginning at a railroad spike found in the north line of the southwest quarter of Section 22 at the intersection of center-lines of County Highway 47 (60 feet wide) and Township Road 173 (40 feet wide).

THENCE, with the center-line of County Highway 47 the following three courses

S 19°-27'-10"W, a distance of 273.80 feet to a MAG nail set

S 19°-35'-03"W, a distance of 1092.24 feet to a MAG nail set

S 21°-49'-15"W, a distance of 282.88 feet to a MAG nail set at the TRUE POINT OF BEGINNING.

THENCE, continuing with the center-line of County Highway 47 the following two courses:

S 21°-49'-15"W, a distance of 168.12 feet to an angle iron found with brick surround.

S 23°-41'-15"W, a distance of 114.77 feet to a MAG nail set.

THENCE, N 84°-50'-07"W, a distance of 820.89 feet to a 5/8 inch iron rod set, passing a 5/8 inch iron rod set at 31.64 feet.

THENCE, N 23°-41'-15"E, a distance of 116.42 feet to a 5/8 inch iron rod set.

THENCE, N 21°-49'-15"E, a distance of 167.29 feet to a 5/8 inch iron rod set.

THENCE, S 84°-46'-51" E, a distance of 820.60 feet to the point of beginning, passing a 5/8 inch iron rod set at 789.42 feet.

Containing 5.093 acres, of which 0.190 acre is within the highway right-of-way.

The basis for bearings is the south line of Section 22, being N 85°-00'-00"W, and all other bearings are from angles and distances measured in a field survey by Lee Surveying and Mapping Co., Inc. on January 6, 2004.



ORIGINAL STAMP IN GREEN

Description prepared by:

Jeffrey I. Lee
Jeffrey I. Lee
Professional Surveyor 6359
January 13, 2004

L-3713

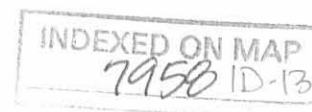

received 1-23-04 original

Lee Surveying and Mapping Co., Inc.

Land Surveys • Topography • Subdivisions • Construction Layout

117 N. Madriver St.
Bellefontaine OH 43311

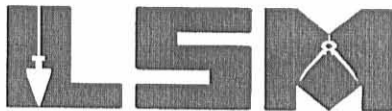

Phone: (937) 593-7335
Fax: (937) 593-7444

BAILEY 5.062 ACRES TRACT 14-R

Lying in Section 22, Town 5, Range 13, Miami Rivers Survey, Monroe Township, Logan County, Ohio

Being out of the Vincent R. Bailey, Trustee of the Vincent R. Bailey Trust, dated April 11, 1995 original 97.44 acre tract as deeded and described in Official Record 254, Page 306 (Tract II, Parcel 1) of the Logan County Records of Deeds and being more particularly described as follows:

Beginning at a railroad spike found in the north line of the southwest quarter of Section 22 at the intersection of center-lines of County Highway 47 (60 feet wide) and Township Road 173 (40 feet wide).

THENCE, with the center-line of County Highway 47 the following four courses:

S 19°-27'-10"W, a distance of 273.80 feet to a MAG nail set

S 19°-35'-03"W, a distance of 1092.24 feet to a MAG nail set

S 21°-49'-15"W, a distance of 451.00 feet to an angle iron found with brick surround

S 23°-41'-15"W, a distance of 114.77 feet to a MAG nail set at the TRUE POINT OF BEGINNING.

THENCE, continuing with the center-line of County Highway 47, S 23°-41'-15"W, a distance of 282.88 feet to a MAG nail set.

THENCE, N 84°-53'-25"W, a distance of 821.15 feet to a 5/8 inch iron rod set, passing a 5/8 inch iron rod set at 31.42 feet..

THENCE, N 23°-41'-15"E, a distance of 283.71 feet to a 5/8 inch iron rod set.

THENCE, S 84°-50'-07" E, a distance of 820.89 feet to the point of beginning, passing a 5/8 inch iron rod set at 789.25 feet.

Containing 5.062 acres, of which 0.195 acre is within the highway right-of-way.

The basis for bearings is the south line of Section 22, being N 85°-00'-00"W, and all other bearings are from angles and distances measured in a field survey by Lee Surveying and Mapping Co., Inc. on January 6, 2004.



ORIGINAL STAMP IN GREEN

Description prepared by:

Jeffrey I. Lee
Professional Surveyor 6359
January 13, 2004

L-3713

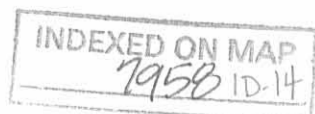

Lee Surveying and Mapping Co., Inc.

Land Surveys • Topography • Subdivisions • Construction Layout

117 N. Madriver St.
Bellefontaine OH 43311



Phone: (937) 593-7335
Fax: (937) 593-7444

BAILEY 5.062 ACRES TRACT 15-S

Lying in Section 22, Town 5, Range 13, Miami Rivers Survey, Monroe Township, Logan County, Ohio

Being out of the Vincent R. Bailey, Trustee of the Vincent R. Bailey Trust, dated April 11, 1995 original 97.44 acre tract as deeded and described in Official Record 254, Page 306 (Tract II, Parcel 1) of the Logan County Records of Deeds and being more particularly described as follows:

Beginning at a railroad spike found in the north line of the southwest quarter of Section 22 at the intersection of center-lines of County Highway 47 (60 feet wide) and Township Road 173 (40 feet wide).

THENCE, with the center-line of County Highway 47 the following four courses:

S 19°-27'-10"W, a distance of 273.80 feet to a MAG nail set

S 19°-35'-03"W, a distance of 1092.24 feet to a MAG nail set

S 21°-49'-15"W, a distance of 451.00 feet to an angle iron found with brick surround

S 23°-41'-15"W, a distance of 397.65 feet to a MAG nail set at the TRUE POINT OF BEGINNING.

THENCE, continuing with the center-line of County Highway 47, S 23°-41'-15"W, a distance of 282.88 feet to a MAG nail set.

THENCE, N 84°-56'-42"W, a distance of 821.42 feet to a 5/8 inch iron rod set, passing a 5/8 inch iron rod set at 31.66 feet.

THENCE, N 23°-41'-15"E, a distance of 283.71 feet to a 5/8 inch iron rod set.

THENCE, S 84°-53'-25" E, a distance of 821.15 feet to the point of beginning, passing a 5/8 inch iron rod set at 789.73 feet.

Containing 5.062 acres, of which 0.195 acre is within the highway right-of-way.

The basis for bearings is the south line of Section 22, being N 85°-00'-00"W, and all other bearings are from angles and distances measured in a field survey by Lee Surveying and Mapping Co., Inc. on January 6, 2004.



ORIGINAL STAMP IN GREEN

Description prepared by:

Jeffrey I. Lee
Professional Surveyor 6359
January 13, 2004

L-3713

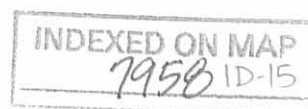

Lee Surveying and Mapping Co., Inc.

Land Surveys • Topography • Subdivisions • Construction Layout

117 N. Madriver St.
Bellefontaine OH 43311



Phone: (937) 593-7335
Fax: (937) 593-7444

BAILEY 5.062 ACRES TRACT 16-T

Lying in Section 22, Town 5, Range 13, Miami Rivers Survey, Monroe Township, Logan County, Ohio

Being out of the Vincent R. Bailey, Trustee of the Vincent R. Bailey Trust, dated April 11, 1995 original 97.44 acre tract as deeded and described in Official Record 254, Page 306 (Tract II, Parcel 1) of the Logan County Records of Deeds and being more particularly described as follows:

Beginning at a 3/4 inch iron rod found at the southwest corner of Section 22 and in the center-line of Township Road 174 (40 feet wide).

THENCE, with the south line of Section 22 and the center-line of Township Road 174, S 85°-00'-00" E, a distance of 3360.94 feet to a MAG nail set at the TRUE POINT OF BEGINNING

THENCE, N 23°-41'-15"E, a distance of 283.71 feet to a 5/8 inch iron rod set, passing a 5/8 inch iron rod set at 21.11 feet.

THENCE, S 84°-56'-42"E, a distance of 821.42 feet to a MAG nail set in the center-line of County Highway 47 (60 feet wide), passing a 5/8 inch iron rod set at 789.76 feet.

THENCE, with the center-line of County Highway 47, S 23°-41'-15"W, a distance of 282.88 feet to a 3/4 inch square top iron bar found on the south line of Section 22 at the intersection of Township Road 174.

THENCE, with the south line of Section 22 and the center-line of Township Road 174, N 85°-00'-00"W, a distance of 821.68 feet to the point of beginning.

Containing 5.062 acres, of which 0.557 acre is within the highway rights-of-way.

The basis for bearings is the south line of Section 22, being N 85°-00'-00"W, and all other bearings are from angles and distances measured in a field survey by Lee Surveying and Mapping Co., Inc. on January 6, 2004.

Description prepared by:



ORIGINAL STAMP IN GREEN

Jeffrey I. Lee
Professional Surveyor 6359
January 13, 2004

L-3713

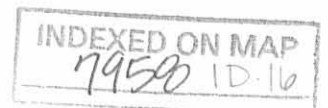

Received 1-23-04 OK gms

Lee Surveying and Mapping Co., Inc.

Land Surveys • Topography • Subdivisions • Construction Layout

117 N. Madriver St.
Bellefontaine OH 43311



Phone: (937) 593-7335
Fax: (937) 593-7444

BAILEY 9.120 ACRES TRACT 17-V

Lying in Section 22, Town 5, Range 13, Miami Rivers Survey, Monroe Township, Logan County, Ohio

Being out of the Vincent R. Bailey, Trustee of the Vincent R. Bailey Trust, dated April 11, 1995 original 97.44 acre tract as deeded and described in Official Record 254, Page 306 (Tract II, Parcel 1) of the Logan County Records of Deeds and being more particularly described as follows:

Beginning at a 3/4 inch iron rod found at the southwest corner of Section 22 and in the center-line of Township Road 174 (40 feet wide).

THENCE, with the south line of Section 22 and the center-line of Township Road 174, S 85°-00'-00" E, a distance of 3062.95 feet to a MAG nail set at the TRUE POINT OF BEGINNING

THENCE, N 5°-36'-38"E, a distance of 893.98 feet to a 5/8 inch iron rod set, passing a 5/8 inch iron rod set at 20.00 feet.

THENCE, S 85°-00'-00"E, a distance of 590.83 feet to a 5/8 inch iron rod set.

THENCE, S 23°-41'-15"W, a distance of 943.67 feet to a MAG nail set in the south line of Section 22 and the center-line of Township Road 174, passing a 5/8 inch iron rod set at 922.56 feet.

THENCE, with the south line of Section 22 and the center-line of Township Road 174, N 85°-00'-00"W, a distance of 297.99 feet to the point of beginning.

Containing 9.120 acres, of which 0.138 acre is within the highway right-of-way.

The basis for bearings is the south line of Section 22, being N 85°-00'-00"W, and all other bearings are from angles and distances measured in a field survey by Lee Surveying and Mapping Co., Inc. on January 6, 2004.



ORIGINAL STAMP IN GREEN

Description prepared by:

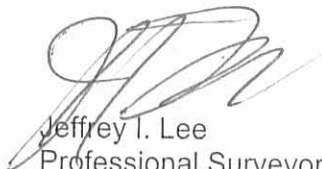
Jeffrey I. Lee
Professional Surveyor 6359
January 13, 2004

L-3713

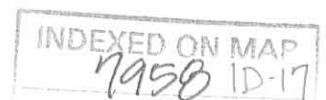

Received 1-23-04 OK GMS

Lee Surveying and Mapping Co., Inc.

Land Surveys • Topography • Subdivisions • Construction Layout

117 N. Madriver St.
Bellefontaine OH 43311



Phone: (937) 593-7335
Fax: (937) 593-7444

BAILEY 6.115 ACRES TRACT 18-W

Lying in Section 22, Town 5, Range 13, Miami Rivers Survey, Monroe Township, Logan County, Ohio

Being out of the Vincent R. Bailey, Trustee of the Vincent R. Bailey Trust, dated April 11, 1995 original 97.44 acre tract as deeded and described in Official Record 254, Page 306 (Tract II, Parcel 1) of the Logan County Records of Deeds and being more particularly described as follows:

Beginning at a 3/4 inch iron rod found at the southwest corner of Section 22 and in the center-line of Township Road 174 (40 feet wide).

THENCE, with the south line of Section 22 and the center-line of Township Road 174, S 85°-00'-00" E, a distance of 2764.96 feet to a MAG nail set at the TRUE POINT OF BEGINNING.

THENCE, N 5°-36'-38"E, a distance of 893.98 feet to a 5/8 inch iron rod set, passing a 5/8 inch iron rod set at 20.00 feet.

THENCE, S 85°-00'-00"E, a distance of 297.99 feet to a 5/8 inch iron rod set.

THENCE, S 05°-36'-38"W, a distance of 893.98 feet to a MAG nail set on the south line of Section 22 and in the center-line of Township Road 174, passing a 5/8 inch iron rod set at 873.98.

THENCE, with the south line of Section 22 and the center-line of Township Road 174, N 85°-00'-00"W, a distance of 297.99 feet to the point of beginning.

Containing 6.115 acres, of which 0.137 acre is within the highway right-of-way.

The basis for bearings is the south line of Section 22, being N 85°-00'-00"W, and all other bearings are from angles and distances measured in a field survey by Lee Surveying and Mapping Co., Inc. on January 6, 2004.

Description prepared by:



ORIGINAL STAMP IN GREEN

Jeffrey I. Lee
Professional Surveyor 6359
January 13, 2004

L-3713

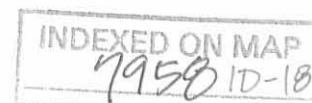

Lee Surveying and Mapping Co., Inc.

Land Surveys • Topography • Subdivisions • Construction Layout

117 N. Madriver St.
Bellefontaine OH 43311

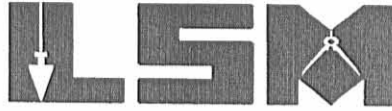

Phone: (937) 593-7335
Fax: (937) 593-7444

BAILEY 6.115 ACRES TRACT 19-X

Lying in Section 22, Town 5, Range 13, Miami Rivers Survey, Monroe Township, Logan County, Ohio

Being out of the Vincent R. Bailey, Trustee of the Vincent R. Bailey Trust, dated April 11, 1995 original 97.44 acre tract as deeded and described in Official Record 254, Page 306 (Tract II, Parcel 1) of the Logan County Records of Deeds and being more particularly described as follows:

Beginning at a 3/4 inch iron rod found at the southwest corner of Section 22 and in the center-line of Township Road 174 (40 feet wide).

THENCE, with the south line of Section 22 and the center-line of Township Road 174, S 85°-00'-00" E, a distance of 2466.97 feet to a MAG nail set at the TRUE POINT OF BEGINNING

THENCE, with the with the east line and said line extended of the Richard Riel and Betty M. Riel 2.56 acre tract (Vol. 341, Pg. 658), N 5°-36'-38"E, a distance of 893.98 feet to a 5/8 inch iron rod set, passing 5/8 inch iron rods set at 20.00 feet and 210.00 feet.

THENCE, S 85°-00'-00"E, a distance of 297.99 feet to a 5/8 inch iron rod set.

THENCE, S 5°-36'-38"W, a distance of 893.98 feet to a MAG nail set on the south line of Section 22 and in the center-line of Township Road 174, passing a 5/8 inch iron rod set at 873.98 feet.

THENCE, with the south line of Section 22 and the center-line of Township Road 174, N 85°-00'-00"W, a distance of 297.99 feet to the point of beginning.

Containing 6.115 acres, of which 0.137 acre is within the highway right-of-way.

The basis for bearings is the south line of Section 22, being N 85°-00'-00"W, and all other bearings are from angles and distances measured in a field survey by Lee Surveying and Mapping Co., Inc. on January 6, 2004.



ORIGINAL STAMP IN GREEN

Description prepared by:

Jeffrey I. Lee
Professional Surveyor 6359
January 13, 2004

L-3713

INDEXED ON MAP
7950 10-19

Lee Surveying and Mapping Co., Inc.

Land Surveys • Topography • Subdivisions • Construction Layout

117 N. Madriver St.
Bellefontaine OH 43311



Phone: (937) 593-7335
Fax: (937) 593-7444

BAILEY 169.015 ACRES TRACT 20-Y

Lying in Section 22, Town 5, Range 13, Miami Rivers Survey, Monroe Township, Logan County, Ohio

Being out of the Vincent R. Bailey, Trustee of the Vincent R. Bailey Trust, dated April 11, 1995 original 97.44 acre tract (Tract II, Parcel 1), 35.52 acre tract (Tract II, Parcel 2), 68.711 acre tract (Tract II, Parcel 2) and 72.410 acre tract (Tract IV) as deeded and described in Official Record 254, Page 306 of the Logan County Records of Deeds and being more particularly described as follows:

Beginning at a 5/8 inch iron rod set at the northwest corner of the southwest quarter of Section 22 and in the center-line of Township Road 173 (40 feet wide).

THENCE, with the north line of the southwest quarter of Section 22 and the center-line of Township Road 173, S 84°-31'-06"E, a distance of 1892.77 feet to a MAG nail set.

THENCE, with the west line and the west line extended of the Vincent R. Bailey, Trustee of the Vincent R. Bailey Trust, dated April 11, 1995 4.079 acre tract (O.R. 254, Pg. 306, Tract III) S 5°-28'-54"W, a distance of 819.63 feet to a 5/8 inch iron rod set, passing 5/8 inch iron rods set at 20.06 feet and 729.09 feet.

THENCE, S 84°-31'-06" E, a distance of 2032.98 feet to a 5/8 inch iron rod set.

THENCE, S 19°-35'-03"W, a distance of 524.14 feet to a 5/8 inch iron rod set.

THENCE, S 21°-49'-15"W, a distance of 451.00 feet to a 5/8 inch iron rod set.

THENCE, S 23°-41'-15" W, a distance of 23.88 feet to a 5/8 inch iron rod set.

THENCE, N 85°-00'-00"W, a distance of 1186.81 feet to a 5/8 inch iron rod set.

THENCE, S 5°-36'-38"W, a distance of 683.98 feet to a 5/8 inch iron rod set.

THENCE, with the north line of the Richard Riel and Betty M. Riel 2.56 acre tract (Vol. 341, Pg. 658), N 83°-51'-58"W, a distance of 516.18 feet to a 3/4 inch iron pipe found.

THENCE, with the west line of the said 2.56 acre tract, S 4°-43'-03"W, a distance of 220.21 feet to a MAG nail set in the center-line of Township Road 174 (40 feet wide), passing a 5/8 inch iron rod set at 200.21 feet.

THENCE, with the south line of Section 22 and the center-line of Township Road 174, N 85°-00'-00"W, a distance of 1954.22 feet to a 3/4 inch iron rod found at the southwest corner of Section 22.

THENCE, with the west line of Section 22 and Monroe Township, and the east line of the Julia B. Yoder, Trustee 31.20 acre tract (O.R. 172, Pg. 542) and the east line of the Vincent R. Bailey, Trustee of the Vincent R. Bailey Trust, dated April 11, 1995, 97.00 acre tract (O.R. 254, Pg. 306, Tract I), N 5°-18'-43"E, a distance of 2708.15 feet to the point of beginning, passing 5/8 inch iron rods set at 20.00 feet and 2688.15 feet..

Containing 169.015 acres, of which 1.766 acres are within the highway rights of way.

The basis for bearings is the south line of Section 22, being N 85°-00'-00"W, and all other bearings are from angles and distances measured in a field survey by Lee Surveying and Mapping Co., Inc. on January 6, 2004.



Description prepared by:

Jeffrey I. Lee
Professional Surveyor 6359
JANUARY 13, 2004

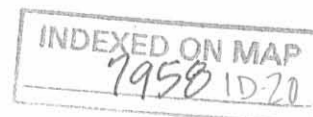

L-3713

Received 1-23-04-01 gms

Lee Surveying and Mapping Co., Inc.

Land Surveys • Topography • Subdivisions • Construction Layout

117 N. Madriver St.
Bellefontaine OH 43311

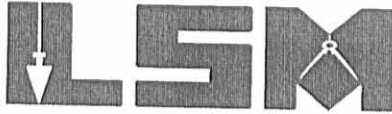

Phone: (937) 593-7335
Fax: (937) 593-7444

BAILEY 5.183 ACRES TRACT 21-Z

Lying in Section 22, Town 5, Range 13, Miami Rivers Survey, Monroe Township, Logan County, Ohio

Being out of the Vincent R. Bailey, Trustee of the Vincent R. Bailey Trust, dated April 11, 1995 original 68.711 acre tract as deeded and described in Official Record 254, Page 306 (Tract II, Parcel 2) of the Logan County Records of Deeds and being more particularly described as follows:

Beginning at a 5/8 inch iron rod set at the northwest corner of the southwest quarter of Section 22 and in the center-line of Township Road 173 (40 feet wide).

THENCE, with the north line of the southwest quarter of Section 22 and the center-line of Township Road 173, S 84°-31'-06"E, a distance of 2136.82 feet to a MAG nail set at the TRUE POINT OF BEGINNING.

THENCE, continuing with the north line of the southwest quarter of Section 22 and the center-line of Township Road 173, S 84°-31'-06"E, a distance of 251.02 feet to a MAG nail set.

THENCE, S 5°-50'-00"W, a distance of 819.65 feet to a 5/8 inch iron rod set, passing a 5/8 inch iron rod set at 20.00 feet.

THENCE, N 84°-31'-06"W, a distance of 490.05 feet to a 5/8 inch iron rod set.

THENCE, N 5°-28'-54" E, a distance of 90.54 feet to a 5/8 inch iron rod set at the southwest corner of the Vincent R. Bailey, Trustee of the Vincent R. Bailey Trust, dated April 11, 1995 4.079 acre tract (O.R. 254, Page 306, Tract III).

THENCE, with said 4.079 acre tract the following two courses:

S 84°-31'-06" E, a distance of 244.05 feet to a 5/8 inch iron rod set.

N 5°-28'-54" E, a distance of 729.09 feet to the point of Beginning, passing a 5/8 inch iron rod set at 709.09 feet.

Containing 5.183 acre, of which 0.115 acre is within the highway right-of-way.

The basis for bearings is the south line of Section 22, being N 85°-00'-00"W, and all other bearings are from angles and distances measured in a field survey by Lee Surveying and Mapping Co., Inc. on January 6, 2004.

Description prepared by:



ORIGINAL STAMP IN GREEN

Jeffrey I. Lee
Professional Surveyor 6359
January 13, 2004

L-3713

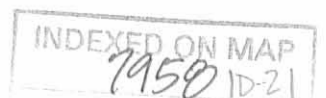

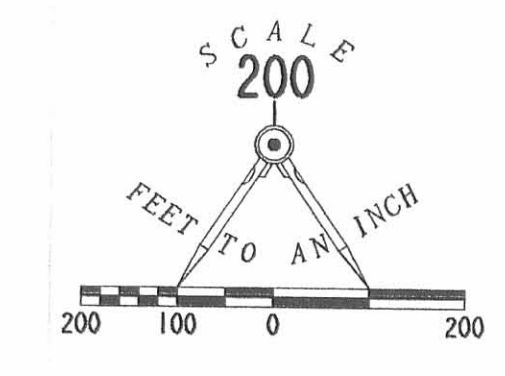

- LEGEND:
- 5/8 INCH IRON ROD SET
 - MAG NAIL SET
 - 3/4 INCH SQUARE TOP IRON BAR FOUND
 - 3/4 INCH IRON ROD FOUND
 - 3/4 INCH IRON PIPE FOUND
 - ◻ ANGLE IRON FOUND WITH BRICK SURROUND
 - ⊙ RAILROAD SPIKE FOUND
 - ⊗ 1/2 INCH IRON ROD FOUND

VINCENT R. BAILEY, TRUSTEE FOR THE VINCENT R. BAILEY TRUST DATED APRIL 11, 1995 97.00 ACRES O.R. 254, PG. 306 (TRACT I)

VINCENT R. BAILEY, TRUSTEE OF THE VINCENT R. BAILEY TRUST DATED APRIL 11, 1995 O.R. 254, PG. 306 TRACT II, PARCEL 2 ORIGINAL 68.711 ACRES

JULIA B. YODER, TRUSTEE 31.20 ACRES O.R. 172, PG. 542

VINCENT R. BAILEY, TRUSTEE OF THE VINCENT R. BAILEY TRUST DATED APRIL 11, 1995 O.R. 254, PG. 306 TRACT II, PARCEL 2 ORIGINAL 35.52 ACRES

VINCENT R. BAILEY, TRUSTEE OF THE VINCENT R. BAILEY TRUST DATED APRIL 11, 1995 O.R. 254, PG. 306 TRACT II, PARCEL 1 ORIGINAL 97.44 ACRES

SURVEY OF 21 TRACTS OUT OF THE VINCENT R. BAILEY, TRUSTEE OF THE VINCENT R. BAILEY TRUST DATED APRIL 11, 1995
 ORIGINAL 97.440 ACRE TRACT (TRACT II, PARCEL 1)
 ORIGINAL 35.52 ACRE TRACT (TRACT II, PARCEL 2)
 ORIGINAL 68.711 ACRE TRACT (TRACT II, PARCEL 2)
 ORIGINAL 4.079 ACRE TRACT (TRACT III) AND
 ORIGINAL 72.410 ACRE TRACT (TRACT IV)
 OFFICIAL RECORD 254, PAGE 306
 PART OF SECTION 22, TOWN 5, RANGE 13
 MIAMI RIVERS SURVEY
 MONROE TOWNSHIP
 LOGAN COUNTY, OHIO

TOWNSHIP ROAD 173 (40')

TOWNSHIP ROAD 174 (40')

COUNTY HIGHWAY 47 (60')

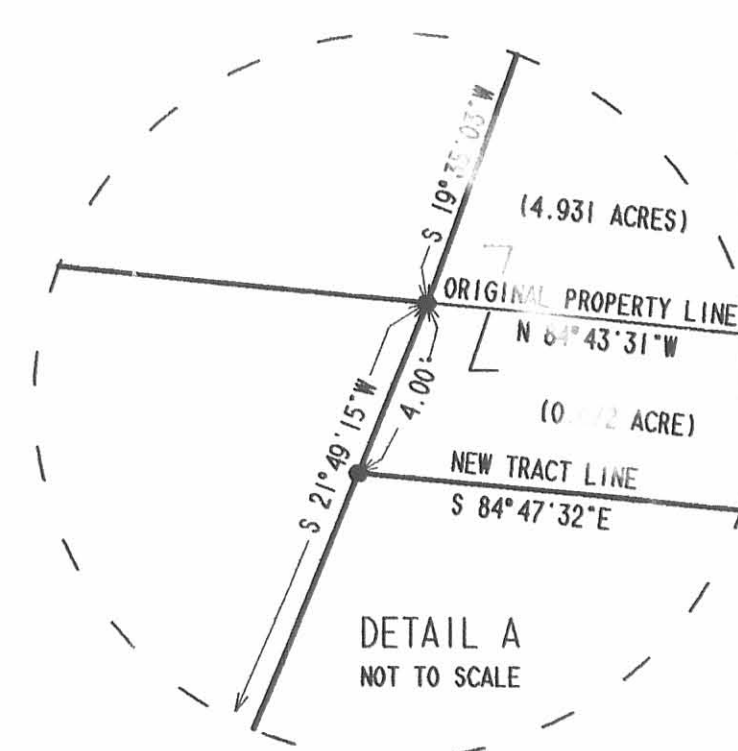
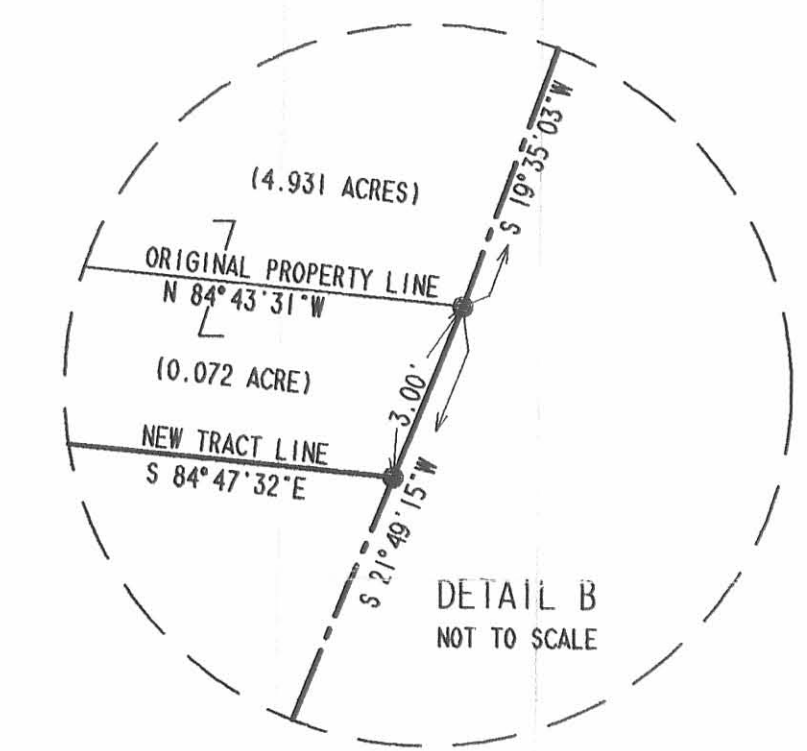

I HEREBY STATE TO THE TITLE COMPANY, L.T.D. AND FIFTH THIRD BANK THAT I HAVE SURVEYED THE PROPERTY IN THE FOREGOING TITLE CAPTION AND THAT SAID SURVEY IS TRUE AND ACCURATE TO THE BEST OF MY KNOWLEDGE AND BELIEF.

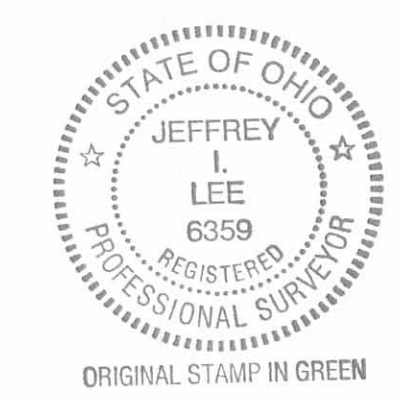

JEFFREY I. LEE
 PROFESSIONAL SURVEYOR 6359
 JANUARY 6, 2004

COPYRIGHT 2004 BY:
 LEE SURVEYING & MAPPING CO., INC.
 117 North Medriver Street
 BELLEFONTAINE, OHIO 43311
 (937) 593-7335

INDEXED ON MAP 7456 1P