

132 668 acrs. - The division line east and west begins in ¹³²
 the east line 150 poles from the S. E. corner of the sec.
 a w. oak $\text{S } 70^{\circ} \text{ W } 23^{\circ}$ links; thence west, crossing the creek
 at 158 poles $\text{S } 20^{\circ}$ poles to a stake in the west line of the sec.
 The line north and south begins at a w. oak $\text{S } 83^{\circ} \text{ W } 16^{\circ}$
 links dist in the north line 164 poles from the N. W.
 corner of the sec.; thence south crossing the creek 9 times
 passing the center stake at 153 poles $\text{S } 04^{\circ}$ poles to a stake
 in the south line of the sec. a w. oak $\text{S } 34^{\circ} \text{ E } 19^{\circ}$ links.
 dist. 164 poles from the N. W. corner
 Cyrus Ferris } C.C.
 Henry Kelley } C.C. James Harmon
C.C.

B. Long et al. } 10th Mo., Oct. 16 1831
 N. 168 } 3

Survey No 168

8258
 Surveyed 206 acrs for Benjamin Long and step
 sons, heirs of Zabud Randall; beginning at a white
 oak, where formerly stood 2 white oaks hickory and elm
 (the hickory elm and one white oak is down), at the N. E.
 corner of Thomas Worthington's survey N 44 97; thence
 with his east line $\text{S } 20^{\circ} \text{ E}$, crossing Machachae at 129
 poles, 248 poles to 2 black oaks and red oak, the S. E. cor-
 ner of said survey; thence $\text{S } 70^{\circ} \text{ W}$ with the south line of
 the original survey, 137 poles to 2 black oaks and hickory
 corner to George Meeks land
 thence $\text{S } 20^{\circ} \text{ W}$ (crossing
 Machachae at 268 poles)
 (a mill race at 234 poles)
 248 poles, to a white oak
 in the north line of said
 survey - thence with said
 line $\text{S } 70^{\circ} \text{ E}$ 137 poles to the
 beginning containing
 206 acrs, off the east end
 of Worthington's said survey
 Jeffrey Williams } C.C.
 Thomas Wittett } C.C.

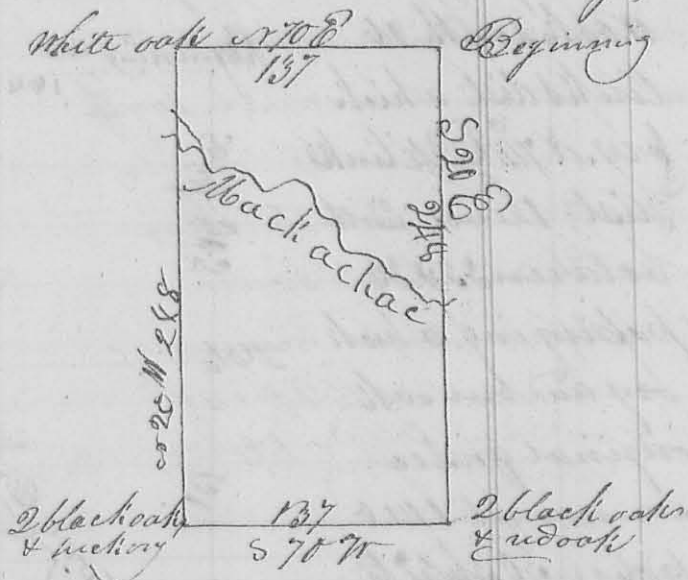

James Harmon
 C.C.