

32

8514

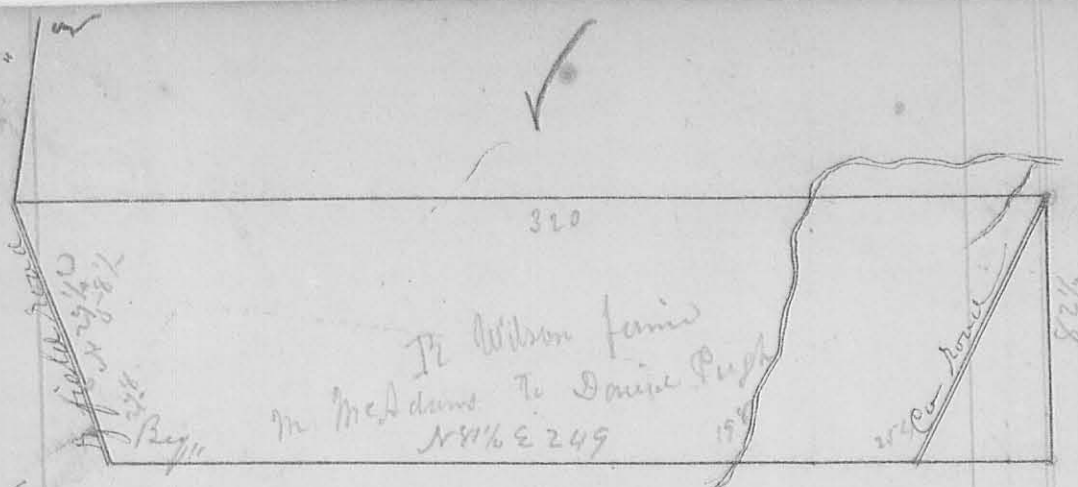

Survey
N 357

Surveyed December the 15th 1845 for Martin Mc Adams the following lot of land being part of Survey N 3223 as follows: Beginning at a Stake in the road running from Yanesfield to Sandusky at Oliver Canins at the West corner & run N 81 1/2 E 294 poles to Stake of 2 Buck (one Buck gone) 198 poles to Branch, 254 poles to County road, then S 80 1/2 N 10 1/2 W 82 1/2 poles to Stake in said County road then S 80 50 W 320 poles to the Center of the Yanesfield road, then with said road S 29 1/4 E 158 1/2 poles to Stake in Centre of said road then S 26 1/2 E 278 poles to the Beginning containing 155.75 Acres

Abel Roberts } cher
- Butler } " "

A. A. Merriam
C. S. Lee O