

REC'D 2-9-04 SMJ an

Lee Surveying and Mapping Co., Inc.

Land Surveys • Topography • Subdivisions • Construction Layout

117 N. Madriver St.
Bellefontaine OH 43311



Phone: (937) 593-7335
Fax: (937) 593-7444

COUNTRYTYME 5.676 ACRES TRACT A-1

Lying in Virginia Military Survey 3224, Monroe Township, Logan County, Ohio.

Being a out of the Countrytyme Grove City Ltd. original 61.78 acres tract as deeded in Official Record 691, Page 682 of the Logan County Records of Deeds and being more particularly described as follows:

Beginning at a railroad spike set on the west line of Virginia Military Survey 3224 at the intersection of center-lines of Township Road 164 (60 feet wide) and County Highway 178 (60 feet wide).

THENCE, with the west line of Virginia Military Survey 3224 and center-line of County Highway 178, N 26°-33'-38"W, a distance of 290.54 feet to a MAG nail set.

THENCE, N 73°-58'-54"E, a distance of 530.57 feet to a 5/8 inch iron rod set, passing a 5/8 inch iron rod set at 30.51 feet.

THENCE, S 26°-33'-38"E, a distance of 575.44 feet to a 5/8 inch iron rod set, passing a 5/8 inch iron rod set at 544.56 feet.

THENCE, with the center-line of Township Road 164 on a curve to the left having a central angle of 30°-52'-57", a radius of 911.88 feet, an arc of 491.50 feet, with a chord bearing N 84°-15'-07"W, a distance of 485.58 feet to a railroad spike set.

THENCE, with the center-line of Township Road 164, N 68°-48'-38"W, a distance of 165.41 feet to the point of beginning.

Containing 5.676 acres of which 0.634 acre is within the highway right-of-way.

The basis for bearings is the north line of the Jeffrey B. Gantz, Kelly W. Gantz, Cheryl E. Gantz, Benjamin B. Gantz 218.54 acre tract (O.R. 495, Pg. 254 Parcel II, Tract I), being S 73°-30'-00"E , and all other bearings are from angles and distances measured in a field survey by Lee Surveying and Mapping Co., Inc. on January 8, 2004.

Description prepared by:



ORIGINAL STAMP IN GREEN

Jeffrey I. Lee
Professional Surveyor 6359
January 13, 2004
Revised January 23, 2003

L-3703

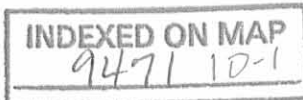

Lee Surveying and Mapping Co., Inc.

Land Surveys • Topography • Subdivisions • Construction Layout

117 N. Madriver St.
Bellefontaine OH 43311



Phone: (937) 593-7335
Fax: (937) 593-7444

COUNTRYTYME 5.919 ACRES TRACT J-9

Lying in Virginia Military Survey 3224, Monroe Township, Logan County, Ohio.

Being a out of the Countrytyme Grove City Ltd. original 61.78 acres tract as deeded in Official Record 691, Page 682 of the Logan County Records of Deeds and being more particularly described as follows:

Beginning at a railroad spike set on the west line of Virginia Military Survey 3224 at the intersection of center-lines of Township Road 164 (60 feet wide) and County Highway 178 (60 feet wide).

THENCE, with the west line of Virginia Military Survey 3224 and center-line of County Highway 178, N 26°-33'-38"W, a distance of 1177.63 feet to a railroad spike found.

THENCE, with the west line of Virginia Military Survey 3224 and center-line of County Highway 178, N 24°-09'-16"W, a distance of 441.85 feet to a railroad spike found.

THENCE, with the west line of Virginia Military Survey 3224 and center-line of County Highway 178, N 16°-11'-55"W, a distance of 738.66 feet to a MAG nail set at THE TRUE POINT OF BEGINNING.

THENCE, with the west line of Virginia Military Survey 3224 and center-line of County Highway 178, N 16°-11'-55"W, a distance of 292.52 feet to a 5/8 inch iron rod found.

THENCE, with the south line of Virginia Military Survey 3222 and the south line of the Cheskin Holstein Farm original 141 acre tract (Vol. 361, Pg. 416 Tract II), N 73°-58'-54"E, a distance of 859.20 feet to a 5/8 inch iron rod set, passing a 5/8 inch iron rod set at 30.00 feet.

THENCE, with the west line of the Jack L. Jackson and Cynthia G. Jackson 130.06 acre tract (O.R. 447, Pg. 959), S 24°-49'-14"E, a distance of 296.00 feet to a 5/8 inch iron rod set.

THENCE, S 73°-58'-54"W, a distance of 903.58 feet to the point of beginning, passing a 5/8 inch iron rod set at 873.58 feet.

Containing 5.919 acres of which 0.202 acre is within the highway right-of-way.

The basis for bearings is the north line of the Jeffrey B. Gantz, Kelly W. Gantz, Cheryl E. Gantz, Benjamin B. Gantz 218.54 acre tract (O.R. 495, Pg. 254 Parcel II, Tract I), being S 73°-30'-00"E , and all other bearings are from angles and distances measured in a field survey by Lee Surveying and Mapping Co., Inc. on January 8, 2004.

Description prepared by:



ORIGINAL STAMP IN GREEN

Jeffrey I. Lee
Professional Surveyor 6359
January 13, 2004
Revised January 23, 2003

L-3703

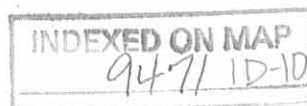

REC'D 2-9-04 SM OK

Lee Surveying and Mapping Co., Inc.

Land Surveys • Topography • Subdivisions • Construction Layout

117 N. Madriver St.
Bellefontaine OH 43311



Phone: (937) 593-7335
Fax: (937) 593-7444

COUNTRYTYME 5.019 ACRES TRACT B-2

Lying in Virginia Military Survey 3224, Monroe Township, Logan County, Ohio.

Being a out of the Countrytyme Grove City Ltd. original 61.78 acres tract as deeded in Official Record 691, Page 682 of the Logan County Records of Deeds and being more particularly described as follows:

Beginning at a railroad spike set on the west line of Virginia Military Survey 3224 at the intersection of center-lines of Township Road 164 (60 feet wide) and County Highway 178 (60 feet wide).

THENCE, with the center-line of Township Road 164, S 68°-48'-38"E, a distance of 165.41 feet to a railroad spike set.

THENCE, with a curve to the left having a central angle of 30°-52'-57", a radius of 911.88 feet, an arc of 491.50 feet, with a chord bearing S 84°-15'-07"E, a distance of 485.58 feet to a 5/8 inch iron rod set at the TRUE POINT OF BEGINNING.

THENCE, N 26°-33'-38"W, a distance of 575.44 feet to a 5/8 inch iron rod set, passing a 5/8 inch iron rod set at 30.88 feet.

THENCE, N 73°-58'-54"E, a distance of 463.00 feet to a 5/8 inch iron rod set.

THENCE, with the west line of the Jack L. Jackson and Cynthia G. Jackson 130.06 acre tract (O.R. 447, Pg. 959), S 24°-49'-14"E, a distance of 219.03 feet to a 5/8 inch iron rod set.

THENCE, with the lines of the Jeffrey B. Gantz, Kelly W. Gantz, Cheryl E. Gantz, Benjamin B. Gantz 0.87 acre tract (O.R. 495, Pg. 254, Parcel II, Tract IV) the following two courses:

S 74°-33'-47"W, a distance of 105.12 feet to a 5/8 inch iron rod set.

S 19°-06'-52"E a distance of 372.09 feet to a 5/8 inch iron rod set, passing a 5/8 inch iron rod set at 325.78 feet.

THENCE, with the north line of the Jeffrey B. Gantz, Kelly W. Gantz, Cheryl E. Gantz, Benjamin B. Gantz 218.54 acre tract (O.R. 495, Pg. 254, Parcel II, Tract I), S 73°-30'-00"W, a distance of 189.05 feet to a 5/8 inch rod set.

THENCE, with the a line of the Jeffrey B. Gantz, Kelly W. Gantz, Cheryl E. Gantz, Benjamin B. Gantz 2.35 acre tract (O.R. 495, Pg. 254, Parcel II, Tract III), N 16°-11'-15"W, a distance of 17.29 feet to a 5/8 inch rod set.

THENCE, with the center line of Township Road 164 the following two courses:

S 73°-48'-45"W, a distance of 13.96 feet to a 5/8 inch iron rod set.

a curve to the right having a central angle of 06°-29'-40", a radius of 911.88 feet , an arc of 103.36 feet, with a chord bearing N 77°-03'-35"E, a distance of 103.31 feet to the point of beginning.



Lee Surveying and Mapping Co., Inc.

Land Surveys • Topography • Subdivisions • Construction Layout

117 N. Madriver St.
Bellefontaine OH 43311



Phone: (937) 593-7335
Fax: (937) 593-7444

Containing 5.019 acres of which 0.285 acre is within the highway right-of-way.

The basis for bearings is the north line of the Jeffrey B. Gantz, Kelly W. Gantz, Cheryl E. Gantz, Benjamin B. Gantz 218.54 acre tract (O.R. 495, Pg. 254 Parcel II, Tract I), being S 73°-30'-00"E, and all other bearings are from angles and distances measured in a field survey by Lee Surveying and Mapping Co., Inc. on January 8, 2004.

Description prepared by:



ORIGINAL STAMP IN GREEN

A handwritten signature in black ink, appearing to read 'Jeffrey I. Lee'.

Jeffrey I. Lee
Professional Surveyor 6359
January 13, 2004
Revised January 23, 2003

L-3703

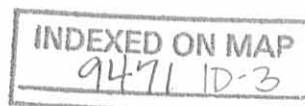

REC'D 2-9-04 SML/ML

Lee Surveying and Mapping Co., Inc.

Land Surveys • Topography • Subdivisions • Construction Layout

117 N. Madriver St.
Bellefontaine OH 43311



Phone: (937) 593-7335
Fax: (937) 593-7444

COUNTRYTYME 7.545 ACRES TRACT C-3

Lying in Virginia Military Survey 3224, Monroe Township, Logan County, Ohio.

Being a out of the Countrytyme Grove City Ltd. original 61.78 acres tract as deeded in Official Record 691, Page 682 of the Logan County Records of Deeds and being more particularly described as follows:

Beginning at a railroad spike set on the west line of Virginia Military Survey 3224 at the intersection of center-lines of Township Road 164 (60 feet wide) and County Highway 178 (60 feet wide).

THENCE, with the west line of Virginia Military Survey 3224 and center-line of County Highway 178, N 26°-33'-38"W, a distance of 290.54 feet to a MAG nail set at THE TRUE POINT OF BEGINNING.

THENCE, with the west line of Virginia Military Survey 3224 and center-line of County Highway 178, N 26°-33'-38"W, a distance of 334.73 feet to a MAG nail set.

THENCE, N 73°-58'-54"E, a distance of 1003.85 feet to a 5/8 inch iron rod set, passing a 5/8 inch iron rod set at 30.51 feet.

THENCE, with the west line of the Jack L. Jackson and Cynthia G. Jackson 130.06 acre tract (O.R. 447, Pg. 959), S 24°-49'-14"E a distance of 333.00 feet to a 5/8 inch iron rod set.

THENCE, S 73°-58'-54"W, a distance of 993.57 feet to the point of beginning, passing a 5/8 inch rod set at 963.06 feet.

Containing 7.545 acres of which 0.231 acre is within the highway right-of-way.

The basis for bearings is the north line of the Jeffrey B. Gantz, Kelly W. Gantz, Cheryl E. Gantz, Benjamin B. Gantz 218.54 acre tract (O.R. 495, Pg. 254 Parcel II, Tract I), being S 73°-30'-00"E , and all other bearings are from angles and distances measured in a field survey by Lee Surveying and Mapping Co., Inc. on January 8, 2004.

Description prepared by:



Jeffrey I. Lee
Professional Surveyor 6359
January 13, 2004
Revised January 23, 2003

L-3703

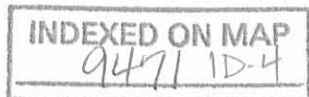

REC'D 29-04 SMM/AL

Lee Surveying and Mapping Co., Inc.

Land Surveys • Topography • Subdivisions • Construction Layout

117 N. Madriver St.
Bellefontaine OH 43311



Phone: (937) 593-7335
Fax: (937) 593-7444

COUNTRYTYME 8.688 ACRES TRACT D-4

Lying in Virginia Military Survey 3224, Monroe Township, Logan County, Ohio.

Being a out of the Countrytyme Grove City Ltd. original 61.78 acres tract as deeded in Official Record 691, Page 682 of the Logan County Records of Deeds and being more particularly described as follows:

Beginning at a railroad spike set on the west line of Virginia Military Survey 3224 at the intersection of center-lines of Township Road 164 (60 feet wide) and County Highway 178 (60 feet wide).

THENCE, with the center-line of County Highway 178, N 26°-33'-38"W, a distance of 625.27 feet to a MAG nail set at THE TRUE POINT OF BEGINNING.

THENCE with the west line of Virginia Military Survey 3224 and center-line of County Highway 178, N 26°-33'-38"W, a distance of 381.25 feet to a MAG nail set.

THENCE, N 73°-58'-54"E, a distance of 1015.57 feet to a 5/8 inch iron rod set, passing a 5/8 inch iron rod set at 30.51 feet.

THENCE, with the west line of the Jack L. Jackson and Cynthia G. Jackson 130.06 acre tract (O.R. 447, Pg. 959), S 24°-49'-14"E, a distance of 379.28 feet to a 5/8 inch iron rod set.

THENCE, S 73°-58'-54"W, a distance of 1003.85 feet to the point of beginning, passing a 5/8 inch iron rod set at 973.34 feet.

Containing 8.688 acres of which 0.262 acre is within the highway right-of-way.

The basis for bearings is the north line of the Jeffrey B. Gantz, Kelly W. Gantz, Cheryl E. Gantz, Benjamin B. Gantz 218.54 acre tract (O.R. 495, Pg. 254 Parcel II, Tract I), being S 73°-30'-00"E , and all other bearings are from angles and distances measured in a field survey by Lee Surveying and Mapping Co., Inc. on January 8, 2004.

Description prepared by:



ORIGINAL STAMP IN GREEN

Jeffrey I. Lee
Jeffrey I. Lee
Professional Surveyor 6359
January 13, 2004
Revised January 23, 2003

L-3703

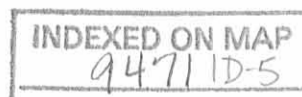

REC'D 2-9-04 SMY/OK

Lee Surveying and Mapping Co., Inc.

Land Surveys • Topography • Subdivisions • Construction Layout

117 N. Madriver St.
Bellefontaine OH 43311



Phone: (937) 593-7335
Fax: (937) 593-7444

COUNTRYTYME 8.768 ACRES TRACT E-5

Lying in Virginia Military Survey 3224, Monroe Township, Logan County, Ohio.

Being a out of the Countrytyme Grove City Ltd. original 61.78 acres tract as deeded in Official Record 691, Page 682 of the Logan County Records of Deeds and being more particularly described as follows:

Beginning at a railroad spike set on the west line of Virginia Military Survey 3224 at the intersection of center-lines of Township Road 164 (60 feet wide) and County Highway 178 (60 feet wide).

THENCE, with the west line of Virginia Military Survey 3224 and center-line of County Highway 178, N 26°-33'-38"W, a distance of 1006.52 feet to a MAG nail set at THE TRUE POINT OF BEGINNING.

THENCE, with the west line of Virginia Military Survey 3224 and center-line of County Highway 178, N 26°-33'-38"W, a distance of 171.11 feet to a railroad spike found.

THENCE, with the west line of Virginia Military Survey 3224 and center-line of County Highway 178, N 24°-09'-16"W, a distance of 208.70 feet to a MAG nail set.

THENCE, N 73°-58'-54"E, a distance of 1018.37 feet to a 5/8 inch iron rod set, passing a 5/8 inch iron rod set at 30.30 feet.

THENCE, with the west line of the Jack L. Jackson and Cynthia G. Jackson 130.06 acre tract (O.R. 447, Pg. 959), S 24°-49'-14"E, a distance of 379.28 feet to a 5/8 inch iron rod set.

THENCE, S 73°-58'-54"W, a distance of 1015.57 feet to the point of beginning, passing a 5/8 inch iron rod set at 985.06 feet.

Containing 8.768 acres of which 0.262 acre is within the highway right-of-way.

The basis for bearings is the north line of the Jeffrey B. Gantz, Kelly W. Gantz, Cheryl E. Gantz, Benjamin B. Gantz 218.54 acre tract (O.R. 495, Pg. 254 Parcel II, Tract I), being S 73°-30'-00"E , and all other bearings are from angles and distances measured in a field survey by Lee Surveying and Mapping Co., Inc. on January 8, 2004.

Description prepared by:



ORIGINAL STAMP IN GREEN

Jeffrey I. Lee
Jeffrey I. Lee
Professional Surveyor 6359
January 13, 2004

Revised January 23, 2003

L-3703

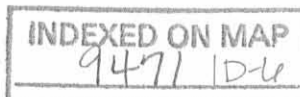

Lee Surveying and Mapping Co., Inc.

Land Surveys • Topography • Subdivisions • Construction Layout

117 N. Madriver St.
Bellefontaine OH 43311



Phone: (937) 593-7335
Fax: (937) 593-7444

COUNTRYTYME 7.822 ACRES TRACT F-6

Lying in Virginia Military Survey 3224, Monroe Township, Logan County, Ohio.

Being a out of the Countrytyme Grove City Ltd. original 61.78 acres tract as deeded in Official Record 691, Page 682 of the Logan County Records of Deeds and being more particularly described as follows:

Beginning at a railroad spike set on the west line of Virginia Military Survey 3224 at the intersection of center-lines of Township Road 164 (60 feet wide) and County Highway 178 (60 feet wide).

THENCE, with the west line of Virginia Military Survey 3224 and center-line of County Highway 178, N 26°-33'-38"W, a distance of 1177.63 feet to a set railroad spike found.

THENCE, with the west line of Virginia Military Survey 3224 and center-line of County Highway 178, N 24°-09'-16"W, a distance of 208.70 feet to a MAG nail set at THE TRUE POINT OF BEGINNING.

THENCE, with the west line of Virginia Military Survey 3224 and center-line of County Highway 178, N 24°-09'-16"W, a distance of 233.15 feet to a railroad spike found.

THENCE, with the west line of Virginia Military Survey 3224 and center-line of County Highway 178, N 16°-11'-55"W, a distance of 105.20 feet to a MAG nail set.

THENCE, N 73°-58'-54"E, a distance of 999.67 feet to a 5/8 inch iron rod set, passing a 5/8 inch iron rod set at 30.03 feet.

THENCE, with the west line of the Jack L. Jackson and Cynthia G. Jackson 130.06 acre tract (O.R. 447, Pg. 959), S 24°-49'-14"E, a distance of 340.00 feet to a 5/8 inch iron rod set.

THENCE, S 73°-58'-54"W, a distance of 1018.37 feet to the point of beginning, passing a 5/8 inch iron rod set at 988.07 feet.

Containing 7.822 acres of which 0.233 acre is within the highway right-of-way.

The basis for bearings is the north line of the Jeffrey B. Gantz, Kelly W. Gantz, Cheryl E. Gantz, Benjamin B. Gantz 218.54 acre tract (O.R. 495, Pg. 254 Parcel II, Tract I), being S 73°-30'-00"E , and all other bearings are from angles and distances measured in a field survey by Lee Surveying and Mapping Co., Inc. on January 8, 2004.

Description prepared by:



ORIGINAL STAMP IN GREEN

Jeffrey I. Lee
Professional Surveyor 6359
January 13, 2004
Revised January 23, 2003

L-3703



Lee Surveying and Mapping Co., Inc.

Land Surveys • Topography • Subdivisions • Construction Layout

117 N. Madriver St.
Bellefontaine OH 43311



Phone: (937) 593-7335
Fax: (937) 593-7444

COUNTRYTYME 7.299 ACRES TRACT G-7

Lying in Virginia Military Survey 3224, Monroe Township, Logan County, Ohio.

Being a out of the Countrytyme Grove City Ltd. original 61.78 acres tract as deeded in Official Record 691, Page 682 of the Logan County Records of Deeds and being more particularly described as follows:

Beginning at a railroad spike set on the west line of Virginia Military Survey 3224 at the intersection of center-lines of Township Road 164 (60 feet wide) and County Highway 178 (60 feet wide).

THENCE, with the west line of Virginia Military Survey 3224 and center-line of County Highway 178, N 26°-33'-38"W, a distance of 1177.63 feet to a railroad spike found.

THENCE, with the west line of Virginia Military Survey 3224 and center-line of County Highway 178, N 24°-09'-16"W, a distance of 441.85 feet to a railroad spike found.

THENCE, with the west line of Virginia Military Survey 3224 and center-line of County Highway 178, N 16°-11'-55"W, a distance of 105.20 feet to a MAG nail set at THE TRUE POINT OF BEGINNING.

THENCE, with the west line of Virginia Military Survey 3224 and center-line of County Highway 178, N 16°-11'-55"W, a distance of 326.12 feet to a MAG nail set.

THENCE, N 73°-58'-54"E, a distance of 950.20 feet to a 5/8 inch iron rod set, passing a 5/8 inch iron rod set at 30.00 feet.

THENCE, with the west line of the Jack L. Jackson and Cynthia G. Jackson 130.06 acre tract (O.R. 447, Pg. 959), S 24°-49'-14"E, a distance of 330.00 feet to a 5/8 inch iron rod set.

THENCE, S 73°-58'-54"W, a distance of 999.67 feet to the point of beginning, passing a 5/8 inch iron rod at 969.64 feet.

Containing 7.299 acres of which 0.225 acre is within the highway right-of-way.

The basis for bearings is the north line of the Jeffrey B. Gantz, Kelly W. Gantz, Cheryl E. Gantz, Benjamin B. Gantz 218.54 acre tract (O.R. 495, Pg. 254 Parcel II, Tract I), being S 73°-30'-00"E , and all other bearings are from angles and distances measured in a field survey by Lee Surveying and Mapping Co., Inc. on January 8, 2004.

Description prepared by:



ORIGINAL STAMP IN GREEN

Jeffrey I. Lee
Professional Surveyor 6359
January 13, 2004
Revised January 23, 2003

L-3703

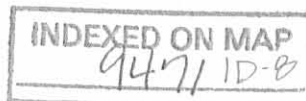

REC'D 2-9-04 EMM/ML

Lee Surveying and Mapping Co., Inc.

Land Surveys • Topography • Subdivisions • Construction Layout

117 N. Madriver St.
Bellefontaine OH 43311



Phone: (937) 593-7335
Fax: (937) 593-7444

COUNTRYTYME 6.540 ACRES TRACT H-8

Lying in Virginia Military Survey 3224, Monroe Township, Logan County, Ohio.

Being a out of the Countrytyme Grove City Ltd. original 61.78 acres tract as deeded in Official Record 691, Page 682 of the Logan County Records of Deeds and being more particularly described as follows:

Beginning at a railroad spike set on the west line of Virginia Military Survey 3224 at the intersection of center-lines of Township Road 164 (60 feet wide) and County Highway 178 (60 feet wide).

THENCE, with the west line of Virginia Military Survey 3224 and center-line of County Highway 178, N 26°-33'-38"W, a distance of 1177.63 feet to a railroad spike found.

THENCE, with the west line of Virginia Military Survey 3224 and center-line of County Highway 178, N 24°-09'-16"W, a distance of 441.85 feet to a railroad spike found.

THENCE, with the west line of Virginia Military Survey 3224 and center- line of County Highway 178, N 16°-11'-55"W, a distance of 431.32 feet to a MAG nail set as THE TRUE POINT OF BEGINNING.

THENCE, with the west line of Virginia Military Survey 3224 and center-line of County Highway 178, N 16°-11'-55"W, a distance of 307.34 feet to a MAG nail set.

THENCE, N 73°-58'-54"E, a distance of 903.58 feet to a 5/8 inch iron rod set, passing a 5/8 inch iron rod set at 30.00 feet.

THENCE, with the west line of the Jack L. Jackson and Cynthia G. Jackson 130.06 acre tract (O.R. 447, Pg. 959), S 24°-49'-14"E, a distance of 311.00 feet to a 5/8 inch iron rod set.

THENCE, S 73°-58'-54"W, a distance of 950.20 feet to the point of beginning, passing a 5/8 inch iron rod set at 920.20 feet.

Containing 6.540 acres of which 0.212 acre is within the highway right-of-way.

The basis for bearings is the north line of the Jeffrey B. Gantz, Kelly W. Gantz, Cheryl E. Gantz, Benjamin B. Gantz 218.54 acre tract (O.R. 495, Pg. 254 Parcel II, Tract I), being S 73°-30'-00"E , and all other bearings are from angles and distances measured in a field survey by Lee Surveying and Mapping Co., Inc. on January 8, 2004.

Description prepared by:



[Handwritten Signature]
Jeffrey I. Lee
Professional Surveyor 6359
January 13, 2004
Revised January 23, 2003

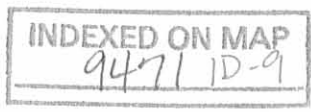

L-3703

LEGEND:

- MAGNETIC NAIL FOUND
- 5/8 INCH IRON REBAR FOUND WITH I.D. CAP STAMPED ("LEE PS6359")
- WOOD LATH SET
- R/W = RIGHT-OF-WAY
- C/L = CENTER-LINE
- O.R. = OFFICIAL RECORD
- PG. = PAGE
- V.M.S. = VIRGINIA MILITARY SURVEY

RETRACEMENT SURVEY

VIRGINIA MILITARY SURVEY 3224
 MONROE TOWNSHIP
 LOGAN COUNTY, OHIO

THOMAS W. MILLER AND
 LAURA A. MILLER
 8.688 ACRES
 O.R. 709, PG. 74

JACK L. JACKSON AND
 CYNTHIA G. JACKSON
 130.06 ACRES
 O.R. 447, PG. 959

7.541 ACRES

TRENA D. SHANK
 7.545 ACRES
 O.R. 1393, PG. 5027

JOHN L. LONGSHORE, II AND
 STACEY D. LONGSHORE
 5.019 ACRES
 O.R. 1392, PG. 3142

JOHN L. LONGSHORE, II AND
 STACEY D. LONGSHORE
 5.676 ACRES
 O.R. 1343, PG. 659

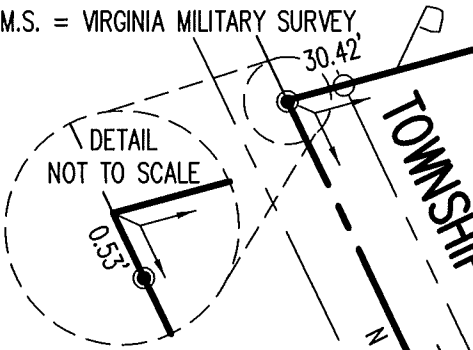
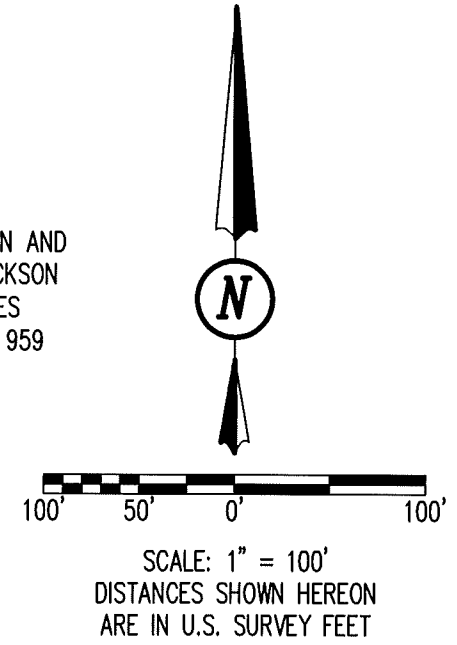

OCCUPATION NOTE:

NO EVIDENCE OF OCCUPATION ALONG BOUNDARY LINES UNLESS OTHERWISE SHOWN

BASIS FOR BEARINGS:

BEARINGS AND DISTANCES, SHOWN HEREON, ARE DERIVED FROM GPS OBSERVATIONS BASED ON GRID NORTH, OHIO STATE PLANE COORDINATE SYSTEM, NORTH ZONE, NAD83 (2011), WITH THE CENTER-LINE OF TOWNSHIP ROAD 178, HAVING A BEARING OF N 25°42'07" W.

CERTIFICATION:

THIS PLAT WAS PREPARED BY DLZ OHIO, INC. AND IS A TRUE AND ACCURATE REPRESENTATION, TO THE BEST OF MY KNOWLEDGE AND BELIEF, OF A SURVEY MADE BY THE SAME IN APRIL, 2022.

THIS SURVEY WAS PERFORMED WITHOUT THE BENEFIT OF A TITLE POLICY; ALL OWNERSHIP SHOWN IS BASED UPON RECORD DATA ACQUIRED AT THE TIME OF SURVEY, NO GUARANTEE IS PLACED UPON ACTUAL OWNERSHIP OF ANY PROPERTY.

EASEMENTS MAY EXIST ON SUBJECT PROPERTY THAT WOULD BE REVEALED IN A TITLE EXAMINATION.

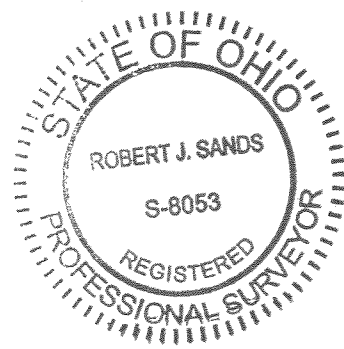

Robert J. Sands 04/29/22
 ROBERT J. SANDS
 PROFESSIONAL SURVEYOR NO. 8053
 APRIL, 2022

COPYRIGHT 2022 BY:

117 N. Madriver Street • Bellefontaine, OH 43311
 (937) 593-7335 • www.dlz.com
 Project #2221-2024.00

DEED & SURVEY REFERENCES:

DEED REFERENCES ARE SHOWN HEREON.

LOGAN COUNTY ENGINEER'S MAP ROOM
 FILES: 9471, 1743 AND 1745

DRAWN BY:	DESCRIPTION	REV. NO.	DATE
KSS			4/28/2022

INDEXED ON MAP
 9471