

Bridge No. 12-6.65 - Preliminary Survey

February 11, 1942

40

E. Carr
G. Wilson
R. Reed
E. Barnes

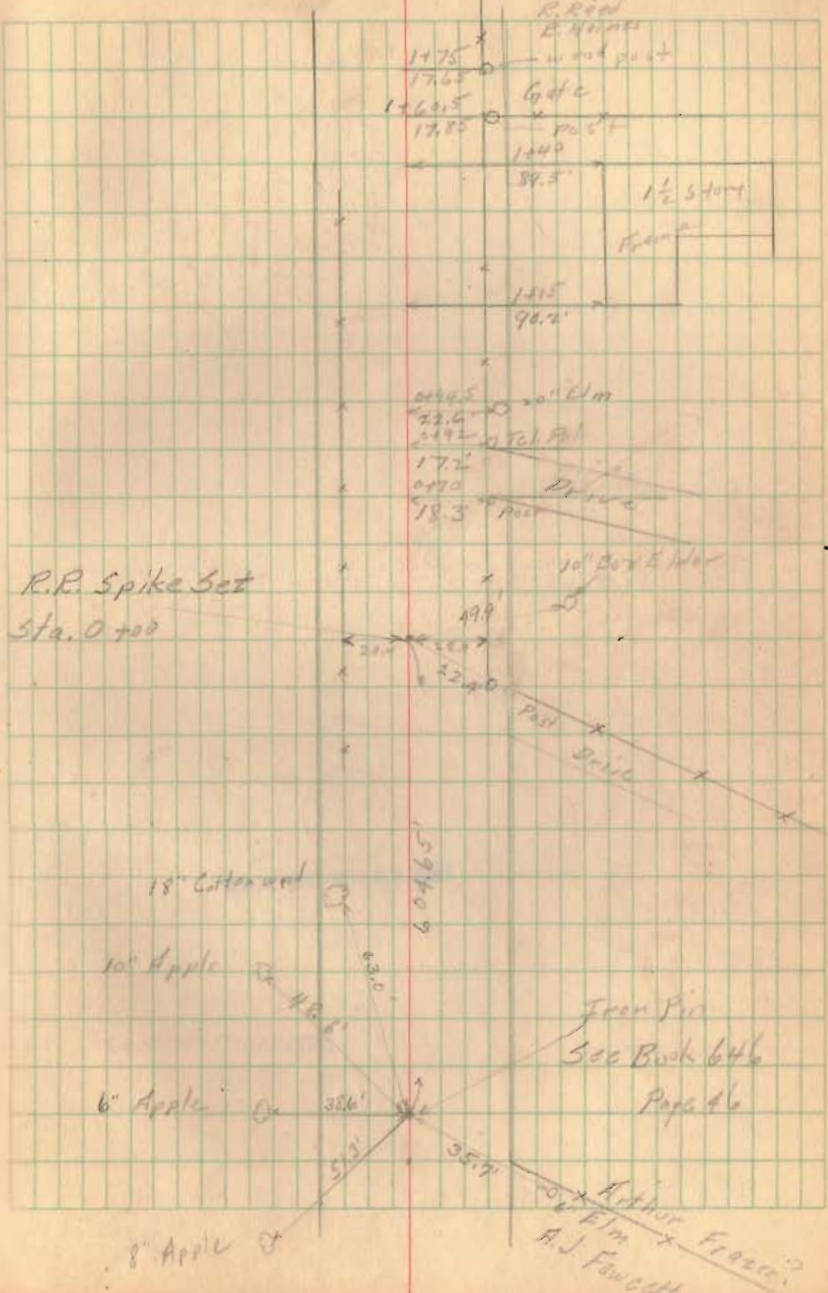

1831

INDEXED ON MAP

March 6, 1942

41

E. W. Lane
G. W. W. Jones
R. H. Ketch
Chas. Miller, Ass

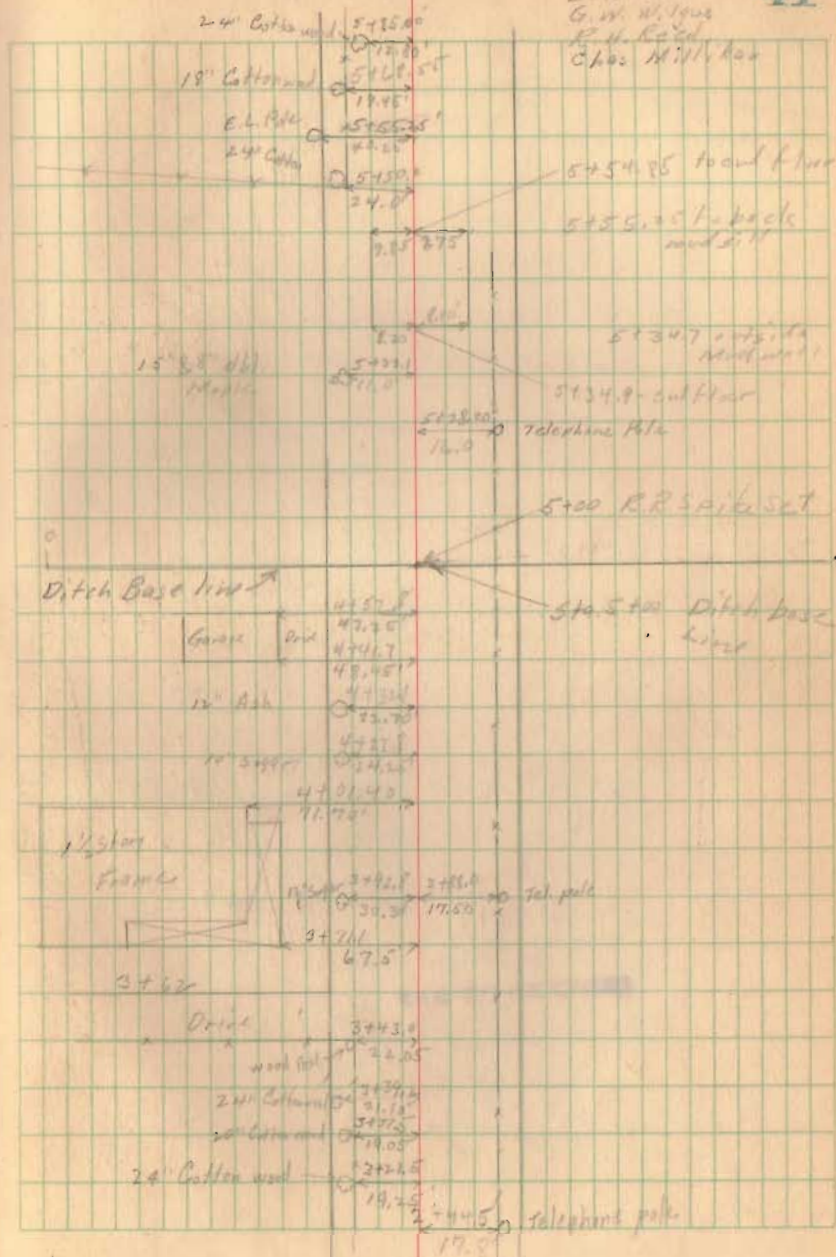

1831

INDEXED ON MAP

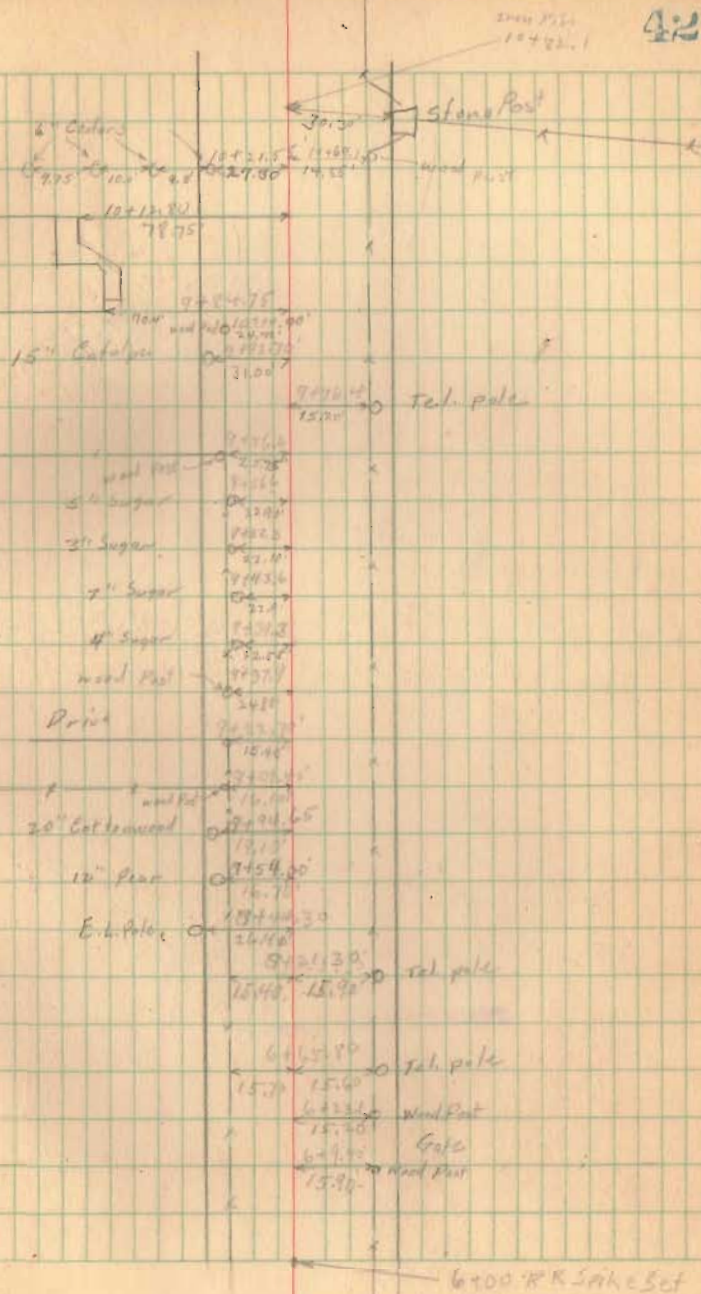

$$\begin{array}{r} 21 \\ 9 \\ \hline 30 \\ 15 \\ 9 \\ \hline 54 \end{array}$$

1831

INDEXED ON MAP