

CORNELIUS SURVEY

September 29, 1973

The following described real estate situated in the Village of Harper, V.M.S.9885, Rushcreek Township, Logan County, Ohio and being more particularly described as follows:

Beginning at an iron bar in the centerline of Northwood Street (C.R.25) at the northeast corner of Gerald R. Nickell's 0.27 acre tract, said iron bar being N.37°00'W. 473.73 feet from the southeast corner of the Harper M.E.Church's tract; thence with the north line of said Nickell's 0.27 acre and 0.81 acre tracts; S.53°10.4'W. 673.33 feet to an iron bar in an easterly line of Charles E. Shoots' 110.50 acre tract; thence with said Shoots' line N.6°02'W. 259.01 feet to an iron bar in the southwest corner of Elmer A. Davis' 3.47 acre tract; thence with said Davis' south line N.52°08.4'E. 540.12 feet to an iron bar in the center of Northwood Street; thence with said street S.37°00'E. 232.25 feet to the place of beginning.

Containing 3.16 acres more or less.

I hereby certify that the above is a true and accurate description of a survey made by me.

Leslie H. Geeslin
Reg. Surveyor 5248

ID

5430

ELMER A. DAVIS
3.47 AC.

CHAS. E. SHOOTZ
110.50 AC.

N. 52° 08.4' E.
540.12'

3.16 AC.

N. 6° 02' W.
259.01'

S. 53° 10.4' W. 673.33'

GERALD R. NICKELL 0.81 AC. N 0.27 AC.

232.25'

S. 37° 00' E.

3.00 AC



473.73

NORTHWOOD ST. (60')

CORNELIUS SURVEY
SEPTEMBER 29, 1973
V.M.S. 9885
VILLAGE OF HARPER
RUSHERS TOWNSHIP
LOGAN COUNTY, OHIO
SCALE 1" = 100'

IRON BAR @
S.E. COR. OF
HARPER M.E. CHURCH

● = R.R. SPIKE SET
○ = 3/4" IRON BAR SET

REF: D.B. 205/600
D.B. 336/596
DRAWER R NO 2760

5430 IP

INDEXED ON MAP

LESLIE H. GEESLIN
REG. SURVEYOR 5248

REC'D 5-29-07 S.M.J. OK

MARY DAVIS
3.50 ACRES
O.R. 291, PG. 483

4.234 ACRES
OF WHICH 0.206 ACRE IS WITHIN
THE HIGHWAY RIGHT-OF-WAY

SANDRA J. SMITH
3.16 ACRES
O.R. 846, PG. 804
PARCEL II

KATHRYN SHOOTS, TRUSTEE OF THE
KATHRYN SHOOTS LIVING TRUST
174.567 ACRES
O.R. 529, PG. 420
TRACT II, PARCEL ONE

JOSEPH I. STEVENS
3.00 ACRES
O.R. 161, PG. 42

0.81 ACRE
O.R. 846, PG. 804
PARCEL I, TRACT II

0.27 ACRE
O.R. 846, PG. 804
PARCEL I, TRACT I

(3.165 ACRES)

(0.274 ACRE)

(0.795 ACRE)

COUNTY HIGHWAY 25 (60')

LEGEND:

- ⊙ 3/4 INCH IRON ROD FOUND
- 5/8 INCH IRON ROD SET
- ⊕ RAILROAD SPIKE SET
- ⊗ RAILROAD SPIKE FOUND

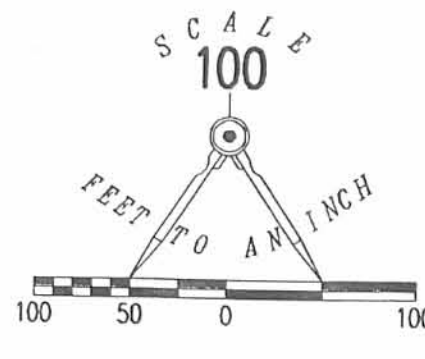

VIRGINIA MILITARY SURVEY 9885
VIRGINIA MILITARY SURVEY 10179-10404

RETRACEMENT SURVEY OF THE
SANDRA J. SMITH
0.27 ACRE TRACT, 0.81 ACRE TRACT
AND 3.15 ACRE TRACT
OFFICIAL RECORD 846, PAGE 804
PARCEL I, TRACTS II AND II
AND PARCEL II
VIRGINIA MILITARY SURVEY 9885
RUSHCREEK TOWNSHIP
LOGAN COUNTY, OHIO

SURVEYED BY:

William K. Bruce
WILLIAM K. BRUCE
PROFESSIONAL SURVEYOR 7437
MAY 20, 2007

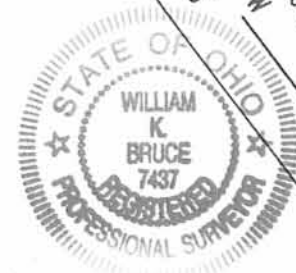

ORIGINAL STAMP IN GREEN

COPYRIGHT 2007 BY:
LEE SURVEYING & MAPPING CO., INC.
117 North Madriver Street
BELLEFONTAINE, OHIO 43311
(937) 593-7335
surveys@lsminc.us
KSR D0507 4431057 L-4431-3

2 WORKING DAYS
BEFORE YOU DIG
CALL TOLL FREE 800-362-2764
OHIO UTILITIES PROTECTION SERVICE.

INDEXED ON MAP
5430 ZP