

July A.D. 1835

N<sup>o</sup> 282

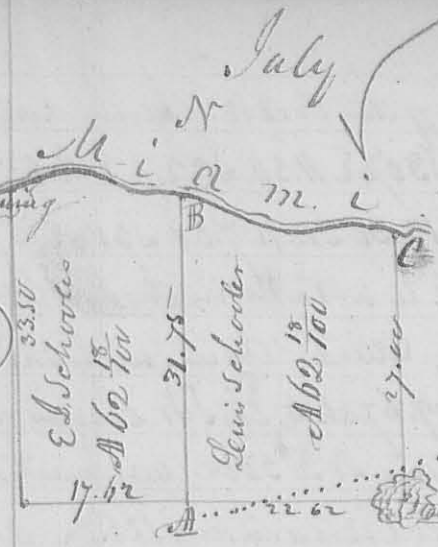

Surveyed July 18. 1835 for Lewis & Evan J. Scholer the west half of fractional Sec- 18 S. 3. R. 12 W. as follows beginning at the NW corner of said section at a stake near the river then South 33. ch 50 links to the W corner of the section, thence with the South line thence of East 40 ch 25 links crossing a road at 22 ch, to a stake in a pond thence North 27 chains crossing road at 4.30 to a red oak 7 1/2 S 35 E 17 Links, a B. Oak 8 1/2 S 50 W 14 links on the bank of the river, thence with the Meander as follows N 77 E 6.25 S 88 W 2.00 S 79 1/4 W 2.50 N 77 1/4 W 4.35 N 66 W 3.55 N 72 W 4.35 N 77 E 5.20 N 65 W 3.90 N 81 1/2 W 3.30 S 81 W 3.37 S 71 W 2.30 to the beginning containing 124 3/4 acres. Divided into two equal parts by the line A. B. Beginning at A on the South line of the section 17 ch 62 links from the NW corner thence at an Ash 8 1/2 S 39 Links, & Dogwood 8 1/2 S 50 W 26 Links, running thence North 31 ch 75 Links to a Buckeye 8 1/2 S 28 1/2 W 17 & Hickory 16 1/2 S 78 E 12 Links at the end of the line A. B. & distance from Lewis Scholer's N. E. corner, on the river (See sketch)

L. A. Hopkins, L. C. Surveyor.

N<sup>o</sup> 283

Surveyed July 31<sup>st</sup> 1835 for Abram Gardner the S. E. q. of the South East of S. 4 T. 5 R. 8 E Beginning at the NW corner a Beech 18 1/2 S 87 W 30 Links, Sugar tree 7 1/2 E 8 Links in the South line of the Sect. & center of South line of said q. thence N 3. 50 W 20 chains to a Beech 6 1/2 S 40 W 4 Links, White Oak 1/2 S 45 W 43 Links, thence N 86. 10 E 20 ch 30 links to a Beech 8 1/2 S 106 4 Links and a pine 18 1/2 S 60 E 11 Links, thence S 3. 50 E 20 chains to the South East corner of the section, thence S 86 10 W 20 chains 50 Links to the beginning containing 61 acres

L. A. Hopkins, L. C. Surveyor

N<sup>o</sup> 284

Surveyed August 1. 1835 for Saml<sup>d</sup> Hall a part of the S. W. q. of S. 4 T. 5 R. 8 E and part of the West half of the S. E. q. of the same Sect. as follows Beginning at q. corner on the West line of the Sect. two N. on the plat thence N 86. 10 E 29 ch 25 Links to a pinked hollow 10 1/2 S 58 W 38 Links, Gray ash 18 1/2 S 76 W 55 Links on the creek, the

Aug 1835

Corner stake standing in the center of the creek, thence down the creek with its meanders as follows S30°E 11.50 S22°E 8.50 N66°E 9.40

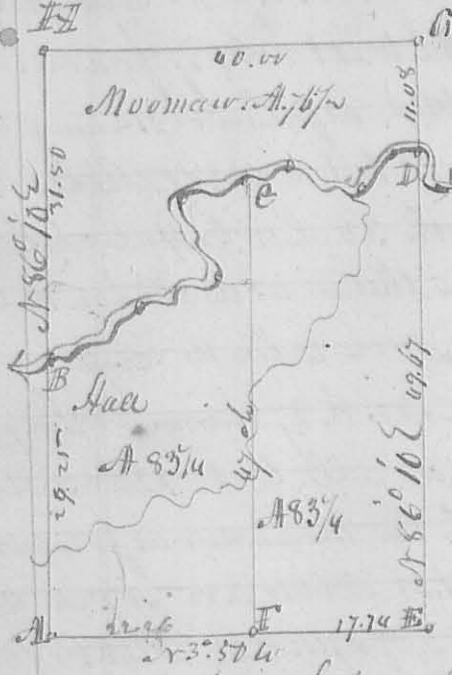

g. 40 S18°E 12.30 S15°W 7.50 S37°E 5.00  
 S47°W 2.50 to a stake in the south line of the lot see letter D thence with said line S86°10' W 49.67 ch to the SW corner of the section thence N3°50' W 40 chains to the beginning containing 166 1/2 acres - divided by the right line B F into two equal parts as follows Beginning at B in the west line of the section 17.74 from the SW corner at a Post 15 1/2 S 54° E 7 Links Red 8 1/2 S N 2 E 42 1/2 Links thence N 86° 10' E, crossing a small branch several times 47 ch. to a stake on the river bank

Comers

Description of Comers. At pt. com B. forked willow & ash above described. E. Sect. corner II. Corner of Moomaw's land. Red Elm 36 1/2 N 25° W 17 1/2 Links. Ironwood 6 1/2 S 50° W 36 Links. C. Post 18 S N 38° W 30 Links. Sugar tree 17 1/2 S 8 Links.

Aug 1. 1835

Dan Hopkins S. P. C.

N° 285

8353

Surveyed for R. Patterson Fifty acres of Land being part of the NW q. of sect. 527 3/4 R 14 W R 1 as follows beginning at the SW corner of the sect. thence N 7/8 E 40 chains to a Black Oak 22 1/2 N 36° W 42 Links. White Oak Grub 2 1/2 S 11 E 39 L. thence S 89° E 12 ch. 30 Links to a Black Oak 27 1/2 N 33 E 24 Links a Black Oak Grub 2 1/2 S 69° W 36 Links thence 1/2 W 40 chains to a stake in a prairie in the south line of the section thence N 89° W 12 ch. 50 Links to the beginning. Containing 50 acres.

Aug. 1835

Dan Hopkins S. P. C.

N° 286

8354

Surveyed off the NW q. of S 18 T 5. N 8 E beginning at the SE corner of said quarter a White Oak 15 1/2 N 36° W 12 1/2 Links. W. O 8 1/2 S 11 E 5 Links thence S 86° 10' W 6 ch. 50 to a White Oak 15 1/2 N 20° W 29 Links. Hickory 8 1/2 N 61° E 34 Links. thence N 3° 30' W 30 ch 7/8 to Red Oak 15 1/2 N 7° E 22. W. O. 12 1/2 N 14° W 15 Links. thence N 86° 10' E 6 ch. 30 L to a W. O. 16 1/2 N 56° E 4 Links. Hickory 22 1/2

Oct- 1835

S 71° W 18 L. thence S 3° 50' E 30.76 to beginning Containing 90 acres. D. Hopkins S. P. C.