

REV'D 3-5-02 SML/OK

# Lee Surveying and Mapping Co., Inc.

Land Surveys • Topography • Subdivisions • Construction Layout

117 N. Madriver St.  
Bellefontaine OH 43311

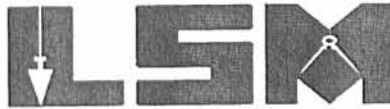

Phone: (937) 593-7335  
Fax: (937) 593-7444

## ANTRAM 24.491 ACRES

Lying in Section 3, Town 7 South, Range 8 East, Stokes Township, Logan County, Ohio.

Being out of the Joseph M. Antram 121.86 acre tract as deeded and described in Official Record 545, Page 478 and Official Record 106, Page 247 of the Logan County Records of Deeds and being more particularly described as follows:

Beginning at a 3/4 inch iron rod found on the northeast corner of Section 4 on the center-line of Township Road 52 (50 feet wide).

THENCE, with the north line of Section 3 and the center-line of Township Road 52, S 89°-15'-00" E, a distance of 1463.79 feet to a MAG nail set at the TRUE POINT OF BEGINNING.

THENCE, with the north line of Section 3 and the center-line of Township Road 52, S 89°-15'-00" E, a distance of 535.04 feet to a MAG nail set.

THENCE, with the west line of the Mary Lou Moon 45.5 acre tract (O.R. 545, Pg. 474 and O.R. 106, Pg. 249), S 0°-44'-03" W, a distance of 1993.91 feet to a 5/8 inch iron rod found, passing a 5/8 inch iron rod set at 25.00 feet.

THENCE, N 89°-15'-00" W, a distance of 535.05 feet to a 5/8 inch iron rod set.

THENCE, N 0°-44'-03" E, a distance of 1993.91 feet to the point of beginning, passing a 5/8 inch iron rod set at 1968.91 feet.

Containing 24.491 acres, of which 0.307 acre is within the highway right-of-way.

The basis for bearings is the north line of Section 3, being S 89°-15'-00" E, and all other bearings are from angles and distances measured in a field survey by Lee Surveying and Mapping Co., Inc. on February 15, 2002.



ORIGINAL STAMP IN GREEN

Description prepared by:

Jeffrey I. Lee  
Professional Surveyor 6359  
February 25, 2002  
Revised March 3, 2002

L-3313

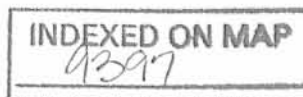

1D-1

REC'D 3-5-02 SMY OK  
**Lee Surveying and Mapping Co., Inc.**

Land Surveys • Topography • Subdivisions • Construction Layout

117 N. Madriver St.  
Bellefontaine OH 43311



Phone: (937) 593-7335  
Fax: (937) 593-7444

**ANTRAM  
42.555 ACRES**

Lying in Section 4, Town 7 South, Range 8 East, Stokes Township, Logan County, Ohio.

Being out of the Joseph M. Antram 105.35 acre tract as deeded and described in Official Record 545, Page 476 and Official Record 417, Page 342 of the Logan County Records of Deeds and being more particularly described as follows:

Beginning at a 3/4 inch iron rod found on the northeast corner of Section 4 on the center-line of Township Road 52 (50 feet wide).

THENCE, with the east line of Section 4, S 0°-33'-28" W, a distance of 2480.60 feet to a 3/4 inch iron rod found, passing a 5/8 inch iron rod set at 25.00 feet.

THENCE, with the north line of the W.R. Dickson III, original 18.912 acre tract (O.R. 24, Pg. 304), N 89°-23'-21" W, a distance of 746.97 feet to a 5/8 inch iron rod set.

THENCE, N 0°-33'-28" E, a distance of 2482.66 feet to a MAG nail set, passing a 5/8 inch iron rod set at 2457.66 feet.

THENCE, with the north line of Section 4 and the center-line of Township Road 52, S 89°-13'-50" E, a distance of 746.97 feet to the point of beginning.

Containing 42.555 acres, of which 0.432 acre is within the highway right-of-way.

The basis for bearings is the north line of Section 3, being S 89°-15'-00" E, and all other bearings are from angles and distances measured in a field survey by Lee Surveying and Mapping Co., Inc. on February 15, 2002.

Description prepared by:

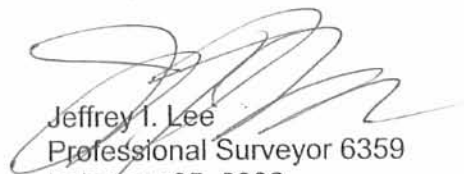

ORIGINAL STAMP IN GREEN

  
Jeffrey I. Lee  
Professional Surveyor 6359  
February 25, 2002  
Revised March 3, 2002

L-3313

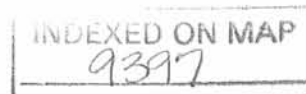

1D-2

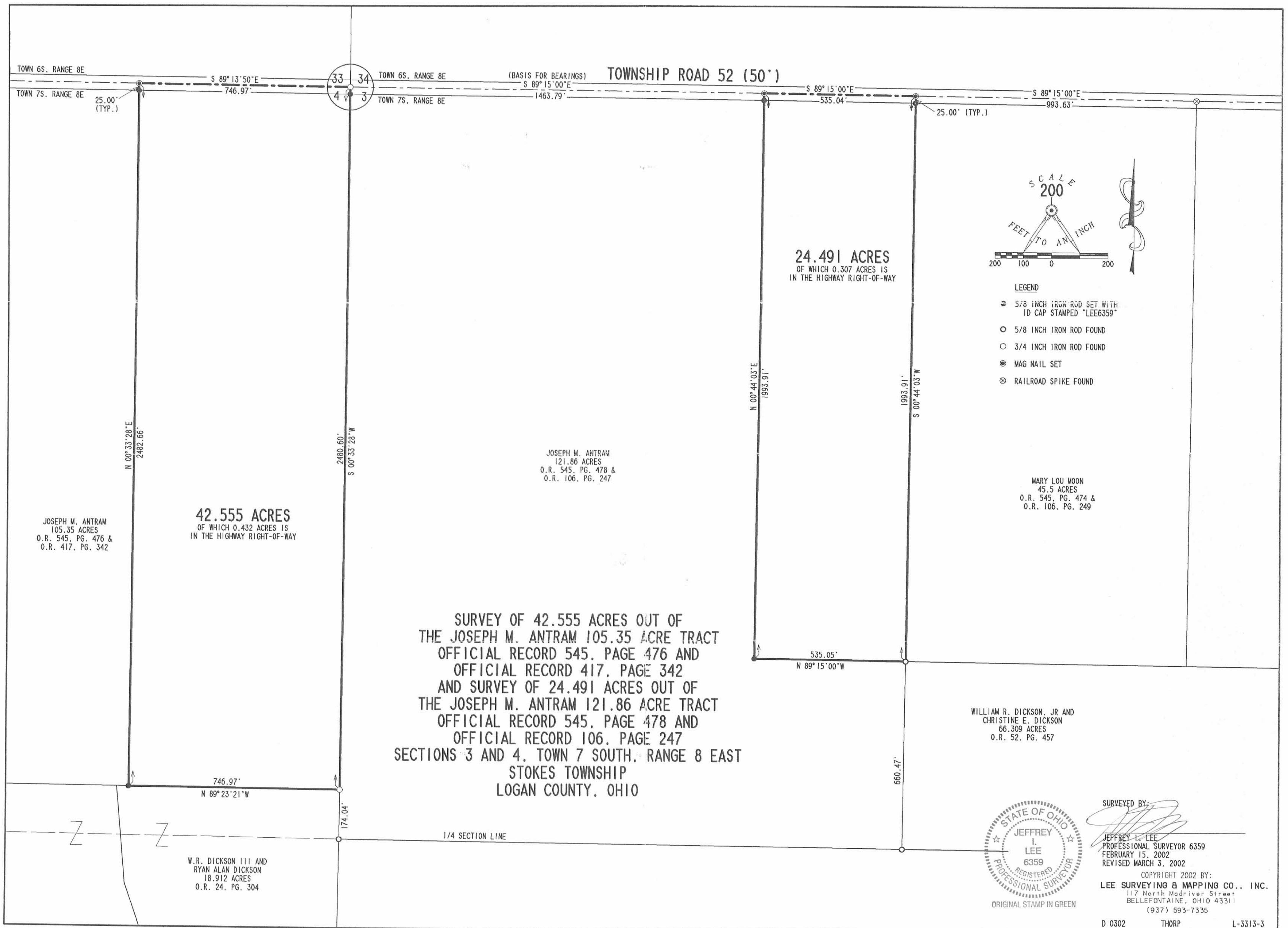

TOWN 6S. RANGE 8E

TOWN 7S. RANGE 8E

TOWN 6S. RANGE 8E

TOWN 7S. RANGE 8E

TOWNSHIP ROAD 52 (50')

(BASIS FOR BEARINGS)  
S 89° 15' 00" E

S 89° 15' 00" E

S 89° 15' 00" E

25.00' (TYP.)

S 89° 13' 50" E  
746.97'

1463.79'

535.04'

993.63'

25.00' (TYP.)

N 00° 33' 28" E  
2482.66'

S 00° 33' 28" W  
2480.60'

N 00° 44' 03" E  
1993.91'

S 00° 44' 03" W  
1993.91'

535.05'  
N 89° 15' 00" W

660.47'

42.555 ACRES  
OF WHICH 0.432 ACRES IS  
IN THE HIGHWAY RIGHT-OF-WAY

JOSEPH M. ANTRAM  
105.35 ACRES  
O.R. 545, PG. 476 &  
O.R. 417, PG. 342

JOSEPH M. ANTRAM  
121.86 ACRES  
O.R. 545, PG. 478 &  
O.R. 106, PG. 247

24.491 ACRES  
OF WHICH 0.307 ACRES IS  
IN THE HIGHWAY RIGHT-OF-WAY

MARY LOU MOON  
45.5 ACRES  
O.R. 545, PG. 474 &  
O.R. 106, PG. 249

SURVEY OF 42.555 ACRES OUT OF  
THE JOSEPH M. ANTRAM 105.35 ACRE TRACT  
OFFICIAL RECORD 545, PAGE 476 AND  
OFFICIAL RECORD 417, PAGE 342  
AND SURVEY OF 24.491 ACRES OUT OF  
THE JOSEPH M. ANTRAM 121.86 ACRE TRACT  
OFFICIAL RECORD 545, PAGE 478 AND  
OFFICIAL RECORD 106, PAGE 247  
SECTIONS 3 AND 4, TOWN 7 SOUTH, RANGE 8 EAST  
STOKES TOWNSHIP  
LOGAN COUNTY, OHIO

W.R. DICKSON III AND  
RYAN ALAN DICKSON  
18.912 ACRES  
O.R. 24, PG. 304

WILLIAM R. DICKSON, JR AND  
CHRISTINE E. DICKSON  
66.309 ACRES  
O.R. 52, PG. 457



SURVEYED BY:  
*Jeffrey L. Lee*  
JEFFREY L. LEE  
PROFESSIONAL SURVEYOR 6359  
FEBRUARY 15, 2002  
REVISED MARCH 3, 2002  
COPYRIGHT 2002 BY:  
LEE SURVEYING & MAPPING CO., INC.  
117 North Madriver Street  
BELLEFONTAINE, OHIO 43311  
(937) 693-7335

INDEXED ON MAP  
9397 1P

REC'D 12-7-07 SML/ALC

# Lee Surveying and Mapping Co., Inc.

Land Surveys • Topography • Subdivisions • Construction Layout

117 N. Madriver St.  
Bellefontaine OH 43311

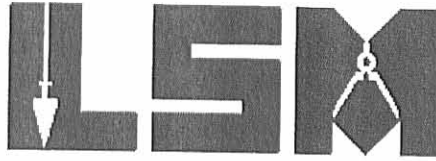

Phone: (937) 593-7335  
Fax: (937) 593-7444

## MOON 2.300 ACRES TRACT A

Lying in Section 3, Town 7, Range 8, Stokes Township, Logan County, Ohio.

Being out of the Mary Lou Moon 45.2 acre tract as deeded and described in Official Record 545, Page 474 of the Logan County Records of Deeds and being more particularly described as follows:

Commencing at a 5/8 inch iron rod found at the northwest corner of Section 3 also on the center-line of Township Road 52 (50 feet wide).

THENCE, with the north line of Section 3 and the center-line of Township Road 52, S 89°-15'-00"E, a distance of 2681.33 feet to a MAG nail set at the TRUE POINT OF BEGINNING.

THENCE, with the north line of Section 3 and the center-line of Township Road 52, S 89°-15'-00"E, a distance of 301.89 feet to a MAG nail set.

THENCE, S 0°-44'-03"W, a distance of 331.87 feet to a 5/8 inch iron rod set, passing a 5/8 inch iron rod set at 25.00 feet.

THENCE, N 89°-15'-00"W, a distance of 301.89 feet to a 5/8 inch iron rod set.

THENCE, N 0°-44'-03"E, a distance of 331.87 feet to the point of beginning, passing a 5/8 inch iron rod set at 306.87 feet.

Containing 2.300 acres of which 0.173 acre is within the highway right-of-way.

The basis for bearings is the north line of Section 3, being S 89°-15'-00"E, and all other bearings are from angles and distances measured in a field survey by Lee Surveying and Mapping Co., Inc. on December 3, 2007.

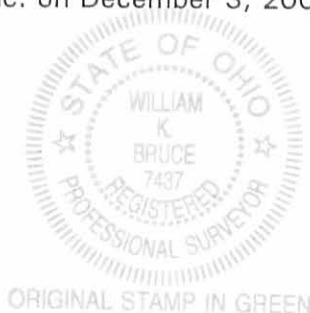

Description prepared by:

*William K. Bruce*

William K. Bruce  
Professional Surveyor 7437  
December 3, 2007

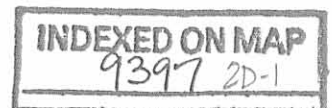

L-1377107

REC'D 12-7-07 SMY OK

# Lee Surveying and Mapping Co., Inc.

Land Surveys • Topography • Subdivisions • Construction Layout

117 N. Madriver St.  
Bellefontaine OH 43311

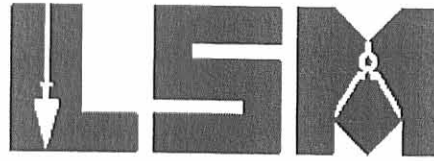

Phone: (937) 593-7335  
Fax: (937) 593-7444

## MOON 2.300 ACRES TRACT B

Lying in Section 3, Town 7, Range 8, Stokes Township, Logan County, Ohio.

Being out of the Mary Lou Moon 45.2 acre tract as deeded and described in Official Record 545, Page 474 of the Logan County Records of Deeds and being more particularly described as follows:

Commencing at a 5/8 inch iron rod found at the northwest corner of Section 3 also on the center-line of Township Road 52 (50 feet wide).

THENCE, with the north line of Section 3 and the center-line of Township Road 52, S 89°-15'-00"E, a distance of 2379.44 feet to a MAG nail set at the TRUE POINT OF BEGINNING.

THENCE, with the north line of Section 3 and the center-line of Township Road 52, S 89°-15'-00"E, a distance of 301.89 feet to a MAG nail set.

THENCE, S 0°-44'-03"W, a distance of 331.87 feet to a 5/8 inch iron rod set, passing a 5/8 inch iron rod set at 25.00 feet.

THENCE, N 89°-15'-00"W, a distance of 301.89 feet to a 5/8 inch iron rod set.

THENCE, N 0°-44'-03"E, a distance of 331.87 feet to the point of beginning, passing a 5/8 inch iron rod set at 306.87 feet.

Containing 2.300 acres of which 0.173 acre is within the highway right-of-way.

The basis for bearings is the north line of Section 3, being S 89°-15'-00"E, and all other bearings are from angles and distances measured in a field survey by Lee Surveying and Mapping Co., Inc. on December 3, 2007.



ORIGINAL STAMP IN GREEN

Description prepared by:

William K. Bruce  
Professional Surveyor 7437  
December 3, 2007

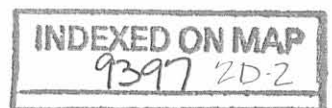

L-1377107



REC'D 12-7-07 SMY/OL

# Lee Surveying and Mapping Co., Inc.

Land Surveys • Topography • Subdivisions • Construction Layout

117 N. Madriver St.  
Bellefontaine OH 43311

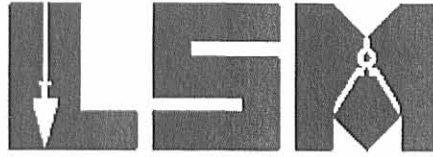

Phone: (937) 593-7335  
Fax: (937) 593-7444

## MOON 2.300 ACRES TRACT C

Lying in Section 3, Town 7, Range 8, Stokes Township, Logan County, Ohio.

Being out of the Mary Lou Moon 45.2 acre tract as deeded and described in Official Record 545, Page 474 of the Logan County Records of Deeds and being more particularly described as follows:

Commencing at a 5/8 inch iron rod found at the northwest corner of Section 3 also on the center-line of Township Road 52 (50 feet wide).

THENCE, with the north line of Section 3 and the center-line of Township Road 52, S 89°-15'-00"E, a distance of 2077.55 feet to a MAG nail set at the TRUE POINT OF BEGINNING.

THENCE, with the north line of Section 3 and the center-line of Township Road 52, S 89°-15'-00"E, a distance of 301.89 feet to a MAG nail set.

THENCE, S 0°-44'-03"W, a distance of 331.87 feet to a 5/8 inch iron rod set, passing a 5/8 inch iron rod set at 25.00 feet.

THENCE, N 89°-15'-00"W, a distance of 301.89 feet to a 5/8 inch iron rod set.

THENCE, N 0°-44'-03"E, a distance of 331.87 feet to the point of beginning, passing a 5/8 inch iron rod set at 306.87 feet.

Containing 2.300 acres of which 0.173 acre is within the highway right-of-way.

The basis for bearings is the north line of Section 3, being S 89°-15'-00"E, and all other bearings are from angles and distances measured in a field survey by Lee Surveying and Mapping Co., Inc. on December 3, 2007.



ORIGINAL STAMP IN GREEN

Description prepared by:

William K. Bruce  
Professional Surveyor 7437  
December 3, 2007

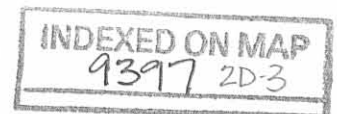

L-1377107

REC'D 12-7-07 SMJ/OK  
**Lee Surveying and Mapping Co., Inc.**

Land Surveys • Topography • Subdivisions • Construction Layout

117 N. Madriver St.  
Bellefontaine OH 43311

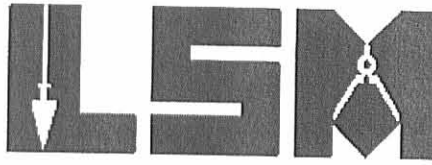

Phone: (937) 593-7335  
Fax: (937) 593-7444

**MOON  
0.600 ACRE**

Lying in Section 3, Town 7, Range 8, Stokes Township, Logan County, Ohio.

Being out of the Mary Lou Moon 45.2 acre tract as deeded and described in Official Record 545, Page 474 of the Logan County Records of Deeds and being more particularly described as follows:

Commencing at a 5/8 inch iron rod found at the northwest corner of Section 3 also on the center-line of Township Road 52 (50 feet wide).

THENCE, with the north line of Section 3 and the center-line of Township Road 52, S 89°-15'-00"E, a distance of 1998.82 feet to a MAG nail found at the TRUE POINT OF BEGINNING.

THENCE, with the north line of Section 3 and the center-line of Township Road 52, S 89°-15'-00"E, a distance of 78.73 feet to a MAG nail set.

THENCE, S 0°-44'-03"W, a distance of 331.87 feet to a 5/8 inch iron rod set, passing a 5/8 inch iron rod set at 25.00 feet.

THENCE, N 89°-15'-00"W, a distance of 78.73 feet to a 5/8 inch iron rod set.

THENCE, with the east line of the Mary Louise Antram Moon 24.491 acre tract (O.R. 561, Pg. 434), N 0°-44'-03"E, a distance of 331.87 feet to the point of beginning, passing a 5/8 inch iron rod found at 306.87 feet.

Containing 0.600 acre of which 0.045 acre is within the highway right-of-way.

The basis for bearings is the north line of Section 3, being S 89°-15'-00"E, and all other bearings are from angles and distances measured in a field survey by Lee Surveying and Mapping Co., Inc. on December 3, 2007.

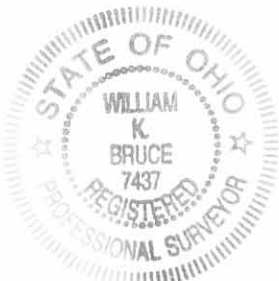

ORIGINAL STAMP IN GREEN

Description prepared by:

*William K. Bruce*

William K. Bruce  
Professional Surveyor 7437  
December 3, 2007

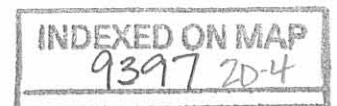

L-1377107

REV'D 12-7-07 SWM OK  
**Lee Surveying and Mapping Co., Inc.**

Land Surveys • Topography • Subdivisions • Construction Layout

117 N. Madriver St.  
Bellefontaine OH 43311

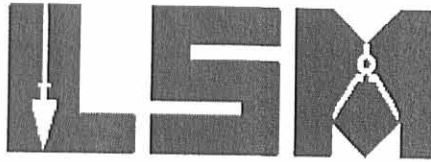

Phone: (937) 593-7335  
Fax: (937) 593-7444

**MOON  
1.700 ACRES**

Lying in Section 3, Town 7, Range 8, Stokes Township, Logan County, Ohio.

Being out of the Mary Louise Antram Moon 24.491 acre tract as deeded and described in Official Record 561, Page 434 of the Logan County Records of Deeds and being more particularly described as follows:

Commencing at a 5/8 inch iron rod found at the northwest corner of Section 3 also on the center-line of Township Road 52 (50 feet wide).

THENCE, with the north line of Section 3 and the center-line of Township Road 52, S 89°-15'-00"E, a distance of 1775.66 feet to a MAG nail set at the TRUE POINT OF BEGINNING.

THENCE, with the north line of Section 3 and the center-line of Township Road 52, S 89°-15'-00"E, a distance of 223.16 feet to a MAG nail found.

THENCE, with the west line of the Mary Lou Moon 45.2 acre tract (O.R. 545, Pg. 474), S 0°-44'-03"W, a distance of 331.87 feet to a 5/8 inch iron rod set, passing a 5/8 inch iron rod found at 25.00 feet.

THENCE, N 89°-15'-00"W, a distance of 223.16 feet to a 5/8 inch iron rod set.

THENCE, N 0°-44'-03"E, a distance of 331.87 feet to the point of beginning, passing a 5/8 inch iron rod set at 306.87 feet.

Containing 1.700 acres of which 0.128 acre is within the highway right-of-way.

The basis for bearings is the north line of Section 3, being S 89°-15'-00"E, and all other bearings are from angles and distances measured in a field survey by Lee Surveying and Mapping Co., Inc. on December 3, 2007.

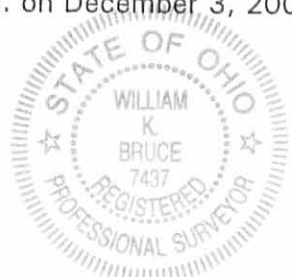

ORIGINAL STAMP IN GREEN

Description prepared by:

William K. Bruce  
Professional Surveyor 7437  
December 3, 2007

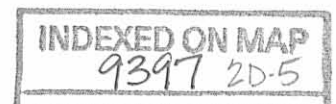

L-1377107



REC'D 12-7-07 SWM OK  
**Lee Surveying and Mapping Co., Inc.**

Land Surveys • Topography • Subdivisions • Construction Layout

117 N. Madriver St.  
Bellefontaine OH 43311

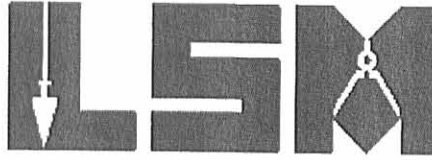

Phone: (937) 593-7335  
Fax: (937) 593-7444

**MOON  
2.300 ACRES  
TRACT E**

Lying in Section 3, Town 7, Range 8, Stokes Township, Logan County, Ohio.

Being out of the Mary Louise Antram Moon 24.491 acre tract as deeded and described in Official Record 561, Page 434 of the Logan County Records of Deeds and being more particularly described as follows:

Commencing at a 5/8 inch iron rod found at the northwest corner of Section 3 also on the center-line of Township Road 52 (50 feet wide).

THENCE, with the north line of Section 3 and the center-line of Township Road 52, S 89°-15'-00"E, a distance of 1473.78 feet to a MAG nail set at the TRUE POINT OF BEGINNING.

THENCE, with the north line of Section 3 and the center-line of Township Road 52, S 89°-15'-00"E, a distance of 301.88 feet to a MAG nail set.

THENCE, S 0°-44'-03"W, a distance of 331.87 feet to a 5/8 inch iron rod set, passing a 5/8 inch iron rod set at 25.00 feet.

THENCE, N 89°-15'-00"W, a distance of 301.88 feet to a 5/8 inch iron rod set.

THENCE, N 0°-44'-03"E, a distance of 331.87 feet to the point of beginning, passing a 5/8 inch iron rod set at 306.87 feet.

Containing 2.300 acres of which 0.173 acre is within the highway right-of-way.

The basis for bearings is the north line of Section 3, being S 89°-15'-00"E, and all other bearings are from angles and distances measured in a field survey by Lee Surveying and Mapping Co., Inc. on December 3, 2007.



ORIGINAL STAMP IN GREEN

Description prepared by:

A handwritten signature in black ink that reads 'William K. Bruce'.

William K. Bruce  
Professional Surveyor 7437  
December 3, 2007

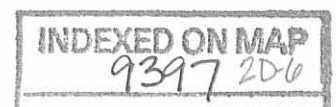

L-1377107

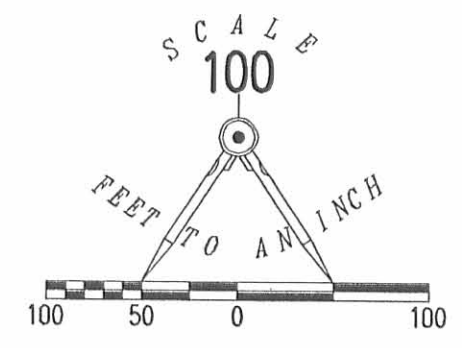

- LEGEND
- 5/8 INCH IRON ROD SET
  - 5/8 INCH IRON ROD FOUND
  - ⊙ MAG NAIL SET
  - ⊘ MAG NAIL FOUND
  - ⊗ RAILROAD SPIKE FOUND

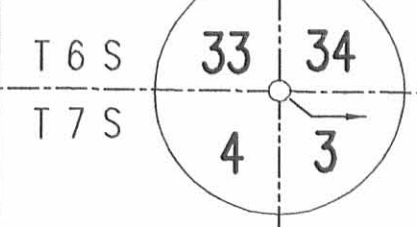

BASIS FOR BEARINGS

TOWNSHIP ROAD 52 (50')

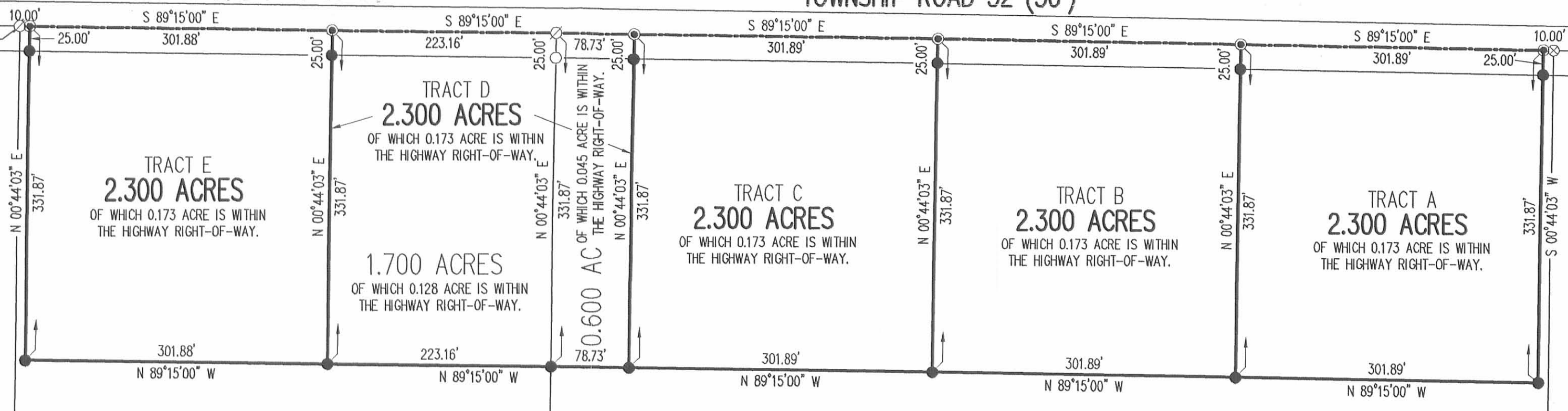

RONALD C. BARNES AND  
GLORIA J. BARNES,  
TRUSTEES  
45.19 ACRE TRACT  
O.R. 856, PG. 717  
TRACT V

MARY LOUISE ANTRAM MOON  
24.491 ACRE TRACT  
O.R. 561, PG. 434

MARY LOU MOON  
45.2 ACRE TRACT  
O.R. 545, PG. 474

A SURVEY OF FOUR TRACTS OUT OF THE  
MARY LOU MOON  
45.2 ACRE TRACT  
OFFICIAL RECORD 545, PAGE 474  
AND TWO TRACTS OUT OF THE  
MARY LOUISE ANTRAM MOON  
24.491 ACRE TRACT  
OFFICIAL RECORD 561, PAGE 434  
SECTION 3, TOWN 7, RANGE 8  
STOKES TOWNSHIP  
LOGAN COUNTY, OHIO

SURVEYED BY:

*William K. Bruce*  
WILLIAM K. BRUCE  
PROFESSIONAL SURVEYOR 7437  
DECEMBER 3, 2007



COPYRIGHT 2007 BY:  
LEE SURVEYING & MAPPING CO., INC.  
117 North Madriver Street  
BELLEFONTAINE, OHIO 43311  
(937) 593-7335  
surveys@lisminc.us  
ADW/KSS D1007 1377107 L-1377107-2

INDEXED ON MAP  
9397 2P

REC'D 6-10-08 SMY/CLK

# Lee Surveying and Mapping Co., Inc.

Land Surveys • Topography • Subdivisions • Construction Layout

117 N. Madriver St.  
Bellefontaine OH 43311



Phone: (937) 593-7335  
Fax: (937) 593-7444

## ANTRAM 5.327 ACRES

Lying in Section 4, Town 7, Range 8, Stokes Township, Logan County, Ohio.

Being out of the Donald Carson Antram 62.795 acre tract as deeded and described in Official Record 807, Page 739 of the Logan County Records of Deeds and being more particularly described as follows:

Commencing on a 3/4 inch iron rod found at the northeast corner of Section 4 on the center-line of Township Road 52.

THENCE, with the north line of Section 4 and the center-line of Township Road 52 (50 feet wide), N 89°-13'-50"W, a distance of 746.97 feet to a MAG nail found at the TRUE POINT OF BEGINNING.

THENCE, with the west line of the remainder of the Joseph M. Antram 105.35 acre tract (O.R. 545, Pg. 476), S 0°-33'-28"W, a distance of 346.28 feet to a 5/8 inch iron rod set, passing a 5/8 inch iron rod found at 25.00 feet.

THENCE, S 89°-04'-13"W, a distance of 650.95 feet to a point in a ditch, passing a 5/8 inch iron rod set at 640.95 feet.

THENCE, with the center-line of said ditch, N 0°-12'-04"E, a distance of 365.60 feet to a MAG nail set on the north line of Section 4 and the center-line of Township Road 52, passing a 5/8 inch iron rod set at 340.60 feet.

THENCE, with the north line of Section 4 and the center-line of Township Road 52, S 89°-13'-50"E, a distance of 653.00 feet to the point of beginning.

Containing 5.327 acres, of which 0.375 acre is within the highway right-of-way.

The basis for bearings is the north line of Section 4, being N 89°-13'-50"W, and all other bearings are from angles and distances measured in a field survey by Lee Surveying and Mapping Co., Inc. on June 6, 2008.

Description prepared by:

A handwritten signature in black ink that reads "William K. Bruce".

William K. Bruce  
Professional Surveyor 7437  
June 9, 2008



ORIGINAL STAMP IN GREEN



3313068

REC'D 6-10-08 SMJ BK

# Lee Surveying and Mapping Co., Inc.

Land Surveys • Topography • Subdivisions • Construction Layout

117 N. Madriver St.  
Bellefontaine OH 43311



Phone: (937) 593-7335  
Fax: (937) 593-7444

## ANTRAM 50.00 FEET WIDE INGRESS/EGRESS EASEMENT

Lying in Section 4, Town 7, Range 8, Stokes Township, Logan County, Ohio.

Being a 50.00 feet wide ingress/egress easement through a portion of the Donald Carson Antram 62.795 acre tract as deeded and described in Official Record 807, Page 739 of the Logan County Records of Deeds and being more particularly described as follows:

Commencing on a 3/4 inch iron rod found at the northeast corner of Section 4 on the center-line of Township Road 52.

THENCE, with the north line of Section 4 and the center-line of Township Road 52 (50 feet wide), N 89°-13'-50"W, a distance of 1349.97 feet to a point at the TRUE POINT OF BEGINNING, passing a MAG nail found at 746.97 feet.

THENCE, S 0°-12'-04"W, a distance of 364.11 feet to a point.

THENCE, S 89°-04'-13"W, a distance of 50.01 feet to a point in a ditch, passing a 5/8 inch iron rod set at 40.01 feet.

THENCE, with the center-line of said ditch, N 0°-12'-04"E, a distance of 365.60 feet to a MAG nail set on the north line of Section 4 and the center-line of Township Road 52, passing a 5/8 inch iron rod set at 340.60 feet.

THENCE, with the north line of Section 4 and the center-line of Township Road 52, S 89°-13'-50"E, a distance of 50.00 feet to the point of beginning.

The basis for bearings is the north line of Section 4, being N 89°-13'-50"W, and all other bearings are from angles and distances measured in a field survey by Lee Surveying and Mapping Co., Inc. on June 6, 2008.



ORIGINAL STAMP IN GREEN

Description prepared by:

A handwritten signature in black ink that reads 'William K. Bruce'.

William K. Bruce  
Professional Surveyor 7437  
June 9, 2008

3313068

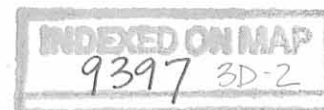

REC'D 6-10-08 SMY OK

# TOWNSHIP ROAD 52 (50')

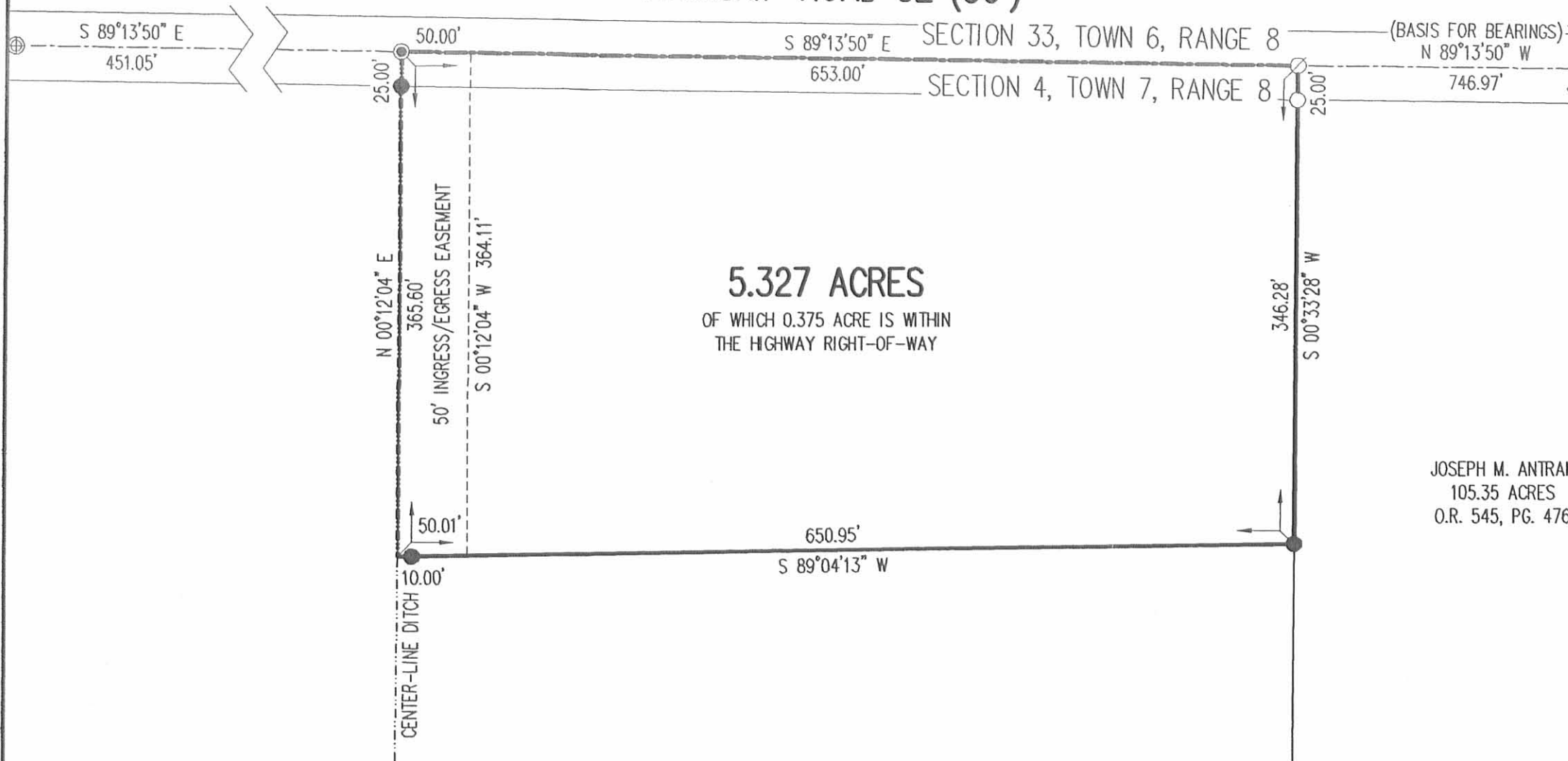

**5.327 ACRES**  
 OF WHICH 0.375 ACRE IS WITHIN  
 THE HIGHWAY RIGHT-OF-WAY

DONALD CARSON ANTRAM  
 62.795 ACRES  
 O.R. 807, PG. 739

JOSEPH M. ANTRAM  
 105.35 ACRES  
 O.R. 545, PG. 476

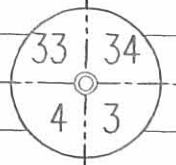
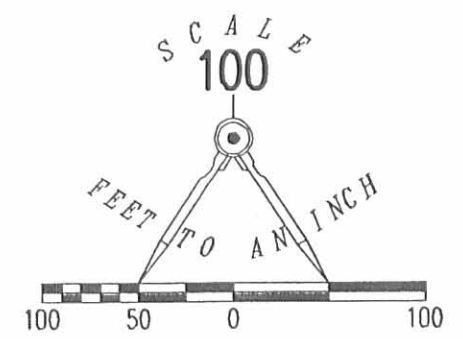

- LEGEND:
- ⊕ 1-1/4 INCH IRON ROD FOUND
  - ⊙ 3/4 INCH IRON ROD FOUND
  - ⊘ MAG NAIL FOUND
  - MAG NAIL SET
  - 5/8 INCH IRON ROD FOUND
  - 5/8 INCH IRON ROD SET

**SURVEY OF 5.327 ACRES OUT OF THE  
 DONALD CARSON ANTRAM  
 62.795 ACRE TRACT  
 OFFICIAL RECORD 807, PAGE 739  
 SECTION 4, TOWN 7, RANGE 8  
 STOKES TOWNSHIP  
 LOGAN COUNTY, OHIO**

SURVEYED BY:

*William K. Bruce*

WILLIAM K. BRUCE  
 PROFESSIONAL SURVEYOR 7437  
 JUNE 6, 2008



ORIGINAL STAMP IN GREEN

COPYRIGHT 2008 BY:  
**LEE SURVEYING & MAPPING CO., INC.**  
 117 North Madriver Street  
 BELLEFONTAINE, OHIO 43311  
 (937) 593-7335  
 surveys@lsmcinc.us  
 KSS D0608 3313068 L-3313-3

2 WORKING DAYS  
**BEFORE YOU DIG**  
 CALL TOLL FREE **800-362-2764**  
 OHIO UTILITIES PROTECTION SERVICE

INDEXED ON MAP  
 9397 3P



2-22-18

# Lee Surveying and Mapping Co.

Land Surveys • Topography • Subdivisions • Construction Layout



117 N. Madriver St.  
Bellefontaine OH 43311



Phone: (937) 593-7335  
Fax: (937) 593-7444  
surveys@lsminc.us

## ANTRAM 40.355 ACRES

Lying in Section 4, Town 7 South, Range 8 East, Between the Miami Rivers Survey, Stokes Township, Logan County, Ohio (all records referenced herein refer to the Logan County Records of Deeds).

Being out of the Donald Carson Antram 62.795 acre tract as deeded and described in Official Record 807, Page 739 and being more particularly described as follows:

Commencing at a 3/4 inch iron rod found at the northeast corner of Section 4 on the center-line of Township Road 52 (50 feet wide);

THENCE, with the north line of Section 4, within the right-of-way of said Township Road 52, N 89°-12'-49"W, a distance of 1399.92 feet to a point at the **TRUE POINT OF BEGINNING**;

THENCE, with new division lines through said 62.795 acre tract and along the approximate center of a ditch, the following four (4) courses:

- (1) S 00°-12'-45"W, a distance of 365.93 feet to a point, passing a MAG nail found at a distance of 0.41 feet and a 5/8 inch iron rod found at a distance of 25.43 feet, said point referenced by a 5/8 inch iron rod found bearing N 89°-04'-14"E, a distance of 9.93 feet;
- (2) S 00°-26'-08"W, a distance of 1021.42 feet to a 5/8 inch iron rod set;
- (3) S 89°-55'-01"E, a distance of 487.77 feet to a 5/8 inch iron rod set;  
and
- (4) S 06°-48'-16"E, a distance of 1110.84 feet to a point on a common line to the southerly line of said 62.795 acre tract and the northerly line of the W.R. Dickson III and Ryan Alan Dickson 18.912 acre tract as deeded and described in Official Record 24, Page 304, being referenced by a 5/8 inch iron rod found at the southeast corner of said 62.795 acre tract, bearing S 89°-20'-03" E, a distance of 16.50 feet;

THENCE, with the southerly line of said 62.795 acre tract and partly with northerly lines of said 18.912 acre tract and the Alan G. Boogher and Sally Sue Boogher 109 acre tract as deeded and described in Official Record 18, Page 650, N 89°-20'-03"W, a distance of 1097.10 feet to a 5/8 inch

INDEXED ON MAP  
9397

# Lee Surveying and Mapping Co.

Land Surveys • Topography • Subdivisions • Construction Layout

117 N. Madriver St.  
Bellefontaine OH 43311



Phone: (937) 593-7335  
Fax: (937) 593-7444  
surveys@lsminc.us

iron rod set, being a common southerly corner to said 62.795 acre tract and the Alan Boogher (1/2 Interest) and Sally McTish (1/2 Interest), 90.02 acre tract as dedeed and described in Official Record 293, Page 288;

THENCE, with the common line to said 62.795 acre and 90.02 acre tracts, N 00°-49'-28"E, a distance of 2484.73 feet to a 1-1/4 inch iron rod found (Station 34 + 60 – Logan County Engineer's File X-52) on the north line of said Section 4, passing a 5/8 inch iron rod set at 2459.19 feet;

THENCE, with the north line of said Section 4 and within the right-of-way of said Township Road 52, S 89°-12'-49"E, a distance of 451.06 feet to the **POINT OF BEGINNING**.

Containing 40.355 acres, more or less, of which 0.268 acre is within the highway right-of-way.

Iron rods set, where indicated, are 30 inches in length, 5/8 inch in diameter with an orange plastic I.D. cap stamped "L-8533."

Property is subject to any and all previous easements and rights-of-way of record.

The basis for bearings, described herein, is the north line of Section 4, being N 89°-12'-49"W, and all other bearings are from angles and distances measured in a field survey by Lee Surveying and Mapping Co. on February 5, 2018.

Description prepared by:

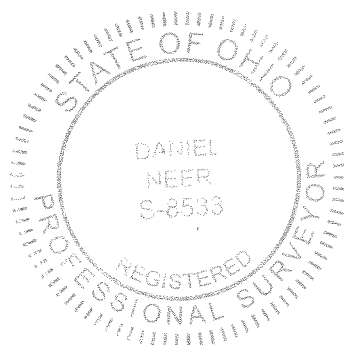

*D. Neer*  
Daniel A. Neer  
Professional Surveyor No. 8533  
February 16, 2018

33130118W





APPROVED

2-22-18

STATION 34+60

STATION 53+12

(LOGAN COUNTY ENGINEER'S  
FILE X-52)

(BASIS FOR BEARINGS)  
FILE X-52

(LOGAN COUNTY ENGINEER'S  
SECTION 33

P.O.C.  
SECTION 34

R/W  
R/W  
NO DRIVES  
LOCATED + 250'  
25.54'  
S 89°12'49" E 451.06'  
DRIVE CAN BE LOCATED  
IN THIS AREA

EXISTING DRIVE  
441.29'

TOWNSHIP ROAD 52 (50')

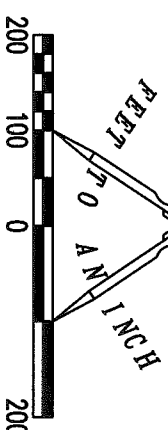
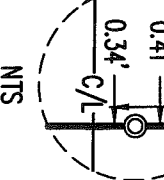
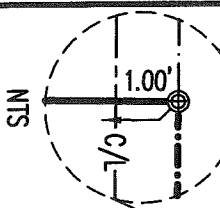

S C A L E  
200

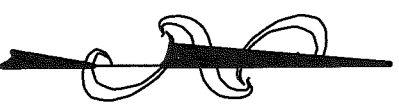

**SURVEY OF 40.355 ACRES OUT OF THE  
DONALD CARSON ANTRAM  
62.795 ACRE TRACT  
OFFICIAL RECORD 807, PAGE 739  
SECTION 4, TOWN 7 S, RANGE 8 E  
BETWEEN THE MIAMI RIVER SURVEY  
STOKES TOWNSHIP  
LOGAN COUNTY, OHIO**

DONALD CARSON ANTRAM  
62.795 ACRES  
O.R. 807, PG. 739

ALAN BOOGHER (1/2 INTEREST)  
AND SALLY McTISH (1/2 INTEREST)  
90.02 ACRES  
O.R. 293, PG. 288

N 00°49'28" E  
2484.73'

1021.42'  
S 00°26'08" W

**40.355 ACRES**  
OF WHICH 0.268 ACRE IS WITHIN  
THE HIGHWAY RIGHT-OF-WAY

APPROXIMATE CENTER  
OF DITCH

S 89°55'01" E  
487.77'

S 06°48'16" E  
1110.84'

1097.10'  
N 89°20'03" W

ALAN G. BOOGHER AND  
SALLY SUE BOOGHER  
109 ACRES  
O.R. 18, PG. 650

W.R. DICKSON III AND  
RYAN ALAN DICKSON  
18.912 ACRES  
O.R. 24, PG. 304

**DEED & SURVEY REFERENCES:**

- O.R. 18, PG. 650
- O.R. 24, PG. 304
- O.R. 293, PG. 288
- O.R. 807, PG. 739

PLAT OF SURVEY BY JEFFREY I. LEE, P.S. 6359, ENTITLED "SURVEY OF 42.555 ACRES OUT OF THE JOSEPH M. ANTRAM 105.35 ACRE TRACT", DATED FEBRUARY 15, 2002, REVISED MARCH 3, 2002  
PLAT OF SURVEY BY WILLIAM K. BRUCE, P.S. 7437 ENTITLED "SURVEY OF 5.327 ACRES OUT OF THE DONALD CARSON ANTRAM 62.795 ACRE TRACT", DATED JUNE 6, 2008.

**LEGEND:**

- ⊙ 3/4 INCH IRON ROD FOUND
- ⊗ 1-1/4 INCH IRON ROD FOUND
- ⊙ MAG NAIL FOUND
- 5/8 INCH IRON ROD FOUND
- 5/8 INCH IRON ROD SET WITH PLASTIC I.D. CAP STAMPED "L-85533"

NTS = NOT TO SCALE  
C/L = CENTER-LINE  
R/W = RIGHT-OF-WAY  
S = SOUTH  
E = EAST

**ACCESS MANAGEMENT NOTE:**

TOWNSHIP ROAD 52 IS CLASSIFIED AS A LOCAL ROAD.  
MINIMUM DRIVE SPACING IS 250'  
MINIMUM STOPPING SIGHT DISTANCE IS >995 (55 MPH)

THIS SURVEY WAS PREPARED IN THE ABSENCE OF A COMPLETE AND ACCURATE TITLE SEARCH AND DOES NOT GUARANTEE TITLE.

2 WORKING DAYS

**BEFORE YOU DIG**

CALL TOLL FREE **800-362-2764**

OHIO UTILITIES PROTECTION SERVICE

**BASIS FOR BEARINGS:**

THE BASIS FOR BEARINGS SHOWN HEREON IS THE NORTH LINE OF SECTION 4, BEING, N 89°12'49" W.

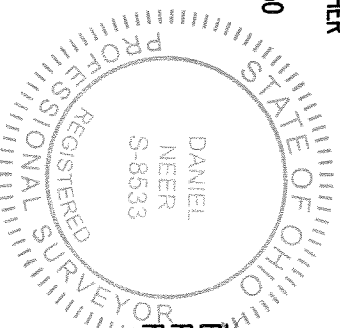

DANIEL A. NEER  
PROFESSIONAL SURVEYOR NO. 85533  
FEBRUARY 5, 2018

COPYRIGHT 2018 BY:  
**LEE SURVEYING & MAPPING CO.**

117 North Modriver Street  
BELLEFONTAINE, OHIO 43311

(937) 593-7335  
www.lsminc.us  
surveys@lsminc.us

KSS D0118 33130118W L-3313-3

INDEXED ON MAP  
4397

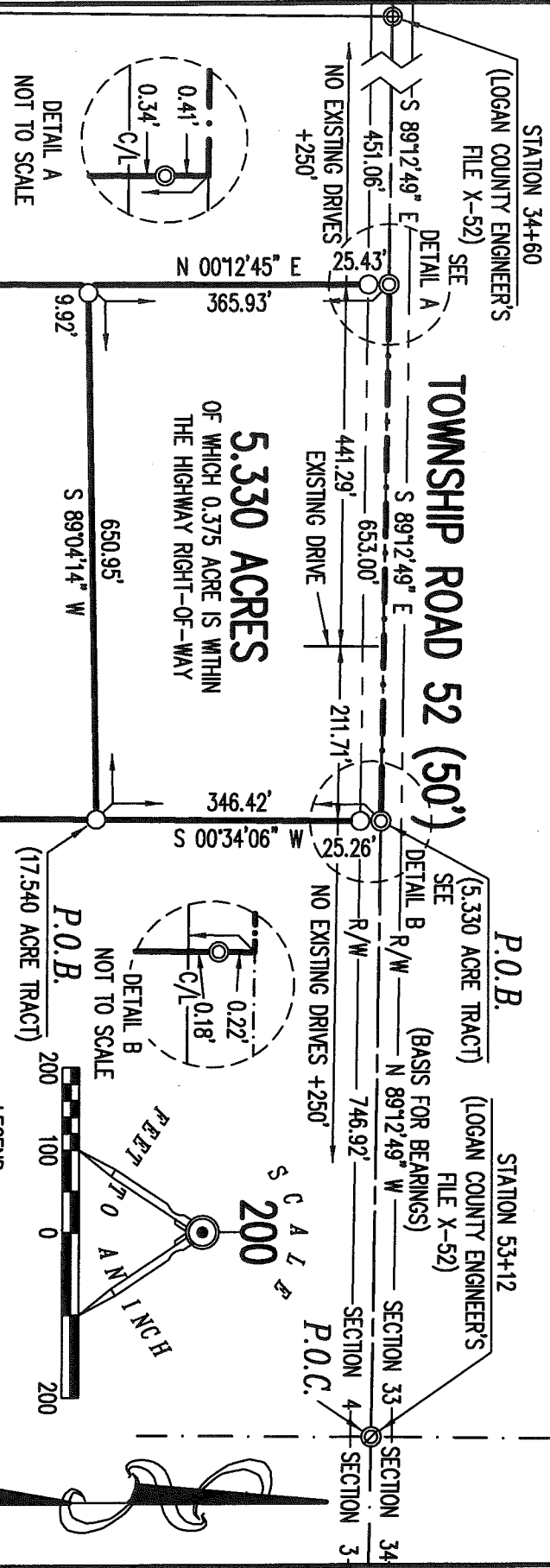

LEGEND:

- ⊙ 3/4 INCH IRON ROD FOUND
- ⊕ 1-1/4 INCH IRON ROD FOUND
- ⊙ MAG NAIL FOUND
- 5/8 INCH IRON ROD FOUND
- 5/8 INCH IRON ROD SET WITH PLASTIC I.D. CAP STAMPED "L-8533"
- C/L = CENTER-LINE
- R/W = RIGHT-OF-WAY
- S = SOUTH
- E = EAST

DONALD CARSON ANTRAM  
62.795 ACRES  
O.R. 807, PG. 739

JOSEPH M. ANTRAM  
REMAINDER OF 105.35 ACRES  
O.R. 545, PG. 476

**DEED & SURVEY REFERENCES:**

- O.R. 18, PG. 650
- O.R. 24, PG. 304
- O.R. 545, PG. 476
- O.R. 293, PG. 288
- O.R. 807, PG. 739

PLAT OF SURVEY BY JEFFREY I. LEE, P.S. 6359, ENTITLED "SURVEY OF 42,555 ACRES OUT OF THE JOSEPH M. ANTRAM 105.35 ACRE TRACT", DATED FEBRUARY 15, 2002, REVISED MARCH 3, 2002

PLAT OF SURVEY BY WILLIAM K. BRUCE, P.S. 7437 ENTITLED "SURVEY OF 5,327 ACRES OUT OF THE DONALD CARSON ANTRAM 62.795 ACRE TRACT", DATED JUNE 6, 2008.

**NOTE:**

THE 17,540 ACRE PARCEL IS TO BE ATTACHED TO AN ADJOINING TRACT OF LAND AND IS NOT TO BE USED AS A SEPARATE AND INDEPENDENT PARCEL.

**ACCESS MANAGEMENT NOTE:**

TOWNSHIP ROAD 52 IS CLASSIFIED AS A LOCAL ROAD.  
MINIMUM DRIVE SPACING IS 250'  
MINIMUM STOPPING SIGHT DISTANCE IS >95 (55 MPH)

THIS SURVEY WAS PREPARED IN THE ABSENCE OF A COMPLETE AND ACCURATE TITLE SEARCH AND DOES NOT GUARANTEE TITLE.

2 WORKING DAYS



**BEFORE YOU DIG**



CALL TOLL FREE **800-362-2764**

OHIO UTILITIES PROTECTION SERVICE

**SURVEY OF TWO TRACTS OUT OF THE DONALD CARSON ANTRAM 62.795 ACRE TRACT OFFICIAL RECORD 807, PAGE 739 SECTION 4, TOWN 7 S, RANGE 8 E BETWEEN THE MIAMI RIVER SURVEY STOKES TOWNSHIP LOGAN COUNTY, OHIO**

W.R. DICKSON III AND  
RYAN ALAN DICKSON  
18,912 ACRES  
O.R. 24, PG. 304

SURVEYED BY:

DANIEL A. NEER  
PROFESSIONAL SURVEYOR NO. 8533  
FEBRUARY 5, 2018

COPYRIGHT 2018 BY:  
**LEE SURVEYING & MAPPING CO.**

117 North Madriver Street  
BELLEFONTAINE, OHIO 43311  
(937) 593-7335

www.lsminc.us  
surveys@lsminc.us

KSS D0118 33130118E L-3313-3

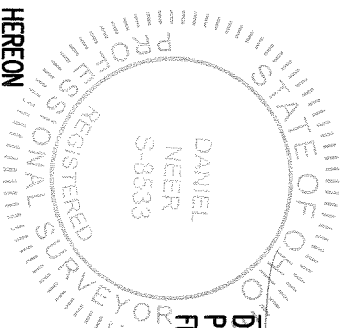

**BASIS FOR BEARINGS:**  
THE BASIS FOR BEARINGS SHOWN HEREON IS THE NORTH LINE OF SECTION 33, BEING N 89°12'49" W.

ALAN G. BOOGHER AND  
SALLY SUE BOOGHER  
109 ACRES  
O.R. 18, PG. 650

3-23-18



APPROVED

# Lee Surveying and Mapping Co.

Land Surveys • Topography • Subdivisions • Construction Layout

117 N. Madriver St.  
Bellefontaine OH 43311



Phone: (937) 593-7335  
Fax: (937) 593-7444  
surveys@lsminc.us

## ANTRAM 5.330 ACRES

Lying in Section 4, Town 7 South, Range 8 East, Between the Miami Rivers Survey, Stokes Township, Logan County, Ohio (all records referenced herein refer to the Logan County Records of Deeds).

Being out of the Donald Carson Antram 62.795 acre tract as deeded and described in Official Record 807, Page 739 and being more particularly described as follows:

**COMMENCING** at a 3/4 inch iron rod found at Station 53 + 12 (Logan County Engineer's File X-52) at the northeast corner of Section 4 on the center-line of Township Road 52 (50 feet wide);

**THENCE**, with the north line of Section 4, within the right-of-way of said Township Road 52, N 89°-12'-49" W, a distance of 746.92 feet to a point at the **TRUE POINT OF BEGINNING**, being a common northerly corner to said 62.795 acre tract and the remainder of the Joseph M. Antram 105.35 acre tract as deeded and described in Official Record 545, Page 476;

**THENCE**, with a common line to said 62.795 acre and 105.35 acre tracts, S 00°-34'-06" W, a distance of 346.42 feet to a 5/8 inch iron rod found, passing a MAG nail found at a distance of 0.22 feet and a 5/8 inch iron rod found at a distance of 25.26 feet;

**THENCE**, with new division lines through said 62.795 acre tract, the following two (2) courses:

- (1) S 89°-04'-14" W, a distance of 650.95 feet to a point in the approximate center of a ditch, passing a 5/8 inch iron rod found at a distance of 641.03 feet; and
- (2) N 00°-12'-45" E, a distance of 365.93 feet to a point on the north line of said Section 4, passing a 5/8 inch iron rod found at a distance of 340.50 feet and a MAG nail found at a distance of 365.52 feet, said point bears S 89°-12'-49" E, a distance of 451.06 feet from a 1-1/4 inch iron rod found at Station 34 + 60 (Logan County Engineer's File X-52);

INDEXED ON MAP  
9397



# Lee Surveying and Mapping Co.

Land Surveys • Topography • Subdivisions • Construction Layout

117 N. Madriver St.  
Bellefontaine OH 43311



Phone: (937) 593-7335  
Fax: (937) 593-7444  
surveys@lsminc.us

THENCE, with the north line of said Section 4 and within the right-of-way of said Township Road 52, S 89°-12'-49" E, a distance of 653.00 feet to the **POINT OF BEGINNING**.

Containing 5.330 acres, more or less, of which 0.375 acre is within the highway right-of-way.

Iron rods set, where indicated, are 30 inches in length, 5/8 inch in diameter with an orange plastic I.D. cap stamped "L-8533."

Property is subject to any and all previous easements and rights-of-way of record.

The basis for bearings, described herein, is the north line of Section 4, being N 89°-12'-49"W, and all other bearings are from angles and distances measured in a field survey by Lee Surveying and Mapping Co. on February 5, 2018.

INDEXED ON MAP

9397

Description prepared by:

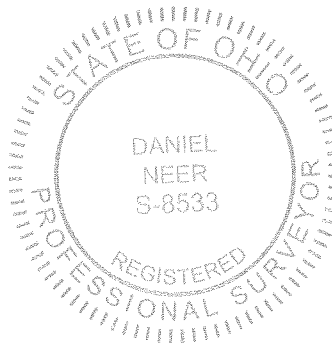

*D. A. Neer*  
Daniel A. Neer  
Professional Surveyor No. 8533  
March 13, 2018

33130118E



3-23-18

APPROVED

# Lee Surveying and Mapping Co.

Land Surveys • Topography • Subdivisions • Construction Layout

117 N. Madriver St.  
Bellefontaine OH 43311



Phone: (937) 593-7335  
Fax: (937) 593-7444  
surveys@lsminc.us

## ANTRAM 17.540 ACRES

Lying in Section 4, Town 7 South, Range 8 East, Between the Miami Rivers Survey, Stokes Township, Logan County, Ohio (all records referenced herein refer to the Logan County Records of Deeds).

Being out of the Donald Carson Antram 62.795 acre tract as deeded and described in Official Record 807, Page 739 and being more particularly described as follows:

**COMMENCING** at a 3/4 inch iron rod found at Station 53 + 12 (Logan County Engineer's File X-52) at the northeast corner of Section 4 on the center-line of Township Road 52 (50 feet wide);

THENCE, with the north line of Section 4, within the right-of-way of said Township Road 52, N 89°-12'-49" W, a distance of 746.92 feet to a point, being a common northerly corner to said 62.795 acre tract and the Joseph M. Antram 105.35 acre tract as deeded and described in Official Record 545, Page 476;

THENCE, with a common line to said 62.795 acre and 105.35 acre tracts, S 00°-34'-06" W, a distance of 346.42 feet to a 5/8 inch iron rod found at the **TRUE POINT OF BEGINNING**, passing a MAG nail found at a distance of 0.22 feet and a 5/8 inch iron rod found at a distance of 25.26 feet;

THENCE, continuing with a common line to said 62.795 acre and 105.35 acre tracts, S 00°-36'-37" W, a distance of 2135.98 feet to a 5/8 inch iron rod found at the southerly corner common to said 62.795 acre and the remainder of the 105.35 acre tract, and being on a common line to the southerly line of said 62.795 and the northerly line of the W.R. Dickson III and Ryan Alan Dickson 18.912 acre tract as deeded and described in Official Record 24, Page 304;

THENCE, with said common line, N 89°-20'-03" W, a distance of 16.50 feet to a point in the approximate center of a ditch;

THENCE, with new division lines through said 62.795 acre tract and along the approximate center of said ditch, the following threes (3) courses:

(1) N 06°-48'-16" W, a distance of 1110.84 feet to a 5/8 inch iron rod set;

INDEXED ON MAP  
9397

# Lee Surveying and Mapping Co.

Land Surveys • Topography • Subdivisions • Construction Layout

117 N. Madriver St.  
Bellefontaine OH 43311



Phone: (937) 593-7335  
Fax: (937) 593-7444  
surveys@lsminc.us

(2) N 89°-55'-01" W, a distance of 487.77 feet to a 5/8 inch iron rod set;  
and

(3) N 00°-26'-08" E, a distance of 1021.42 feet to a point;

THENCE, continuing with a new division line through said 62.795 acre tract, N 89°-04'-14"E, a distance of 650.95 feet to the **POINT OF BEGINNING**, passing a 5/8 inch iron rod found at a distance of 9.92 feet

Containing 17.540 acres, more or less.

This parcel is to be attached to an adjoining tract of land and is not to be used as a separate and independent parcel.

Iron rods set, where indicated, are 30 inches in length, 5/8 inch in diameter with an orange plastic I.D. cap stamped "L-8533."

Property is subject to any and all previous easements and rights-of-way of record.

The basis for bearings, described herein, is the north line of Section 4, being N 89°-12'-49"W, and all other bearings are from angles and distances measured in a field survey by Lee Surveying and Mapping Co. on February 5, 2018.

Description prepared by:

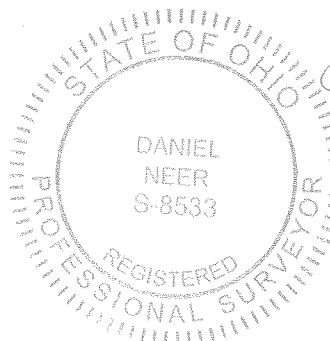

  
Daniel A. Neer  
Professional Surveyor No. 8533  
March 13, 2018

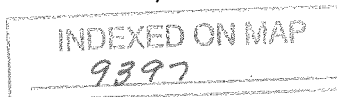

33130118E