

Ireland (Feb) 5th 1827 Survey No 65 (8198)

Surveyed the east half of sec 7 in Town 3 Range 11 E. & N. for Alex. Duke Beginning at the S.W. corner of said half sec. a white oak 15 inches in diam. & 9 1/2 links dist a white 17 in. in diam. & 7 1/2 links dist. Thence with the South line of said half sec. allowing 1/2 East by variation) 157 1/2 poles to a stake in a prairie a white oak 30 inches in diam. & 14 E 11.8 poles dist S.E. corner to said half sec - Thence north 320 poles to the S.E. corner of said sec. a white oak 24 in. in diam. & 65 E 3 1/2 links dist - Thence west with the north

line of the sec. 156 poles to the original quarter sec. corner a black oak 110 E 31 links dist. a white oak east 33 links Thence N. passing the center corner a stone & a white oak 28 links a white oak 20 E 26 1/2 links Thence S 155 Thence South passing the center corner at 160 poles) 320 to the beginning - Division line - beginning at the center corner

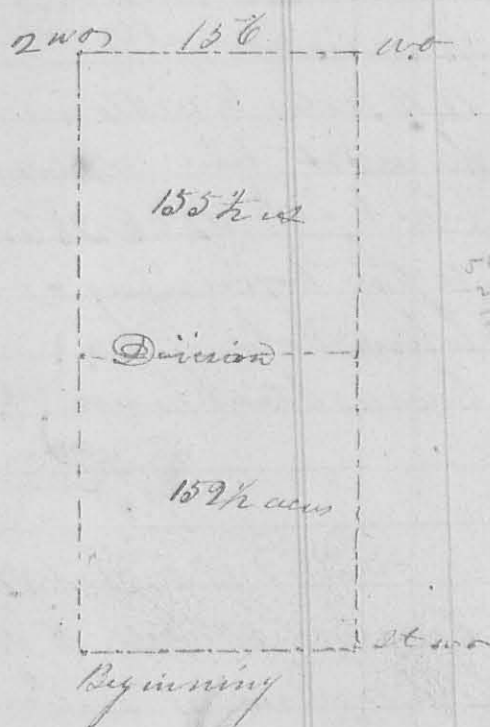

a stone - a white oak 16 links a white oak 28 E 31 links - Thence east 155 1/2 poles to a stake in the east line - containing in the whole 306 acres

A Craig Schoonover

Ja. W. Harrison

Ireland (Feb) 9th 1827 Survey No 66 (8199)

Surveyed half of the north west quarter of section 12 in Town 4 Range 13 E. & N. for James Stackhouse Beginning at the north west corner of said sec. the original bearing has yet standing, a white oak 18 inches in diam. & 48 W 56 links dist, a white oak 22 inches in diam. & 69 E 51 links dist. Thence south with the original

2 line 70 poles to a stake, thence east 23 poles to a stake  
 thence south 10 poles to a stake thence east 59 poles to a  
 white elm 10 inches in diam. S 21° E 13 links, a bur oak  
 or S 5° W 27 links dist. thence south 2 1/2 poles to a stake  
 thence east 80 poles to a stake in a prairie thence  
 or S 1/2° E 82 poles to the s.w. corner of said quarter  
 sec. a white oak 15 inches in diam. or S 7° W 112 links  
 dist a white oak 17 inches in diam. or S 7° E 104 links thence  
 the north line of

the sec. (allowing for  
 1/2° easterly variation)  
 164 poles to the be-  
 ginning con-  
 taining 81 acres  
 James Craig }  
 Geo. M. Beck } C. C.

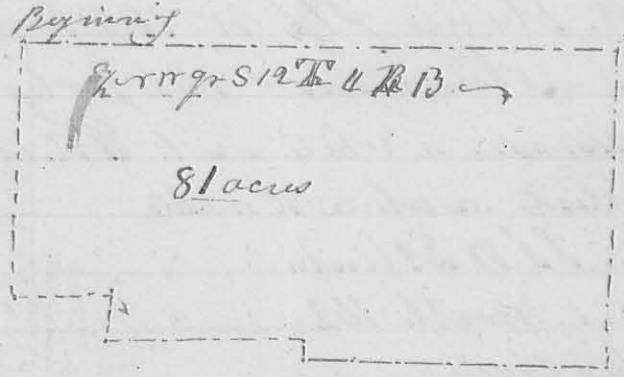

50 poles  
to the inch

Ja. Williamson  
C. S.

D<sup>no</sup> (Feb) 9<sup>th</sup> 1827 ✓ Survey or 67

(8199)

Surveyed the south half of the north west quarter of  
 section 12 Town. 4 Range 13 E. R. 13, for Andrew Thomp-  
 son beginning at the west line of said sec. at  
 a stake 70 poles from the s.w. corner of said ~~quarter~~  
 thence east 23 poles to a stake thence south 10 poles  
 to a stake - thence east 59 poles to a white elm 10 inches  
 in diam S 21° E 13 links dist. a bur oak or S 5° W 27 links  
 thence south 2 1/2 poles to a stake - thence east 82 poles to  
 a stake in a prairie  
 thence S 1/2° W 78 poles  
 to a stake in a prairie  
 placed for the center  
 corner of the sec. thence  
 west 160 poles to 2 white  
 oaks growing from one  
 root in the west line of  
 the sec. thence north 90 poles  
 to the beginning containing 81 1/2 acres

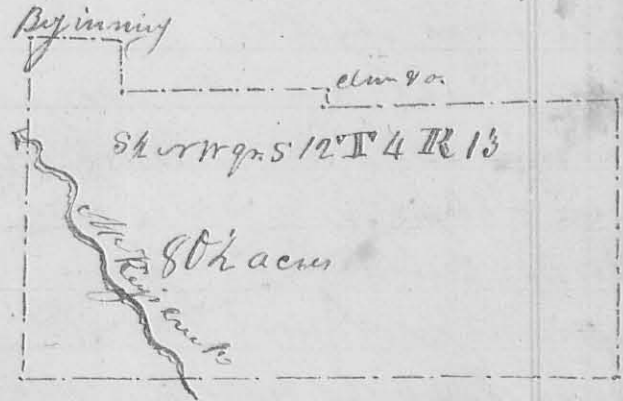

50 poles  
to the inch

Ja. Williamson  
L. C. Surveys

James Craig }  
 Geo. M. Beck } C. C.

2<sup>nd</sup> mo (Feb.) 10<sup>th</sup> 1827 ✓ Surveyor No 68

(899)

Surveyed the N.E. quarter of section 12 in Town 4 Range 13 E. M. R. for William H. Davis - beginning at the N.E. corner of said sec. a stake in a prairie a white oak 30 inches in diam. bears S 14° E 11.9 poles dist. thence West 152 poles to the quarter sec. corner, a white oak 15 inches in diam. S 79° E 104 links, a white oak 17 inches in diam. N 79° E 104 links dist. thence S 1/2 W 162 poles to a stake in a prairie - thence east 156 poles to the South corner of said quarter a white oak 8 inches in diam. south 14 links dist. a white 10 inches in diam. S 5° W 38 links dist. thence north 162 poles to the beginning containing 155 3/4 acres

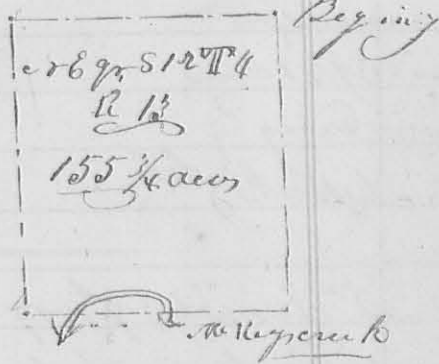

James Craig }  
 James MacKinnon }  
 Sec. W. H. Morrison & Surveyor

2<sup>nd</sup> mo (Feb.) 10<sup>th</sup> 1827 ✓ Surveyor No 69

(8700)

Surveyed the north half of the north east quarter of section 18 Town 4 Range 13 E. M. R. for George Meekick: beginning at the north east corner of said sec. the original bearing tree, a white oak 18 inches in diam. S 18° W 56 links dist a white oak 22 inches in diam. N 69° E 51 links distant thence west with the north line of the sec. 161 poles to the original quarter sec. corner, a white oak 12 inches diam. S 50° W 20 links - a white oak S 65° E 12 links thence S 80 poles, a white oak 20 inches in diam. south 20 links - 2 black oak's growing from one root west 12 links thence east 161 poles to a stake in the east line of the sec. - thence north 80 poles to the beginning containing 80 1/2 acres

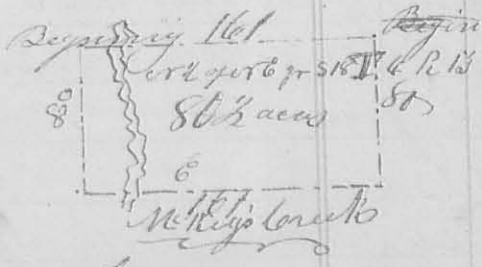

James Craig }  
 Andrew Thompson }  
 Sec. W. H. Morrison & Surveyor