

162) 11<sup>th</sup> Mo. (Nov) 5<sup>th</sup> 1832

Surveyor No 199 162

G. Broughton }  
 Amos & Abram }  
 James }

Surveyed and divided the S.E. q<sup>r</sup> of Sec 2 T3R14M.R. for Gurdon Broughton Amos James as follows Beginning

(8286)

at the corner of sec 2 & 3 in said T3R. a white oak N62°E 102 a black oak N73°W 25 L. original bearing trees thence between said sec. 2 & 3 177 161 poles, a white N3°E 25 L a oak N53°E 29 L. thence S 17 161 poles, a white oak N15°E 11 L a black oak N86°W 18 L. thence S 89 1/2° E 161 poles to a white elm N91°W 45 L. in the east line of the sec — thence with said line N1°E 161 poles to the beginning containing 162 acres

The 1<sup>st</sup> division line begins in the South line of the q<sup>r</sup> 53 2/3 poles west of the S.E. corner of the q<sup>r</sup> a hickory N10°W 24 L. thence N1°E 161 poles to a stake in a prairie in the north of the sec —

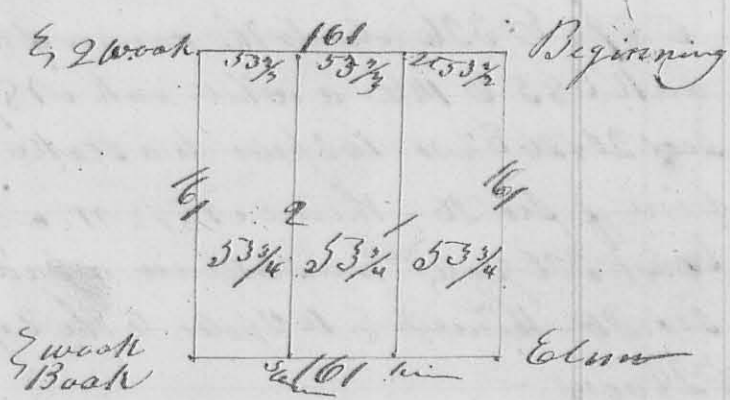

The 2<sup>nd</sup> division line at a stake in the prairie in the north line of the sec. 53 2/3 poles west of the last named corner thence S 17° 161 poles to a stone in the South line of the q<sup>r</sup>.

John Grindle } 66  
 Elephas Gray } 66  
 James Mannon } 65  
 C. S. L. } 65

(8287) 11<sup>th</sup> Mo. (Nov) 6<sup>th</sup> 1832

Surveyor No 200

John Grindle }  
 No 200 }

Surveyed the S.E. q<sup>r</sup> of Sec 1 Town 3 R. 14. M. R. for John Grindle: Beginning at the corner of

sec 1 & 2 in said T3R. a white oak N21°W 30 L a hickory N14°W 65 L thence S 17° 162 poles to a stone a white oak S53°E 8 L. thence



163  
 r 87 1/2 N. cuping a prairie 162 poles a white oak  
 S 80 1/2 W 302 a n. c. 128 E 33 L. thence r 1 E 162 poles a white  
 oak S 83 E 16 L original golden corner in the north line  
 of the sec. - thence with said line S 89 E 162 poles to the be-  
 ginning containing 164 acres  
 Gorden Broughton }  
 Abraham James } De Mearns, C.S. & C.

11<sup>th</sup> Mo. r 28<sup>th</sup> 1832 ✓ Survey #201  
 Wannak }  
 Benson }  
 201 County for Wannak Benson - Beginning in  
 the north line of said sec. 84 poles west of the r & e corner  
 thereof a bar oak S 106 1/4 L - a maple r 56 W 28 L. thence  
 S 3 1/2 E crossing the sandwich road at 46 poles, 164 poles to  
 3 rods long - thence S 87 1/2 W cuping said road, 167 poles  
 a bush r 58 W 7 L  
 a bush S 85 1/2 E 17 L  
 thence r 3 1/2 W 16 3/4 poles  
 a bush r 57 1/2 W 20 L  
 a bush S 69 1/2 E 23 L  
 in the north line of  
 the sec - thence with  
 said line r 87 1/2 E  
 167 poles to the beginning  
 containing 170 acres  
 Philip Hackethorn }  
 Samuel Simson } De Mearns, C.S. & C.

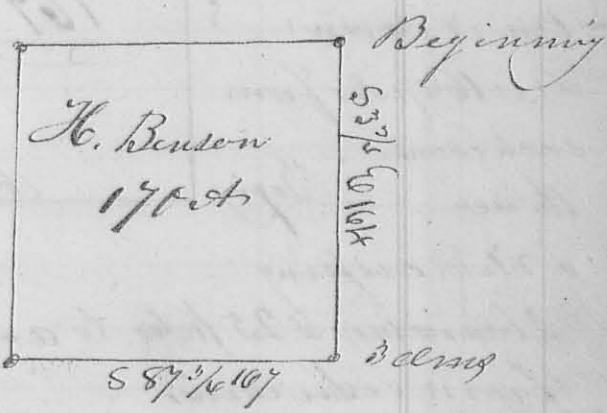

11 Mo. r 30<sup>th</sup> 1832 ✓ Survey #202  
 Geo Kellerman }  
 Christy Houtz }  
 + others }  
 Surveyed divided sec. 12 & 14  
 for Christy Houtz, George  
 Kellerman, & others, beginning at the corner  
 of sec 11. 12. 17 & 18 a white oak original corner  
 down; thence between sec 12 & 14 r 1/4 E crossing a  
 branch at 252 poles, 326 poles to the r. n. corner of sec  
 12, the original corner down, set a stake - thence

(8288)