

INDEXED ON MAP
17-1 1050

1

Harris Hopkins

37-177

Apr 11/1861

Wm. Brownson

N 1/2 of SE Qr of SE Qr Sec. 23-7-8

20.47 acs -

A. M. Cherry et al

Wm. Brownson

29-297

Feb. 20, 1853

Part SE Qr, a part NE Qr, Sec. 23-7-8

Begin - stake 50 lbs. N. of Cent Sec. - R. O. 12", E, 157

- S 1/4 W, 30.92 ch to W. Oak 24", S 15 1/2 E, 82 lbs

(N.W. H. Hopkins. — East 20.15 ch to

W. O. 24", N 83 3/4 W, 19 lbs. and W. O. 20", N 36 1/4 W, 36 1/2

- North, 30.92 ch to stake 50 lbs N. of line bet. N. E

and SE Qrs. - with - Burn. Oak 18", N 53 3/4 E, 22 lbs, and

Burn Oak 18", S 6 1/2 E, 1 1/2 1/2 lbs. — W. 20 ch to

- begin - 62.07 a.

Am. Cherry to Wm. Branson (continued)

(2)

also — a piece lying between the E 1/2 of
S.E. Q. of Sec, and the County Road, (or where
the County road runs.) = 1/2 a

INDEXED ON MAP

1050 1D-2

Wm
Cherry to Brunson 29-555

PT NE Qr Sec. 23-7-8

Begin post 50 lks. nr. of. Cenr. of Sec.

(by true meridian) North, 10.16 ch to
stone in road from Lewistown to Plum Bridge

- S 86 E, 20 ch. to post, with - W. O. 20",
N. 53 E, 49 lks, and W. O. 20", S 12 3/4 E, 109 lks.

- with road, South, 8.63 ch to post

- West - 20 ch to begin = 18.77 a

INDEXED ON MAP
105010-3

Seth McBride to } 68-60 Dec. 19, 1884
w^m H. Blum

(4)

Pr. N¹/₂, SW Qr. Sec. 24-7-8

Begin, NW \leftarrow said Qr Sec. — South 20.12 to
SW \leftarrow said N¹/₂. — East so far that a line
running N, parallel with W. line to County road, would
contain 20 acres. — with road, west, to begin

also

NE Qr, of SE Qr. Sec 23-7-8 = 40a

INDEXED ON MAP
10501D-4

Jonathan Plum to
Wm. Plum

54-374

June 9, 1876

5

Undivided $\frac{1}{2}$ of $5\frac{1}{2}$ of SW Qr. Sec. 20-7-8

Begin SW \angle of Sec. — North 20.16 to NW \angle

Said S $\frac{1}{2}$. — E 40.47 to NE \angle said South $\frac{1}{2}$

— South 20.04 to SE \angle said Qr Sec.

— West 40.41 to begin = 81.28 a

= Also =

Undivided $\frac{1}{2}$ of $5\frac{1}{2}$ of SE Qr. of SE Qr-23-7-8

Begin SE \angle of Sec. 23.

— West 20.20

— North 10.04 $\frac{1}{2}$

— East 20.35

— South 10.08 to begin = ~~20.44~~ 20.44 a

INDEXED ON MAP

1050 105

Jonathan Plurto } 54 - 375
W + Plurto

Begin NW 1/4 Sec 25-7-8.

- South with Sec. line 25.41 to NW 1/4 Trout's 90 acres — N 83 E, 42.28 to stone
- in road. — with road 3 3/4 W, 20.89 to Ar. Sec 1
- W with sec. line 40.51 to begin = 95.23 a

Jno. Trout to Abraham Trout. 4-50
frac. Sec. 26-7-8 = 105.43 a

INDEXED ON MAP
1050 1D-6

13

Plumti.
Wm Brunson

72-289

(7)

W¹/₂ of NW Qr Sec. 24-7-8
Except 30a of N. end thereof.

⊕

Also (continued from p. 8)

pt. SW. Qr Sec. 23-7-8-

Begin S.E. \angle said Qr, same place of beginning
as 17a tract. — with E. line of said Qr.

N ¹/₄ W, 22.11 ch to stone at NW \angle of
141.95 a. of which Jno Trout died seized

(balance of description unnecessary to copy)

INDEXED ON MAP
1050 10-7

Sheriff Logan Co to
Emma R. Wolfe } 8-194

July 23/97

Pt. SE Qr Sec. 23-7-8.

Begin - stake at SW. of said SE Qr in N. line Nancy
Stewart Sec. — N $\frac{1}{4}$ W, with W. line said Qr.

8.16 ch. to stake. — with bearing of Sec. East N 20.00

ch. to E. line of N $\frac{1}{2}$ of SE Qr. - wit! - W.O. 18", S 25 W, 26 $\frac{1}{2}$ lks,

W.O. 24", N 84 $\frac{1}{2}$ W, 19 lks. — with said E. line, 5.

9.55 ch. to S. line of Sec. - wit! - W.O. 20", N 77 $\frac{1}{2}$ W, 40 lks,

— with said S. line, W. 7 15 $\frac{1}{2}$ ch. to E. line

Stewart Sec. — with last named E. line, N 15 $\frac{1}{2}$ W

2.33 ch. to N.E. of said Sec. — with said

N. line, S 85° 5', 12.44 ch. to begin =

17. acres

also (see p. 7).

INDEXED ON MAP
1050 108

Jno. J. Brunson Assg^t

83-51 - Apr 10/72

Elizabeth Kauffman

pt. NE Qr 23-7-

Same Description as Hopkins to Brunson
(pages 1 and 3)

Also - N 1/2, SE 1/4, of S.E. Qr, Sec. 23-7-8 = 20.47

Also - N 1/2 of S.E. Qr of S.E. Qr " " = 20.47

(Either error or dup.)

Contains a. more or less

70
6 1/2
4.70

INDEXED ON MAP

1P Kauffman survey.
Washington Twp
Sec. 23-4 T7 R8

Sec. 23-7-8

Sec. 24-7-8

863
50
9.13



Rd 54 change from page 16

See F.B. 571 page 43 for original

Aug 4, 53

shirk

61

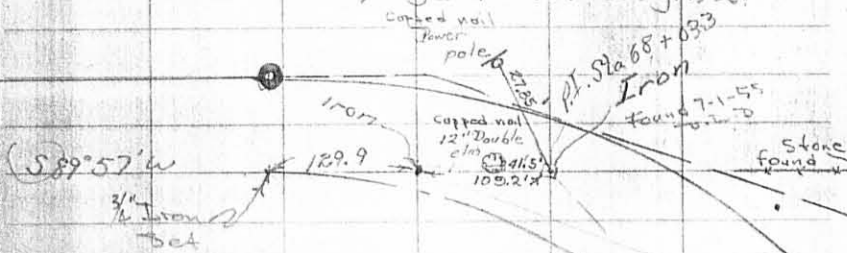

$\Delta = 45^\circ 15' \text{ RE}$
 $D = 10'$
 $T = 239.14$
 E
 $R = 573.69$
 $L = 452.59$

PC 65+64.2	0° 0'
66	1° 47'
66+50	4° 17'
67	6° 47'
67+50	9° 17'
68	11° 47'
68+50	14° 17'
69	16° 47'
69+50	19° 17'
70	21° 47'
PT 70+16.8	22° 39'

○ = RIW Monuments
 Set - Oct. 1953

Profile on pg. 66

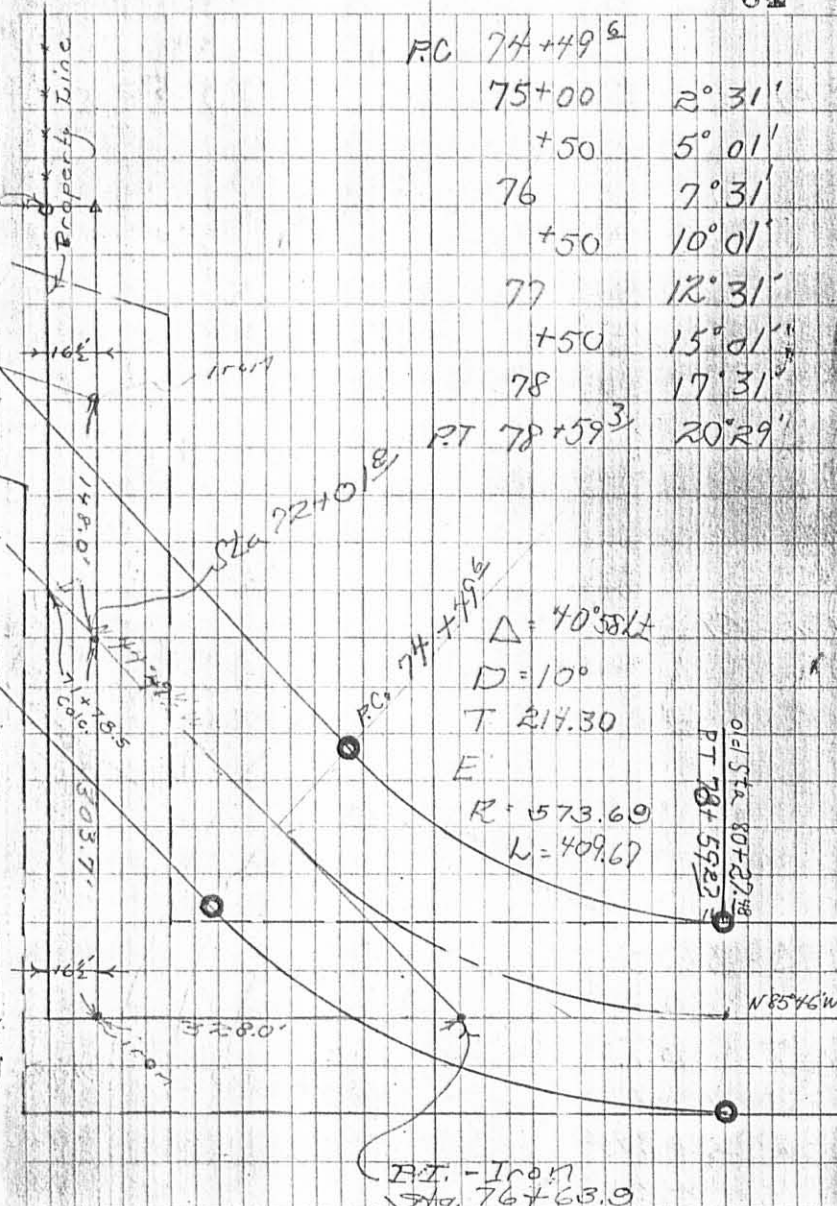

P.C. 74+49.6	
75+00	2° 31'
+50	5° 01'
76	7° 31'
+50	10° 01'
77	12° 31'
+50	15° 01'
78	17° 31'
P.T. 78+59.3	20° 29'

$\Delta = 40^\circ 58' \text{ L}$
 $D = 10'$
 $T = 217.30$
 E
 $R = 573.69$
 $L = 409.67$

P.I. - Iron
 Sta. 76+63.9
 40°-58' Lt.

Old Sta. 80+27.59
 PT 78+59.22

F.B. 692, Pg 61 2P

REC'D 4-21-97 Juy OK gch



Lee Surveying and Mapping Co., Inc.



Farm Surveys • Lot Surveys • Topography • Subdivisions • Construction Layout

117 NORTH MADRIVER STREET
BELLEFONTAINE, OHIO 43311

(937) 593-7335
FAX (937) 593-7444

VAN GORDER FARMS TRACT B 3.333 ACRES

Lying in Section 24, Town 7, Range 8, Washington Township, Logan County, Ohio.

Being out of the Van Gorder Farms original 81.28 acre tract as deeded and described in Volume 233, Page 297 and Official Record 273, Page 835 of the Logan County Records of Deeds and being more particularly described as follows:

Beginning at a 1 inch metal pipe found on the center-line of Township Road 213 at the southeast corner of the southwest quarter of Section 24.

THENCE, with the south line of Section 24 and the north line of the Timothy E. Knief 95.23 acre tract (Vol. 404, Pg. 956), S 88°-34'-29" W, a distance of 493.43 feet to a 5/8 inch iron rod set, passing a 5/8 inch iron rod set at 30.00 feet.

THENCE, N 1°-03'-17" W, a distance of 295.10 feet to a 5/8 inch iron rod set.

THENCE, N 88°-45'-52" E, a distance of 493.42 feet to a MAG nail set, passing a 5/8 inch iron rod set at 463.42 feet.

THENCE, with the east line of the southwest quarter of Section 24 and the center-line of Township Road 213 (60 feet wide), S 1°-03'-17" E, a distance of 293.46 feet to the point of beginning.

Containing 3.333 acres of which 0.202 acre is within the highway right-of-way.

The basis for bearings is the east line of the southwest quarter of Section 24 being S 1°-03'-17" E, and all other bearings are from angles and distances measured in a field survey by Lee Surveying and Mapping Co., Inc. on April 14, 1997.

Description prepared by:

Jeffrey I. Lee
Professional Surveyor 6359
April 21, 1997



ORIGINAL STAMP IN GREEN

INDEXED ON MAP
1050 3D-1

REC'D A-21-97 *guy* ✓



Lee Surveying and Mapping Co., Inc.



Farm Surveys • Lot Surveys • Topography • Subdivisions • Construction Layout

117 NORTH MADRIVER STREET
BELLEFONTAINE, OHIO 43311

(937) 593-7335
FAX (937) 593-7444

VAN GORDER FARMS TRACT C 3.333 ACRES

Lying in Section 24, Town 7, Range 8, Washington Township, Logan County, Ohio.

Being out of the Van Gorder Farms original 81.28 acre tract as deeded and described in Volume 233, Page 297 and Official Record 273, Page 835 of the Logan County Records of Deeds and being more particularly described as follows:

Beginning at a 1 inch metal pipe found on the center-line of Township Road 213 at the southeast corner of the southwest quarter of Section 24.

THENCE, with the east line of the southwest quarter of Section 24 and the center-line of Township Road 213 (60 feet wide), N 1°-03'-17" W, a distance of 293.46 feet to a MAG nail set at the TRUE POINT OF BEGINNING.

THENCE, S 88°-45'-52" W, a distance of 493.42 feet to a 5/8 inch iron rod set, passing a 5/8 inch iron rod set at 30.00 feet.

THENCE, N 1°-03'-17" W, a distance of 294.27 feet to a 5/8 inch iron rod set.

THENCE, N 88°-45'-52" E, a distance of 493.42 feet to a MAG nail set, passing a 5/8 inch iron rod set at 463.42 feet.

THENCE, with the east line of the southwest quarter of Section 24 and the center-line of Township Road 213, S 1°-03'-17" E, a distance of 294.27 feet to the point of beginning.

Containing 3.333 acres of which 0.203 acre is within the highway right-of-way.

The basis for bearings is the east line of the southwest quarter of Section 24 being S 1°-03'-17" E, and all other bearings are from angles and distances measured in a field survey by Lee Surveying and Mapping Co., Inc. on April 14, 1997.

Description prepared by:

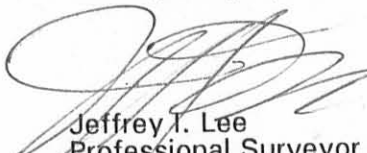
Jeffrey I. Lee
Professional Surveyor 6359
April 21, 1997



L 2308

ORIGINAL STAMP IN GREEN

INDEXED ON MAP
1050 3D-2

REC'D 4-21-97 *smg* *OK* ✓



Lee Surveying and Mapping Co., Inc.



Farm Surveys • Lot Surveys • Topography • Subdivisions • Construction Layout

117 NORTH MADRIVER STREET
BELLEFONTAINE, OHIO 43311

(937) 593-7335
FAX (937) 593-7444

VAN GORDER FARMS TRACT D 5.000 ACRES

Lying in Section 24, Town 7, Range 8, Washington Township, Logan County, Ohio.

Being out of the Van Gorder Farms original 81.28 acre tract as deeded and described in Volume 233, Page 297 and Official Record 273, Page 835 of the Logan County Records of Deeds and being more particularly described as follows:

Beginning at a 1 inch metal pipe found on the center-line of Township Road 213 at the southeast corner of the southwest quarter of Section 24.

THENCE, with the east line of the southwest quarter of Section 24 and the center-line of Township Road 213 (60 feet wide), N 1°-03'-17" W, a distance of 587.73 feet to a MAG nail set at the TRUE POINT OF BEGINNING.

THENCE, S 88°-45'-52" W, a distance of 493.42 feet to a 5/8 inch iron rod set, passing a 5/8 inch iron rod set at 30.00 feet.

THENCE, N 1°-03'-17" W, a distance of 441.41 feet to a 5/8 inch iron rod set.

THENCE, N 88°-45'-52" E, a distance of 493.42 feet to a MAG nail set, passing a 5/8 inch iron rod set at 463.42 feet.

THENCE, with the east line of the southwest quarter of Section 24 and the center-line of Township Road 213, S 1°-03'-17" E, a distance of 441.41 feet to the point of beginning.

Containing 5.000 acres of which 0.304 acre is within the highway right-of-way.

The basis for bearings is the east line of the southwest quarter of Section 24 being S 1°-03'-17" E, and all other bearings are from angles and distances measured in a field survey by Lee Surveying and Mapping Co., Inc. on April 14, 1997.

Description prepared by:

[Handwritten Signature]
Jeffrey I. Lee
Professional Surveyor 6359
April 21, 1997

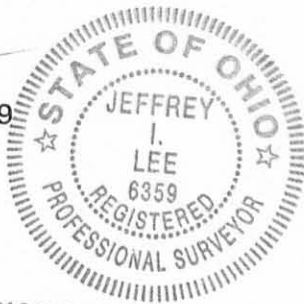

L 2308

ORIGINAL STAMP IN GREEN

INDEXED ON MAP
1050 3D-3

Received 4-23-97 OKJCTH



Lee Surveying and Mapping Co., Inc.



Farm Surveys • Lot Surveys • Topography • Subdivisions • Construction Layout

117 NORTH MADRIVER STREET
BELLEFONTAINE, OHIO 43311

(937) 593-7335
FAX (937) 593-7444

VAN GORDER FARMS TRACT E 3.333 ACRES

Lying in Section 24, Town 7, Range 8, Washington Township, Logan County, Ohio.

Being out of the Van Gorder Farms original 81.28 acre tract as deeded and described in Volume 233, Page 297 and Official Record 273, Page 835 of the Logan County Records of Deeds and being more particularly described as follows:

Beginning at a 1 inch metal pipe found on the center-line of Township Road 213 at the southeast corner of the southwest quarter of Section 24.

THENCE, with the east line of the southwest quarter of Section 24 and the center-line of Township Road 213 (60 feet wide), N 1°-03'-17" W, a distance of 1029.14 feet to a MAG nail set at the TRUE POINT OF BEGINNING.

THENCE, S 88°-45'-52" W, a distance of 493.42 feet to a 5/8 inch iron rod set, passing a 5/8 inch iron rod set at 30.00 feet.

THENCE, N 1°-03'-17" W, a distance of 294.27 feet to a 5/8 inch iron rod set.

THENCE, with the south lines of the Bert Renick, Jr. original 50.0 acre tract (Vol. 373, Pg. 623) and the Robert P. Berg 10.000 acre tract (O.R. 125, Pg. 93, Tr. II) N 88°-45'-52" E, a distance of 493.42 feet to a MAG nail set, passing a 5/8 inch iron rod set at 463.42 feet.

THENCE, with the east line of the southwest quarter of Section 24 and the center-line of Township Road 213, S 1°-03'-17" E, a distance of 294.27 feet to the point of beginning.

Containing 3.333 acres of which 0.203 acre is within the highway right-of-way.

The basis for bearings is the east line of the southwest quarter of Section 24 being S 1°-03'-17" E, and all other bearings are from angles and distances measured in a field survey by Lee Surveying and Mapping Co., Inc. on April 14, 1997.

Description prepared by:

Jeffrey I. Lee
Professional Surveyor 6359
April 21, 1997

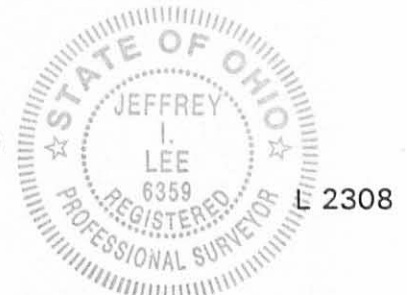

ORIGINAL STAMP IN GREEN

INDEXED ON MAP
1050 3D-4

COUNTY HIGHWAY 54 (60')

1/4 SECTION LINE

BERT RENICK JR.
ORIGINAL 50 ACRES
VOL. 373, PG. 623

ROBERT P. BERG
AND
KATHY J. BRAUTIGAM
10.00 AC.
O. R. 125, PG. 93
TRACT II

2 WORKING DAYS
BEFORE YOU DIG
CALL TOLL FREE **800-362-2764**
OHIO UTILITIES PROTECTION SERVICE.

LEGEND

- 5/8 IRON ROD SET
- ⊙ MAG NAIL SET
- ⊗ RAILROAD SPIKE FOUND
- 1" METAL PIPE FOUND



N 88° 45' 52" E
493.42'

TRACT E
3.333 ACRES
OF WHICH 0.203 IS IN
HIGHWAY RIGHT-OF-WAY

N 88° 45' 52" E
493.42'

TRACT D
5.000 ACRES
OF WHICH 0.304 IS IN
HIGHWAY RIGHT-OF-WAY

N 88° 45' 52" E
493.42'

TRACT C
3.333 ACRES
OF WHICH 0.203 IS IN
HIGHWAY RIGHT-OF-WAY

N 88° 45' 52" E
493.42'

TRACT B
3.333 ACRES
OF WHICH 0.202 IS IN
HIGHWAY RIGHT-OF-WAY

S 88° 34' 29" W
493.43'

TIMOTHY E. KNIEF
95.23 AC.
VOL. 404, PG. 956

INDEXED ON MAP
10503P

**SURVEY OF FOUR TRACTS
OUT OF THE
VAN GORDER FARMS
ORIGINAL 81.28 ACRE TRACT
VOLUME 233, PAGE 297
AND
OFFICIAL RECORD 273, PAGE 835
SECTION 24, TOWN 7, RANGE 8
WASHINGTON TOWNSHIP
LOGAN COUNTY, OHIO**

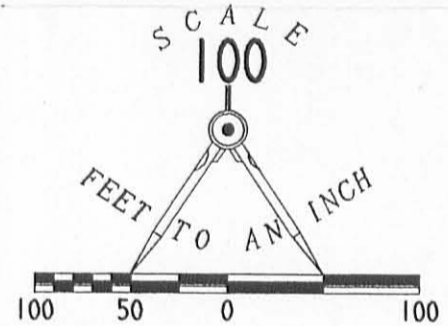

SURVEYED BY:

Jeffrey I. Lee
JEFFREY I. LEE
PROFESSIONAL SURVEYOR 6359
APRIL 14, 1997
REV. APRIL 29, 1997

ORIGINAL STAMP IN GREEN

COPYRIGHT 1997 BY:
LEE SURVEYING & MAPPING CO., INC.
117 North Madriver Street
BELLEFONTAINE, OHIO 43311
(937) 593-7335

**SECTION 24, TOWN 7, RANGE 8
SECTION 25, TOWN 7, RANGE 8**

P. O. B.

D310

VANGRDER

L-2308-3

Received 4-24-97 org/gh



Lee Surveying and Mapping Co., Inc.



Farm Surveys • Lot Surveys • Topography • Subdivisions • Construction Layout

117 NORTH MADRIVER STREET
BELLEFONTAINE, OHIO 43311

(937) 593-7335
FAX (937) 593-7444

VAN GORDER FARMS 20.379 ACRES

Lying in Section 23, Town 7, Range 8, Washington Township, Logan County, Ohio.

Being all of the Van Gorder Farms 20.44 acre tract as deeded and described in Volume 233, Page 297 and Official Record 273, Page 835 of the Logan County Records of Deeds and being more particularly described as follows:

Beginning at a 5/8 inch iron rod found on the center-line of Township Road 215 at the southeast corner of Section 23.

THENCE, with the south line of Section 23 and the north line of the Jake Schwartz 100.347 acre tract (O.R. 241, Pg. 536), S 89°-24'-15" W, a distance of 1330.72 feet to a 5/8 inch iron rod set, passing a 5/8 inch iron rod set at 30.00 feet.

THENCE, with the east line of the Lelah May 17.00 acre tract (Vol. 333, Pg. 605, First tract) and a line of the Van Gorder Farms original 102.52 acre tract (O.R. 273, Pg. 835, and Vol. 233, Pg. 297), N 1°-38'-44" W, a distance of 662.95 feet to a stone found.

THENCE, with a south line of the said 102.52 acre tract, N 89°-15'-28" E, a distance of 1340.89 feet to a 5/8 inch iron rod set, passing a 5/8 inch iron rod set at 1310.89 feet and a stone found at 1340.39 feet.

THENCE, with the east line of Section 23 and the center-line of Township Road 215, S 0°-46'-00" E, a distance of 666.26 feet to the point of beginning.

Containing 20.379 acres of which 0.459 acre is within the highway right-of-way.

The basis for bearings is the east line of Section 23 being S 0°-46'-00" E, and all other bearings are from angles and distances measured in a field survey by Lee Surveying and Mapping Co., Inc. on April 14, 1997.

Description prepared by:

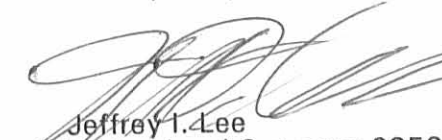
Jeffrey I. Lee
Professional Surveyor 6359
April 21, 1997



L 2308

ORIGINAL STAMP IN GREEN

INDEXED ON 1050 4D-1

REC'D 4-24-97 *slly OK*



Lee Surveying and Mapping Co., Inc.



Farm Surveys • Lot Surveys • Topography • Subdivisions • Construction Layout

117 NORTH MADRIVER STREET
BELLEFONTAINE, OHIO 43311

(937) 593-7335
FAX (937) 593-7444

VAN GORDER FARMS TRACT A 5.000 ACRES

Lying in Section 24, Town 7, Range 8, Washington Township, Logan County, Ohio.

Being out of the Van Gorder Farms original 81.28 acre tract as deeded and described in Volume 233, Page 297 and Official Record 273, Page 835 of the Logan County Records of Deeds and being more particularly described as follows:

Beginning at a 5/8 inch iron rod found on the center-line of Township Road 215 at the southwest corner of Section 24.

THENCE, with the west line of Section 24 and the center-line of Township Road 215 (60 feet wide), N 0°-46'-00" W, a distance of 487.62 feet to a railroad spike set at the TRUE POINT OF BEGINNING.

THENCE, with the west line of Section 24 and the center-line of Township Road 215, N 0°-46'-00" W, a distance of 450.00 feet to a railroad spike set.

THENCE, N 87°-51'-01" E, a distance of 484.14 feet to a 5/8 inch iron rod set, passing a 5/8 inch iron rod set at 30.00 feet.

THENCE, S 0°-46'-00" E, a distance of 450.00 feet to a 5/8 inch iron rod set.

THENCE, S 87°-51'-01" W, a distance of 484.14 feet to the point of beginning, passing a 5/8 inch iron rod set at 454.14 feet.

Containing 5.000 acres of which 0.310 acre is within the highway right-of-way.

The basis for bearings is the west line of Section 24 being S 0°-46'-00" E, and all other bearings are from angles and distances measured in a field survey by Lee Surveying and Mapping Co., Inc. on April 14, 1997.

Description prepared by:

Jeffrey I. Lee
Professional Surveyor 6359
April 24, 1997



L 2308

ORIGINAL STAMP IN GREEN

1050 4D-2
INDEXED ON MAP

REC'D 4-28-97 SWJ OK JCH



Lee Surveying and Mapping Co., Inc.



Farm Surveys • Lot Surveys • Topography • Subdivisions • Construction Layout

117 NORTH MADRIVER STREET
BELLEFONTAINE, OHIO 43311

(937) 593-7335
FAX (937) 593-7444

VAN GORDER FARMS 20.431 ACRES

Lying in Section 23, Town 7, Range 8, Washington Township, Logan County, Ohio.

Being out of the Van Gorder Farms original 102.52 acre tract as deeded and described in Volume 233, Page 297 and Official Record 273, Page 835 of the Logan County Records of Deeds and being more particularly described as follows:

Beginning at a 5/8 inch iron rod found on the center-line of Township Road 215 at the southeast corner of Section 23.

THENCE, with the east line of Section 23 and the center-line of Township Road 215, N 0°-46'-00" W, a distance of 666.26 feet to a 5/8 inch iron rod set at the TRUE POINT OF BEGINNING and being 0.50 feet east of a stone found.

THENCE, with the north line of the Van Gorder Farms 20.44 acre tract (O.R. 273, Pg. 835), S 89°-15'-28" W, a distance of 1340.89 feet to a stone found, passing a 5/8 inch iron rod set at 30.00 feet.

THENCE, N 0°-23'-11" W, a distance of 663.60 feet to a 5/8 inch iron rod set.

THENCE, with the south line of the William T. Keegan 40.0 acre tract (O.R. 55, Pg. 622), N 89°-09'-06" E, a distance of 1336.48 feet to a railroad spike set, passing a 5/8 inch iron rod set at 1306.48 feet.

THENCE, with the east line of Section 23 and the center-line of Township Road 215, S 0°-46'-00" E, a distance of 666.06 feet to the point of beginning.

Containing 20.431 acres of which 0.459 acre is within the highway right-of-way.

The basis for bearings is the east line of Section 23 being S 0°-46'-00" E, and all other bearings are from angles and distances measured in a field survey by Lee Surveying and Mapping Co., Inc. on April 26, 1997.

Description prepared by:

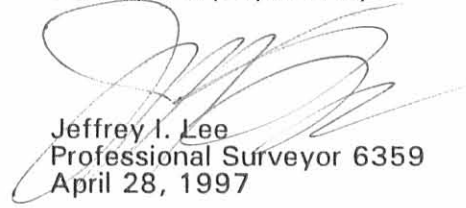

Jeffrey I. Lee
Professional Surveyor 6359
April 28, 1997



ORIGINAL STAMP IN GREEN

L 2308

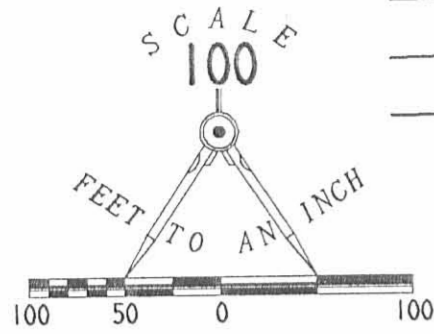
INDEXED ON MAP
1050 47-3



COUNTY HIGHWAY 54 (60')

WILLIAM T. KEEGAN
40.0 AC.
O. R. 55, PG. 622

SURVEY OF VAN GORDER FARMS 20.44 ACRE TRACT
(20.379 ACRES BY THIS SURVEY)

AND
20.431 ACRES OUT OF THE
VAN GORDER FARMS
ORIGINAL 102.52 ACRE TRACT
SECTION 23, TOWN 7, RANGE 8

AND
5.00 ACRES OUT OF THE
VAN GORDER FARMS
ORIGINAL 81.28 ACRE TRACT
SECTION 24, TOWN 7, RANGE 8
VOLUME 233, PAGE 297

AND
OFFICIAL RECORD 273, PAGE 835
WASHINGTON TOWNSHIP
LOGAN COUNTY, OHIO

20.431 ACRES
OF WHICH 0.459 ACRE
IS WITHIN THE HIGHWAY
RIGHT-OF-WAY

VAN GORDER FARMS
102.52 AC.
VOL. 233, PG. 297
O. R. 273, PG. 835

VAN GORDER FARMS
20.44 AC.
VOL. 233, PG. 297
O. R. 273, PG. 835

20.379 ACRES
OF WHICH 0.459 ACRES IS
WITHIN THE HIGHWAY
RIGHT-OF-WAY

LELAH MAY
17.00 AC.
VOL. 333, PG. 605
FIRST TRACT

2 WORKING DAYS
BEFORE YOU DIG
CALL TOLL FREE **800-362-2764**
OHIO UTILITIES PROTECTION SERVICE.

JAKE SCHWARTZ
100.347 AC.
O. R. 241, PG. 536

TRACT A
5.000 ACRES
OF WHICH 0.310 ACRES IS
WITHIN THE HIGHWAY
RIGHT-OF-WAY

VAN GORDER FARMS
81.28 AC.
VOL. 233, PG. 297
O. R. 273, PG. 835

TIMOTHY KNIEF
95.23 AC.
VOL. 404, PG. 456

TOWNSHIP ROAD 215
(60')

LEGEND

- 5/8 IRON ROD SET
- ⊕ RAILROAD SPIKE SET
- 5/8 IRON ROD FOUND
- ⊕ STONE FOUND



SURVEYED BY:
Jeffrey L. Lee
JEFFREY L. LEE
PROFESSIONAL SURVEYOR 6359
APRIL 14, 1997
REVISED APRIL 24, 1997

COPYRIGHT 1997 BY:
LEE SURVEYING & MAPPING CO., INC.
117 North Modriver Street
BELLEFONTAINE, OHIO 43311
(937) 593-7335

D310 VNGDR2 L-2308-2

INDEXED ON MAP
1050 4P