

SEE SURVEYOR'S AFFIDAVIT

Lee Surveying and Mapping Co.



CLAYTON M. LEE, P.S.
JEFFREY I. LEE, P.S.

855 East Sandusky Avenue
Bellefontaine, Ohio 43311
Phone 593-5780



Farm Surveys • Lot Surveys • Topography • Subdivisions • Construction Layout

KOORN TO KNIEF 16.003 ACRE SURVEY

Lying in partial Section 25, T-7-S, R-8-E, Washington Township,
Logan County, Ohio.

Being out of that original 95.23 acre tract lying in the name of
Cornelius Koorn, (Volume 391, Page 565) being in the southwest corner
thereof and more particularly described as follows:

Beginning at a railroad spike set on the center-line of Township
Road 215 (west line of Section 25) marking the southwest corner of said
95.23 acres and being southerly along said center-line a distance of 1691.0
feet from the northwest corner of said Section 25.

THENCE, with said west line of Section 25 and road center-line,
N 1°-01' W, a distance of 703.71 feet to a railroad spike.

THENCE, with a fence line, N 88°-44' E, a distance of 1031.00 feet
to an iron rod.

THENCE, S 14°-16'-30" E, a distance of 573.48 feet to an iron rod
set on the north line of the Detrick 90 acres (Volume 344, Page 162, Par-
cel 3, Tract 1), this line and fence line also being the south line of
grantor's said 95.23 acres.

THENCE, with said south line, S 81°-37'-50" W, a distance of 1172.15
feet to the point of beginning. Containing 16.003 acres.

Last previous deed reference: Volume 391, Page 565.

Prepared by:

Clayton M. Lee

Clayton M. Lee
Registered Surveyor No. 6181
4-27-84

7036 1D

INDEXED ON MAP



ORIGINAL STAMP IN GREEN

L-1123

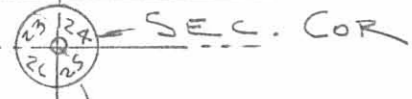

CORNELIUS KOORN
ORIG. 95.23 AC., VOL. 391, PG. 565



16.003 ACRES

SURVEY OF 16.003 ACRES OUT OF THE
KOORN 95.23 ACRES (VOL. 391, PG. 565 ,)
PARTIAL SEC. 25, T-7-S, R-8-E,
WASHINGTON TWP. LOGAN COUNTY, OHIO

APRIL 20, 1984
REV. 23, 1984 (E. Line)

SET RR SPIKE
TWP. ROAD 215 (VAN GORDER RD.) SET RR SPIKE
N 1°-01' W, 703.71'

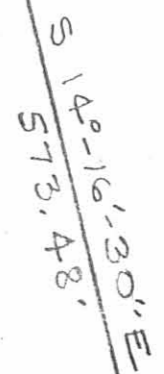

SCALE = 1" = 100'

SET RR SPIKE

SET IRON ROD

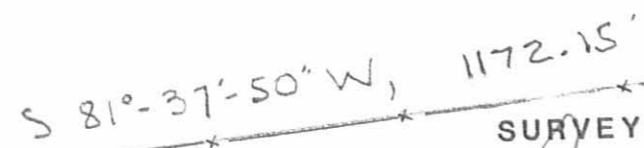

ELIZ. DETRICK
90.0 AC. ORIG.
VOL. 344, PG. 162
(PARC. 3, TRACT 1)

SURVEYED BY:

Jeffrey I. Lee

JEFFREY I. LEE

REG. SURVEYOR NO. 6359



ORIGINAL STAMP IN GREEN

7036 IP

INDEXED ON MAP

Lee Surveying & Mapping Co.
855 E. Sandusky Ave.
BELLEFONTAINE, OHIO 43311
(513) 593-5780

PROFESSIONAL SURVEYOR'S AFFIDAVIT

STATE OF OHIO
RECEIVED _____

TIME _____

RECORDED _____

OFFICIAL RECORD _____ PAGE _____

COUNTY RECORDER ss:

Jeffrey I. Lee, being first duly sworn, deposes and says that he is a Registered Professional Surveyor under the laws of the State of Ohio, being Professional Surveyor No. 6359 and that he is making this affidavit for the purposes of correcting the description to certain real estate situated in Washington Township, Logan County, Ohio, presently owned by J. Randall Gobin and Patricia Jean Gobin by virtue of a Warranty Deed recorded in Volume 404, Page 954 of the Logan County Records of Deeds.

The corrected description being as follows with corrections underlined:

Lying in partial Section 25, T-7-S, R-8-E, Washington Township, Logan County, Ohio.

Being out of that original 95.23 acre tract lying in the name of Cornelius Koorn, (Volume 391, Page 565) being in the southwest corner thereof and more particularly described as follows:

Beginning at a railroad spike set on the center-line of Township Road 215 (west line of Section 25) marking the southwest corner of said 95.23 acres and being southerly along said center-line a distance of 1691.0 feet from the northwest corner of said Section 25.

THENCE, with the west line of Section 25 and road center-line, N 1°-01'-00" W, a distance of 703.71 feet to a railroad spike.

THENCE, with a fence line, N 88°-44'-00" E, a distance of 1031.00 feet to a iron rod.

THENCE, S 14°-16'-30" E, a distance of 583.44 feet to an iron rod set on the north line of the Detrick 90 acres, (Volume 344, Pg. 162, Parcel 3, Tract 1), this line and fence line also being the south line of grantor's said 95.23 acres.

THENCE, with said south line, S 82°-06'-52" W, a distance of 1173.22 feet to the point of beginning. Containing 16.136 acres. PARCEL# 51-060-00-00-033.002

Last previous deed reference: Volume 391, Page 565.

Description prepared by Clayton M. Lee, Registered Surveyor No. 6181, April 27, 1984.

This affidavit is made in compliance with Revised Code of Ohio Sec. 5301.252 and particularly to show an affidavit of a professional surveyor to reconcile conflicts and ambiguities in descriptions of land in recorded instruments as stated in paragraph B(5) of Section 5301.252. Under Sec. 5301.252(C) the County Recorder shall receive and cause such affidavit to be recorded as deeds are recorded.

SIGNED AND ACKNOWLEDGED IN THE PRESENCE OF:

Brandi Pyles
BRANDI PYLES
Mary Ann Conkle

Jeffrey I. Lee
Jeffrey I. Lee
Professional Surveyor No. 6359

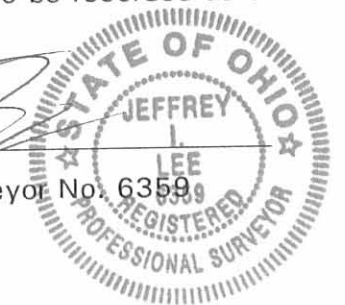

ORIGINAL STAMP IN GREEN

BE IT REMEMBERED, that on this 27 day of April, 1998, before me, the subscriber, a Notary Public in and for said County and State, personally came the above named Jeffrey I. Lee the maker of the foregoing Affidavit, and acknowledged the signing of the same to be his voluntary act and deed, for the uses and purposes therein mentioned.

IN TESTIMONY WHEREOF, I have hereunto subscribed my name and affixed my official seal, on the day and year last aforesaid.

Mary Ann Conkle
Notary Public, MARY ANN CONKLE
NOTARY PUBLIC, STATE OF OHIO
My Commission Expires Oct. 10, 1999

RECORDER:
Please cross reference to Volume 404, Page 954 in the Abstract of the Deed Records of Logan County, Ohio.

This instrument was prepared by Jeffrey I. Lee.

7036 2D
INDEXED ON FILE

26 24
23 25
SECTION CORNER

CORNELIUS KOORN
ORIG. 95.23 ACRES
VOL. 391, PG. 565

SCALE
100

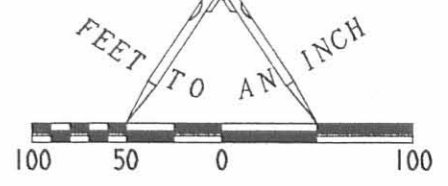

TOWNSHIP ROAD 215 (VAN GORDER RD.)

S 01° 01' 00" E
987.29'

30.00'

N 88° 44' 00" E
1031.00'

16.136 ACRES

N 01° 01' 00" W
703.71'

S 14° 16' 30" E
583.44'

1173.22'
S 82° 06' 52" W

SET APRIL 17, 1998

ELIZ DETRICK
ORIG. 90.0 ACRE
VOL. 344, PG. 162
PAR. 3, TRACT 1

CORRECTION SURVEY FOR
16.003 ACRES OUT OF THE
(16.136 ACRE BY THIS SURVEY)
KOORN 95.23 ACRES
VOLUME 391, PAGE 565
SECTION 25, TOWN 7, RANGE 8
WASHINGTON TOWNSHIP
LOGAN COUNTY, OHIO



SURVEYED BY:
JEFFREY I. LEE
PROFESSIONAL SURVEYOR 6359
APRIL 23, 1984

CORRECTED BY:
[Signature]
JEFFREY I. LEE
PROFESSIONAL SURVEYOR 6359
APRIL 17, 1998

COPYRIGHT 1998 BY:
LEE SURVEYING & MAPPING CO., INC.
117 North Madriver Street
BELLEFONTAINE, OHIO 43311
(937) 593-7335

2 WORKING DAYS
BEFORE YOU DIG
CALL TOLL FREE 800-362-2764
OHIO UTILITIES PROTECTION SERVICE.

IND...
70362P

ORIGINAL STAMP IN GREEN

D 325 RGOBIN

L-1123-3