

83-7



Surveyed September 13<sup>th</sup> 1833 for Isaac Cooper part of sections No. 23 & 24 of T. 5 of R. 8 E. Beginning at the NW corner of the East half of the N. E. q. in Sec. 23. at a Quaking asp 60<sup>o</sup> 33' 3/4 E 88 links - & White oak 30<sup>o</sup> 20' S. W 100.31 links, then S 3<sup>o</sup> 30' E 40 ch. to a Bur oak 19<sup>o</sup> 10' S 114 692 links. and a Bur oak 52<sup>o</sup> 15' 56' W 4 links. then N 86<sup>o</sup> 10' E 40 ch. 10 links to a Plum tree standing in an old Indian field 22<sup>o</sup> 10' 30' S 116 W 12 links then N 3<sup>o</sup> 30' W 20 ch. to a stake in a prairie. then N 86<sup>o</sup> 10' E 20 ch. 108 crossing a small branch to a Quaking asp 52<sup>o</sup> 18' 13' 30' S 130 E 3 links. then N 3<sup>o</sup> 30' W 20 ch. to the quarter section corner on the center of the north line of Sec. 24. a Bur oak 12<sup>o</sup> 10' 142 W 49 links, White oak 12<sup>o</sup> 10' 132 E 34 links, then N 86<sup>o</sup> 10' W 60.20 ch. crossing a small branch at 28 ch. and NW corner of section No. 24 at 40 ch. 20 links to the beginning. Cont. 2 Two Hundred acres, and Sixty hundred a. this

Surveyed by D. Hopkins 5<sup>th</sup> day Survey 26

for

No. 225

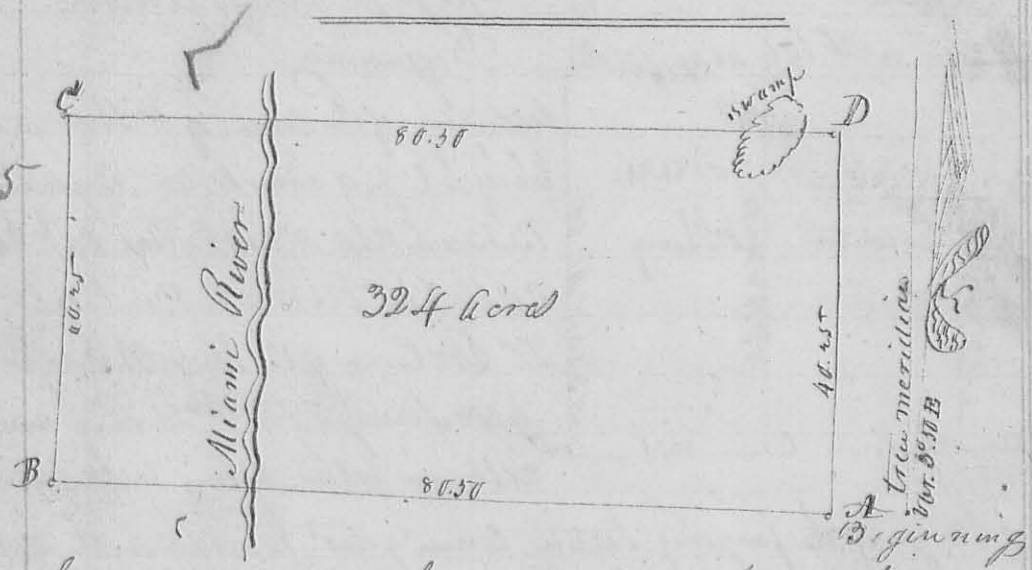

83-8

Surveyed September 14<sup>th</sup> 1833 for Abram Cherry the South half of Sec. 23 of T. 5 of R. 8 E. Beginning at the South East corner of the section. then N 86<sup>o</sup> 10' W 80 ch. 50 links crossing the Big Miami to the NW corner of the section. then N 3<sup>o</sup> 30' W 40 ch. 25 links to the q. d. corner. On the west line of the section. then N 86<sup>o</sup> 10' E 80.30 ch. crossing the river and passing thro' a swamp to the q. d. corner on the East line of the section. then S 3<sup>o</sup> 30' E 40.25 ch. to the beginning. Cont. 324 acres. D. Hopkins 5<sup>th</sup> day 26