

83-7



Surveyed September 13<sup>th</sup> 1833 for Isaac Cooper part of sections No. 23 & 24 of T. 5 of R. 8 E. Beginning at the NW corner of the East half of the N. E. q. in Sec. 23. at a Quaking asp 60<sup>o</sup> 33' 3/4 E 88 links - & White oak 30<sup>o</sup> 20' S. W 100.31 links, then S 3<sup>o</sup> 30' E 40 ch. to a Bur oak 19<sup>o</sup> 10' S 114 6 22 links. and a Bur oak 52<sup>o</sup> 15' 56' W 4 links. then N 86<sup>o</sup> 10' E 40 ch. 10 links to a Plum tree standing in an old Indian field 22<sup>o</sup> 10' 30' S 116 W 12 links then N 3<sup>o</sup> 30' W 20 ch. to a stake in a prairie. then N 86<sup>o</sup> 10' E 20 ch. 10 ch. crossing a small branch to a Quaking asp 52<sup>o</sup> 18' 13' 30' S 130 E 3 links. then N 3<sup>o</sup> 30' W 20 ch. to the quarter section corner on the center of the north line of Sec. 24. a Bur oak 12<sup>o</sup> 10' S 42 W 49 links, White oak 12<sup>o</sup> 10' S 32 E 34 links, then N 86<sup>o</sup> 10' W 60.20 ch. crossing a small branch at 28 ch. and NW corner of section No. 24 at 40 ch. 20 links to the beginning. Cont. 2. Two Hundred acres, and Sixty hundred a. this

Surveyed by D. Hopkins 5<sup>th</sup> day Survey 26

for

No. 225

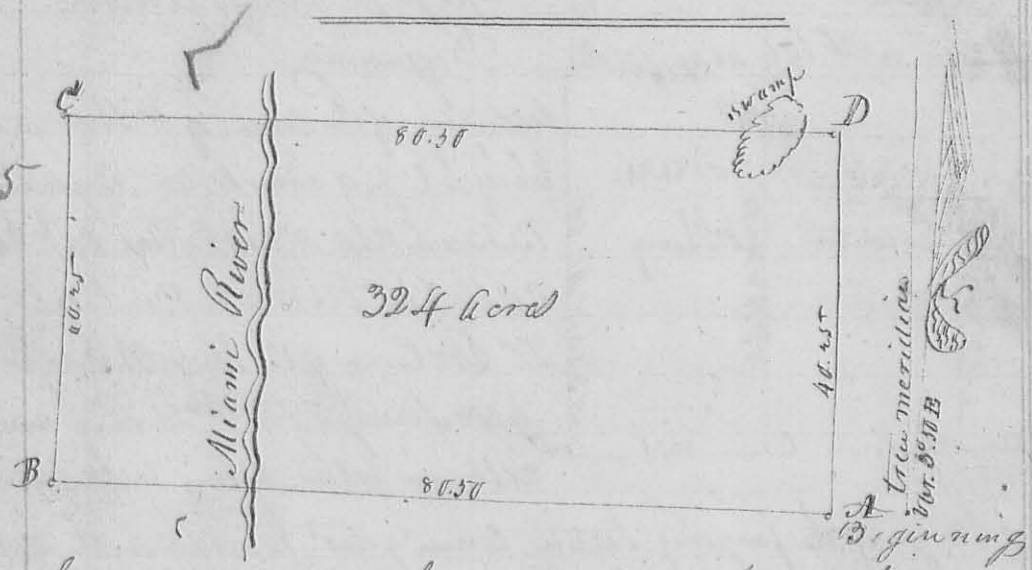

83-8

Surveyed September 14<sup>th</sup> 1833 for Abram Cherry the South half of Sec. 23 of T. 5 of R. 8 E. Beginning at the South East corner of the section. then N 86<sup>o</sup> 10' W 80 ch. 50 links crossing the Big Miami to the NW corner of the section. then N 3<sup>o</sup> 30' W 40 ch. 25 links to the q. d. corner. On the west line of the section. then N 86<sup>o</sup> 10' E 80.30 ch. crossing the river and passing thro' a swamp to the q. d. corner on the East line of the section. then S 3<sup>o</sup> 30' E 40.25 ch. to the beginning. Cont. 324 acres. D. Hopkins 5<sup>th</sup> day 26