

Survey No 629 Surveyed June 6th 1848-
 minimum for Dennis Leonard a part
 of the S.W. q. of Sec 33, Town 5, Range 13,
 E. of Miami River - as follows to wit Beginning
 at the N.W. corner of said q. at a stone
 near a White Oak - thence S $\frac{1}{2}$ W $107 \frac{1}{4}$ poles crossing
 a county Road at 95 poles to a stake near
 a Bot Oak N. $15 \frac{1}{2}$ E $46 \frac{3}{4}$ E 20 links dist. thence S $89 \frac{1}{2}$ E
 $158 \frac{3}{4}$ poles to a stake in the aforesaid Co. road near
 a large Hickory thence S $\frac{1}{2}$ E $107 \frac{1}{4}$ poles to a
 stake near a large White Oak thence S $89 \frac{1}{2}$ W $158 \frac{3}{4}$
 poles to the beginning containing 106 A 30.68 Per-

Said off out of the N.E. corner of said ~~tract~~
 Leonard tract a lot for Joseph B. Gray as follows
 Beginning at a stake at the N.E. corner of
 Leonard's tract. thence N $89 \frac{1}{2}$ W $17 \frac{2}{3}$ poles to
 a stake thence S $\frac{1}{2}$ W $53 \frac{18}{25}$ poles to a stake near
 a small Hickory thence S $89 \frac{1}{2}$ E $17 \frac{2}{3}$ poles
 to a stake near a Hickory "Stub" (dead) thence
 N $\frac{1}{2}$ E $53 \frac{18}{25}$ poles to the beginning containing
 6 Acres and $\frac{17}{1000}$ of an acre

Also at same time & out of same tract
 laid off a lot for George Coley as follows
 Beginning at a stake in the west line of Sec-
 33 T5 R13 E. of C. M. R. from which a Bot. Oak
 12 S. E. bears N $46 \frac{3}{4}$ E 20 links distant thence
 S $89 \frac{1}{2}$ E 60 poles to a stake near a large White Oak
 thence N $81 \frac{3}{4}$ W $60 \frac{3}{5}$ poles to a stake in the
 West line of said Sec. thence S $\frac{1}{2}$ W 11 poles to
 the place of beginning containing 2 acres and
 10 perches

Also ran a line so as to divide the remainder
 of said Leonard tract between Dennis and
 Absolom Leonard as follows Beginning at a stake
 88 poles N $89 \frac{1}{2}$ W from the N.E. corner of said tract

8534

Thence S 1/2 W 72 poles to a stone in a field
thence N 89 1/2 W 34 7/25 poles to a stake near a
White Oak thence S 1/2 W 30 poles to a stake
in a County road,

Dennis Conards describes as follows - Absolom is described as follows

- 1 S 1/2 W 72 poles
- 2 N 89 1/2 W 34 7/25 "
- 3 S 1/2 W 30 "
- 4 S 81 1/4 E 22 "
- 5 S 89 1/2 E 98 5/25 "
- 6 N 1/2 E 53 18/25 "
- 7 N 89 1/2 W 17 22/25 "
- 8 N 1/2 E 53 18/25 "
- 9 N 89 1/2 W 70 3/25 "

- 1 S 1/2 W 72 poles
- 2 N 89 1/2 W 34 7/25 "
- 3 S 1/2 W 30 "
- 4 N 81 1/4 W 38 7/25 "
- 5 N 1/2 E 107 10/25 "
- 6 S 89 1/2 E 70 5/25 "

The foregoing descriptions both begin at the same place i.e. where the last named line commences -

D. Conard
A. D. Jones

O. Hayes Sur. L. C. C.

Survey No. 630

8534

Surveyed June 21-22/48 for John Kautzman of Rush creek township L. County O. Military Survey No. 9888 on the waters of Mill creek as follows "to wit" Beginning at the N.E. corner of said Survey at a stone thence S 79 W 100.40 chains crossing a road at 69 chs to a stake from which a Sugar tree 16 In. dia bears N 25 1/2 E 9 links and a do. 10 In. dia S 33 1/2 E 16 1/2 links distant thence S 11 E 100 chs crossing the aforesaid road at 55 chs to a stake from which a blue Ash 16 In. dia bears N 54 E 27 links and a hickory 5 In. dia N 47 1/2 W 9 links dist.

thence $N 79^{\circ} E$ 100 chs. passing along an exceeding high bank to a stake in a field thence $N 11^{\circ} W$ 100. ch. crossing a brook at 47.50 chains and spring brook at 260 poles to place of beginning containing 1002 Acrey

Subdivided same as follows.

Beginning at a stake in the North line of said Survey (at the centre) from which a Sugar 20 I. S. bears $S 73^{\circ} E$ 26 and Hickory 18 I. S. $N 77^{\circ} W$ 8 links distant thence $S 11^{\circ} E$ 100 chs. passing stake 33.58 chs. ~~corner~~ to creek at 55 chs. and deep ravine at 99 chains to a stake in the centre of South line of said Survey Then divided said Survey by two lines running Easterly through same

as follows 1st. Beginning at a stake in the West line of said survey 33.58 chs. from the S.W. corner of the same from which a sugar 15 I. S. bears $S 4^{\circ} E$ 8 and sugar 12 I. S. $N 32^{\circ} W$ 14 links distant thence $N 79^{\circ} E$ 100 chs. passing Ironwood 4 I. S. at 50 chs. (corner to John Roberts, John Kautzman, George Kautzman and Peter Kautzman) to a stake in the East line of said Survey from which a Bur Oak 30 I. S. bears $S 6^{\circ} W$ 9 links. Second line runs as follows Beginning at a stake in the West line of said Survey from which an Elm 18 I. S. bears $S 37^{\circ} E$ 29 and Beech $N 77^{\circ} E$ 32 links distant thence $N 79^{\circ} E$ 100 chs. crossing Jamesfield road at 23.50 chs. passing a small beech at 50 chs. (corner of John, George Barney and Old man Kautzman) to a stake in the E. line of said Survey 33.58 chs. S.W. of the N.E. ^{corner} of the same John Kautzman & Peter Kautzman chs. ers. O. Hayes Sur. L. C. Ohio.

8557

Survey No 631

Surveyed June 23/48 for Jesse Roberts part of Military Survey No. 13203 on the Waters of Boker Creek as follows
 Beginning at Lawson Riddells S.E. corner at a Buckeye Buchard cherry thence S 10° E 155 poles crossing a road at 80 poles a branch at 128 poles to two Beeches Original corner of said Block (No 13203) thence S 78° W 103 3/4 poles crossing a branch at 25 poles to a Beech and Small Sugar thence N 10° W 155 poles crossing a branch at 20 and one at 51 and a road at 74 poles to a Buchard Buckeye bush thence N 78° E 103 3/4 poles to the beginning containing 100 Acres

Lawson Riddell ch. ers.
 C Hayes Sur. L.C.C.

8554

Survey No 632

July 15th 1848

In pursuance of the following notice I proceeded on the above date to take deposition and establish the South East corner of military survey No 9888 -
 Mr John Countryman

Sir,

You will take notice that on the 15th day of July A.D 1848 I (pro) will take testimony before Oam Hayes Surveyor of Logan County to establish the South East corner of Virginia Military Survey No 9888 in Logan County, which corner has been destroyed. The testimony will be taken and the lines of survey connected with said corner be run by said Surveyor and the

Corner established on the premises
and at said corner, on the day and
year aforesaid at which time and place
you can attend with your testimony
and cross examine the witnesses
produced by us if you see proper
June 24th 1848

Anderson Williams
(Signed) Nathan Hockett
Benja^{his} M. Hodges
mark

June 24th 1848 Subpoena issued for the
following persons as witnesses for the
applicants to wit. Jacob King, John Pro-
ter, Henry Rosebrough and Sander
Jacobs and delivered the same to
Philip G. Johnson Constable of Rush-
creek township Logan county O.

July 15/48 Subpoena returned Endorsed
"Served by reading the within to
Henry Rosebrough, John Proter and
Jacob King" Philip G. Johnson Constable

Testimony of witnesses taken before me
Oden Hayes Surveyor of Logan county
on the 15th day of July A. D. 1848 at the
South East corner of Virginia Military
Survey N^o 9888 in pursuance of the notice
hereto attached and at the time and place
therein mentioned present Nathan Hockett
Anderson Williams Benja M. Hodges and
John Cantzman at which time and place
came John Proter Henry Rosebrough and
Jacob King all of Logan county and of -

lawful age who being first duly sworn
as hereafter certified depose as follows in
answer to the interrogatories

Deas. By applicants
John Prater,

Have you ever seen the
marked trees standing at the South East
corner of Virginia Military Survey #09888
in Logan County, and if so what and what
kind of timber was it, and how were the
trees marked?

Ans. I saw the corner that Mr Samuel
Ruth showed when he (Ruth) and I
traded land, Ruth traded the land to
me adjoining the ^{said} corner for another lot
on Rush Creek Logan County Ohio.

I saw the corner in 1832. It was a beech
stump broke off up some 8 or 10 feet high
don't remember height distinctly. It
was marked with hicks seemed to be
made with an ax or hatchet.

Q by same, How near did you live to said
corner after you traded land with Ruth,
and did you ever see it after it was
first shown to you, and how often did
you see it afterwards?

Ans. I lived about 80 poles from said corner
and I saw it frequently - I do not know
how often,

Q by same. Can you now point out the
place where the corner tree ^{or stump} formerly
stood,
and if so where was it?

Ans. I gave Benja M Hodges a lease on the land
near the corner and he built a house near
the corner after I showed it to him.

and I recollect the corner as being near the chimney of said Hodges' house, say not more than 3 rods, in a S. W. direction and within 16 1/2 feet of the ground I now point out

Q by same, Have you continued to reside in the neighborhood, and do you know whether the land adjoining has been improved and occupied to conform to this corner?

Ans. I have not, continued to reside in the neighborhood (and do not know how the land was improved)

(Signed) John Prater

Jacob King - Have you seen the corner trees standing at the South East corner of Va. Military Survey 9888 in Logan County and if so when, what kind of timber were they, and point out the place where they stood?

Ans. I never saw the trees standing - I saw the stump of One, and the other was blown down and the log was still laying - I saw the corner before there was any improvement made about (it) the corner - say about 18 or 20 years ago. It was shown to me by Samuel Ruth and Samuel Monjar and I saw it frequently, afterwards the timber was two Beeches marked as a corner and they stood near a little branch in the edge of the "fallen timber" and the

trees were not more than 4 or 5 rods from the aforesaid branch. And about the same time and noticed and followed a marked line from said corner northwardly some distance

Jacob King ^{his} mark
Henry Rosebrough State

ever saw the corner tree at the South East corner of Military Survey No 9888 in Logan County and if so where when, was it and where did they stand?

Ans I was fetched once to carry chain for a Surveyor by the name of White some 25.01 6 years ago last Jan'y, or Feb'y, and we commenced at the South East corner of Military Survey No 9888 and we made a corner in the East line of said survey which was marked on a sugar tree that I recollect and there was a plain marked line from said sugar both northerly and southerly to the N.E. and S.E. corners of said survey. I do not remember the ground on which said trees stood the trees were both Beeches.

I By same

Did you ever run round or subdivide the survey since you first saw the corner and if so at whose request, and what was the length of the south line of the survey?

Ans I did run round the survey (at the request of Mr Porterfield) as chain carrier and we found the South line of said survey only 380 poles long

I. By same,

Can you point out the Sugar tree corner made by Mr White in the East line of the Survey the first time you saw the S.E. corner of the Survey and if so where is it?

Ans. I can. It stands on the South bank of Mill creek and is now pointed out.

(Signed) Henry Rosebrough

I Oden Hayes County Surveyor of Logan county Ohio do hereby certify that the aforementioned John Prater, Jacob King and Henry Rosebrough were by me first duly sworn to testify the truth the whole truth, and nothing but the truth and that the foregoing depositions by them respectively subscribed were reduced to writing by me, and taken at the time and place specified in the foregoing notice,

In testimony whereof I have hereunto set my hand this 15th day of July in the year A.D. 1848.

O. Hayes, Sur. C. O.

In pursuance of the foregoing depositions and the old marked lines I established the S.E. corner of Virginia Military Survey No. 9888 N 78° 38' 0" poly S 9 1/2° E 400 poles from the N.W. corner of the same as nearly in the original Greenwell's Treaty line as possible and about 4 poles from the branch mentioned by Mr. King

in his testimony and near a small ¹³⁵
 hickory bush, at which point I caused
 a large stone to be planted in the pres-
 ence of the following named persons -
 John Prater, Andrew Roberts, B. Stan-
 ton Esq, Henry Rosebrough, Wm D. Brun-
 son, Jeremiah Hill, Eros Williams,
 Samuel Dearduff, -
 William Callahan } ch.ers.
 David Pugh }
 O. Hayes Sur. L. C.

Survey N^o 633 ^{Surveyed Aug. 5th 1848}
 for Samuel M^{rs} Beth the
 South West quarter of Section 35. Town
 5. Range 13 E. L. M. R. as follows -
 Beginning at the S. W. corner of said
 Section at a stone from which a
 Burr Oak stump bears N 53 E 17 links
 distant, thence N 10 E 160 1/2 poles to
 a stone and stake, thence N 89 3/4 E
 172 poles to a stake at the centre
 of the Sect. thence S 10 W 160 1/2 poles
 to a stone in the centre of the South
 line of said Sect, thence S 89 3/4 W 171 1/4
 poles to the place of beginning contain-
 ing 172 Acres and 186 perches.

Saml M^{rs} Beth }
 John Stow } ch.ers.
 April 3rd 1848 }
 O. Hayes Sur. L. C.
 Subdivided the foregoing gr. by ~~line~~
 for Samuel M^{rs} Beth and Shepard Green by
 a line beginning at the middle of the S. line
 thence N 10 E to the centre of that S. line of the same
 S. Green } ch.ers.
 O. Hayes Sur. L. C.

N^o 634 Surveyed October 24 1825 for

~~unclear~~

8557

John F. Patten and David Jones the west part of the N.E. qr of Section 22 Town 1, Range 8, E. M. M. as follows to wit Beginning at the N.W. corner of said qr. at a stone from which a Beech 40 S. bears S 30° E ^{2 1/2} links and a White Oak

10 S. bears N 71° E 31 links distant. thence S 3° 45' E 20 chs to a stake - Elm 8 S. bears S 51 1/2° E 30 and White Oak 10 S. bears N 21° E 55 links distant thence N 86 1/4° E 25.02 chs. to a stake - Dogwood 4 S. bears S 40° W 24 and Beech 14 S. bears S 36 1/2° E 3 links distant thence N 3° 45' W 20 chs to a stake - Hickory 5 S. bears S 46° W 22 and Br. Oak ^{1 1/2} S. bears N 87 3/4° E 15 links distant, thence S 86 1/4° W 25.02 chs. to the place of beginning containing 50.04 ₁₀₀ Acres. The above is John F. Patten's. and at the same time

Surveyed the South half of the said west part of the N.E. qr. of Section 22 Town 1, Range 8, E. M. M. as follows to wit Beginning at a stake in the centre of the west line of said qr. from which an Elm 8 S. bears S 51 1/2° E 30 and a White Oak 10 S. bears N 28° E 55 links distant. thence N 86 1/4° E 25.02 chs to a stake and Dogwood 5 S. bears S 40° W 24 and Beech 14 S. bears S 36 1/2° E 3 links distant thence S 3° 45' E 20 chs to a stake - Beech 18 S. bears S 45° W 5 1/2 links distant thence S 86 1/4° W 25.02 chs. to a stake - White Oak 42 S. bears N 9° E 18 and Hickory 19 S. bears N 77° E 4 links distant thence N 33 3/4° W 20 chs. to the Beginning containing 50.04 ₁₀₀ Acres for David Jones.

Henry Post
John Patten

O. Hayes Sur. Gen. Ohio

No 635

Surveyed October 27th 1848 for Tho^l

3553

Baird Esq. Adm. with the will annexed of the estate of Thomas Baird Decd. the S. E. qr. of Section No. 33. Town No. 5. of Range No. 13 E. G. M. R. as follows to wit Beginning at the S. W. corner of said qr. at a stake from which a white Oak 14 S. E. bears N 57 1/2° E 64 links thence N 89 1/2° E 42.75 chs. to a stake in Pines "Mill Pond" at the N. W. corner of Section 26. T. S. R. 13 E. G. M. R. thence N 12° E 39.75 chs. to a stake in the centre of the E. line of said Section 33. thence ^{N 47 1/2° W} 42.75 chs. to a stake in the centre of said Section (33) thence S 10° W 40.12 chs. to the place of beginning containing 171 Acres and ⁶/₁₀₀ of an Acre and subdivided said qr. as follows Beginning at the N. E. corner of said qr. at a stake near a white Oak stump thence S 12° W 75 chs. to a stake from which a white Oak 30 S. E. ^{bears} S 26° W 10 links dist. thence ^{West} S 87 1/2° W 42.75 chs. to a stake from which a white Oak 24 S. E. bears S 17° W 32 links thence N 1° E 75 chs. to a stake at the centre of Sec. 33. thence ^{East} S 87 1/2° E 42.75 chs. to the beginning containing 3 ⁷⁰/₁₀₀ Acres. Surveyed to R. G. Roberts set Baird. as follows beginning a stake 75 chs. S 10° W from the centre stake of said Sec. 33 from which a white Oak 24 S. E. bears S 17° W 32 links thence S 10° W 26.33 chs. to a stake from which a Plum 4 S. E. bears N 71° E 24 links dist. thence N 89 1/2° E 3.16 chs. to a stake from which a white Oak 10 S. E. bears N 63° W 30 links. thence N 1° E 6.33 chs. to a stake from which the N. E. corner of the house in which the said Margaret Baird now dwells bears S 36 1/2° W 303 links dist. thence S 87 1/2° W 3.16 chs. to the beginning containing 2 ⁴/₁₀₀ and ⁴/₁₀₀ acres

Also laid off a lot in said gr. for Israel Pim
 as follows Beginning at the S.E. corner of the
 gr. at a stake in said Pim's "Mill pond" thence
 S89 $\frac{1}{2}$ W 3.25 chains to a stake from which a
 White haw 6 S. 5 $\frac{1}{2}$ N 23 $\frac{1}{2}$ W 115 links dist thence
 N1 $^{\circ}$ E 12.50 chs to a stake in a prairie, thence
 N89 $\frac{1}{2}$ E 3.25 chs to a stake from which a Willow
 12 S. 5 $\frac{1}{2}$ bears S86 $\frac{1}{2}$ E 47 links dist thence S1 $^{\circ}$ W
 12.50 chs to the beginning containing 4 Acres and
 10 Perchs.

Also laid off a lot for R.C. Runkle & John H.
 Young Esq. as follows Beginning at the S.W.
 corner of the gr. at a stake from which a
 White Oak 14 S. 5 $\frac{1}{2}$ bears N57 $\frac{1}{2}$ E 64 links dist
 thence N89 $\frac{1}{2}$ E 39.68 chains to a stake from
 which a White Thorn 6 S. 5 $\frac{1}{2}$ bears N23 $\frac{1}{2}$ W 115 links
 dist thence N1 $^{\circ}$ E 12.50 chs to a stake in
 a prairie thence N89 $\frac{1}{2}$ E 3.25 chs to a
 stake from which a Willow 12 S. 5 $\frac{1}{2}$ bears S86 $\frac{1}{2}$ E
 47 links dist thence N1 $^{\circ}$ E 14 chs to a stone
 thence West 6.56 chs to a stake at the S.W. corner
 of a lot dec'd by Mrs Baird ^{and} and wife to F. Hays
 Esq. thence S88 W 3.25 chains to a stake in the
 original bed of Muddy run thence N16 E
 3.47 Chs across a ditch in which the water of
 Muddy Run now flows to a stake thence
 N15 E 3.37 chs to a stake in a ditch thence
 S89 $\frac{1}{2}$ W 34.89 chs to a stake from which the
 N.E. corner of the house in which Margaret
 Baird now dwells bears S36 $\frac{1}{2}$ W 303 links
 dist thence S1 $^{\circ}$ W 6.33 chs to a white Oak 10 S. 5 $\frac{1}{2}$
 N 6.3 W 30 links dist thence S89 $\frac{1}{2}$ W 3.16 chs to
 a stake from which a Plum 4 S. 5 $\frac{1}{2}$ bears N71 E
 24 links dist thence S1 $^{\circ}$ W 33.79 chs to the
 place of Beginning containing 155 A. and $\frac{1}{100}$ of an
 acre. Jno. Brown & Co. Surveyors. O. Hays Esq. S.W. C.

8554

Survey No 636 [✓] Surveyed Nov. 14. 1848 for Samuel M. Hamilton part of Military Survey No. 4810 on Otter creek a branch of Mill creek as follows Beginning at a Beech in the Original South line of said Survey thence S 54 1/2 W 64 poles to a stake from which a Water Elm 18 S. bears N 80 E 48 links dist. thence N 38 W 177 poles crossing Otter creek at 156 pds. to a stake in the Bellefontaine and Columbus Free Turnpike from which a Pigeon Oak Stump 24 S. bears N 53 1/2 E 75 links dist. thence N 65 E 65 1/4 poles to another stake in said Free Turnpike thence S 38 E 163 3/4 poles crossing Otter creek at 11 pds. to the place of beginning containing 68 and 100 Acre -

Solomon Meneal
Isaac B. Dillin
Ch. W. C. Hayes Sur. G. O.

8557

Survey No 637 [✓] Surveyed Nov. 15. 1848 for Charles Carl a part of Military Survey No. 4810 on Otter creek a branch of Mill creek as follows Beginning at a stake in the Bellefontaine and Columbus Free Turnpike from which a Pigeon Oak 24 S. bears N 53 1/2 E 75 links dist. thence S 65 W 60.2 poles to a stake on the North side of said Free Turnpike thence S 38 E 189 poles crossing Otter Creek at 78 pds. to a stake in the Original South line of said Survey from which a White Ash 5 S. bears N 65 E 16 links dist. thence N 54 1/4 E 59 2/10 poles to a stake from which a

Water Elm 18 S. 62. bears N 80° E 48 links dist. thence N 38° W 177 poles crossing Otter creek at 156 poles to the place of beginning containing 67 Aers and 77 Beches

Isaac B. Dillen
Jos. S. Carl

Ch. Cr.
O. Hayes Sur. L. C.

Survey No. 638 Surveyed Nov. 15th, 1848 for

Job Wickensham a part of Military

8555 Survey No. 6232 and a part of Survey No. 4810 on Otter Creek a branch of Mill creek as follows Beginning at a Beech 12 S. 62. in the Original South line of No. 4810 thence N 52° E 168 1/2 poles passing the Original Corner of said Survey at 29 ps. to a stake from which an Ironwood 11 S. 62. bears S 82° W 6 links dist. thence N 38° W 122 poles to a stake in west line of Job Smiths land (crossing the Bellefontaine and Columbus Free Turnpike at 112 ps) thence S 63° W 141 1/2 poles to a stake in said Free Pike thence N 38° W 4 poles to a stake from which a Beech 10 S. 62. bears S 32° E 23 links dist. thence S 77° W 33 1/2 ps. crossing Otter creek to a stake in said Free Pike thence S 35° E 163 1/2 poles crossing Otter creek to the place of beginning containing 151 Aers

Isaac B. Dillen
Jos. S. Carl

Ch. Cr.

O. Hayes Sur. L. C.

Survey No. 639

8553

Surveyed Nov. 15th 1848 for
 Henry Elc a part of Military Survey 80
 6232 on Otter creek a branch of Mill creek
 as follows Beginning at a stake in the
 West line of said Survey on the S. Bank
 of Otter Creek thence N 78³/₄ W 29 poles
 to a stake thence N 59 W 17¹/₂ poles to a stake
 in the West line of said Survey thence
 S 38 E 37²/₃ poles passing along the Orig-
 inal line to the place of beginning containing
 12¹/₂ perches

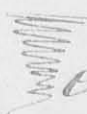

Henry Elc
 Peter Mattox  ch.ers.

O. Hays Sur. L. C. O.

Survey No. 640

2929

Surveyed Nov. 18 1848 for
 Hiram M. White a part of the N. W. gr.
 of Section 28. Town 5. Range 13 E. S. M. R.
 as follows Beginning at the S. W. corner
 of said gr. a stake from which a White
 Oak 18 S. E. bears S 15 W 38 links and a Hick-
 ory 18 S. E. bears S 44 E 38 links distant
 thence East 46 poles to a stake in the West
 side of the Springfield and Sandusky Free
 Turnpike thence N 16 W 26¹⁰/₃ poles to an-
 other stake in said Free Pike thence
 West 54 poles to a stake in the East side
 of the road leading from West Liberty
 in Logan County to Maupankomotta
 in Anglitz County thence S 38 E 95 poles
 to another stake in said Road thence
 South 6 poles to the place of Beginning
 containing 8 Acres nearly

John Prater 
 Fred. Hauger  ch.ers.

O. Hays Sur. L. C. O.

142

2929

Survey No 641

✓

Surveyed Nov. 18, 1848

for Fred. Hanger a lot of land in the
 N.W. qr. of Section 28 T5. R12 E. G. M.R.
 as follows Beginning at a stake in West
 side of the State road leading from
 Bellefontaine Logan Co. to West Liberty in said
 County thence West 54 poles to a stake
 in the road leading from West Liberty
 in Logan Co. to Rappahannetta in Aug-
 laiz Co. thence N 38 W 17 poles to an-
 other stake in said Rappahannetta road
 (Near a little bridge) thence East 60.75
 poles to a stake in the West side of the
 first mentioned Road. thence S 16 E.
 112 poles to the place of beginning con-
 taining 410 Acres

John Proter

Fred. Hanger & chers. atty

O. Huggins, Secy

Survey No 642 Surveyed December 26th 1848

356

for Fred. Hanger, Sander Hen-
 per John and Nathaniel Kelly and H.
 M. White the N.W. qr. of Section No. 29 Town
 5 Range 13 E. G. Miami River as follows
 1st for S. Kemper the E. 1/2 of the N.E.
 qr. of said section Beginning at the N.E.
 corner of said section at a stake from
 which a White Oak 10 in. originally bore
 N 55 W 18 links and a Black Oak 18 in. 57
 links exist (Both said to be gone) a White O.
 stump still standing taken by me as the
 stump of one of said bearing trees,
 thence S 1/2 W 40 chains to a stake in the
 East line of said section thence S 87 1/2 W

20.40 chas. to a stake from which a Hickory
16 S. E. bears N 43 W 39 and another Hickory
10 S. E. bears S 60 E 38 links distant thence
N 18 40 chains to a stake from which
a White Oak 24 S. E. bears S 31 1/2 W 73 links
distant thence N 89 1/2 E 20.61 chains to the place
of beginning containing Eighty two
Acres. Surveyed the West half of said

G. Haugge

N. E. qr. as follows Begin at the N. W. corner
of said Kemper's lot at a stake from which
a White Oak 24 S. E. bears S 31 1/2 W 73 links
distant thence S 1 W 40 chains to a stake from
which a Hickory 16 S. E. bears N 43 W 39 and another
Hickory 10 S. E. bears S 60 E 38 links distant
thence S 89 1/2 W 20.40 chs. to a stake from
which a White Oak 20 S. E. bears N 15 1/2 E 46
and another White Oak 16 S. E. S 3 1/4 W 41 links
distant thence N 42 E 40 chs. to a stake from which
a White Oak 18 S. E. bears S 33 1/2 W 62 links distant
thence N 89 1/2 E 20.61 chains to the place of begin-
ning containing Eighty two Acres

which a

At the same time Surveyed the East
half of the N. W. qr. of said Section for
Jno. and Nathaniel Kelly as follows begin-
ning at the centre of said Section thence
N 42 E 40 chs. to a stake from which a White
Oak 18 S. E. bears S 33 1/2 W 62 links distant thence
S 89 1/2 W 20.63 chains to a stake from which a
Hickory 5 S. E. bears S 19 E 30 links distant thence
S 1 W 40 chs. to a stake from which a White
Oak 20 S. E. N 56 W 40 links distant thence N 89 1/2 W
20.40 chs. to the place of beginning containing
Eighty two Acres

At the same time Surveyed for H. M. White
the N. half of said N. W. qr. as follows -
Surveyed page

See opposite page,

Beginning at said Kelly's N.W. corner at
a stake from which a Hickory 51.5⁺ bears
S 89° 30' links dist. thence S 11° 40' chs. to a stake
from which a White Oak 20.5⁺ bears S 56° W
40 links. thence S 89° W 20.40 chs. to a stake
in the Springfield and Sandusky Free Turn-
pike thence S 72° E along said "Pike" 40 chains
to the N.W. corner of the section. thence
S 89° E 20.63 chs. to the place of beginning
containing Eighty two Acres—

Jac. Thomas
S. Abbott ch.ers.

O. Hays Sur. Sec.

Survey No. 643.

Dec. 30th 1848

Surveyed a line between Secs-
23. & 24 T. 5 R. 13 for John and Peter Kelly—

Beginning at the corner of Secs- 23. 24.

29. and 30. thence S 89° E to the S. end line

O. Hays Sur. Sec.

8523

Survey No 644

145

Surveyed Feby 3rd 1849 for Tho^s P. Miller

the 2nd W. addition of

a Lot of land as follows Beginning on the south side of Columbus street in the town of West Liberty Logan county at the point where Miller street terminates thence S 86° W 100 feet along Columbus street to a stake thence S 40° E 150 feet to a stake on the North side of South Alley, in said town plat, thence N 86° E 100 feet along said Alley to a stake, thence N 40° W 150 feet to the place of beginning, containing 15,000 square feet See plat of Second Western addition to the town of West Liberty Ante page 57

J. M. Glover } carried ch.
O. Hays }

O. Hays Sur. L. C. G.

8469

Survey No 645

February 26/49

Surveyed for Mrs Stuart et al, the South half of Section No 10 Town 4 R 13 E. C. M. R, as follows for Mrs Stuart the West half of the East half of the S. E. q. of said q. Beginning at the N. W. corner of said East half of said S. E. q. at a stake then South 163 poles and 16 links to a stake from which a ~~W~~ thence S 89 1/2° E 36 poles and 9 links to a stake from which a White Oak stump 28 S. Dr. bears S 10° E 21 links. thence N 78° W 163 poles and 16 links to a stake from which a Bot. Oak 20 S. Dr. bears N 20° W 17 links, thence West 38 poles and 16 links to the

place of beginning containing
 38 Acres and 56 perches.
 Reuben James Hill
 Major S. Willford } ch. ers.
 Also surveyed at the same time
 for Henry Eichelberger a lot off the
 North end of the N. half of S. E. qr. of
 Section 10 T 44 R. 13. M. R. E. and off the
 end of the E. half of the S. W. qr. of said
 section as follows Beginning at the
 N. E. corner of the N. half. of the S. W. qr.
 of said Sec. at a white Oak 18 I. Or. thence
 South $\frac{1}{2}$ ° N 46 p. and 14 links to a stone
 thence East 154 p. to a stake, thence
 N 11° N 46 p. and 14 links to a stake, thence
 West 154 p. and 16 links to the place of
 beginning containing 45 Acres.

R. J. Hill
 M. S. Willford } ch. ers.

Also at the same time surveyed
 West half of the S. W. qr. of said section
 as follows beginning at the S. W. corner
 of said section at a stone thence S 89 $\frac{1}{2}$ ° E
 80.75 poles to a stake thence N $\frac{1}{2}$ ° N 163.6
 poles to a white Oak 18 I. Or. thence West
 77.3 poles to a stone thence S $\frac{3}{4}$ ° N 162.75
 poles to the place of beginning containing
 80 Acres and $\frac{55}{100}$.

R. J. Hill
 M. S. Willford } ch. ers.

O. Hays Sur. L. C. O.

Survey No 646 Surveyed March 10th 1849 for Abram Hogue

8291

John A. Harner and John Kenagy part of the East half of Section 24, T. 4. Range 13 E. R. M. R. as follows to wit beginning at the South East corner of said section at a stone for Harner's tract, thence N 1° E 62 3/4 poles to a stake (South E. corner to Hogue's lot) thence S 89 1/2° E 161 1/4 poles to a stake, thence South 62 1/2 poles to a stake, thence S 89 3/4° E 161 1/2 poles to the place of beginning containing 63 Aers and 54 perches

Harner's

Also for A. Hogue beginning as follows to wit at a stake N 1° E 62 3/4 poles from the S. E. corner of the section and in the E line of said section, thence N 1° E along said E line 75 poles to a stake at Kenagy's S. E. corner, thence West 162 1/2 poles to a stake said Kenagy's N. W. corner and in the N. and S. division line of the section, thence South 75 poles to a stake at Harner's N. E. corner thence S 89 1/2° E 161 3/4 poles to the beginning containing 76 Aers

Hogue's

Also for Kenagy as follows Beginning at a stake in the East line of said section N 1° E 137 3/4 poles from the S. E. corner of the section, thence West 162 1/2 poles to a stake, thence North 74 3/5 poles to a stake, thence East 165 1/2 poles to a stake thence S 8° W 74 3/5 poles to the beginning containing 76 Aers

Kenagy's

Richd P. Duwall
Jas L. Frank

O. Hayes Sur. Co. Ohio

148
B307

A plat of McClain & Robinson's addition to the town of East Liberty

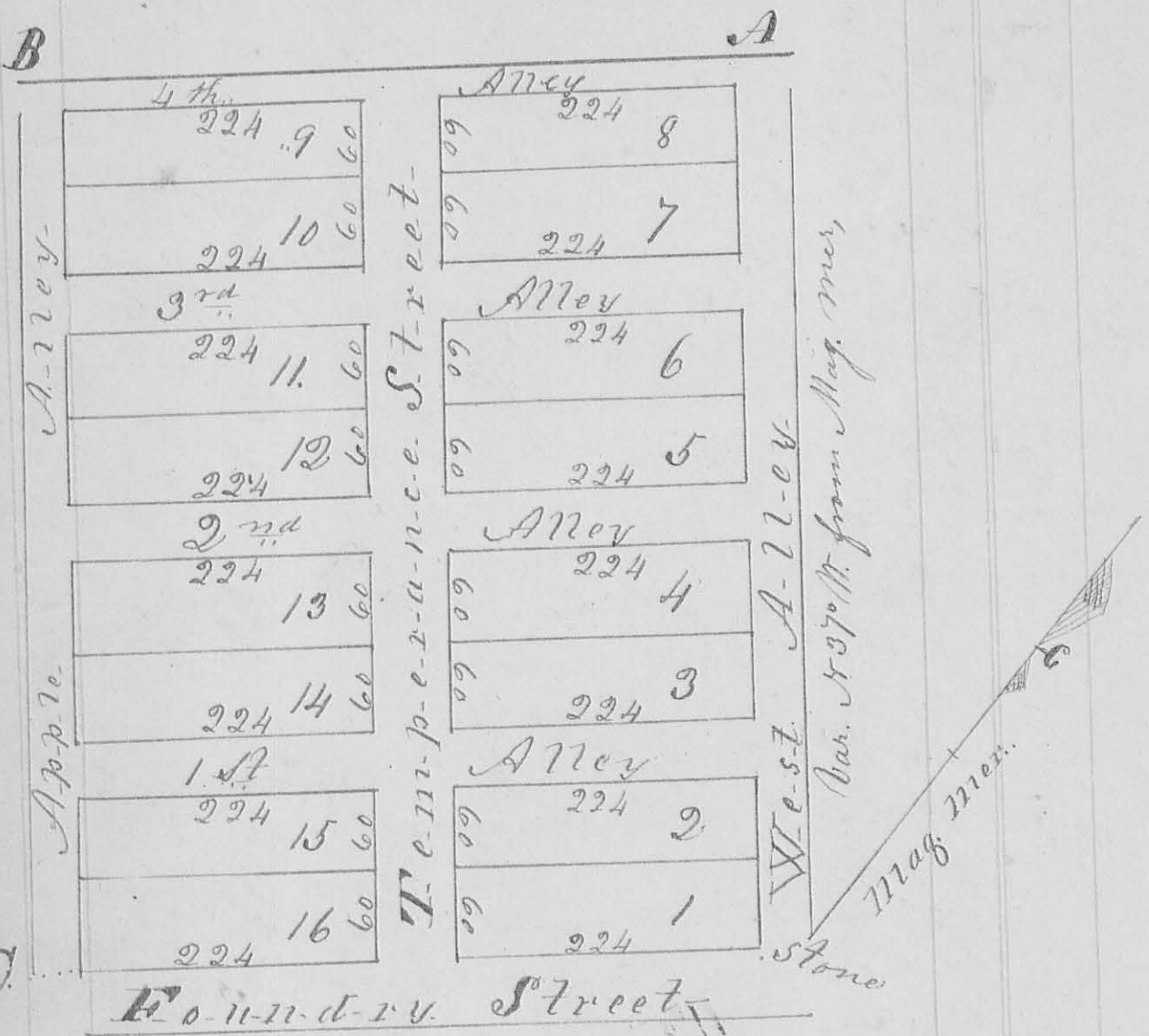

Surveyed March 12th 1849 an addition to the town of East Liberty for Daniel McClain and George Robinson as follows Beginning at the point marked "Stone" in the foregoing plat at the junction of "Foundry Street" and "West Alley" thence N 37° W. to the point "A." thence S 53° W. to the point "B." thence S 37° E. to the point "O" thence N 53° E. to the place of Beginning. Lots No. 1, 2, 3, 4, 5, 6, 7, 8, 9, 10, 11, 12, 13, 14, 15 and 16 are each 60 feet front on Temperance Street and extend 224 feet

back containing 13,440 square feet,
"First" Second Third and fourth alleys
are each 16 feet wide

West alley is 32 feet wide and Apple
alley is 20 feet wide

Temperance and Foundry Streets are
each 60 feet wide

George Robinson
Albert Heath Scheris
D. McClain Marker.

O. Hayes Sur. S. E. Ohio

Survey No. 648 Surveyed and subdivided
Section 36 T. 5. R. 13. E. G. M. R.

8559

between John Goder Alex. Black Egr. George
Secrist George Williams and Tho. Collins
as follows for John Goder Beginning at
the S. W. corner of said section at a stake
thence S 89 1/2° E 169 3/4 poles to a stake thence
N 10° E 56 3/4 poles to a stake thence S 89 1/2° E 169 3/4
poles to a stake thence N 1 1/2° E 54 3/4 poles to
a stake thence N 89 1/2° W 142 3/4 poles to a stake
thence S 10° W 11 1/4 poles to a stake thence N 87 1/2° W
27 3/4 poles to a stake thence S 10° W 8 3/4 poles
to a stake thence N 89 1/2° W 170 poles to
a stake thence S 10° W 92 1/2 poles to the begin-
ning containing 156 A. 3 R and 9 perches.

Goder's

Secrist's

Also for George Secrist as follows Begin-
ning at a stake at the N. W. corner of the
S. W. qr. of said section thence S 10° W 69 1/2 poles
to a stake thence S 89 1/2° E 170 poles to a stake
thence N 10° E 110 poles to a stake thence S 89 1/2° E
27 3/4 poles to a stake thence N 10° E 11 1/4 poles
to a stake thence S 89 1/2° E 142 3/4 poles to a stake
thence N 10° E 50 poles to a stake,

thence N 89 3/4 W 34 1/4 poles to the Beginning containing 12 1/2 Acres and 58 perches

Also for A. Black Esqr. the S. side of the S.E. qr. of said Section Beginning a Stake at the S.E. corner of said section thence N 10 E 56 3/4 poles to a stake, thence N 89 3/4 W 169 3/4 poles to a stake, thence S 19 W 56 3/4 poles to a stake, thence S 89 3/4 E 169 3/4 poles to the beginning containing 60 Acres

Also for Thos. Collins off the N. side of the N.E. qr. of said Section as follows - beginning at a Blk. Oak at the N.E. corner of the section thence N 89 3/4 W 175 3/4 poles to a stake, thence S 10 W 97 1/4 poles to a stake, thence S 89 3/4 E 172 3/4 poles to a stake, thence N 1 3/4 E 97 1/4 poles to the beginning containing 105 Acres.

Also for George Williams the N.W. qr. of said Section as follows beginning at the N.W. corner of said section thence S 10 W 161 3/4 poles to a stake, thence S 89 3/4 E 170 3/8 poles, thence N 10 W 162 3/8 poles to a stake, thence N 89 3/4 W 175 3/4 poles to the beginning containing 175 Acres and 26 perches

March 1647-1847

A. Black
C. Secrist 3 ch. es.

O. Hayes Sur. S. C. Ohio