

Notes & Legend:

1. ——— represents the deed line of Robert B. Dunham to Charles Schlegel et ux as recorded in 1949. Also Hedges deed.
2. - - - - represents the Wonders Line as surveyed in 1892. Then it was also the 1.0' above spillway level line.
3. ——— represents the present 2.0' above spillway level line as measured July, 1969.

Error of closure: These two pts. should be the same.

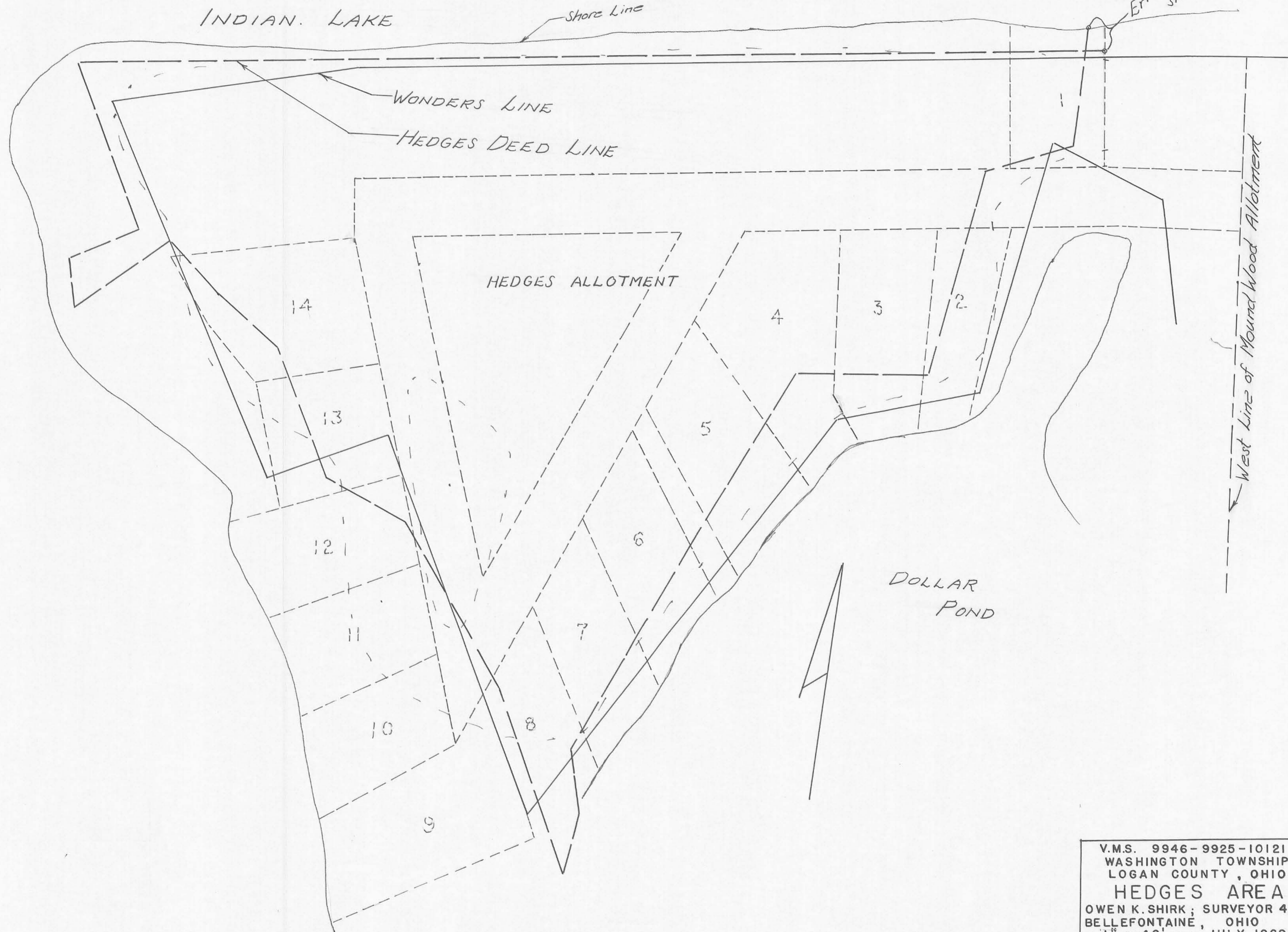

V.M.S. 9946-9925-10121
 WASHINGTON TOWNSHIP
 LOGAN COUNTY, OHIO
HEDGES AREA
 OWEN K. SHIRK; SURVEYOR 4271
 BELLEFONTAINE, OHIO
 1" = 40' — JULY, 1969