

ROBERT R. KING 6.40 AC

ROBERTA M. GRABER 11.34 AC

N. 82° 31' W. 495.2'

S. 82° 58' E. 370.0

ST. 102+57.52

S. 75° 00' E

R/W LINE

U.S. ROUTE No. 68

S. 99+57.52

TRACT No. 1
4.30 AC.

WEST LIBERTY HOMES INC.

4.00 AC.

EXISTING 40' R/W
TO BE EXTINGUISHED

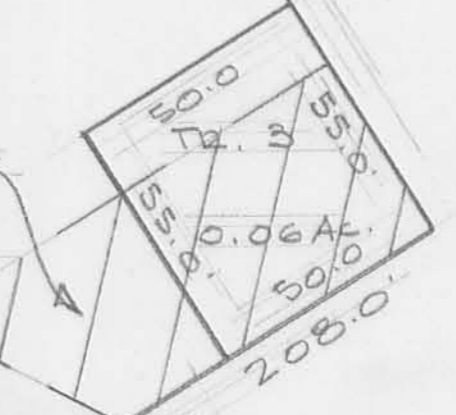

TRACT No. 2
2.36 AC.

N. 20° 44' E. 344.1'

N. 24° 16' W. 275.1'

N. 24° 16' W. 150.0'

40' RIGHT OF WAY

N. 65° 24' E. 176.7'

N. 55° 36' W. 155.0'

S. 34° 24' W. 197.6'

N. 55° 36' W. 185.0'

WEST LIBERTY CARE CENTER INC.
12.78 AC.

WEST LIBERTY GARDEN APARTMENTS
4.08 AC.



PLAT FOR
WEST LIBERTY CARE CENTERS INC.

SEC. 28 T-5 R-13
LIBERTY TOWNSHIP
LOGAN COUNTY, OHIO
MAY 9, 1979
SCALE 1"=40'

PREPARED BY
DAN L. DOBSON
REG. SURVEYOR 4270
BELLEFONTAINE, OHIO

REVISED
12/1/80 D.L.D.