

- SYMBOLS:**
- ◻ - 5/8"  $\varnothing$  Rebar Fd.
  - - 5/8" x 30" Rebar Set.
  - - 5/8" Rebars Fd.
  - ⊙ - 6" Round Concrete Monument Fd.

**MILLIGAN ROAD - 50'**

**KNOWLTON ROAD - 50'**

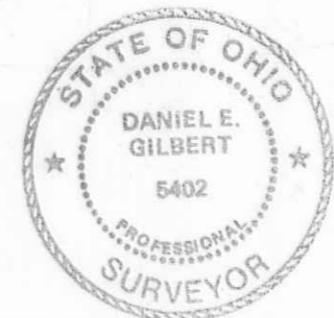

<b>ROBERTS SURVEY - Lot No. 3871</b> City of Bellefontaine, Lake Township, Logan County, Ohio.		
SCALE: 1" = 40'	APPROVED BY:	DRAWN BY <b>DEG</b>
DATE: 12-21-2002		REVISED
<i>Daniel E. Gilbert</i> Daniel E. Gilbert, P.S. Reg. Sur. No. 5402		DRAWING NUMBER <b>2002-021</b>

INDEXED ON MAP  
3421

S-411

3852      3853  
 Belle-Air Estates Addition No. 2  
 Plat Cab. A Slide 323  
 8-11-1955