

S. R. No. 235

- 60'

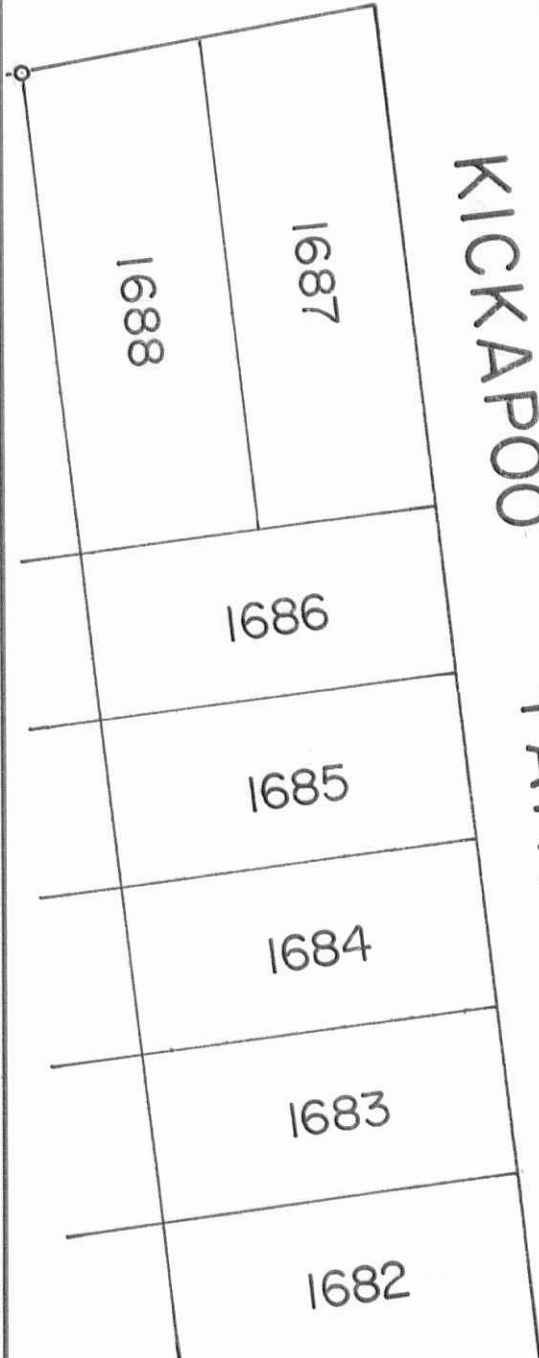

KICKAPOO

PATH - 35'



CHICASSAW

PATH - 35'

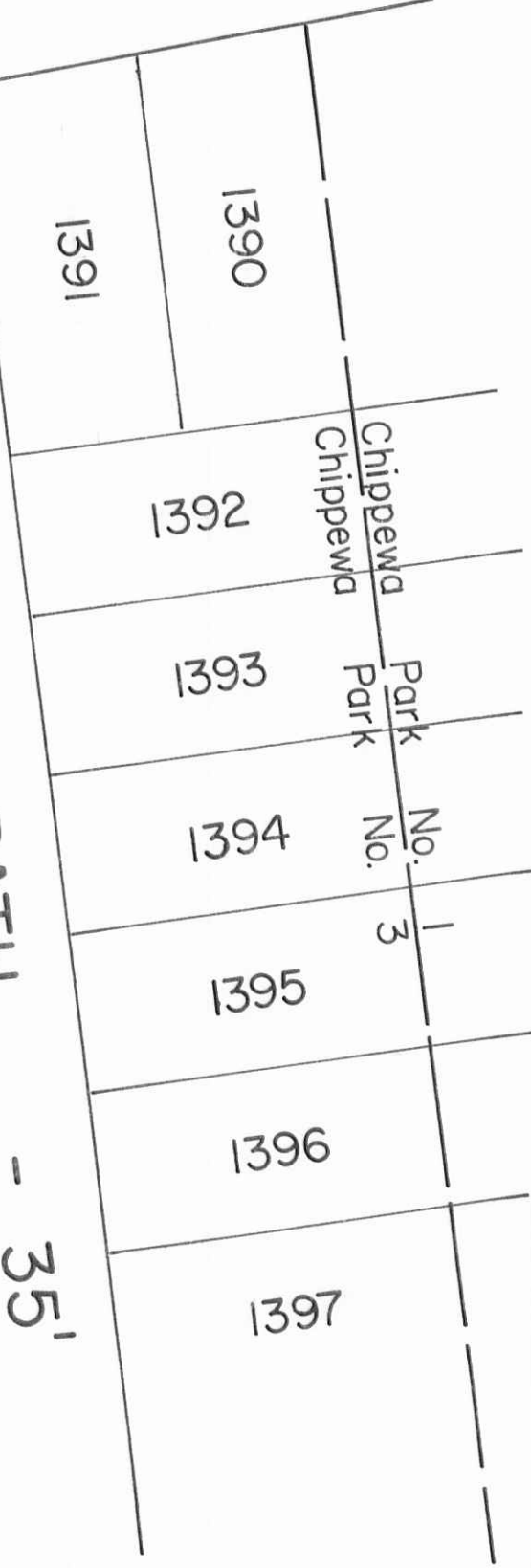

Chippewa Park No. 3



Scale: 1" = 40'



Reference:  
Chippewa Park No. 3  
Plat Cab. A Slide No. 235

Symbols:  
○ - 5/8" x 30" Rebars Fd.  
● - 5/8" x 30" Rebars Set.

Survey of Lots No. 1536 thru 1542 Chippewa Park No. 3, Stokes Township, Logan County, Ohio.		
SCALE: 1" = 40'	APPROVED BY:	DRAWN BY: DEG
DATE: 4-3-1997		REVISED:
<i>Daniel E. Gilbert</i> Daniel E. Gilbert, P.S. Reg. Sur. No. 5402		DRAWING NUMBER 097-012

INDEXED ON MAP  
9122

S-551