

LAWRENCE ST. - 45' R/W

N. 6°-00' E. Basis of Bearing 50.00'

John E. Brown  
O.R. 38 P. 422 (3-4-1986)  
Per. Par. No. 17-091-07-18-003.000

Lot No. 983 pt.

Per. Par. No. 17-091-07-18-004.000

0.170 Acres

S. 83°-28' E. 103.50'

S. 83°-28' E. 2.00'

Dixie Lee Johnson et al  
Vol. 387 P. 438 (4-3-1980)  
Per. Par. No. 17-091-07-18-006.000

Lot No. 970

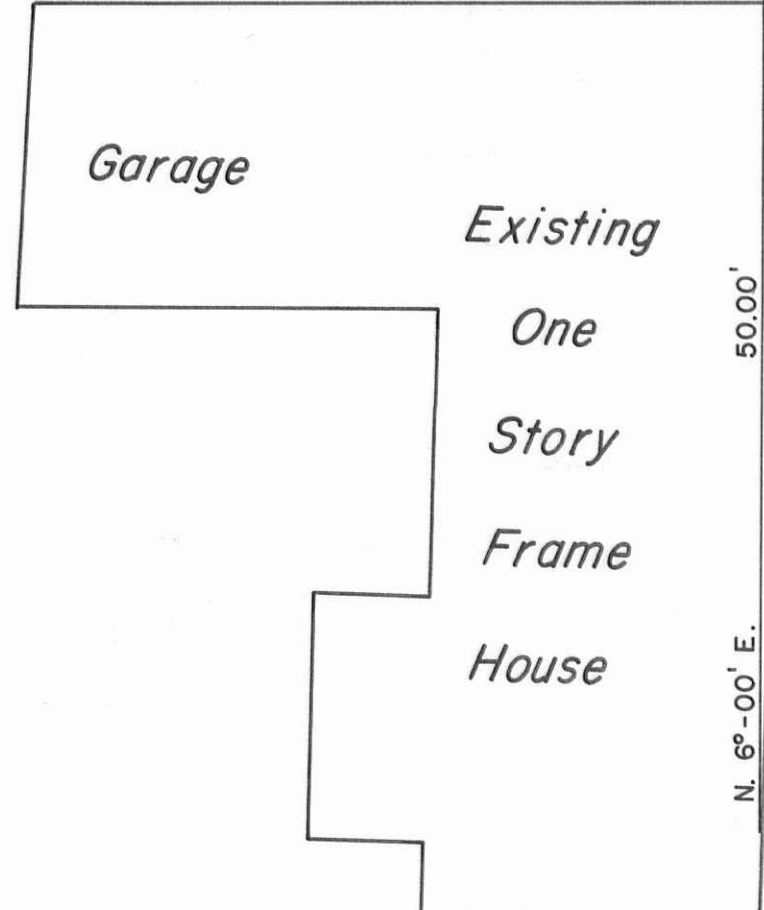

Existing  
One  
Story  
Frame  
House

N. 83°-28' W. 83.50'

N. 6°-00' E. 2.00'

S. 83°-28' E. 20.00'

N. 83°-28' W. 22.00'

N. 6°-00' E. 50.00'

104.00' or 0.002 Acres

S. 6°-00' W. 52.00'

Stanley E. Dow  
Vol. 353 P. 472 (6-12-1974)  
Per. Par. No. 17-091-07-18-005.000

0.131 Acres

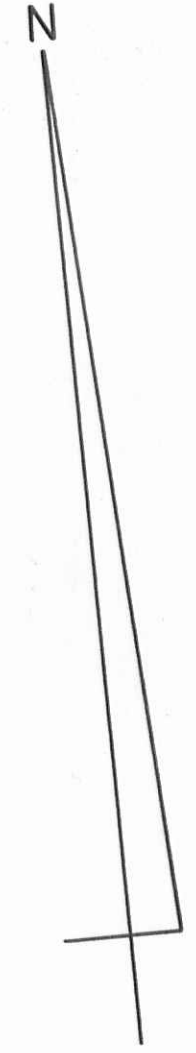

Stanley E. Dow et ux  
Vol. 304 P. 335 (8-20-1965)  
Per. Par. No. 17-091-07-18-007.000

Lot No. 969

• -5/8" x 30" Rebars Fd. or Set.

INDEXED ON MAP  
3988



Dow To Johnson Survey, Part of Lot No. 969 + Acreage,  
Section No. 35, T.4, R.14 BMRS, City of Bellefontaine,  
Lake Township, Logan County, Ohio.

SCALE: 1" = 10'	APPROVED BY:	DRAWN BY DEG
DATE: 12-1-1989		REVISED

*Daniel E. Gilbert*  
Daniel E. Gilbert, P.S.  
Reg. Sur. No. 5402

DRAWING NUMBER  
089-072

S-658