

**ANNEXATION DESCRIPTION**  
**TERRITORY TO BE ANNEXED TO THE CITY OF BELLEFONTAINE**  
 LYING IN SECTION 32, TOWN 4, RANGE 14  
 LIBERTY TOWNSHIP  
 LOGAN COUNTY, OHIO

LYING IN SECTION 32, TOWN 4, RANGE 14, LIBERTY TOWNSHIP, LOGAN COUNTY, OHIO.

BEING A DESCRIPTION FOR ANNEXATION PURPOSES ONLY, OF PART OF THE DOUGLAS D. ELLEMAN ORIGINAL 48.31 ACRE TRACT AS DEEDED AND DESCRIBED IN OFFICIAL RECORD 869, PAGE 905, PARCEL 1 OF THE LOGAN COUNTY RECORDS OF DEEDS AND BEING MORE PARTICULARLY DESCRIBED AS FOLLOWS:

COMMENCING ON A POINT ON THE NORTH LINE OF SECTION 32 AND THE NORTH LINE OF LIBERTY TOWNSHIP AT THE INTERSECTION OF THE CENTER-LINES OF TOWNSHIP ROAD 200 (ALLEN ROAD) AT STATION 20+00.00 AND U. S. ROUTE 68 (SOUTH MAIN STREET) AT STATION 327+08.33.

THENCE, WITH THE CENTER-LINE OF U.S. ROUTE 68 (VARIABLE WIDTHS), S 02°-30'-26"E, A DISTANCE OF 1625.98 FEET TO A POINT.

THENCE, WITH THE SOUTH LINE OF THE OHIO DEPARTMENT OF TRANSPORTATION 0.0133 ACRE TRACT (PARCEL 16 WDV, O.R. 957, PG. 317) EXTENDED AND THE SOUTH LINE OF SAID 0.0133 ACRE TRACT, S 84°-27'-48"E, A DISTANCE OF 42.92 FEET TO A POINT AT THE TRUE POINT OF BEGINNING.

THENCE, WITH THE EXISTING CORPORATION LINE AND THE SOUTH LINE OF THE SBC INVESTMENTS, LLC 2.500 ACRE TRACT (O.R. 912, PG. 376), S 84°-27'-48"E, A DISTANCE OF 258.30 FEET TO A POINT.

THENCE, S 06°-37'-27"W, A DISTANCE OF 128.85 FEET TO A POINT.

THENCE, N 85°-21'-23"W, A DISTANCE OF 237.15 FEET TO A POINT.

THENCE, WITH THE EAST LINE OF THE OHIO DEPARTMENT OF TRANSPORTATION 0.2226 ACRE TRACT (PARCEL 13 WDV, O.R. 959, PG. 294), N 02°-30'-26"W, A DISTANCE OF 133.84 FEET TO THE POINT OF BEGINNING.

CONTAINING 0.743 ACRE.

PROPERTY IS SUBJECT TO ANY AND ALL PREVIOUS EASEMENTS AND RIGHTS-OF-WAY OF RECORD.

THE BASIS FOR BEARINGS IS THE CENTER-LINE OF U.S. ROUTE 68, BEING S 02°-30'-26"E, AND ALL OTHER BEARINGS ARE FROM RECORD. THIS DESCRIPTION IS FOR ANNEXATION AND RE-ZONING PURPOSES ONLY AND IS NOT A BOUNDARY SURVEY AS DEFINED IN OHIO ADMINISTRATIVE CODE 4733-37.

DESCRIPTION PREPARED BY WILLIAM K. BRUCE, PROFESSIONAL SURVEYOR 7437, ON JUNE 8, 2012.

TOWNSHIP ROAD 200 (40') ALLEN ROAD  
 LAKE TOWNSHIP  
 LIBERTY TOWNSHIP  
 SECTION 33, TOWN 4, RANGE 14  
 SECTION 32, TOWN 4, RANGE 14

STATION 20+00.00 (TOWNSHIP ROAD 200)  
 STATION 327+08.33 (U.S. ROUTE 68)

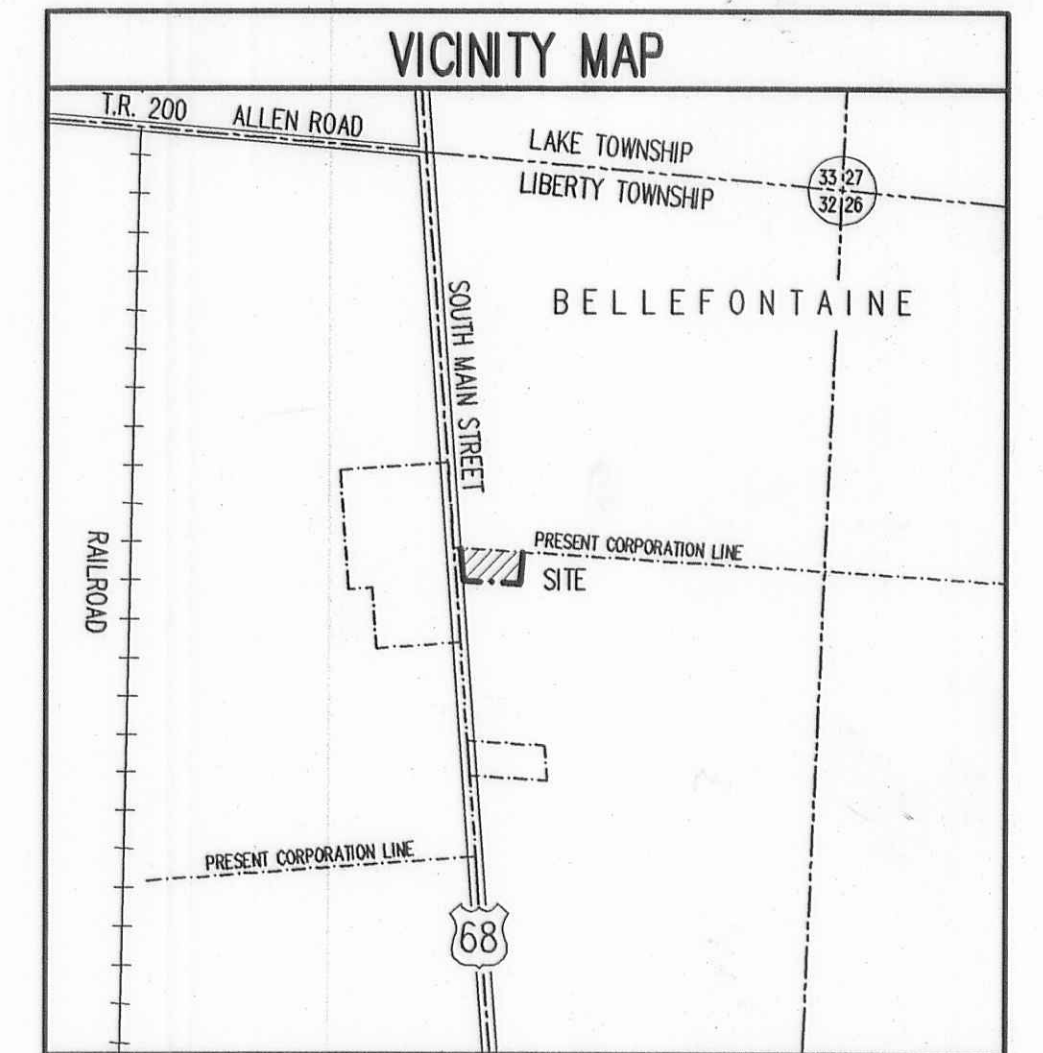
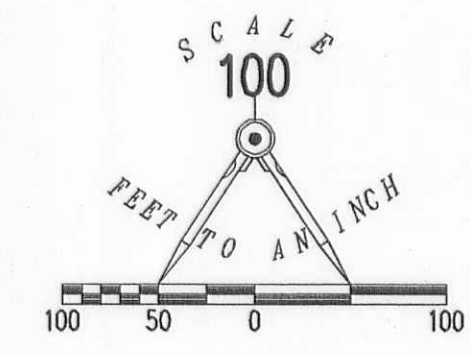

SOUTH MAIN STREET (VARIABLE WIDTHS)



WAL-MART REAL ESTATE BUSINESS TRUST  
 ORIGINAL 22.406 ACRES  
 O.R. 642, PG. 496

WILSON ANDERSON  
 ORIGINAL 72.17 ACRES  
 VOL. 390, PG. 818

SBC INVESTMENTS, LLC  
 ORIGINAL 2.500 ACRES  
 O.R. 912, PG. 376

DAVID P. MONNIN, TRUSTEES  
 ORIGINAL 2.009 ACRES  
 O.R. 208, PG. 1004

DOUGLAS D. ELLEMAN  
 ORIGINAL 48.31 ACRES  
 O.R. 869, PG. 905  
 PARCEL 1

AUSTIN INVESTMENTS LLC  
 8.000 ACRES  
 O.R. 693, PG. 344

THE ALLEN GROUP, LLC  
 1.000 ACRE  
 O.R. 786, PG. 806

0.743 ACRE  
 EXISTING CORPORATION LINE  
 S 84°27'48" E 258.30'  
 PROPOSED CORPORATION LINES  
 N 85°21'23" W 237.15'

**CITY OF BELLEFONTAINE**  
**ANNEXATION AND RE-ZONING MAP OF**  
**0.743 ACRE OF WHICH:**

0.743 ACRE IS OUT OF THE  
 DOUGLAS D. ELLEMAN  
 ORIGINAL 48.31 ACRE TRACT  
 OFFICIAL RECORD 869, PAGE 905  
 PARCEL 1

SECTION 32, TOWN 4, RANGE 14  
 LIBERTY TOWNSHIP  
 LOGAN COUNTY, OHIO

- ADJOINERS**
- (A) OHIO DEPARTMENT OF TRANSPORTATION 0.0087 ACRE (PARCEL 18 WDV) O.R. 964, PG. 225
  - (B) OHIO DEPARTMENT OF TRANSPORTATION 0.0133 ACRE (PARCEL 16 WDV) O.R. 957, PG. 317
  - (C) OHIO DEPARTMENT OF TRANSPORTATION 0.2226 ACRE (PARCEL 13 WDV) O.R. 959, PG. 294
  - (D) OHIO DEPARTMENT OF TRANSPORTATION 0.4229 ACRE (PARCEL 14 WDV) O.R. 953, PG. 289
  - (E) OHIO DEPARTMENT OF TRANSPORTATION 0.1722 ACRE (PARCEL 17 WDV) O.R. 957, PG. 279
  - (F) OHIO DEPARTMENT OF TRANSPORTATION 0.3099 ACRE (PARCEL 15 WDV) O.R. 956, PG. 667

LOGAN COUNTY COMMISSIONERS	<u>John Banjo</u>	<u>6-2-2015</u>
		DATE
	<u>D. A. 21-51</u>	<u>6-2-15</u>
		DATE
	<u>Anthony S. Coe</u>	<u>6/2/15</u>
		DATE
LOGAN COUNTY ENGINEER	<u>Scott Cole</u>	<u>7-27-15</u>
		DATE
CHAIRMAN, TOWNSHIP TRUSTEES	<u>Pat Gendry</u>	<u>7-13-15</u>
		DATE
L.U.C. PLANNING DIRECTOR	<u>David Good</u>	<u>7-20-15</u>
		DATE
MAYOR OF BELLEFONTAINE	<u>Ben Stahler</u>	<u>6-9-15</u>
		DATE
PRESIDENT, CITY COUNCIL	<u>David J. Henry</u>	<u>6.9.15</u>
		DATE
CLERK, CITY COUNCIL	<u>Bonnie Patterson</u>	<u>6-9-15</u>
		DATE
PLAT PRE-APPROVED	<u>Gregory M. Yeary</u>	<u>7-24-15</u>
		DATE
PLAT CHECKED	<u>Gregory M. Yeary</u>	<u>7-27-15</u>
		DATE
CITY ORDINANCE NUMBER	<u>13-25</u>	

TRANSFERRED THIS 21<sup>st</sup> DAY OF July, 20 15

AUDITOR, LOGAN COUNTY, OHIO Spencer E. Grew

RECEIVED FOR RECORD AT 12:06:17 O'CLOCK P. M.

THIS 10<sup>th</sup> DAY OF August, 20 15

RECORDER, LOGAN COUNTY, OHIO Patricia A. Myers

RECORDED IN PLAT CABINET B SLIDE 134A



PREPARED BY:  
William K. Bruce  
 WILLIAM K. BRUCE  
 PROFESSIONAL SURVEYOR 7437  
 JUNE 8, 2012  
 COPYRIGHT 2012 BY:  
 LEE SURVEYING & MAPPING CO., INC.  
 117 North Wedgier Street  
 BELLEFONTAINE, OHIO 43311  
 (937) 593-7335  
 www.lsminc.us  
 surveys@lsminc.us  
 KSS D0612 53410612 L-5341-1