

STOKES TOWNSHIP ISLANDER BOATEL & CONDOMINIUM CRANE-TOWN ISLAND

V.M.S. NO. 12276

SCALE: 1"=100'

UNIT	NAME	DATE
E-1	NORMA J. WARREN	2-14-80
E-2	"	"
E-3	JOHN R. EIFERT ETUX	12-11-79
E-4	SEC. FED. SAVINGS & LOAN ASSN.	5-22-83
E-5	CECIL B. RIBER ETAL	7-26-83
E-6	GRACE CLINE FELTER	1-25-80
E-7	INLACO INC.	6-8-83
E-8	"	"
E-9	"	"
E-10	"	"
E-11	INLACO INC	6-8-83
E-12	JULIUS L. FORTE ETUX	9-29-81
E-13	"	"
E-14	JAMES R. JOHNSON ETUX	8-13-83
E-15	INLACO INC	6-8-83
E-16	STANDARD AMERICAN INC	4-17-84
E-17	"	"
E-18	JAMES B. ROBERTS ETUX	4-11-83
E-19	WAYNE W. PATTON ETUX	10-2-80
E-20	JANE B. BOSART	5-16-80

UNIT	NAME	DATE
A-1	DANIEL J. GRUBB ETUX	6-20-83
A-2	CLIFFORD W. HOENIE ETUX	5-15-79
A-3	GEORGE K. DICK ETUX	6-14-76
A-4	DON R. BLOOM ETAL	6-18-79
A-5	ELIZABETH C. BAKER	8-18-75
A-6	INDLAKE, INC.	1-18-79
A-7	INLACO INC.	6-8-83
A-8	NOEL A. MILLER ETAL	11-27-78
A-9	ROBERT A. SMILEY ETAL	8-18-82
A-10	J. A. HOFFMAN & SON, INC.	7-30-76
A-11	ARTHUR LYTLE JR. ETAL	5-5-75
A-12	JEROME D. POPE	7-19-79
A-13	G. IRICK NELSON	7-23-79
A-14	FRANCIS L. MOSHER ETAL	10-25-83
A-15	DAVID B. GRIESHOP ETUX	8-12-80
A-16	JOHN P. GORDON ETUX	10-4-80
A-17	MARILYN F. MEUCHE	2-5-79
A-18	NICHOLAS R. CAGNETTI ETUX	7-3-75
A-19	LEWIS W. COPPEL ETAL	8-22-83
A-20	BARBARA R. WEBER	6-8-77

B-1	JOHNNY A. WODA	2-6-84
B-2	JOHN W. HENDERSON ETAL	8-15-83
B-3	SYLVANUS A. HUDSON ETUX	7-28-80
B-4	JOHN R. EIFERT ETAL	11-1-79
B-5	CORONAL FED. SAVINGS & LOAN ASSOC.	5-19-83
B-6	LARRY J. RITZERT ETUX	7-6-79
B-7	MICHAEL E. ELSASS ETAL	2-21-80
B-8	JANE E. OLAH	8-28-80
B-9	HOMER L. HACKETT	10-21-82
B-10	OLGA LATHAM	9-26-78

UNIT	NAME	DATE
C-1	J. MICHAEL JOLY	10-31-77
C-2	ROBERT D. WEAVER ETAL	7-23-79
C-3	STEPHEN SEDMAK	4-3-84
C-4	H. S. STEVENSON & SONS, INC.	5-24-79
C-5	LOUIS W. KNERR III	4-30-81
C-6	SHIRLEY J. FITZGERALD ETAL	4-30-80
C-7	FOREST W. BOLANDER ETUX	8-29-79
C-8	MARTHA M. STREMPER	6-8-77
C-9	DAVID A. WITZIGREUTEN ETUX	9-8-77
C-10	PATRICIA H. JACKSON	7-8-77
C-11	JAMES F. LENZ ETAL	4-22-77
C-12	TOMY NIEMEYER LAMOND INC.	3-19-84
C-13	KAE L. WALTERS	11-29-76
C-14	ELIZABETH C. BAKER ETUX	2-8-77
C-15	JAMES F. KITCHEN ETUX	12-4-82
C-16	ANTHONY R. POHLMAN	9-15-83
C-17	FRANK L. HARROP ETUX	11-27-78
C-18	LOUIS W. KNERR ETAL	12-29-76
C-19	THE FISHER REAL ESTATE CO.	10-26-79

D-1	FLORENCE E. FISHER	8-29-80
D-2	BOBBY FISHER INC	8-25-83
D-3	PAUL I. KUPPIN	10-24-80
D-4	INLACO INC	6-8-83
D-5	RUTH ANN WEDGE	5-22-81

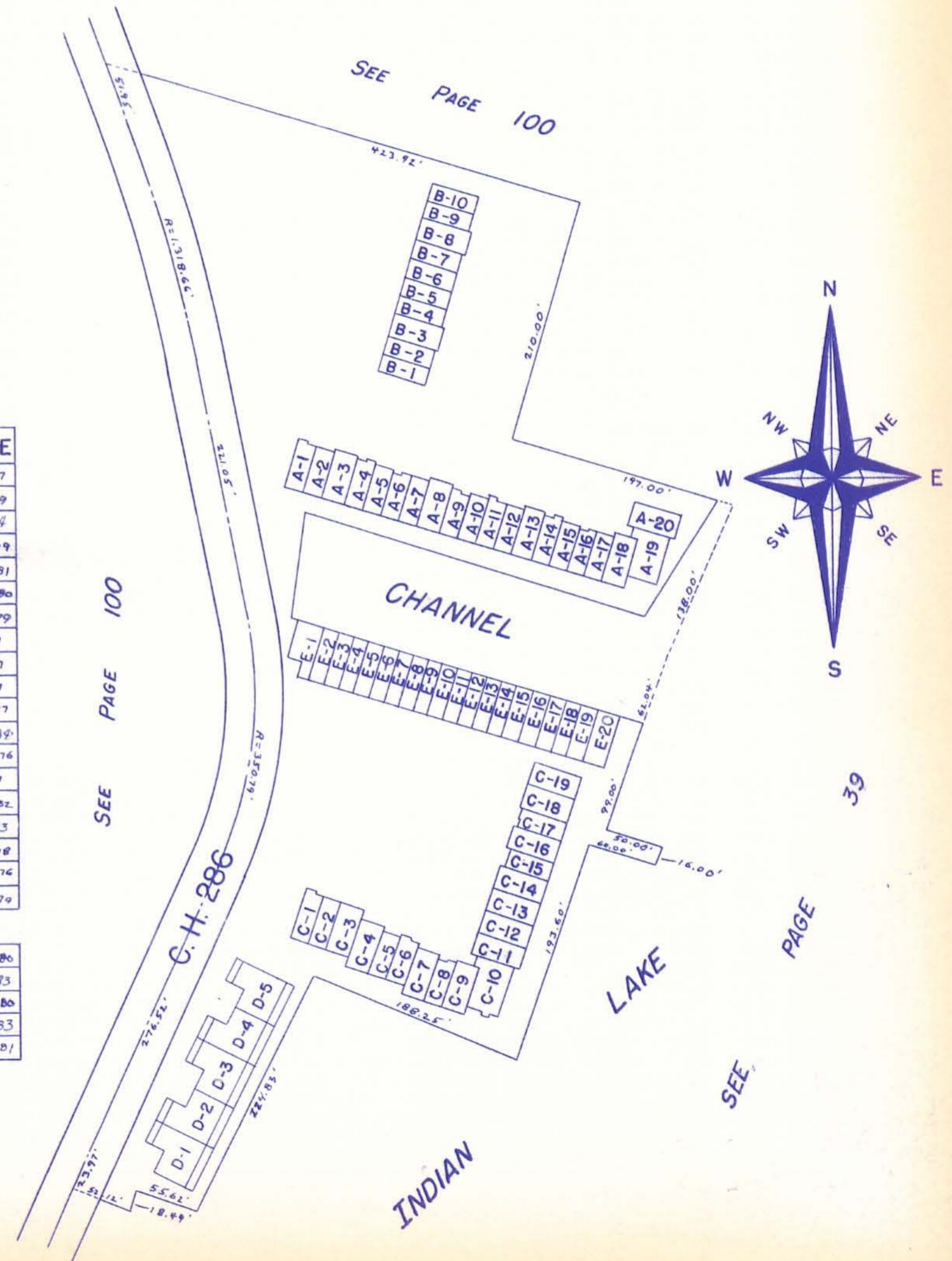

ISLANDER BOATEL & CONDOMINIUM
CABINET A SLIDE 577 & 605
ENG. FILE J-241 & J-241A

DRAWN 6-6-1979
BY R. L. REAMES A.T.M.D.